



ZONING MAP

THE NEW YORK CITY PLANNING COMMISSION

Major Zoning Classifications:

The number(s) and/or letter(s) that follows an R, C or M District designation indicates use, bulk and other controls as described in the text of the Zoning Resolution.

- R – RESIDENTIAL DISTRICT
- C – COMMERCIAL DISTRICT
- M – MANUFACTURING DISTRICT

AREA(S) REZONED

EFFECTIVE DATE(S) OF REZONING:

10-29-2007 C 070447 ZMK

SPECIAL PURPOSE DISTRICT
The letter(s) within the shaded area designates the special purpose district as described in the text of the Zoning Resolution.

- D – RESTRICTIVE DECLARATION
- E – CITY ENVIRONMENTAL QUALITY REVIEW DECLARATION

MAP KEY

12d	13b	13d
16c	17a	17c
16d	17b	17d

© Copyrighted by the City of New York

ZONING MAP 17a

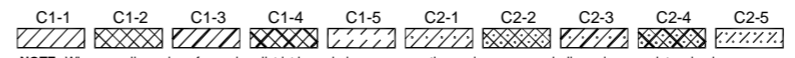
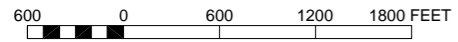

NOTE: Where no dimensions for zoning district boundaries appear on the zoning maps, such dimensions are determined in Article VII, Chapter 6 (Location of District Boundaries) of the Zoning Resolution.

NOTE: Zoning information as shown on this map is subject to change. For the most up-to-date zoning information for this map, visit the Zoning section of the Department of City Planning website: www.nyc.gov/planning or contact the Zoning Information Desk at (212) 720-3291.