

# Newtown Avenue Public Workshop

NYC DOT & The Central Astoria LDC

June 5, 2012



Presented by NYC DOT:  
Vaidila Kungys & Emily Weidenhof



CB1  
QUEENS

# Agenda

- |                         |   |        |
|-------------------------|---|--------|
| 1. Presentation         | - | 15 min |
| 2. Small groups         | - | 20 min |
| 3. Share group thoughts | - | 15 min |
| 4. Wrap up              | - | 10 min |

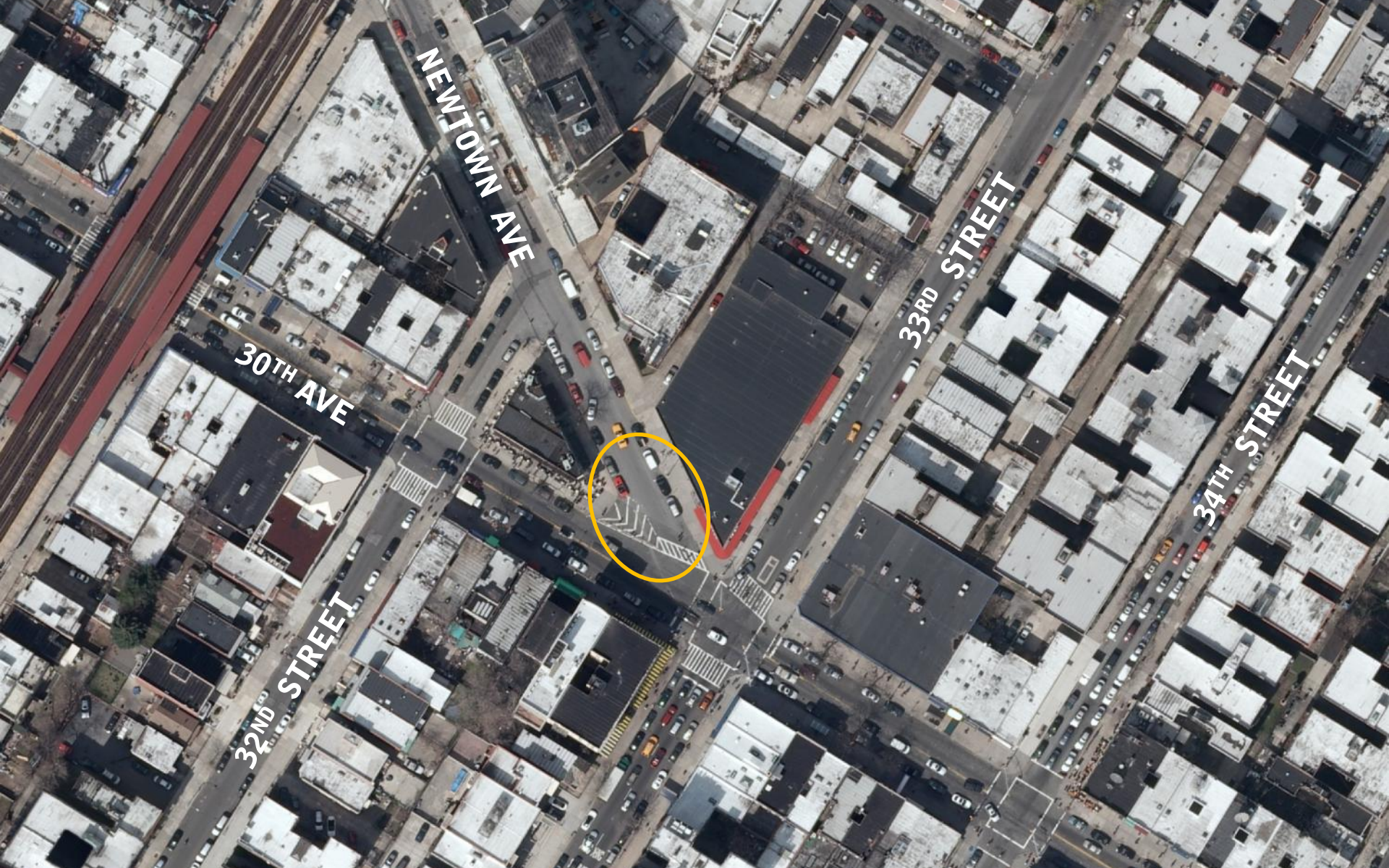

Newtown Ave  
Between 32<sup>nd</sup> & 33<sup>rd</sup> Street



Newtown Ave  
At 30<sup>th</sup> Ave looking northwest



Newtown Ave  
Near 32<sup>nd</sup> St looking southeast

# School Safety:

PS 17 on 29<sup>th</sup> St is one of 135 schools citywide that is part of DOT's School Safety Program.

There is high rate of vehicle accidents in the district.

New York City Department of Transportation  
Office of School Safety Engineering



School Safety Engineering Project

FINAL REPORT: P.S. 17 (Henry Thoreau School), Queens



Prepared by  
The RBA Group/Urbitran Associates



MARCH 22, 2006

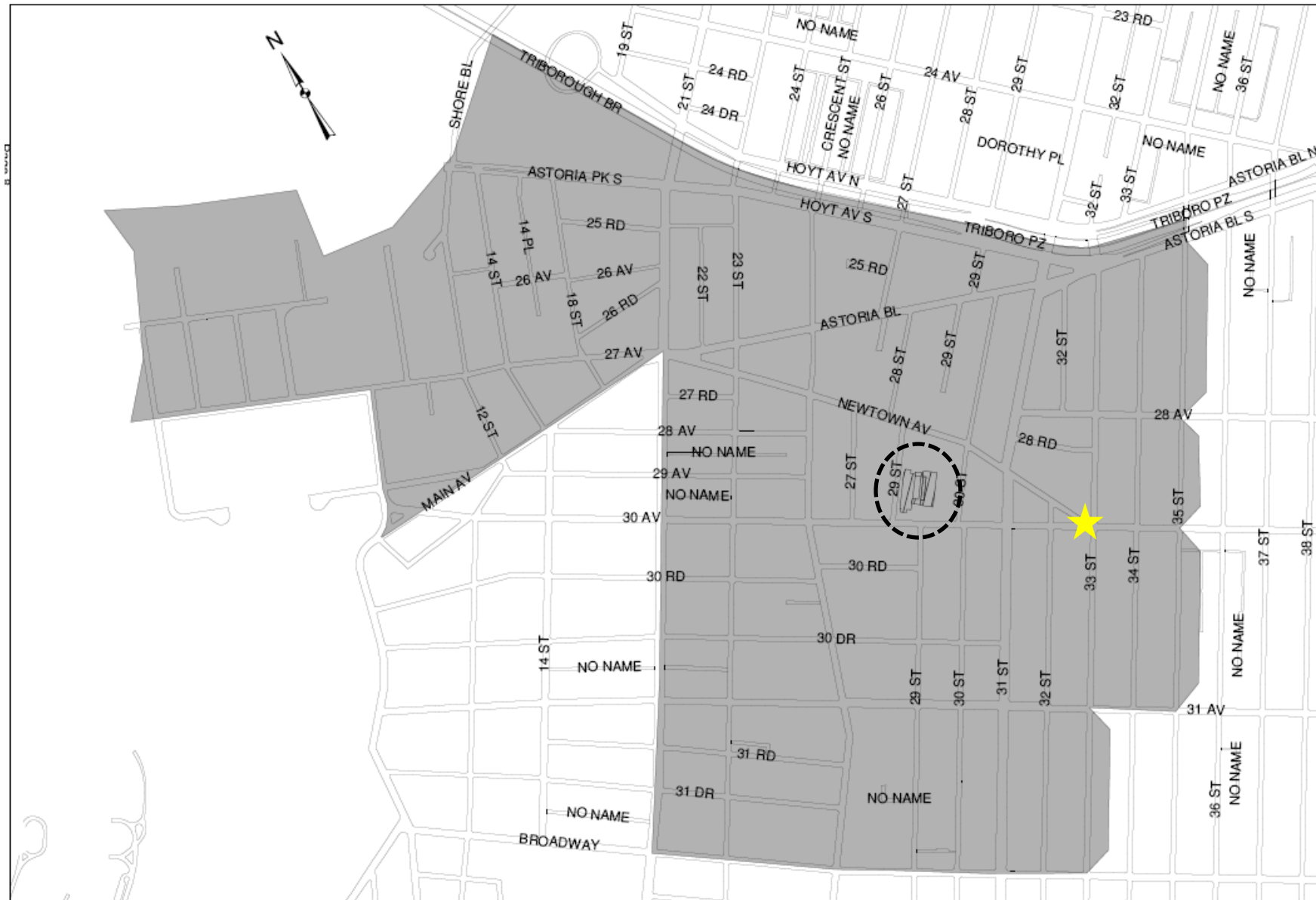

1 inch equals 750 feet



CATCHMENT AREA

## EXHIBIT 2

**HENRY THOREAU SCHOOL  
P.S. 17, QUEENS  
CATCHMENT AREA**

# Total Accidents

Page 17

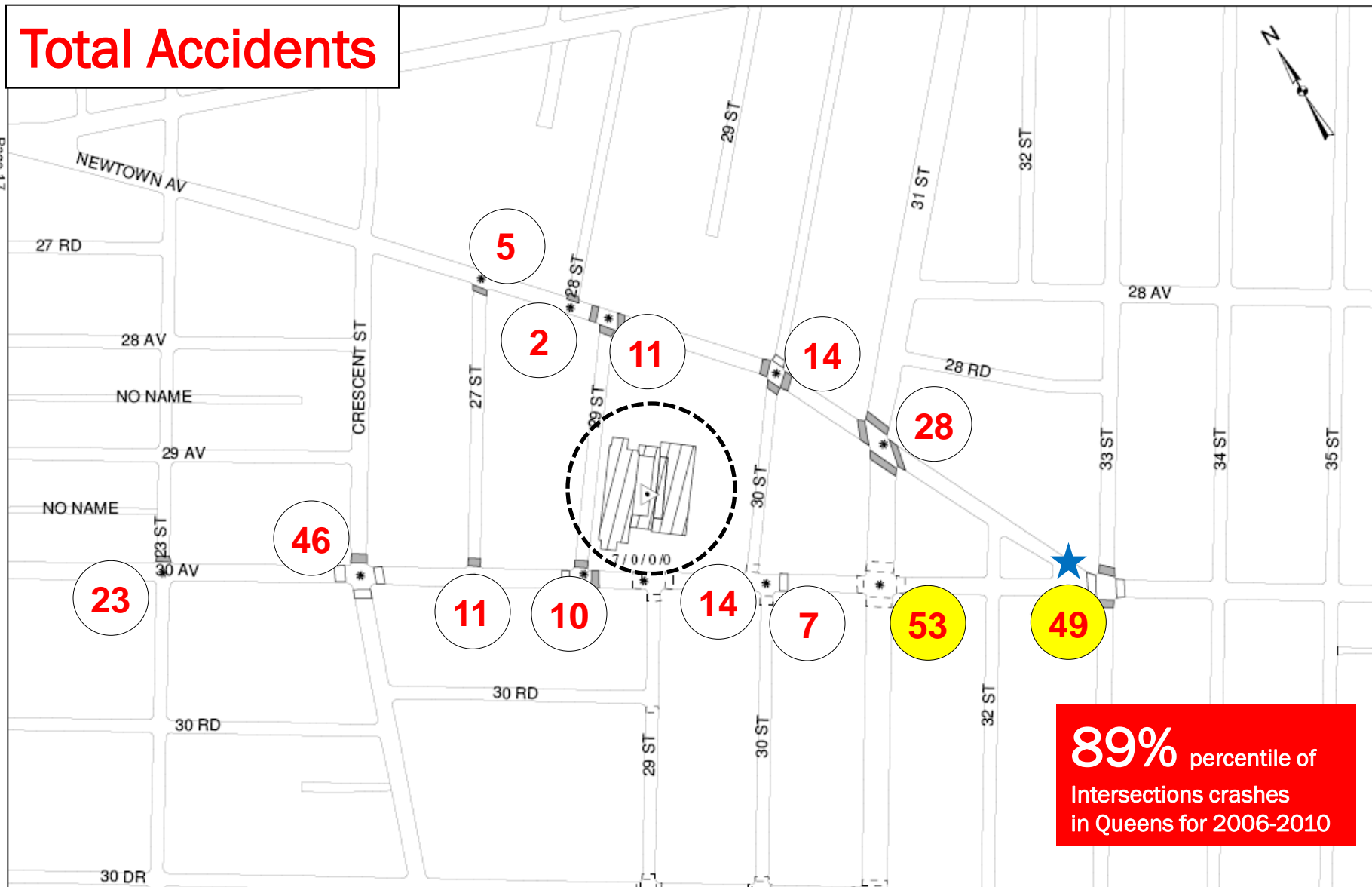

**89%** percentile of  
Intersections crashes  
in Queens for 2006-2010

ACCIDENT LOCATION

SCHOOL CROSSWALK ASSIGNED TO P.S. 17

SCHOOL CROSSWALK ASSIGNED TO ANOTHER SCHOOL

CROSSWALK

X/X/X/X

\*

■

□

□

1 inch equals 300 feet

TOTAL ACCIDENTS	PED ACCIDENTS	PED FATAL	SCHOOL_PED ACCIDENTS
X	X	X	X

EXHIBIT 6

HENRY THOREAU SCHOOL  
P.S. 17, QUEENS

ACCIDENT SUMMARY  
THREE YEAR PERIOD  
(1998-2000)

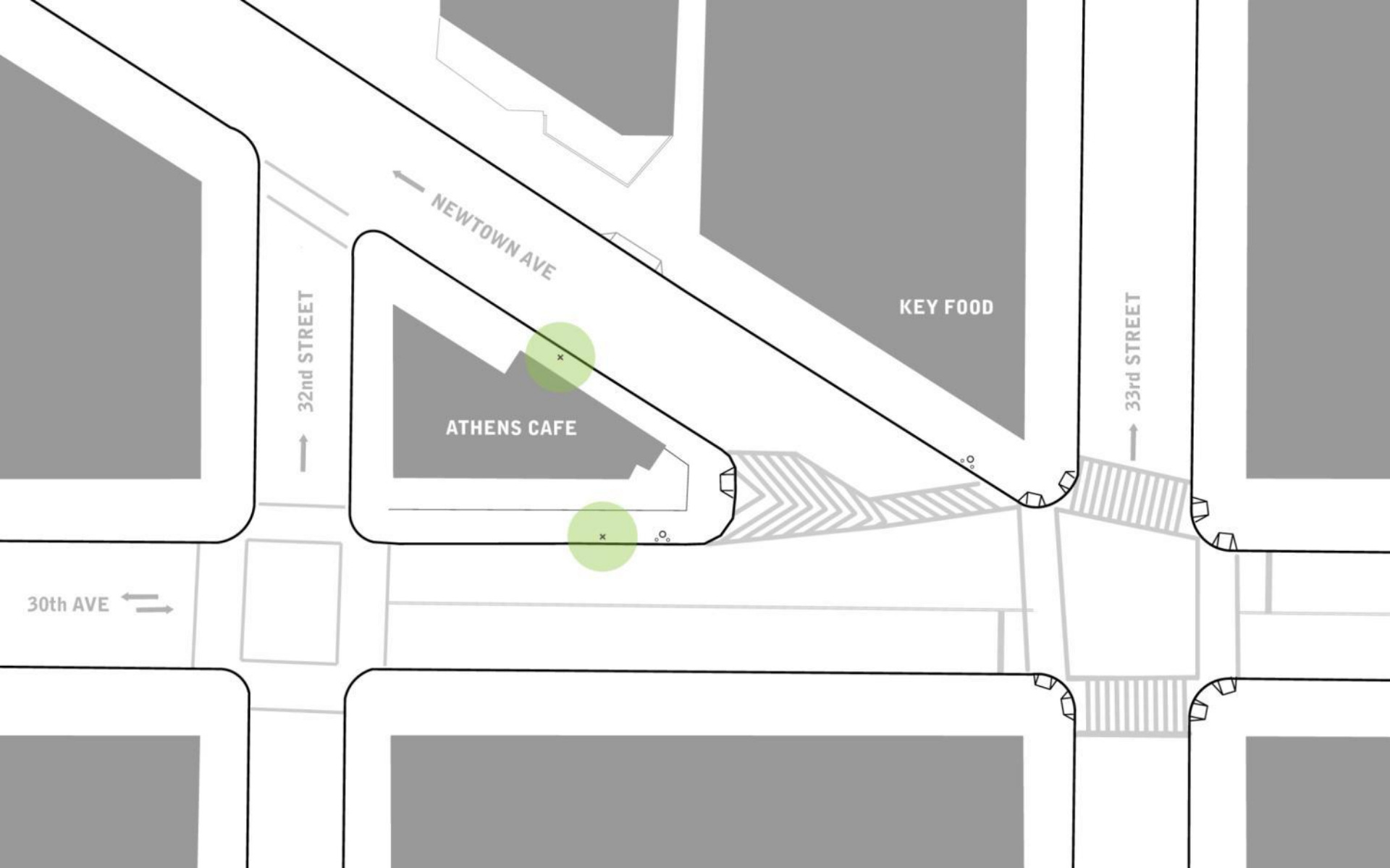

Newtown Ave  
Existing intersection

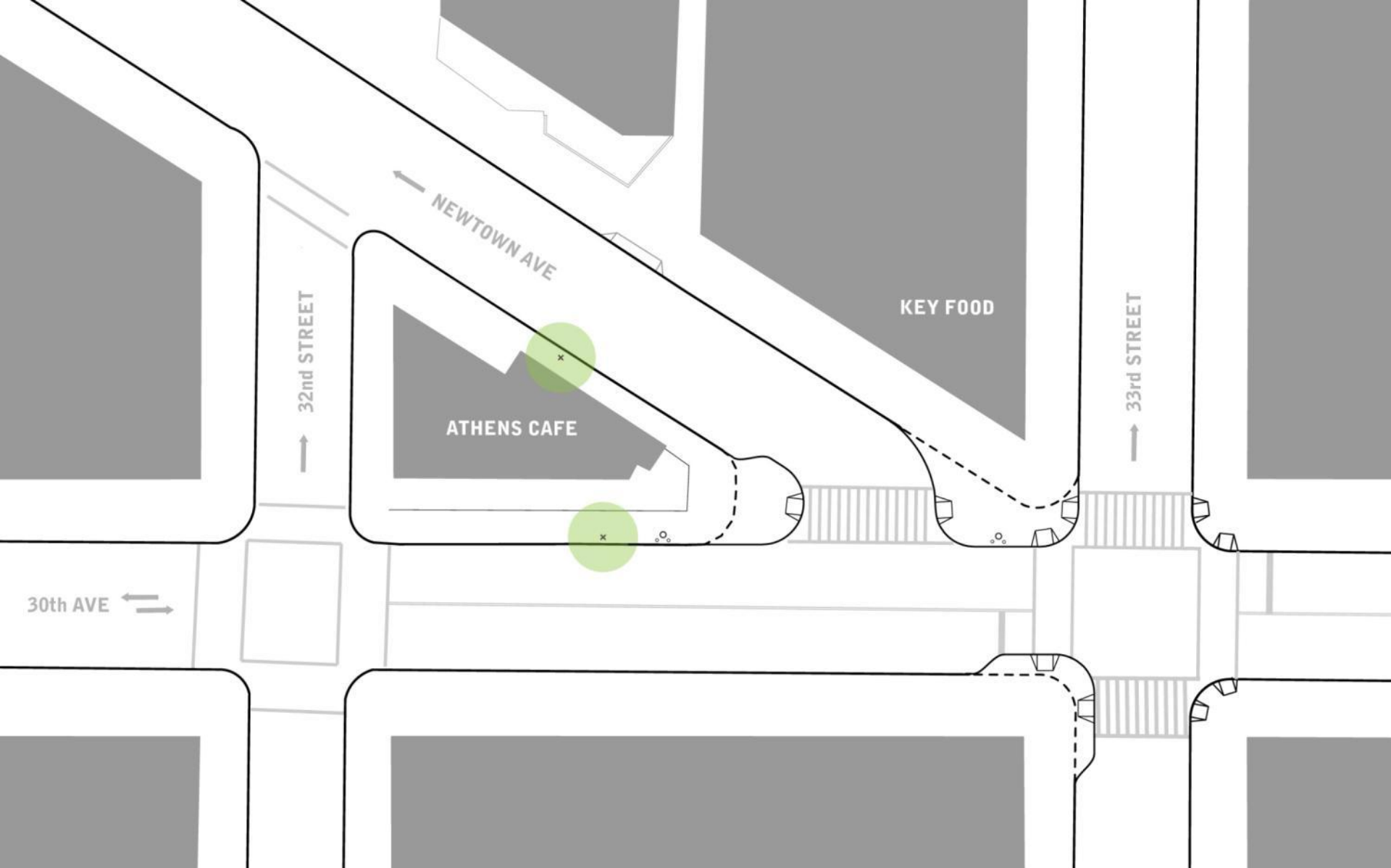

## Newtown Ave

School Safety Curb Extensions to be built Spring 2013, an approx. cost of \$400,000



# Traffic Calming & Safety

Curbs designed to accommodate all vehicle turns, including trucks

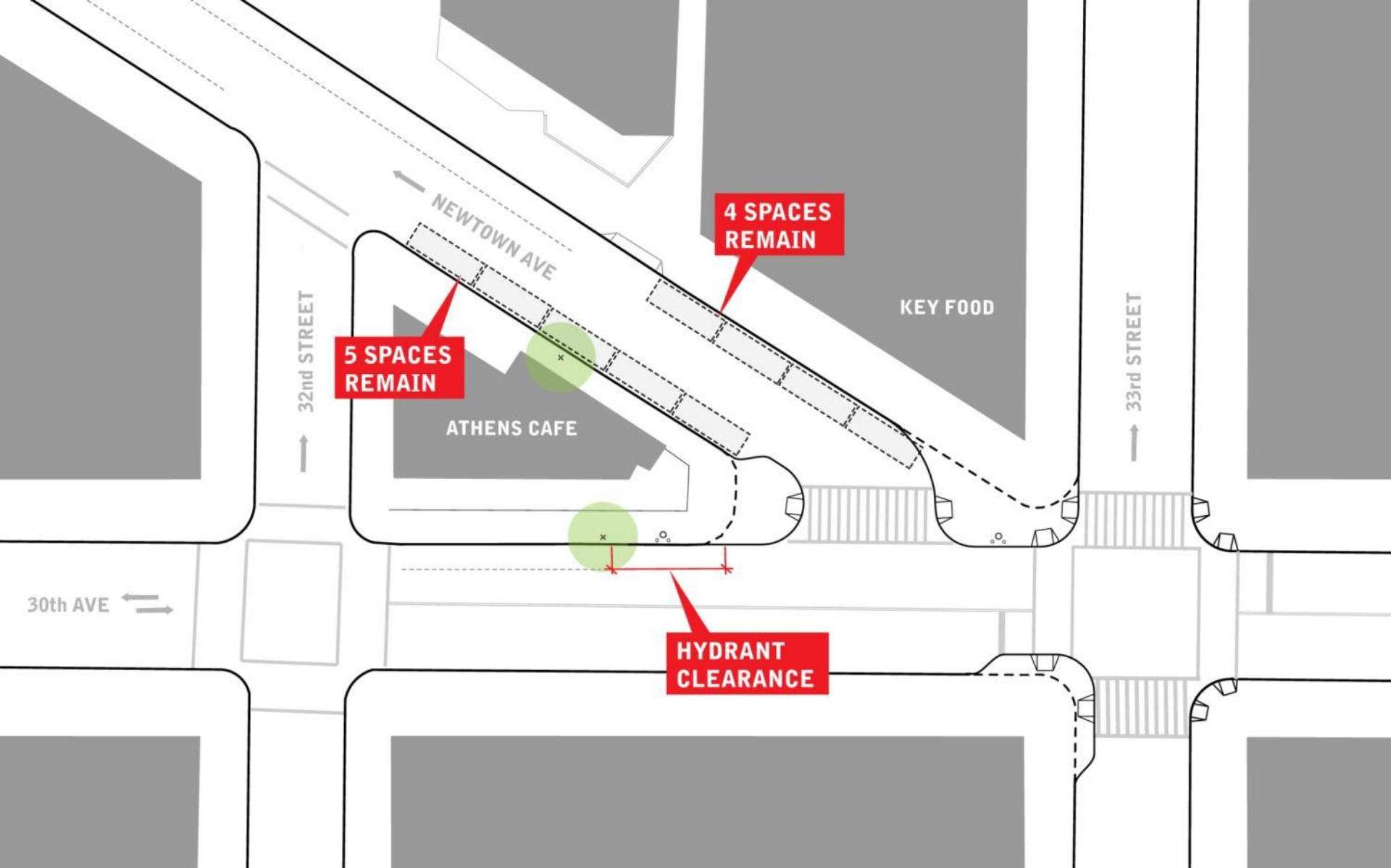

## Parking

School Safety project retains existing parking

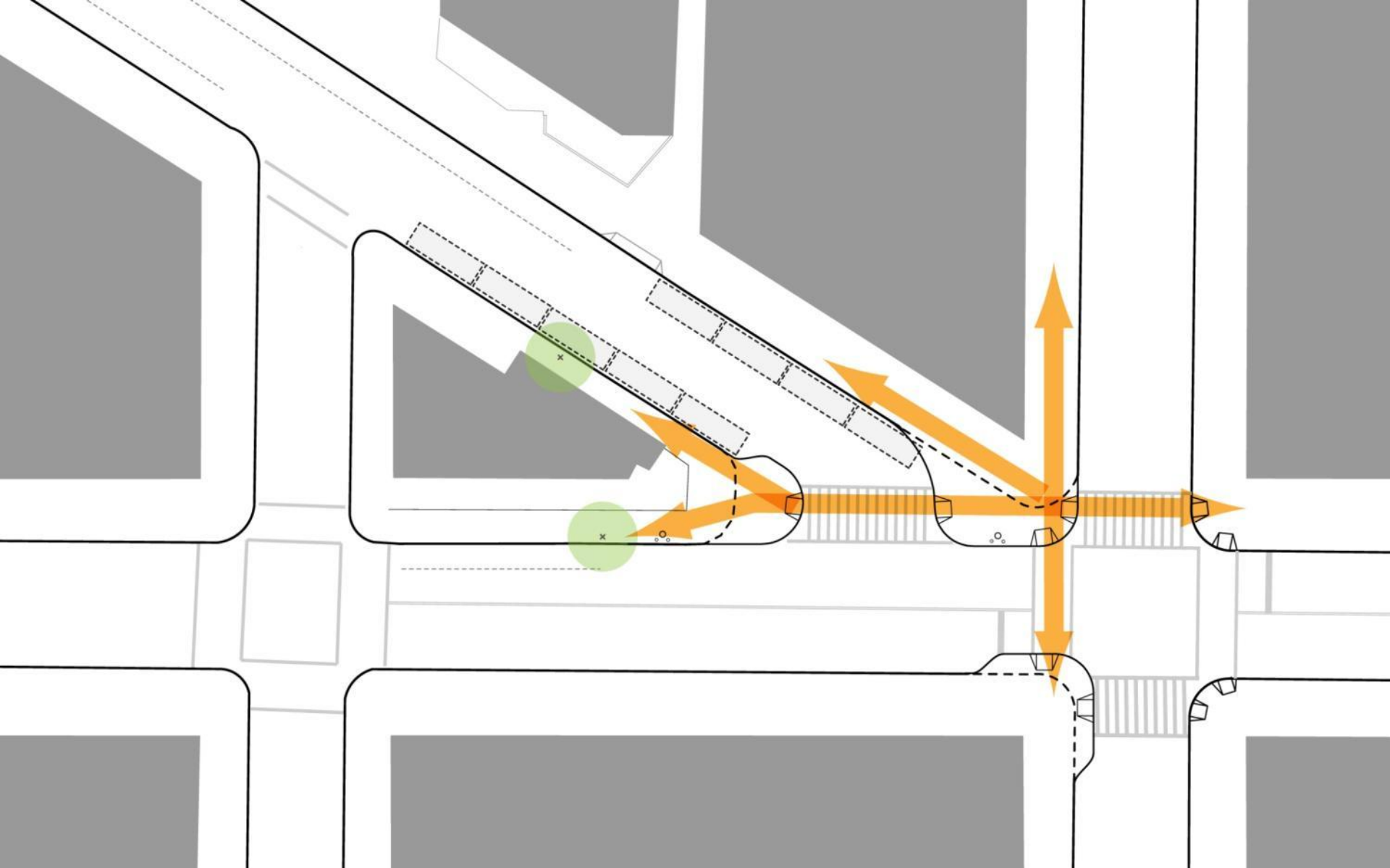

## Pedestrian Circulation

Curb extensions leave little useable public space



New York City Plaza Program launched in 2008  
Dept. of Transportation



# Application to the Plaza Program for Newtown Ave/30<sup>th</sup> Ave

## NYC Plaza Program - 2009 Application for Sponsoring Organization

Please read through the Plaza Program Guidelines before completing the application

ORGANIZATIONAL INFORMATION	
Name of Sponsoring Organization:	Hellenic Orthodox Community of Astoria Saint Demetrios
EIN/Date of Incorporation:	EIN: 86-90289 Date: 11-19-1927
NY State not-for-profit status:	Active <input checked="" type="checkbox"/> Inactive <input type="checkbox"/> Pending <input type="checkbox"/>
Address:	30-11 30th Drive
	City: Queens
	State: NY Zip: 11102
Phone Number:	718-728-1754
Fax Number:	718-726-3482
Website:	
Executive Director/Paid Staff Head:	Mr. Anastasio Koularmanis
Contact Person and Title:	Mr. Nick Andriotis
Contact's Address:	38-07 31st Avenue
	City: Queens
	State: NY Zip: 11102
Contact's Telephone:	917-922-5171
Contact's E-mail:	Andriotis@almarealty.com

AREA SERVED BY ORGANIZATION	
Borough:	Queens
Community Board(s):	1
Neighborhood(s):	Astoria/L.I.C

## Letters of Support

30<sup>th</sup> Avenue Business Association  
37-01 30<sup>th</sup> Ave, Astoria, NY 11103



**City of New York**  
**Community Board #1, Queens**  
American Museum of Moving Image  
36-01 35<sup>th</sup> Avenue  
Astoria, N.Y. 11106  
Tel: 718-786-3335, Fax: 718-746-3368

October 8, 2009

Mr. Valdis Knaggs  
Office of Planning & Sustainability:  
Public Works  
Department of Transportation  
55 Water Street, 9<sup>th</sup> Fl.  
New York, NY 10041

Dear Mr. Knaggs:

RE: Public Plaza Program - Triangle @ 30<sup>th</sup> Ave/Newtown Ave in Astoria, Queens, NY

Community Board 1 has consulted with representatives of the 30<sup>th</sup> Avenue Business Association regarding the above referenced location. As a result, our Board has no objection to the location being used as a Plaza to honor of Bishop Jankovic, providing the following stipulations are adhered to, as per the Business Association's request.

- No seating, temporary or permanent, be installed
- No vendors permitted
- An illuminated flagpole with an American Flag be installed along side the memorial
- The pathway is to be lit with bollards around the triangle

The above noted stipulations have been agreed upon as per the applicant's (Hellenic Orthodox Community of Astoria Saint Demetrios) representative, Nick Andriotis, and the President of the Business Association, Teddy Fessell.

Should you have any questions, please contact our District Manager, Lucille Hartmann.

Thank you.

*(Signature)*  
Teddy Fessell  
President

cc: Hon. Peter Vallone, Jr.  
Mr. Nick Andriotis  
Mr. Teddy Fessell, 30 Ave.BA  
Encl.

**BOARD MEMBERS (cont.)**

Rita Awa Alahgheem  
George Alexiou  
Oss Antonopoulos  
Edward Baber  
Janita Bushwala  
Ann Bruns  
Gerald Calabrese  
James C'Pich  
Dolores DeCicco  
Mary Fennell  
Doreen K. Dorekian  
Elizabeth Fries  
Salvatore Guglielmo  
Anthony Guglielmo  
Pauline Iannelli  
Jury Kell  
Frances Labiano-McDonald  
William Melick  
Preston Miles  
Keren Minkovsky  
Sally Nardone  
Rita Marie Porensco  
Gus Tardian  
Thomas Ryan  
Michael Sene  
Rudolf Sorbara  
Jaredella Smith  
Doreen Spivack  
Judy Talbot  
Patrick A. White  
Heather Wilson  
Alex P. Zarkov

Hellenic Orthodox Community of Astoria St Demetrios  
Astoria Organization applied to the NYC Plaza Program

Astoria is one of ten neighborhoods with the least amount of open space in NYC

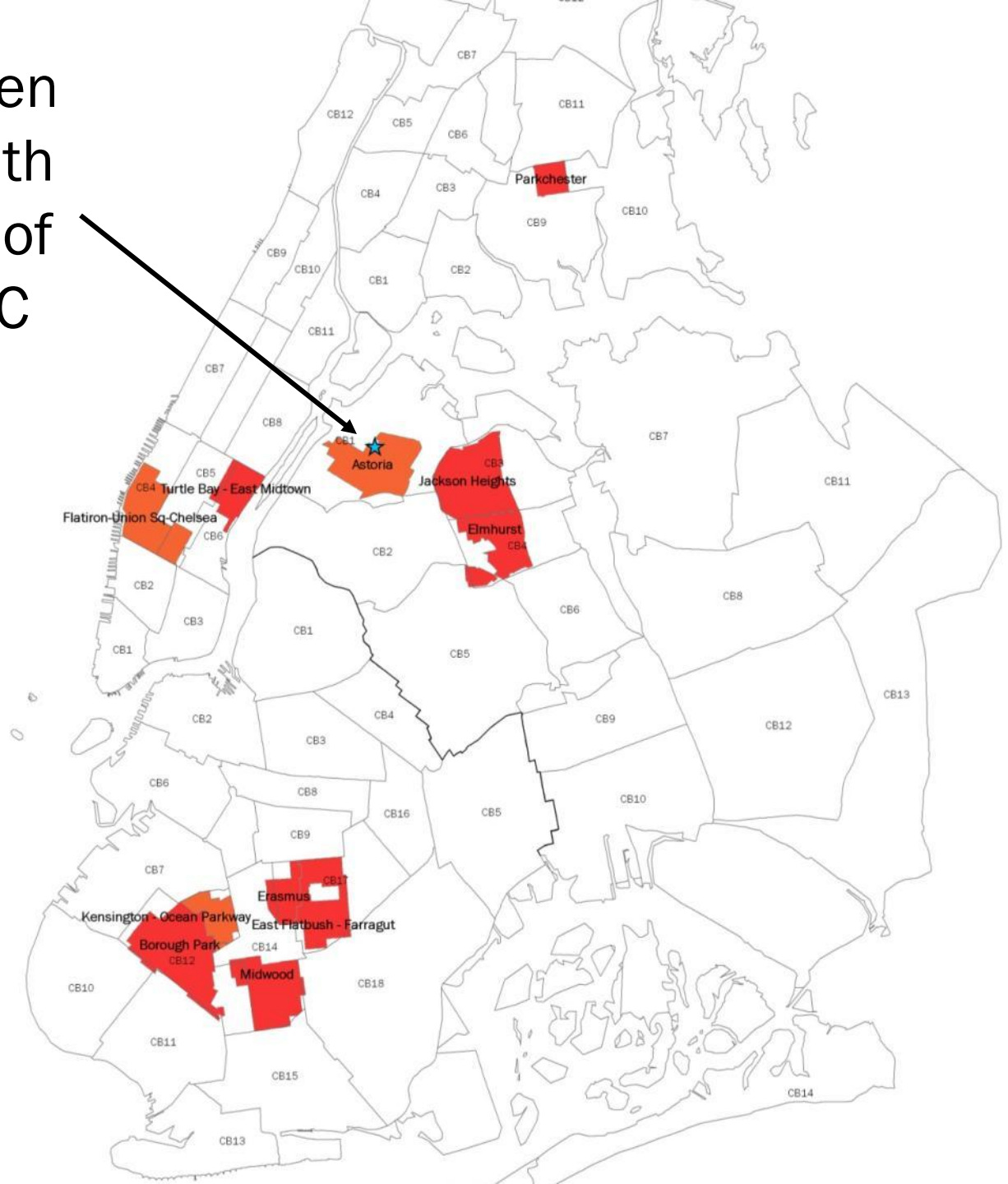

Open Space Needs  
Dept. of Parks & Recreation Data

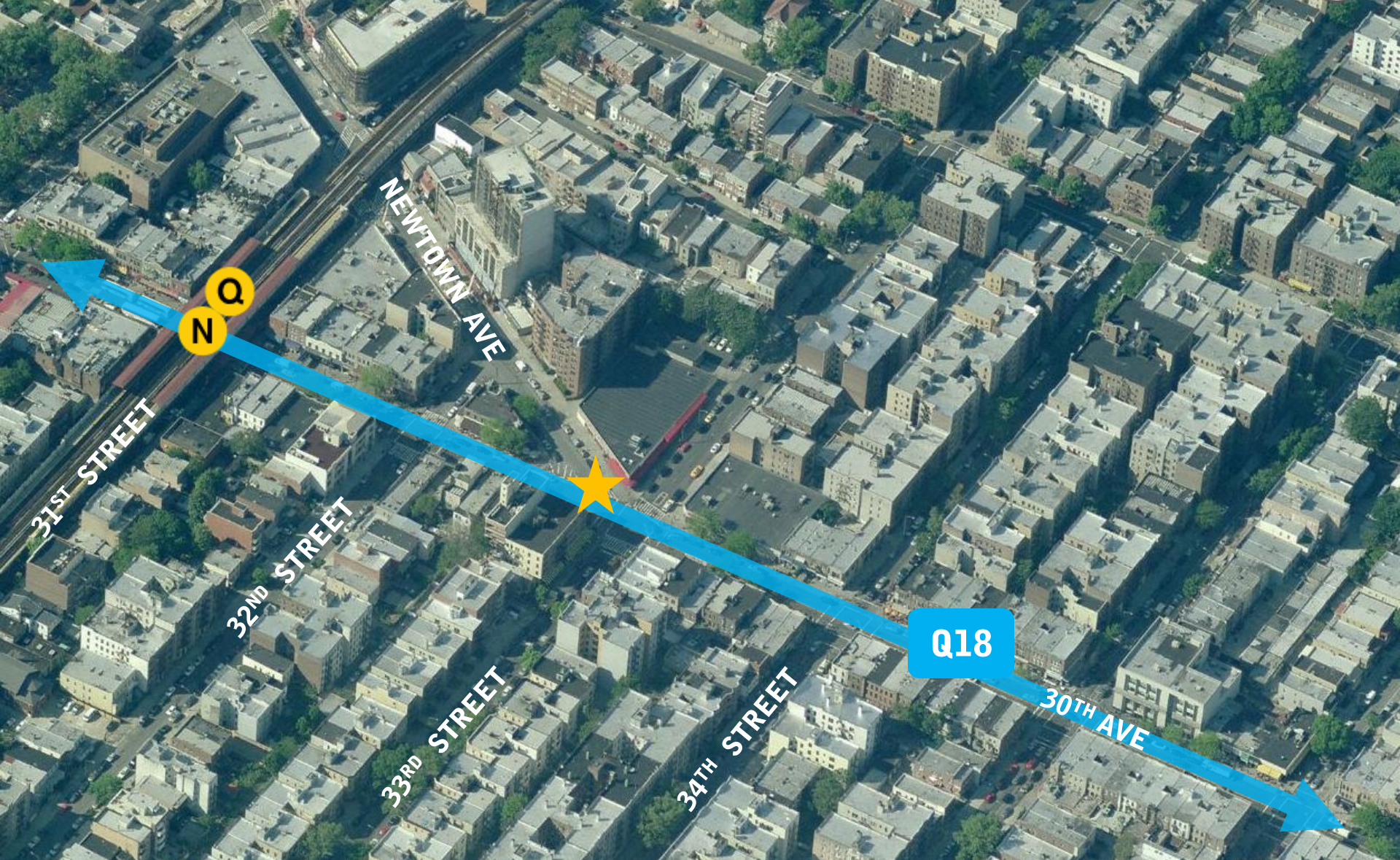

## 30th Ave

Well-served transportation corridor with 13,774 subway riders on an avg. weekday



## Active & Busy Retail Corridor

30<sup>th</sup> Ave shopping & food



## Active & Busy Retail Corridor

30<sup>th</sup> Ave shopping & food



## Active & Busy Retail Corridor

30<sup>th</sup> Ave shopping & food



Active & Busy Retail Corridor

30<sup>th</sup> Ave shopping & food



## Land Use Map



**Land Use Map**

Legend:

- Institutions
- Transportation/Utility
- Open Space
- Residential
- Commercial
- Mixed Use
- Government
- Industrial
- Hotel
- Water





People like open space

Flatiron Plaza adjacent to Madison Square Park. March 13, 2012



Assistance for  
Business & Residents

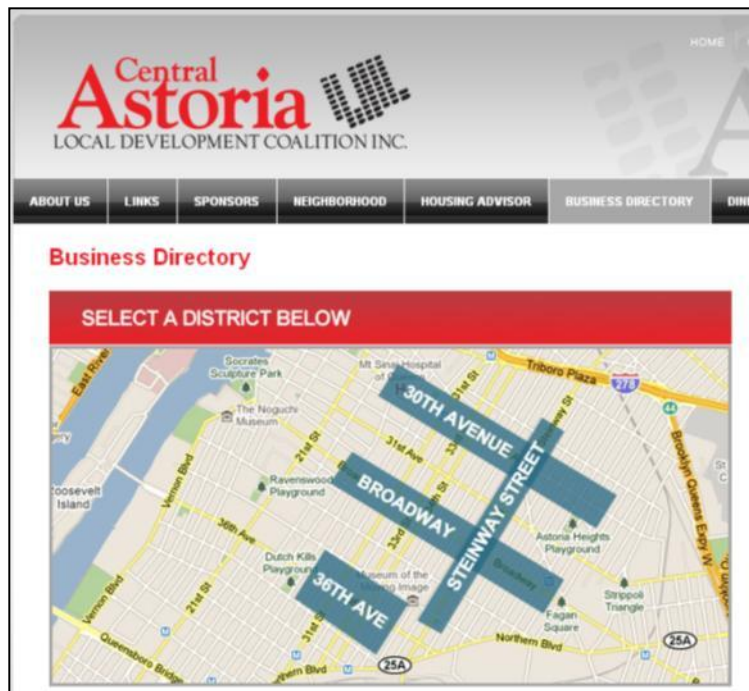

## Cultural Events: Independence Celebration 2011



The Central Astoria Local Development Coalition founded in 1979 is a nonprofit community organization dedicated to preserving and enhancing the neighborhood of Astoria as a vibrant, affordable, harmonious and desirable community in which to live, work, and do business.

A Plaza Partner based in the Community  
Central Astoria Local Development Coalition

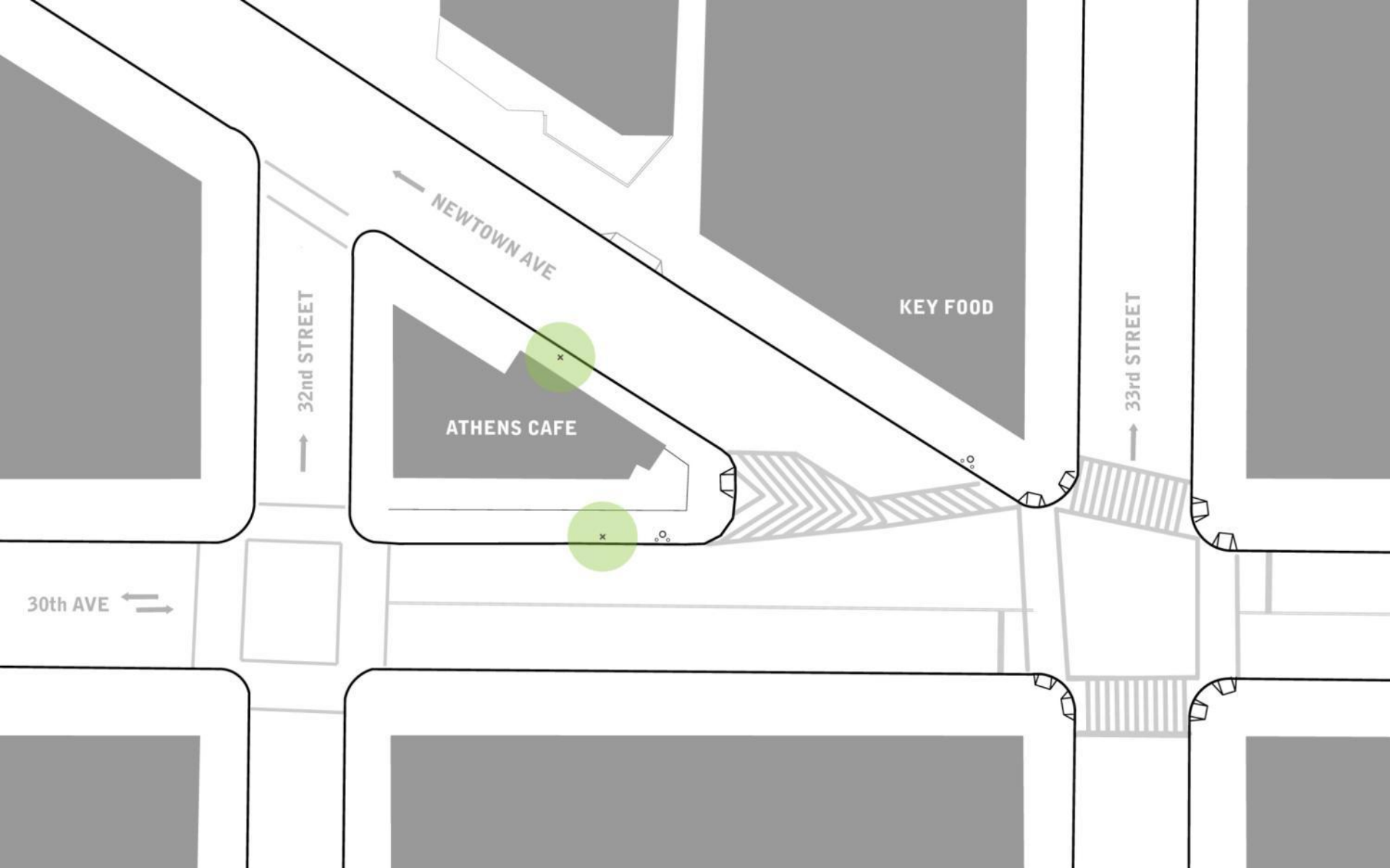

Newtown Ave  
Existing intersection



## Newtown Ave

Public Plaza Proposal that could be built as early as summer 2012 with an approx. cost of \$75,000

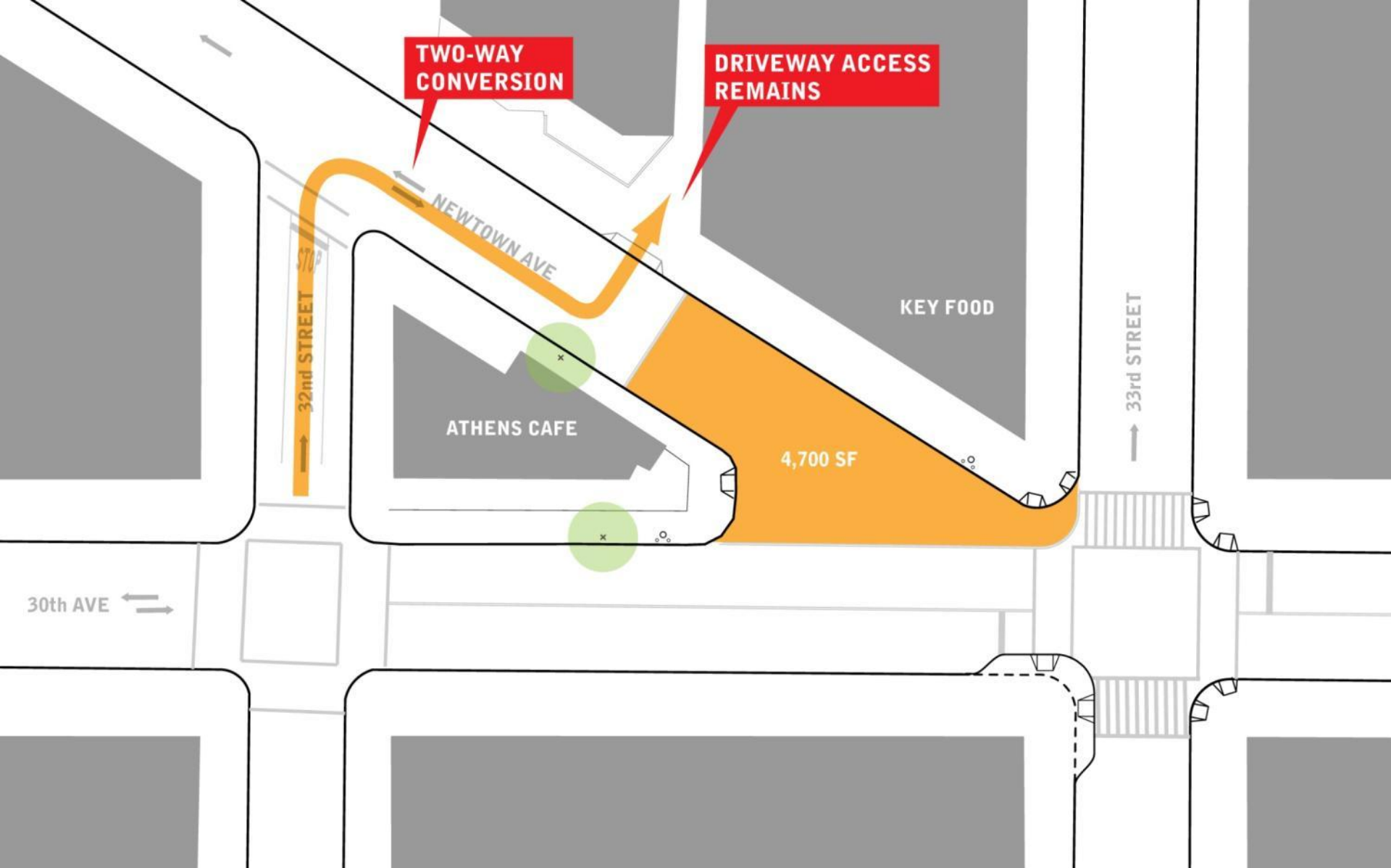

## Newtown Ave

Two-way conversion to maintain driveway access

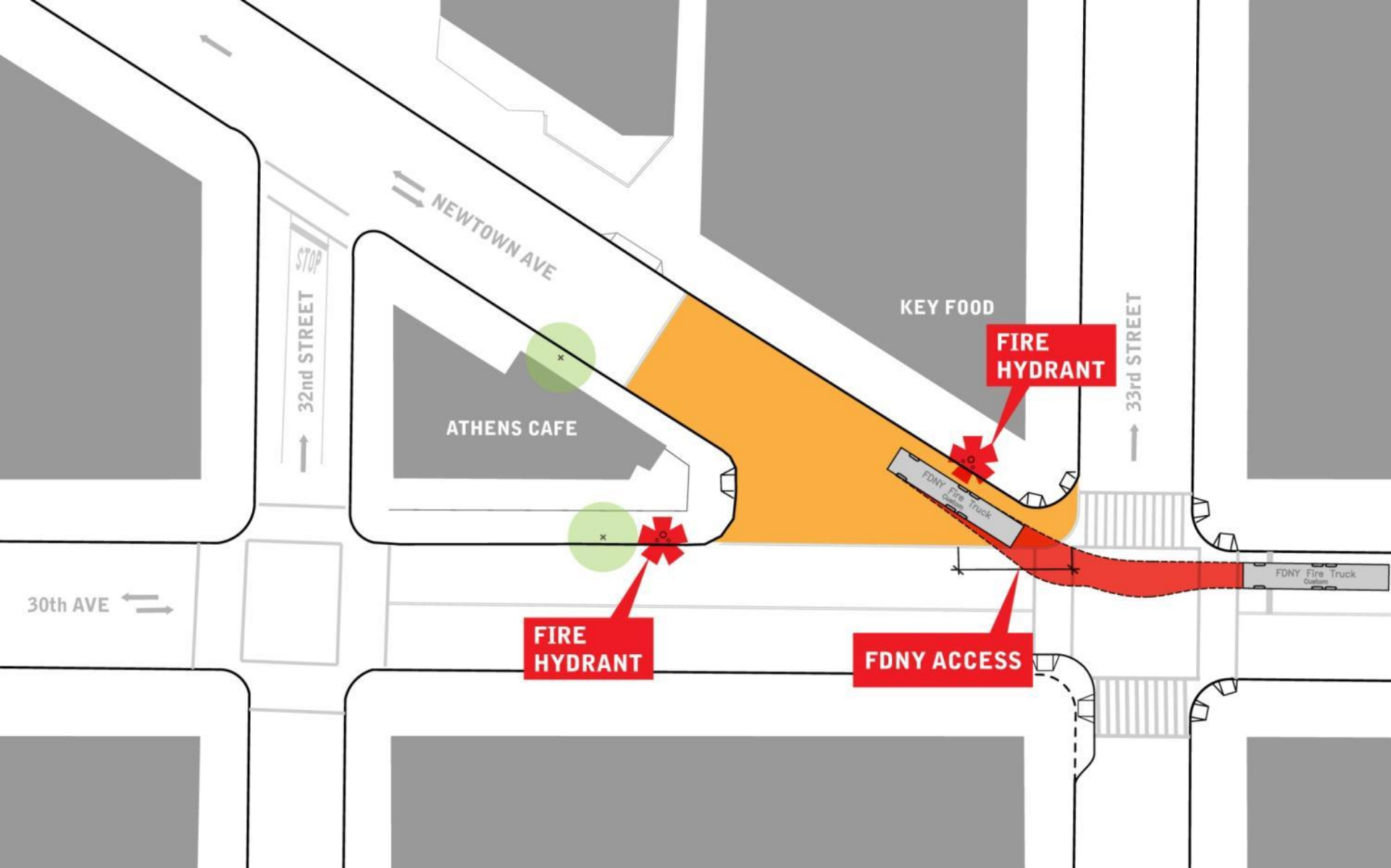

## Emergency Access

Maintain emergency access to hydrants and through the plaza

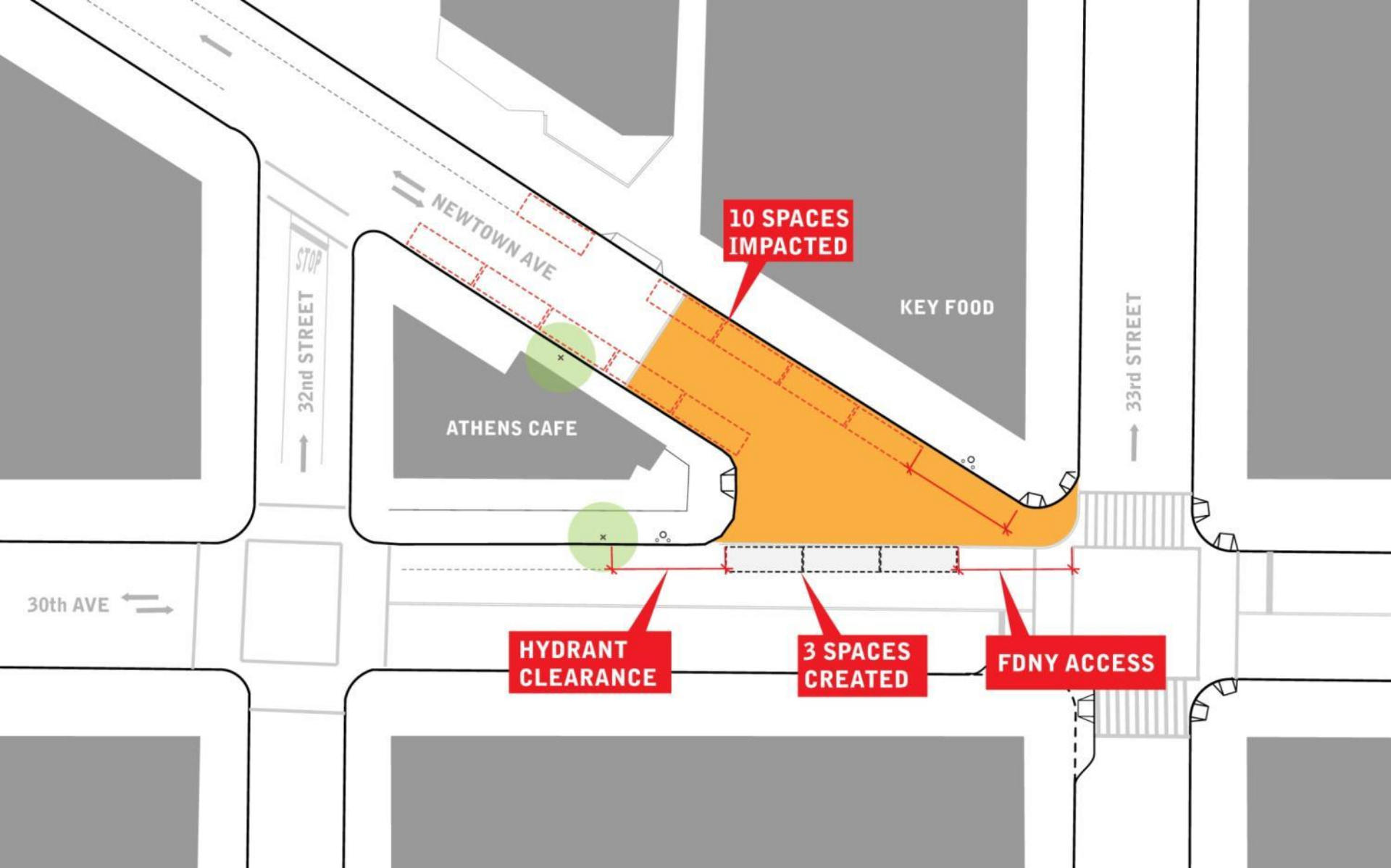

## Parking Impacts

Net loss of 7 parking spaces

# SURVEY QUESTIONS:

How did you get here today?

How long have you lived in the area?

What's your zip code?

**SURVEY TIMES:** Thursday, 5/26 AM & PM - Tuesday, 5/29 AM - Saturday 6/2 AM

Hi! I'm [redacted] from NYCDOT and I'm conducting a short survey of shoppers' habits here on Newtown Ave. three questions and will take 30 seconds – would you mind participating?



1. How did you get here today? Circle how you got here or specify if other / Other				2. How long have you lived in the area? Number of years/months	3. Your Zipcode? Enter zipcode
1	Foot	Livery or private car	Subway/Bus	20 years	11368
2	Foot	Livery or private car	Subway/Bus	45 years	11102
3	Foot	Livery or private car	Subway/Bus	10 years	11103
4	Foot	Livery or private car	Subway/Bus	14 years	11103
5	Foot	Livery or private car	Subway/Bus	10 years	11102
6	Foot	Livery or private car	Subway/Bus	15 years	11102
7	Foot	Livery or private car	Subway/Bus	20 years	11103
8	Foot	Livery or private car	Subway/Bus	30 years	11102
9	Foot	Livery or private car	Subway/Bus	50 years	11103
10	Foot	Livery or private car	Subway/Bus	12 years	11103
11	Foot	Livery or private car	Subway/Bus	9 months	11102
12	Foot	Livery or private car	Subway/Bus	2 years	11102
13	Foot	Livery or private car	Subway/Bus	4 years	11106
14	Foot	Livery or private car	Subway/Bus	3 years	11102
15	Foot	Livery or private car	Subway/Bus	10 years	11102

Key Food Shopper Survey



**98**  
SHOPPER  
RESPONSES

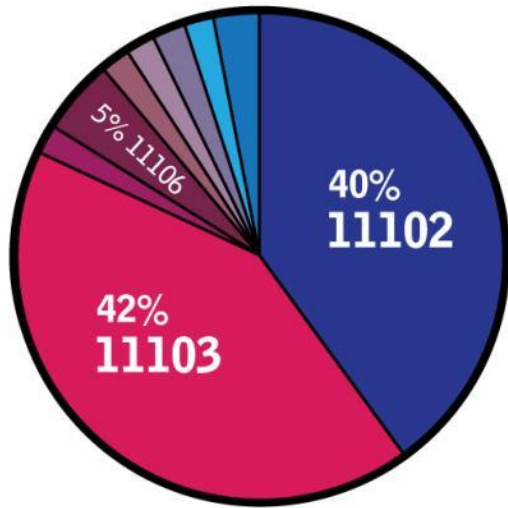

**82%** of shoppers are  
from the immediate area

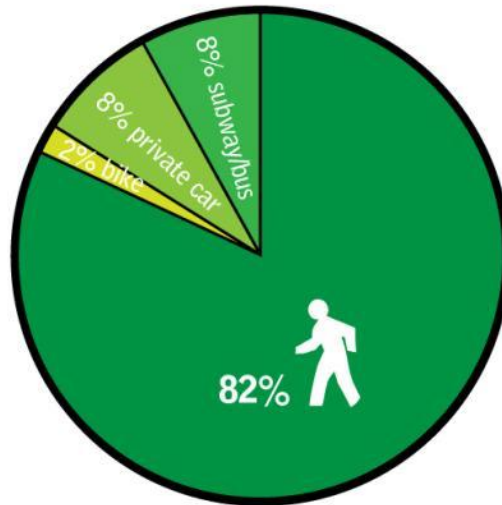

**8%** of shoppers  
arrive by car

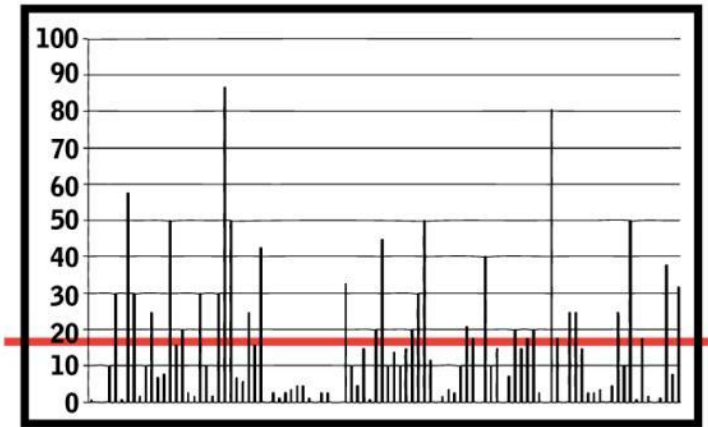

avg. **16** YEARS shoppers  
have lived in neighborhood

Key Food Survey Results



# Vehicle Peak

At the peak there are 166 vehicles using Newtown Ave in an hour

## STREET CLOSURE

## PEAK # OF VEHICLES / HOUR

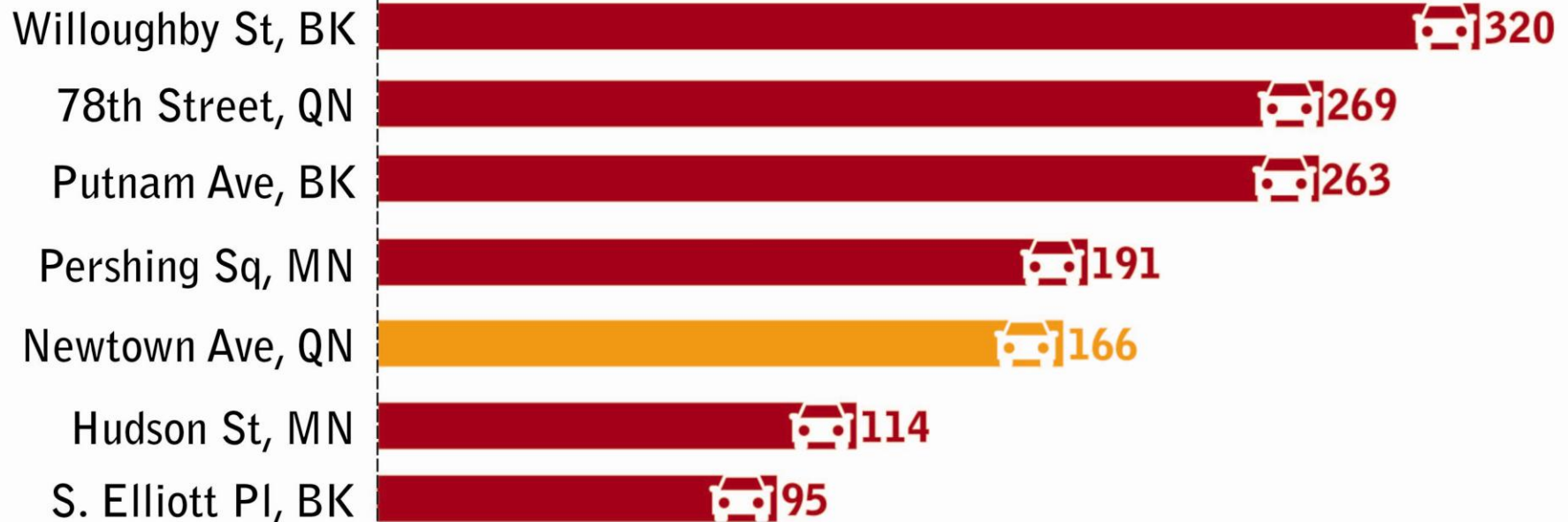

### Traffic Network Impacts

Low volumes compared to other plaza project street closures

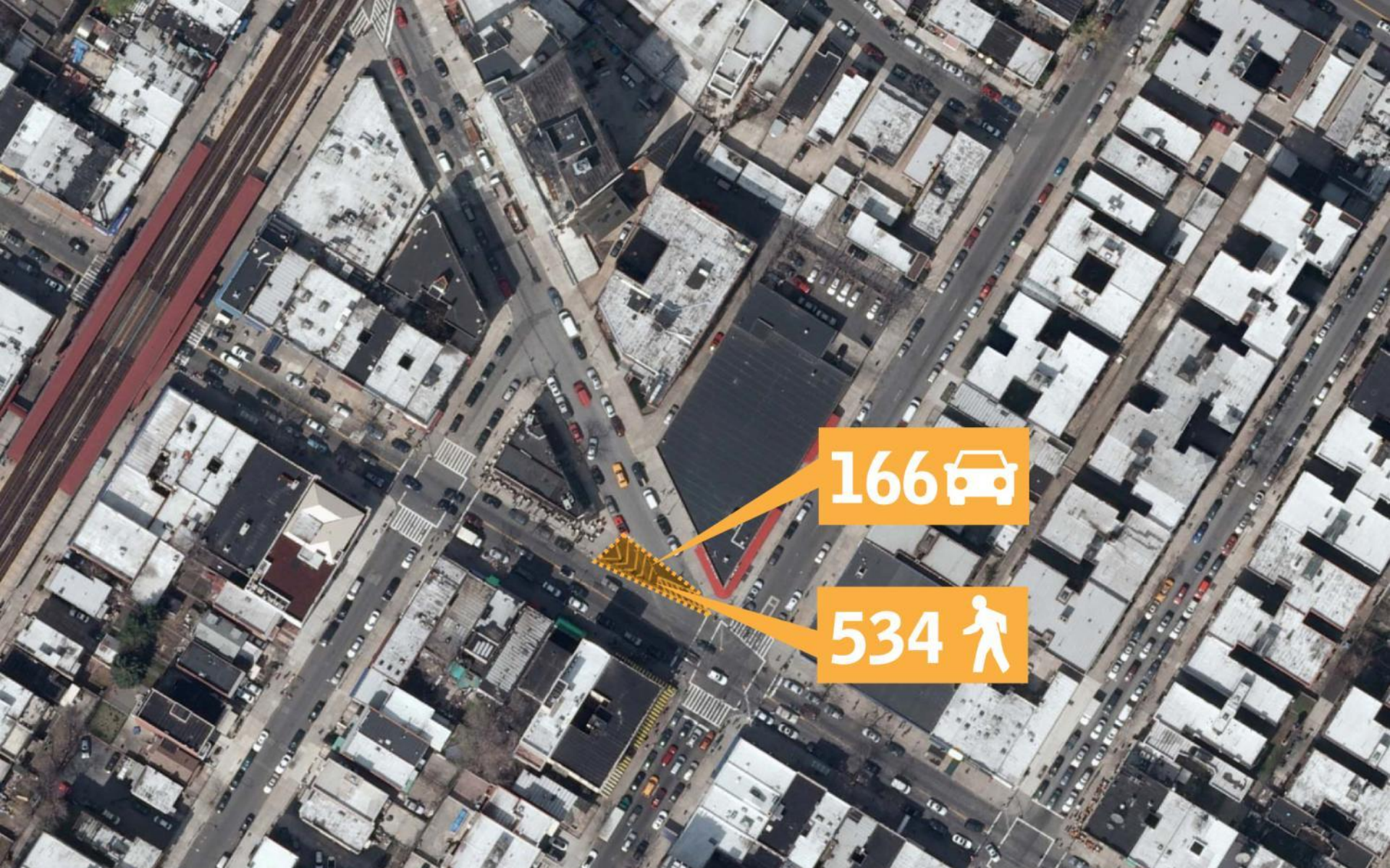

## Pedestrian Peak

At the peak there are 534 pedestrians crossing Newtown Ave in an hour



## Pedestrian Traffic

People outnumber cars 4:1 at this intersection





Newtown Ave: What happens if we close the street?

Between 32<sup>nd</sup> & 33<sup>rd</sup> Street

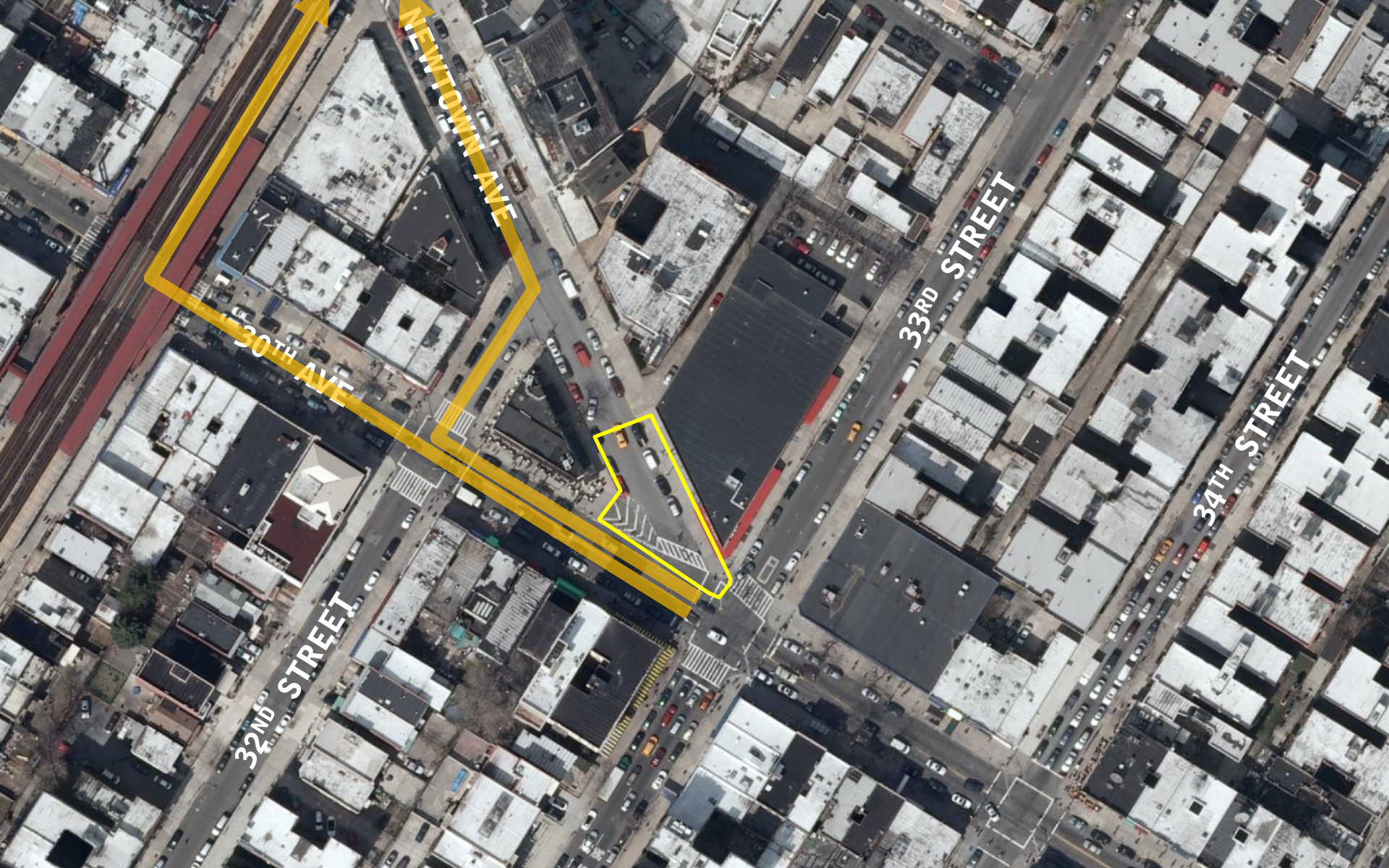

## Newtown Ave: Alternate Routes

Northbound to 31<sup>st</sup> Street & Newtown Ave

# Newtown GPS Car Runs

## Collected on Saturday, June 2, 2012

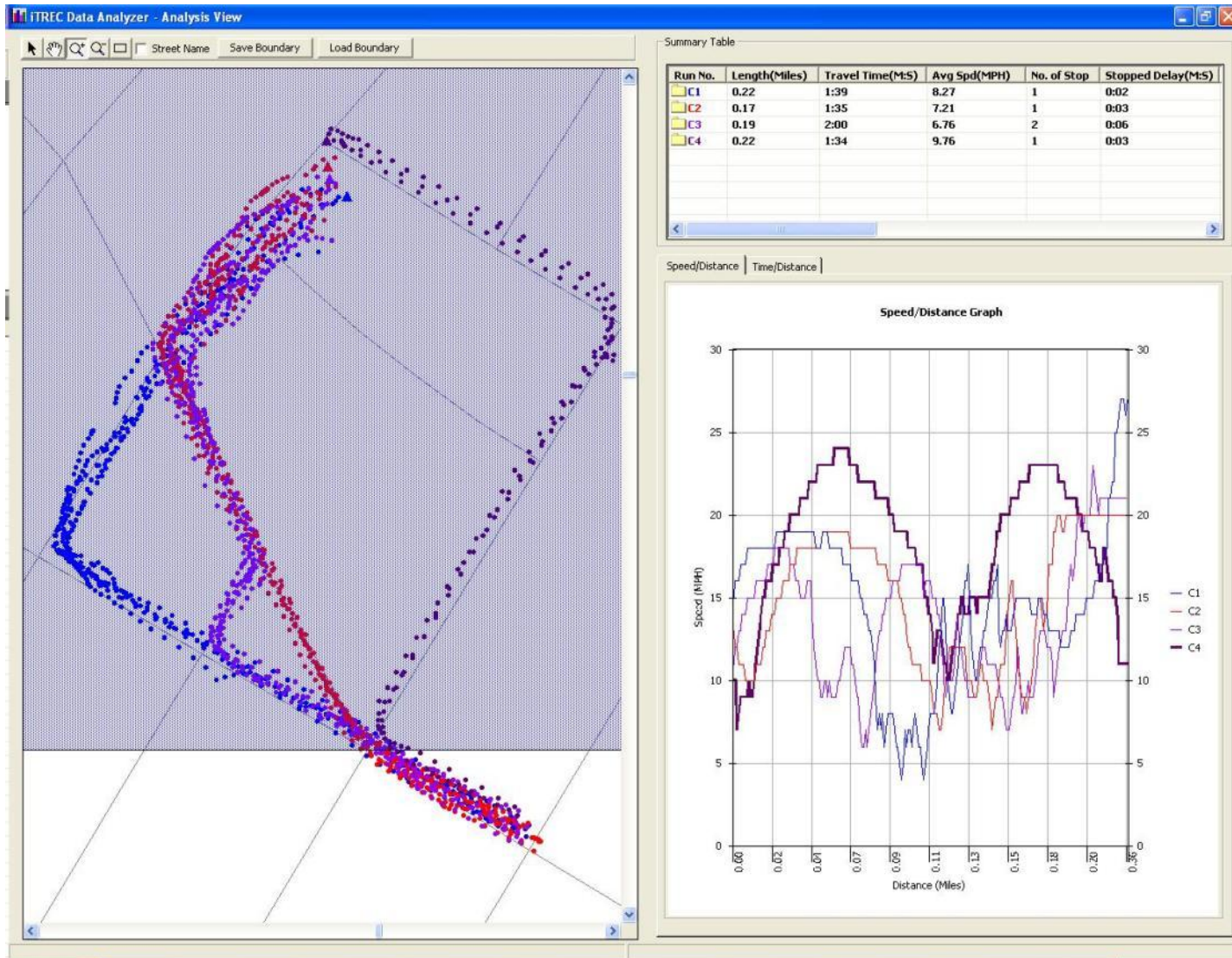

SATURDAY MIDDAY

Finish

7.43 MPH; 1.22 Min

8.78 MPH; 1.08 Min

9.60 MPH; 0.49 Min

Newtown Ave is fastest.

Start

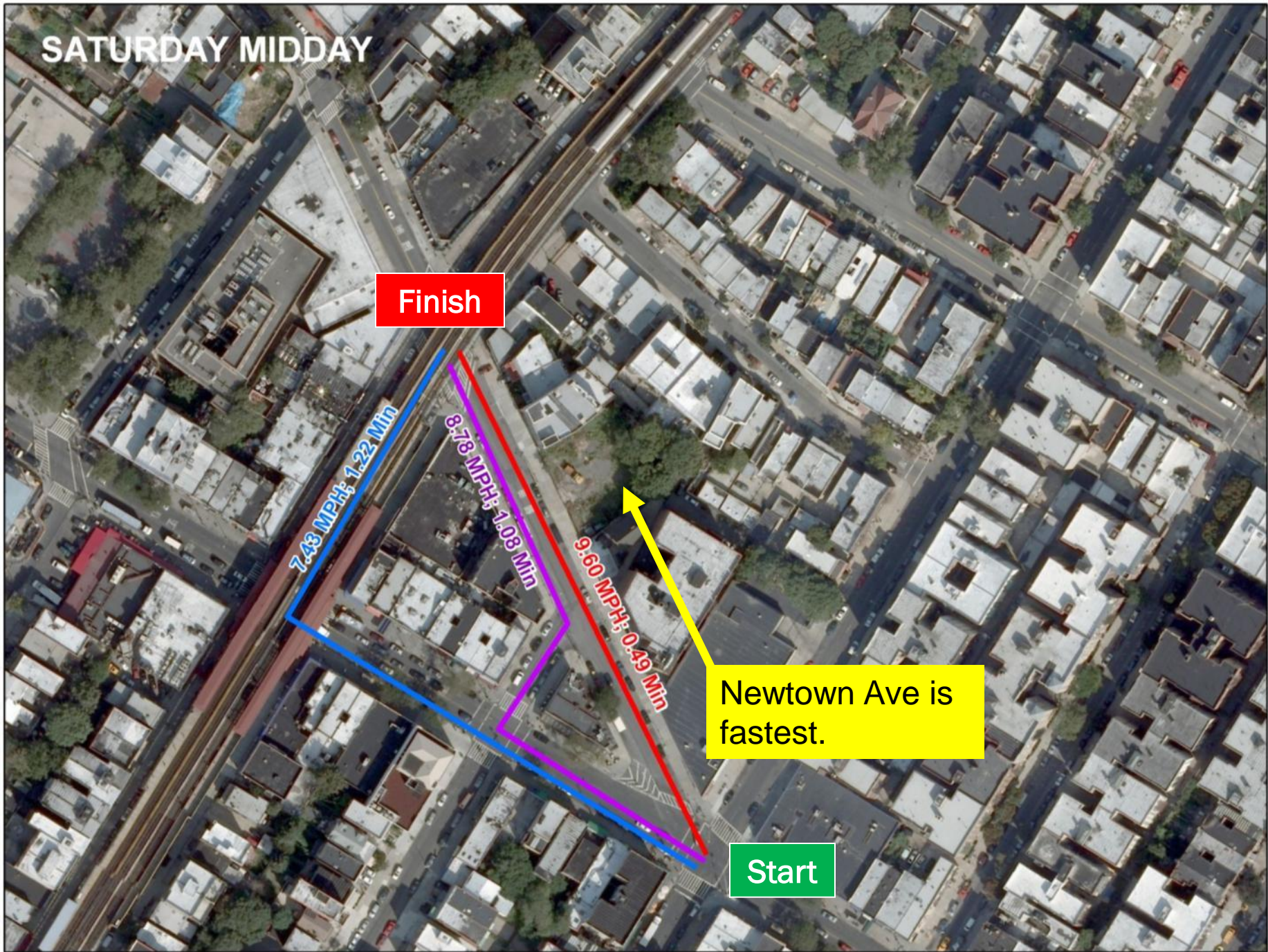

SATURDAY MIDDAY

Finish

9.76 MPH; 1.31 Min

8.27 MPH; 1.37 Min

6.76 MPH; 1.34 Min

7.21 MPH; 1.32 Min

33<sup>rd</sup> St to 28<sup>th</sup> Ave  
is fastest

Start



# Plaza Toolkit

- Paint
- Gravel
- Moveable tables/chairs
- Umbrellas
- Permanent benches
- Bike parking
- Planters
- Granite blocks – informal seating
- Street lighting
- Signage – parking regulations
- Concrete
- Pavement markings





**Tool Kit**  
Bogardus Plaza at Hudson Street





**PLANTERS**

**EPOXY  
GRAVEL**

**GRANITE  
BLOCK**

**MOVABLE  
TABLES &  
CHAIRS**

Tool Kit

Union Square North at Broadway & 17th Street

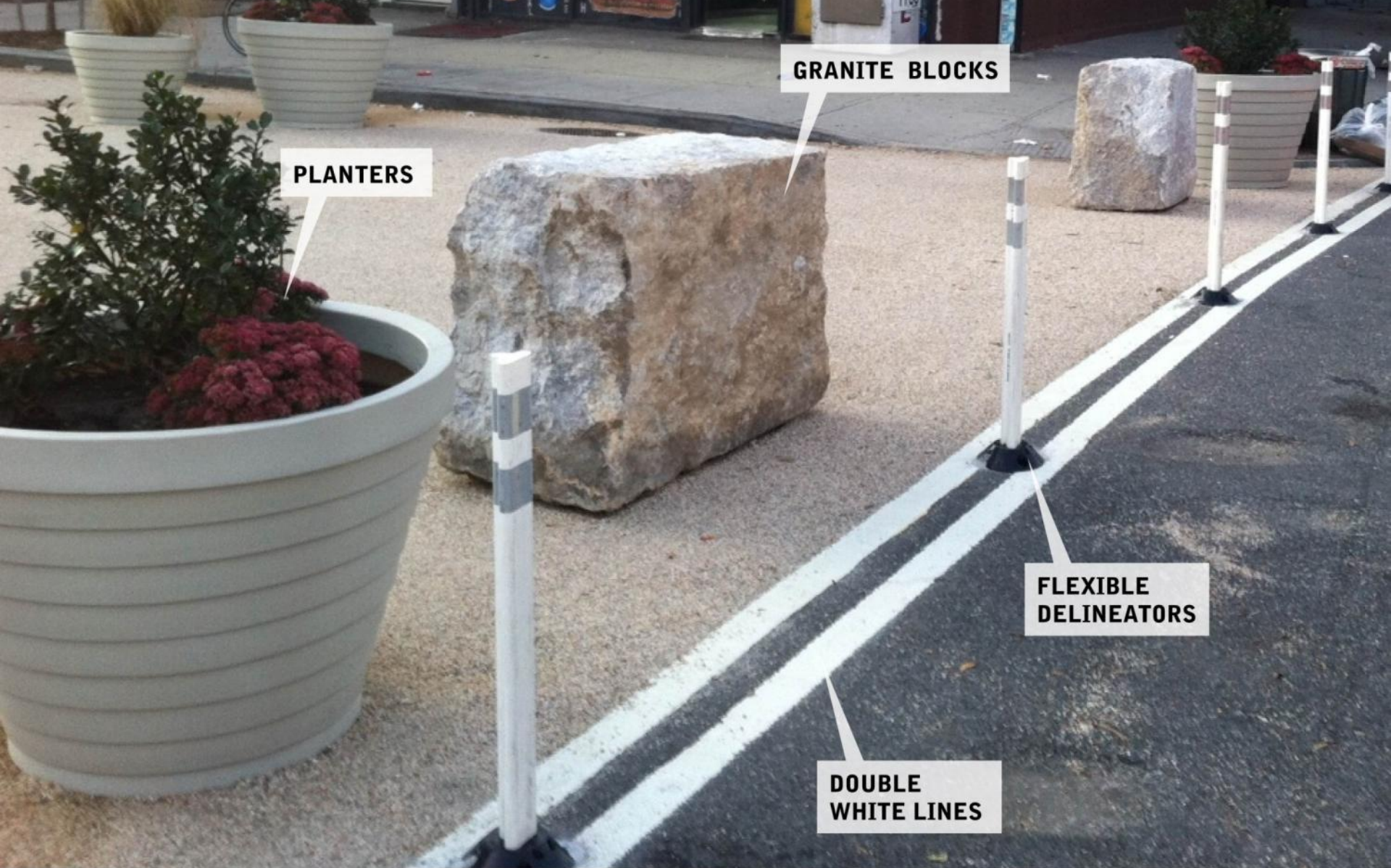

## Tool Kit

Putnam Plaza in Clinton Hill, Brooklyn



Permanent seating:  
NYC DOT CityBench



Bike parking: NYC Bike Rack





## Tool Kit

Umbrellas at Chelsea & Flatiron Plazas



## Plaza Maintenance

Central Astoria would be responsible for plaza maintenance.



## Full access to the public

Plaza is public, DOT property & amenities are non-exclusive. Anyone can apply to hold an event in the plaza, [www.nyc.gov/sapo](http://www.nyc.gov/sapo)

# Programming

Launch Day Event

Recurring Small-Scale Events

Annual Events

Markets



# Public Art

DOT Temporary Art Program  
Permanent Artworks



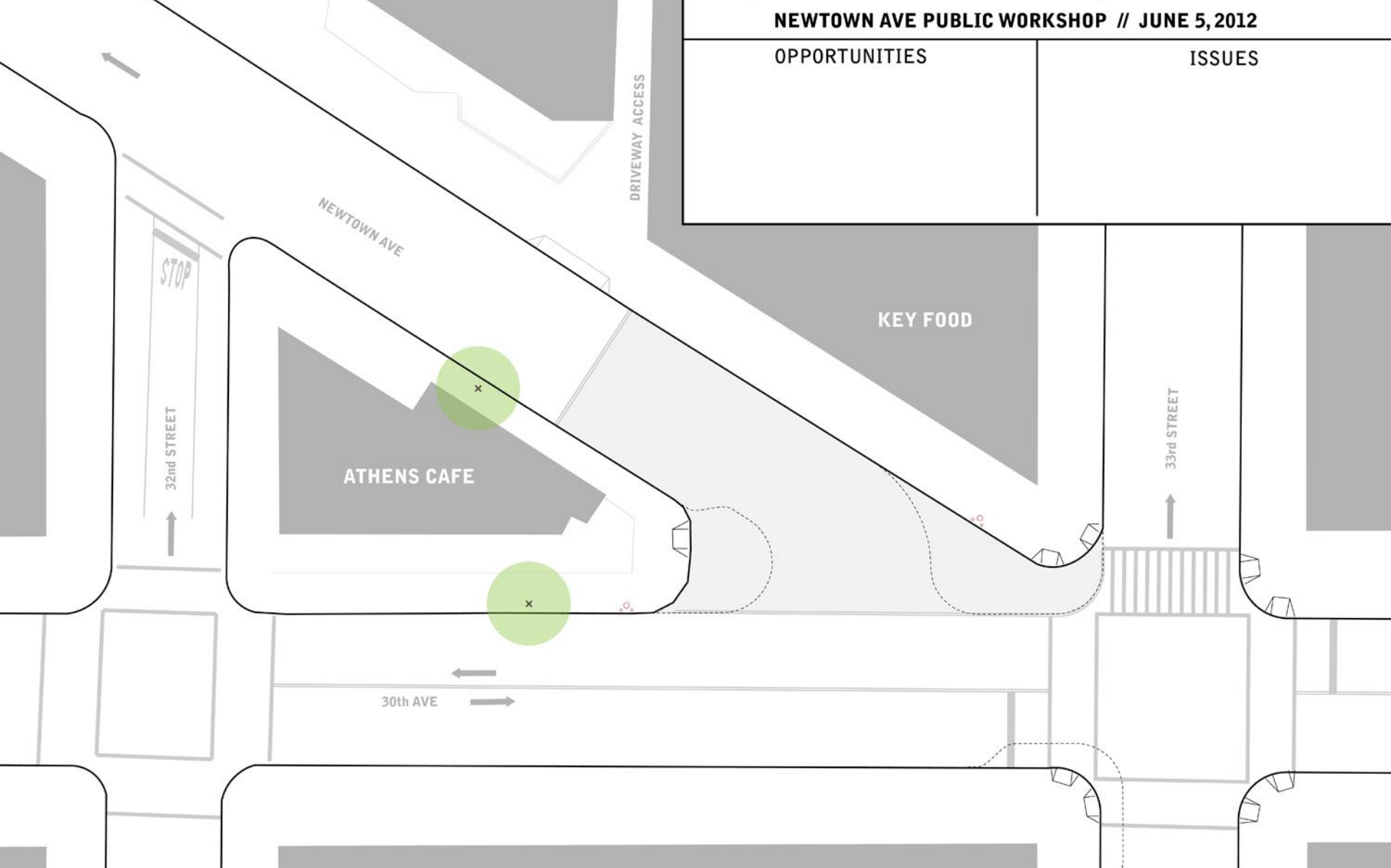

Options for the community: School Safety traffic calming or a pedestrian plaza

We want to hear your thoughts on the opportunities & issues on Newtown Ave.

# NEXT STEPS

Gather Workshop Feedback

Present findings to CB Trans. Committee

Present a proposal to CB Full Board on 6/19

Log In

☐ Keep me logged in[Forgot your password?](#)**Newtown Ave**

32 likes · 8 talking about this · 2 were here

Like

Public Places

32-71 Newtown Ave, Queens, NY.

1 (212) 839-4325

Always open

About



Photos

32

Likes



Map



Events

Highlights ▾



Post



Photo / Video

Write something...

**Newtown Ave**

May 30

Also On

<http://www.nyc.gov/plazas> ➔

Likes

Community Engagement: [www.Facebook.com/NewtownAve](http://www.Facebook.com/NewtownAve)

DOT Facebook page