

# South End Avenue

## Pedestrian Safety Improvements

July  
2014



Commissioner Polly Trottenberg, New York City Department of Transportation  
Presented by the Pedestrian Projects Group, June 3, 2014 to Community Board 1 Battery Park City Committee



# Existing Conditions

## Community request for:

- Traffic calming along South End Ave
- Safer, easier crossings especially along West Thames
- Reduced double parking



# Existing Conditions

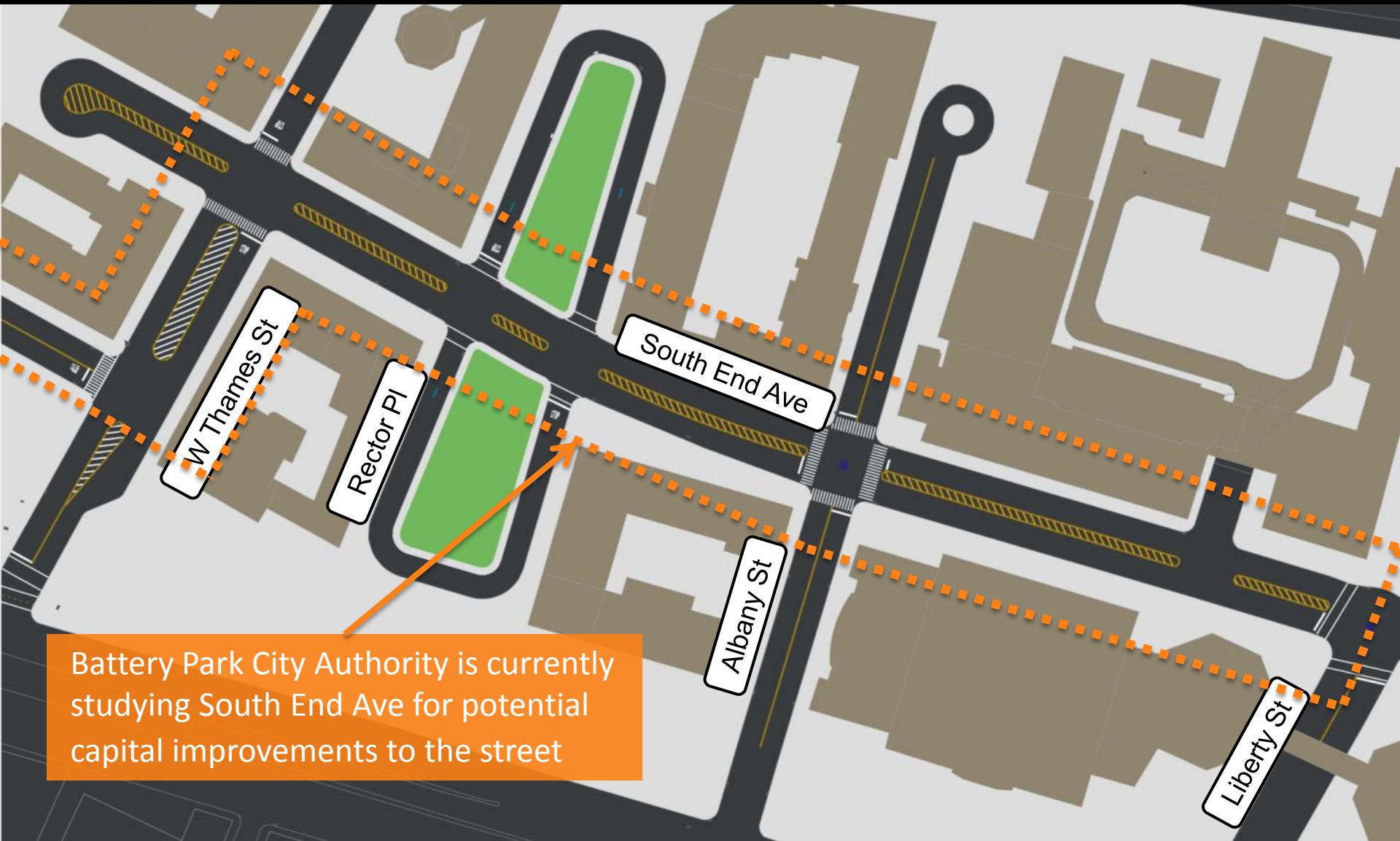

Battery Park City Authority is currently studying South End Ave for potential capital improvements to the street

# Proposed Plan

Wide parking lane lines visually narrow the street, reinforce the moving lane, and provide bicycles a safe place to ride

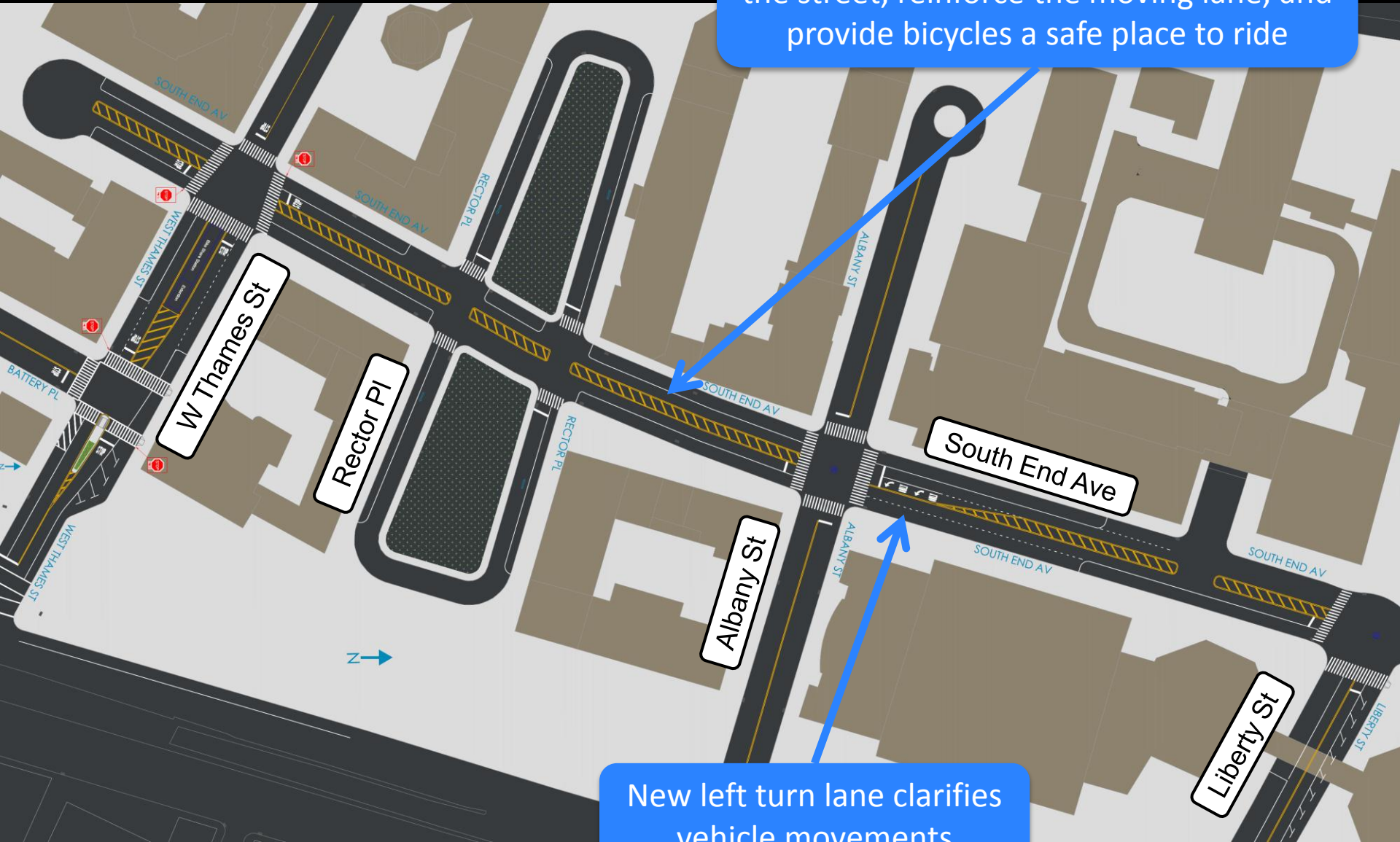

New left turn lane clarifies vehicle movements



# Proposed Plan

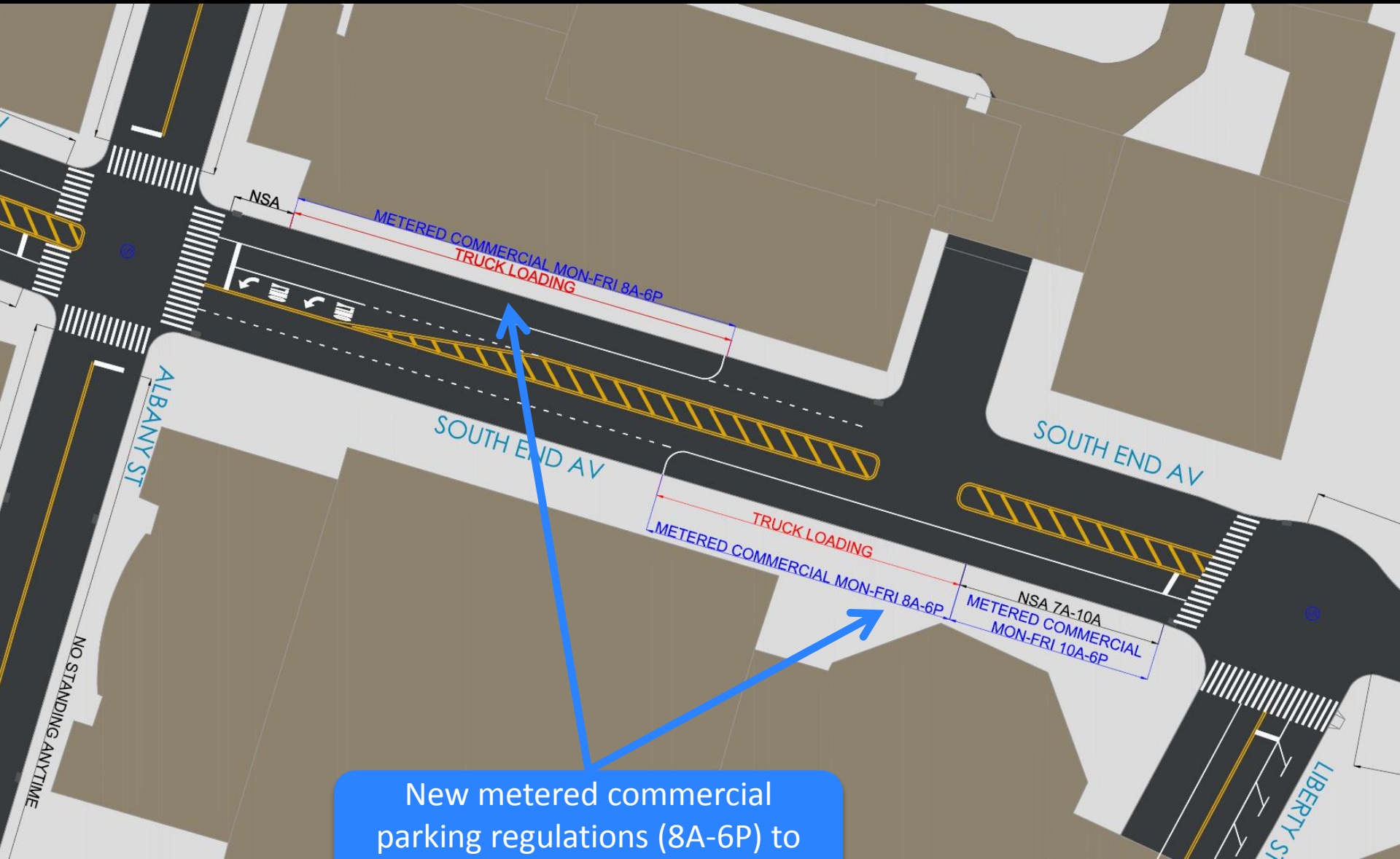

New metered commercial parking regulations (8A-6P) to increase parking turnover

# Proposed Improvements

## Proposed Improvements:

- All-way stop control on West Thames St at South End Ave and Battery Pl with new high visibility crosswalks
- Concrete island at West Thames St and Battery Pl
- Wide parking lane lines on South End Ave
- Left turn bay on South End Ave at Albany St
- Commercial metered parking on South End Ave between Albany St and Liberty St

## Expected Benefits:

- Calm traffic and clarify vehicle movements
- Safer crossings
- Reduced double parking
- Improved biking conditions



[nyc.gov/dot](https://nyc.gov/dot)

**Thank  
You**