

Jackson Avenue and Westchester Avenue



2015

Project Extent



2

5



Existing Conditions



Bus riders wait in moving lane
for bus under elevated train

View North

Existing Conditions



Vehicle movements
unpredictable

View Southwest

Existing Conditions

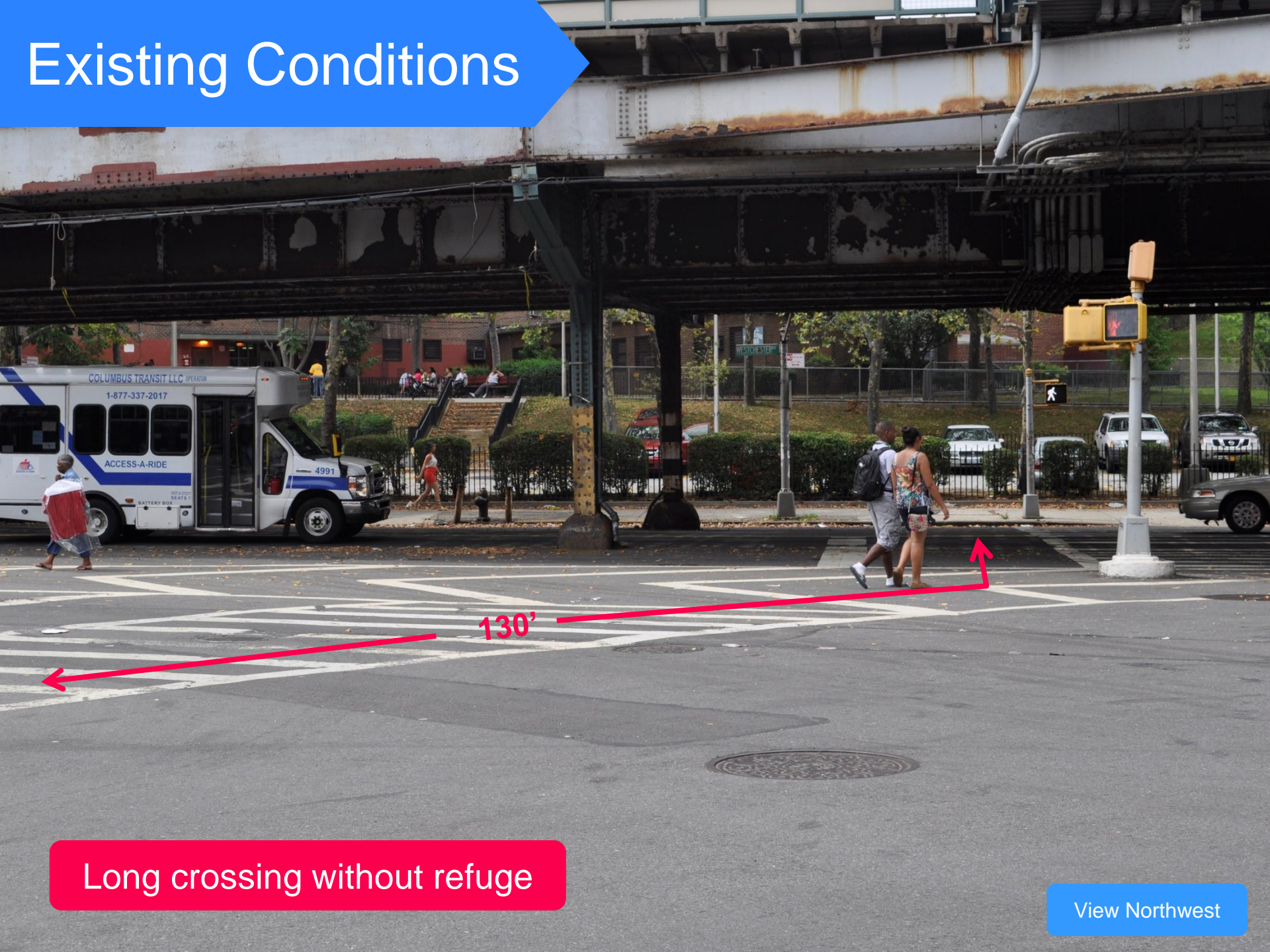

Long crossing without refuge

View Northwest

Existing Conditions

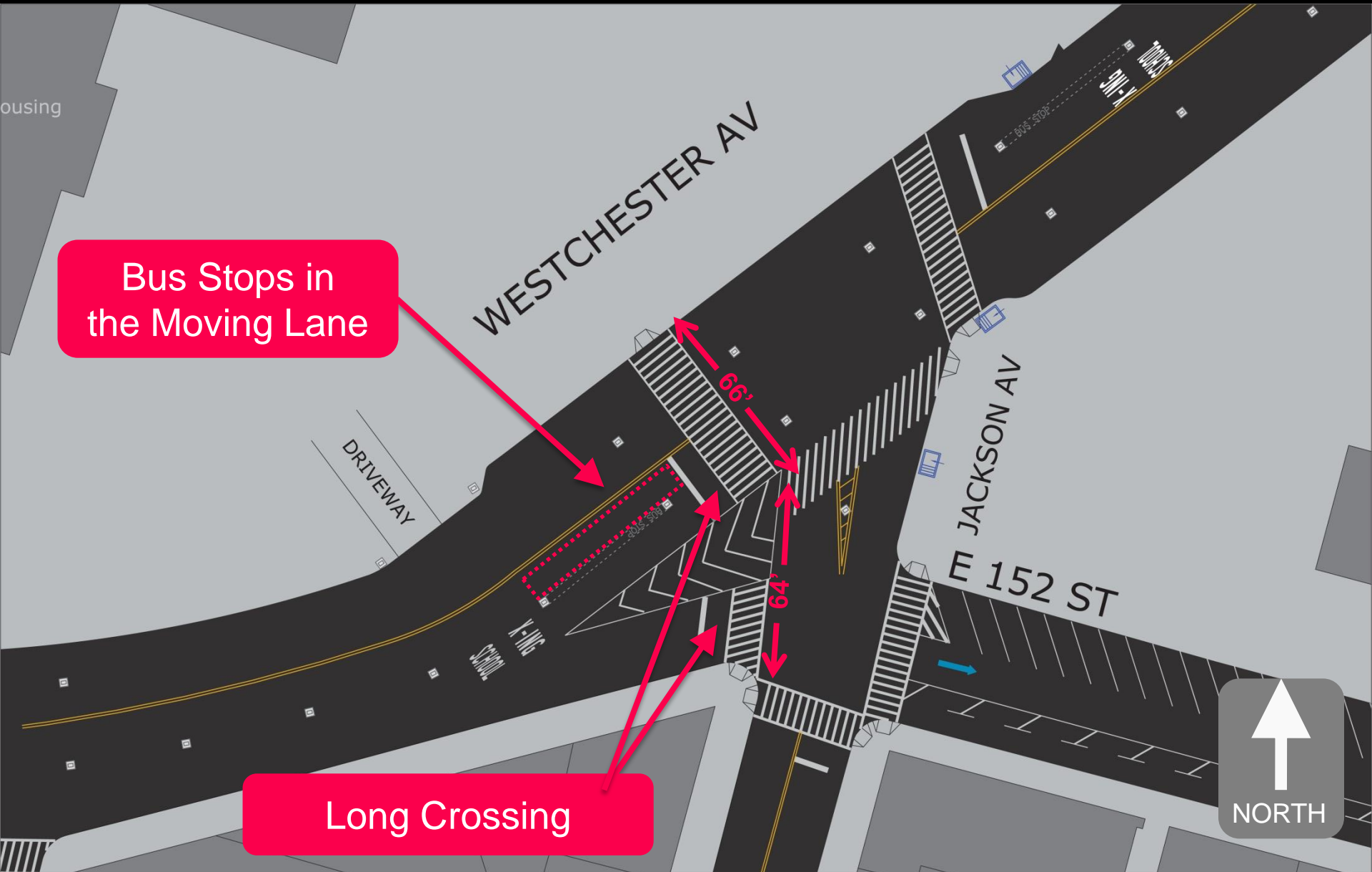

Proposal

Improvements :

Construct concrete triangle for bus stop on south side of Westchester Ave

Protects people waiting for the bus

Shorter, two-part crossing

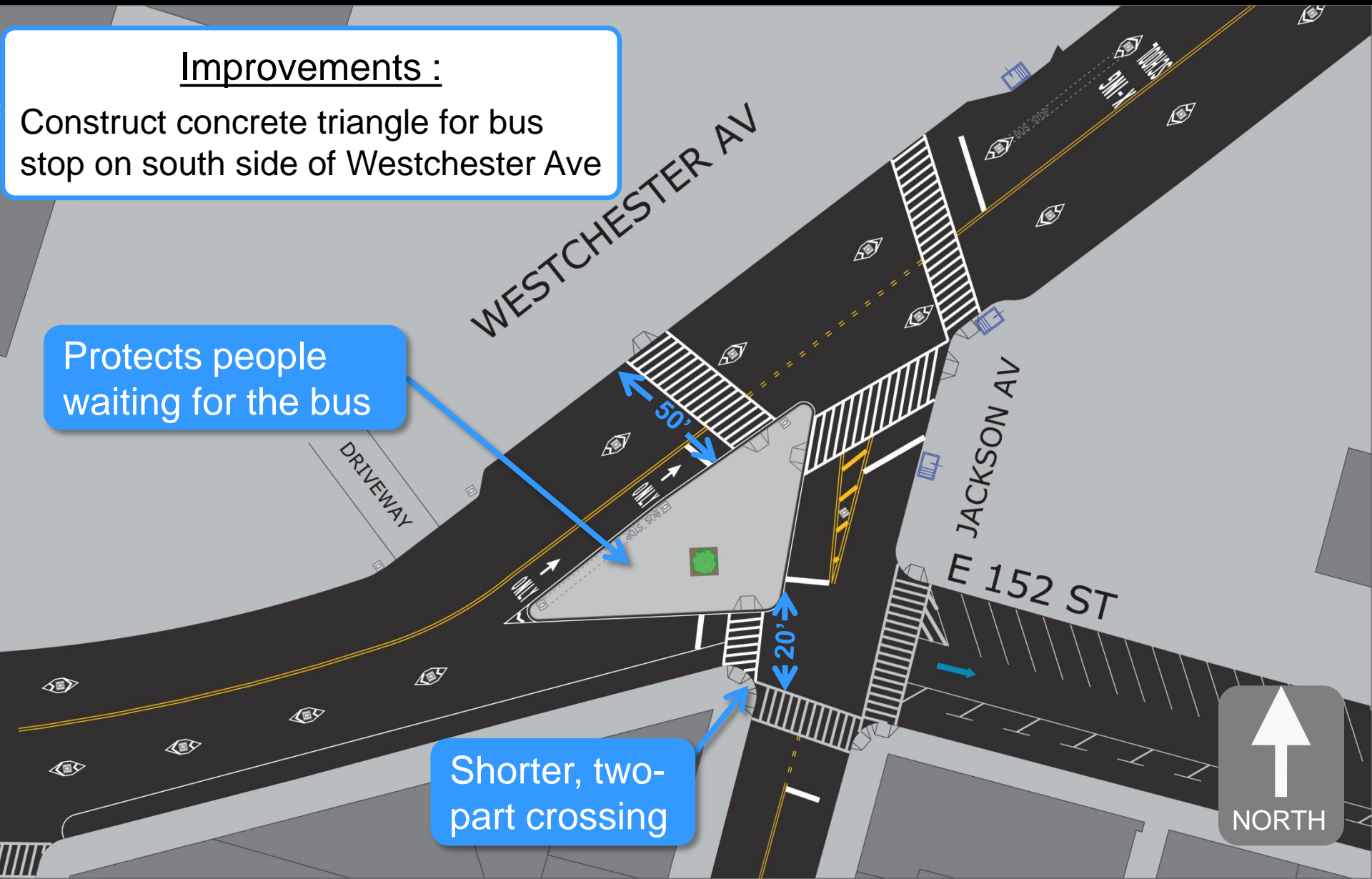

Expected Benefits

- Organized vehicle movements
- Shorter, safer pedestrian crossings
- Increased pedestrian space
- Improved ADA bus stop access



www.nyc.gov/dot

Thank
You

