

# Broadway, Jefferson Ave, and Saratoga Ave

## Intersection Safety Improvements

2015





# Project Area



Cornelia St

Jefferson Ave

Hancock Ave

Broadway

Jefferson Ave

Hancock St

Saratoga Ave

Halsey St

J



# Existing Conditions

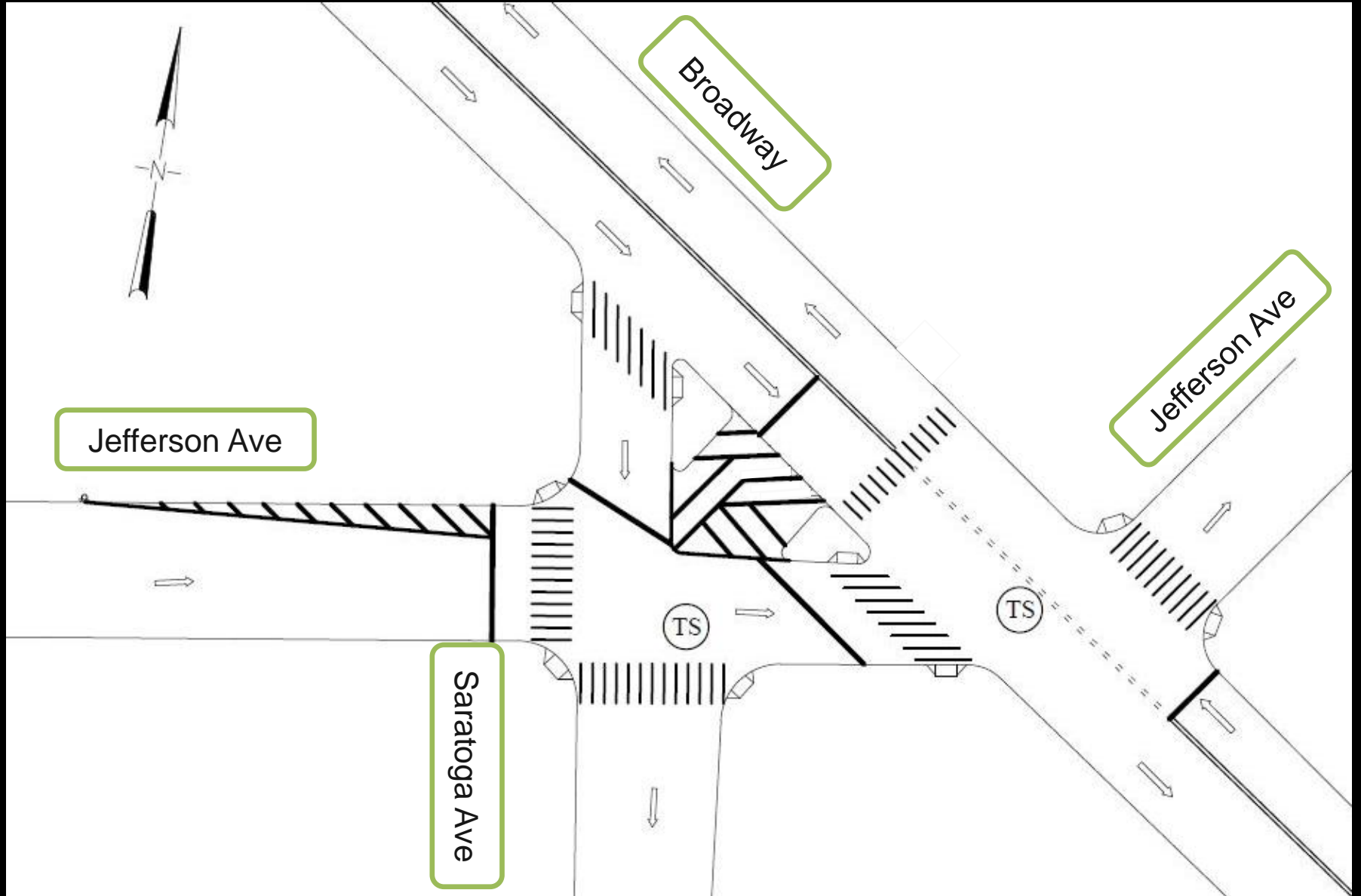

# Existing Issues



## Issues:

Channelized area between two small islands creates confusing and unattractive environment for pedestrians

Existing crosswalk has no pedestrian ramps and leads into subway support pole

# Existing Issues

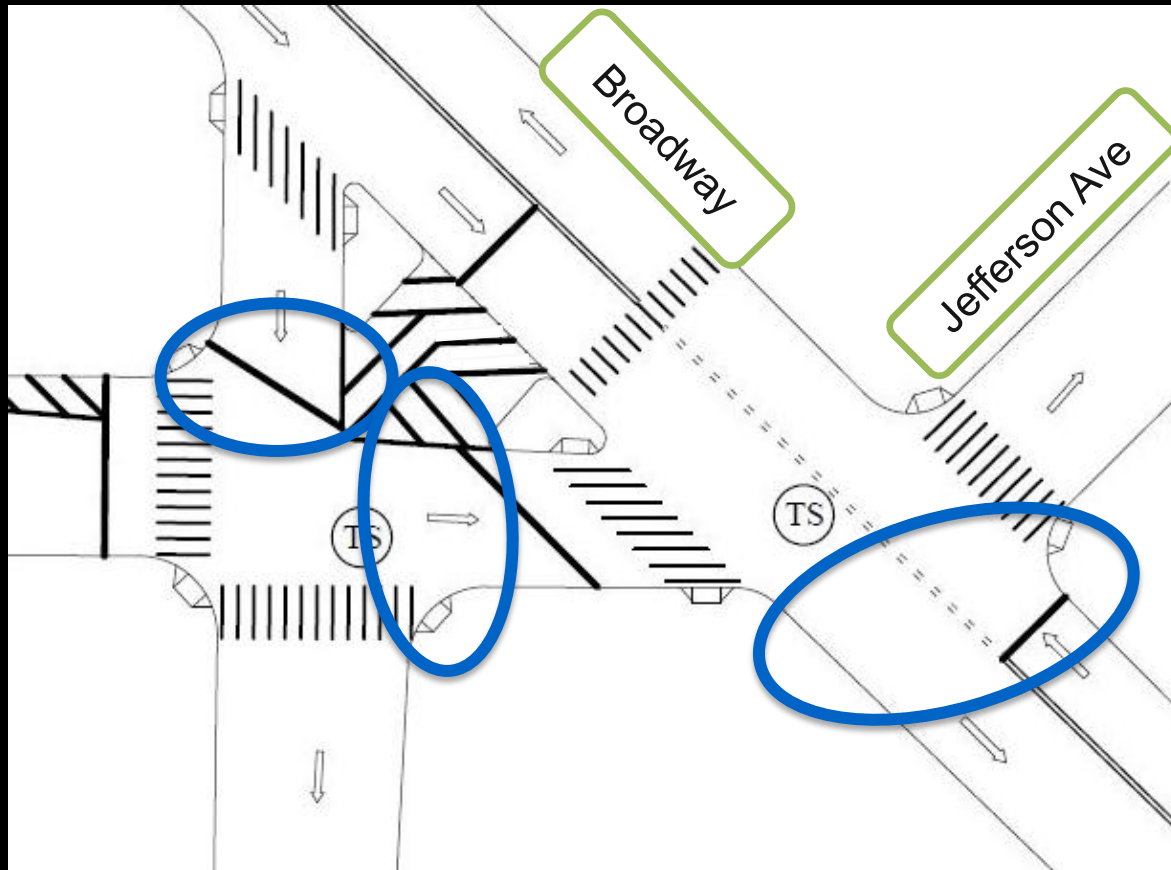

**Issue:**

Lack of crosswalks at desirable locations for pedestrians

# Existing Issues

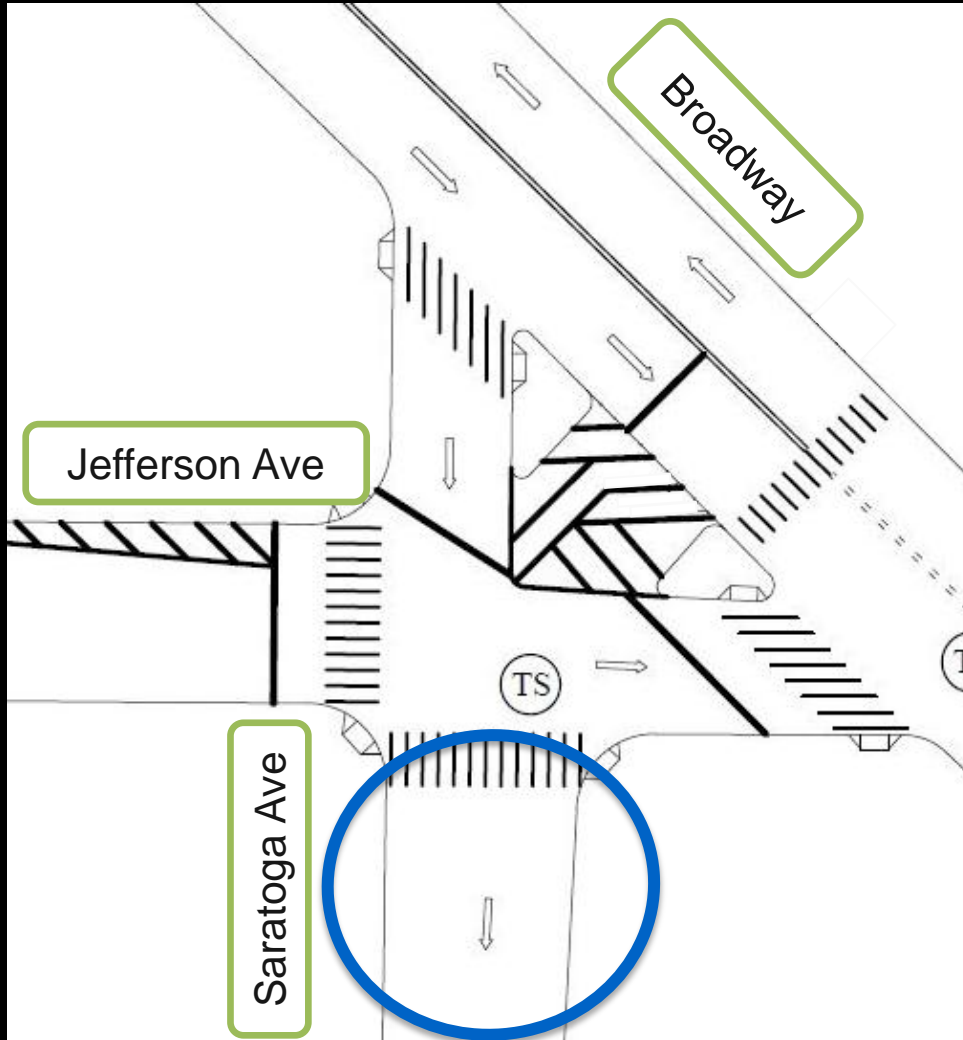

## Issues:

2 substandard moving lanes on Saratoga Avenue (19')

Saratoga Avenue is a high crash corridor

(Vision Zero Priority Corridor)

# Proposed Plan

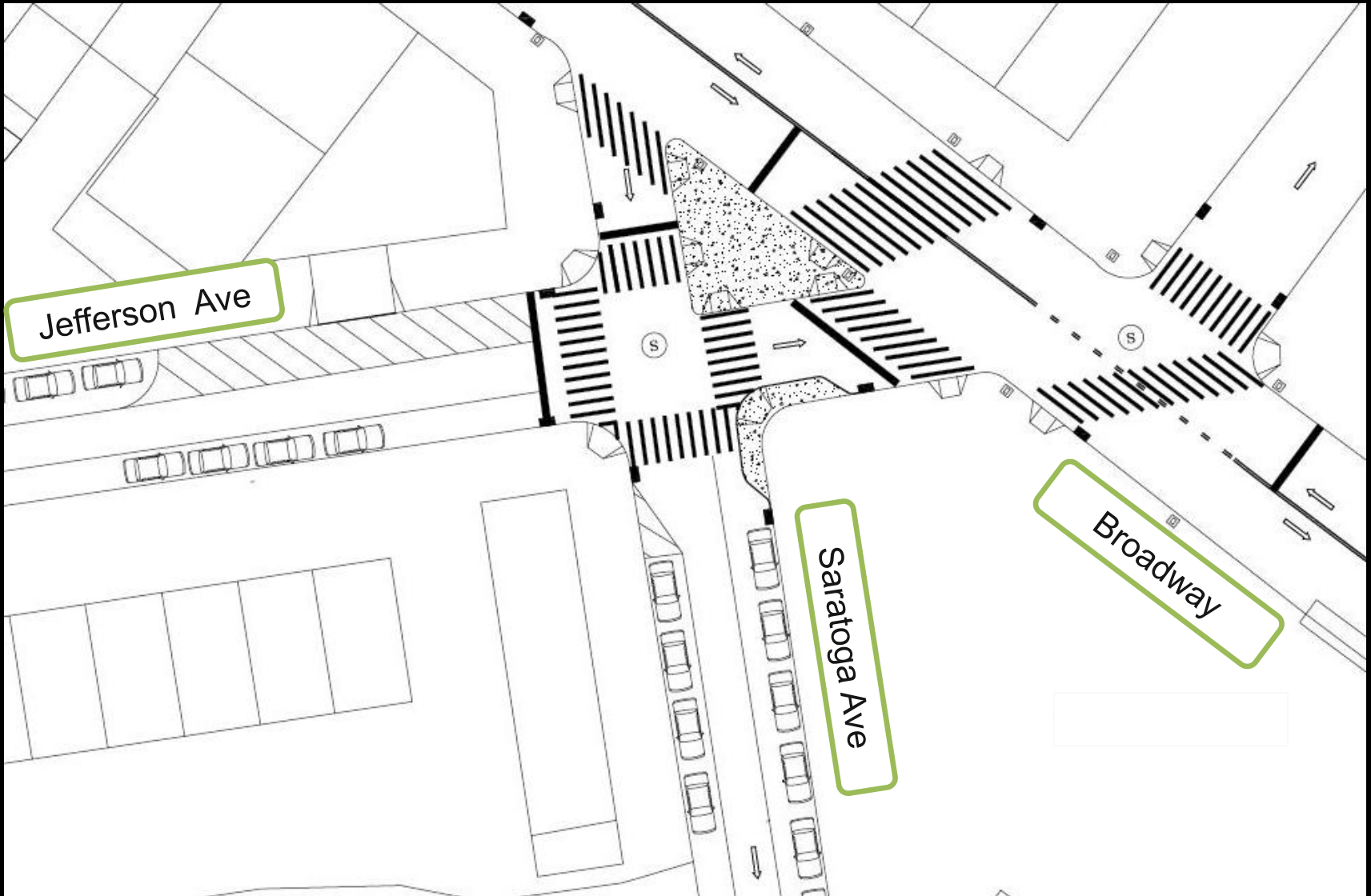



# 1. Pedestrian Space

Concrete island with new ped ramps improves accessibility for pedestrians, particularly the elderly and people with disabilities

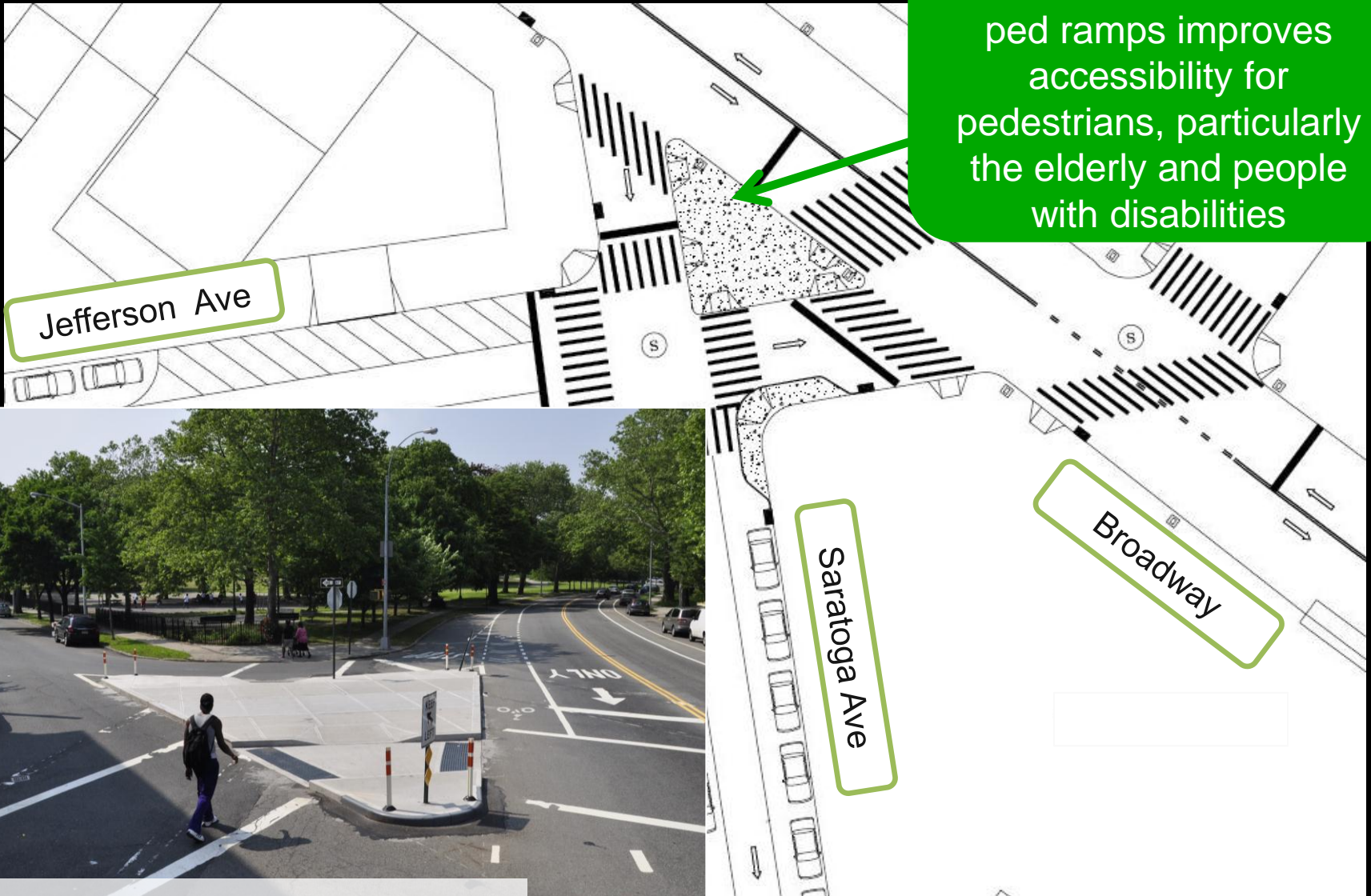

Crotona Park, Bronx



# 1. Pedestrian Space

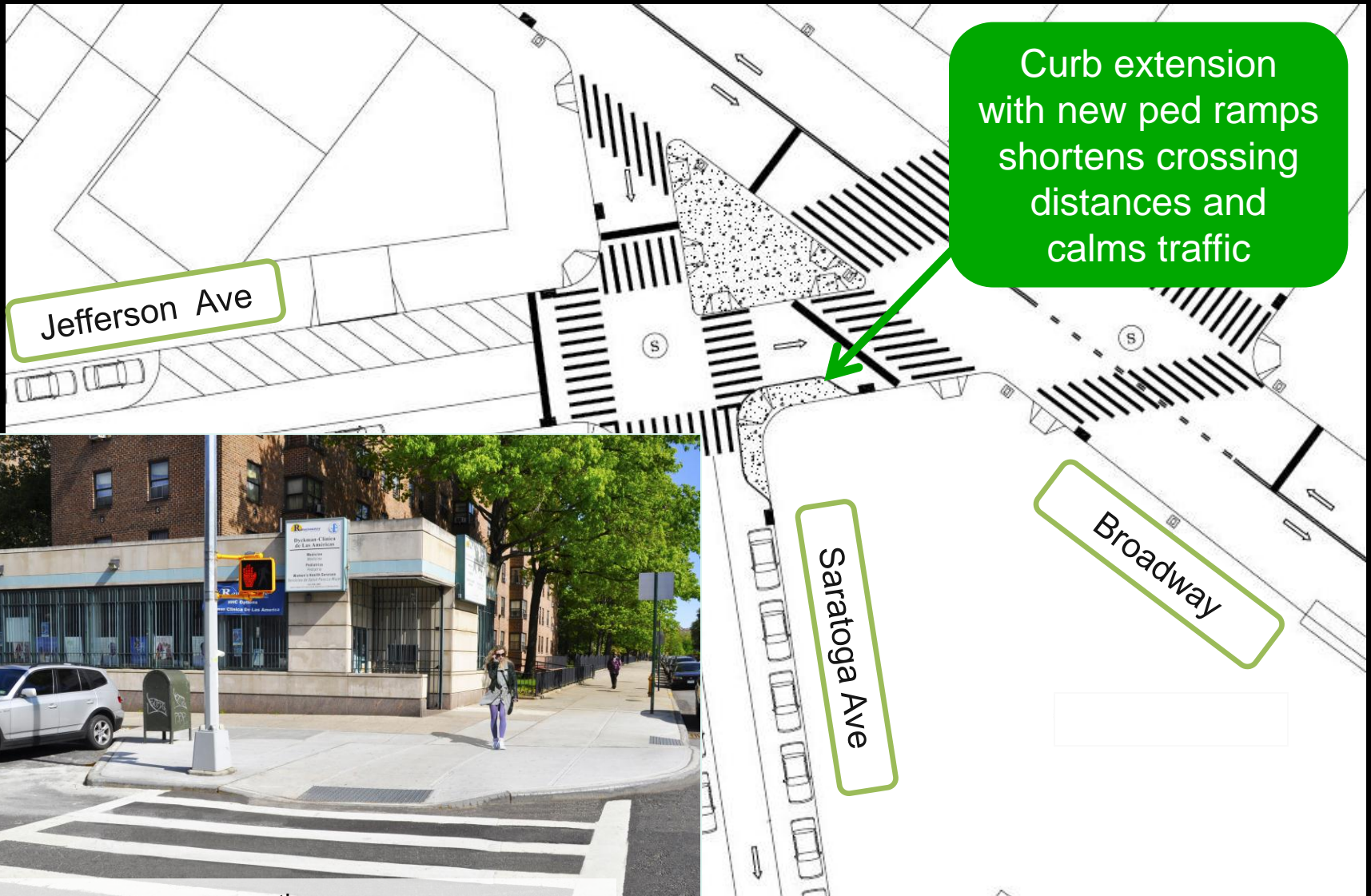

# 2. Pedestrian Crossings

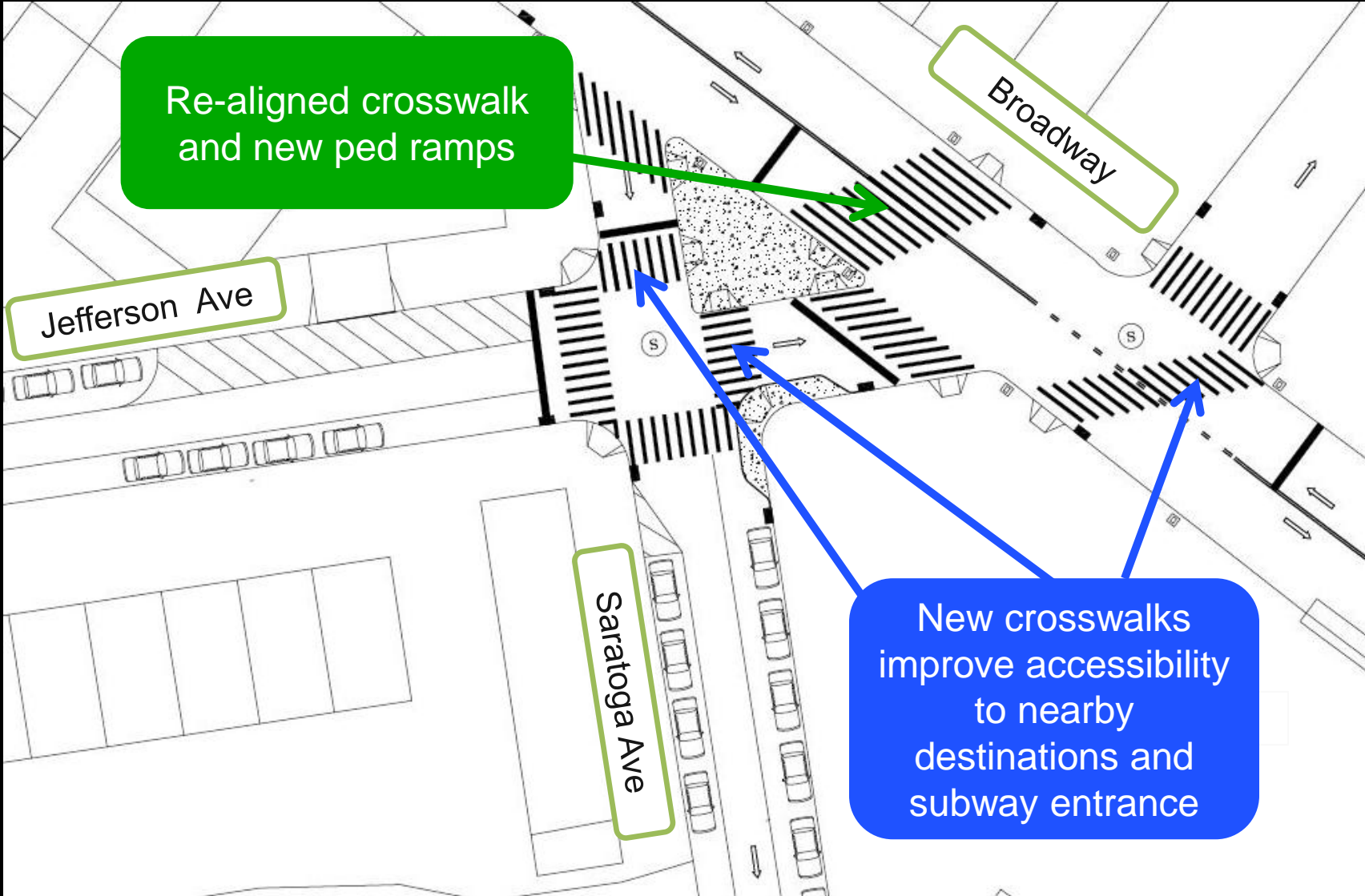



# 3. Traffic Safety

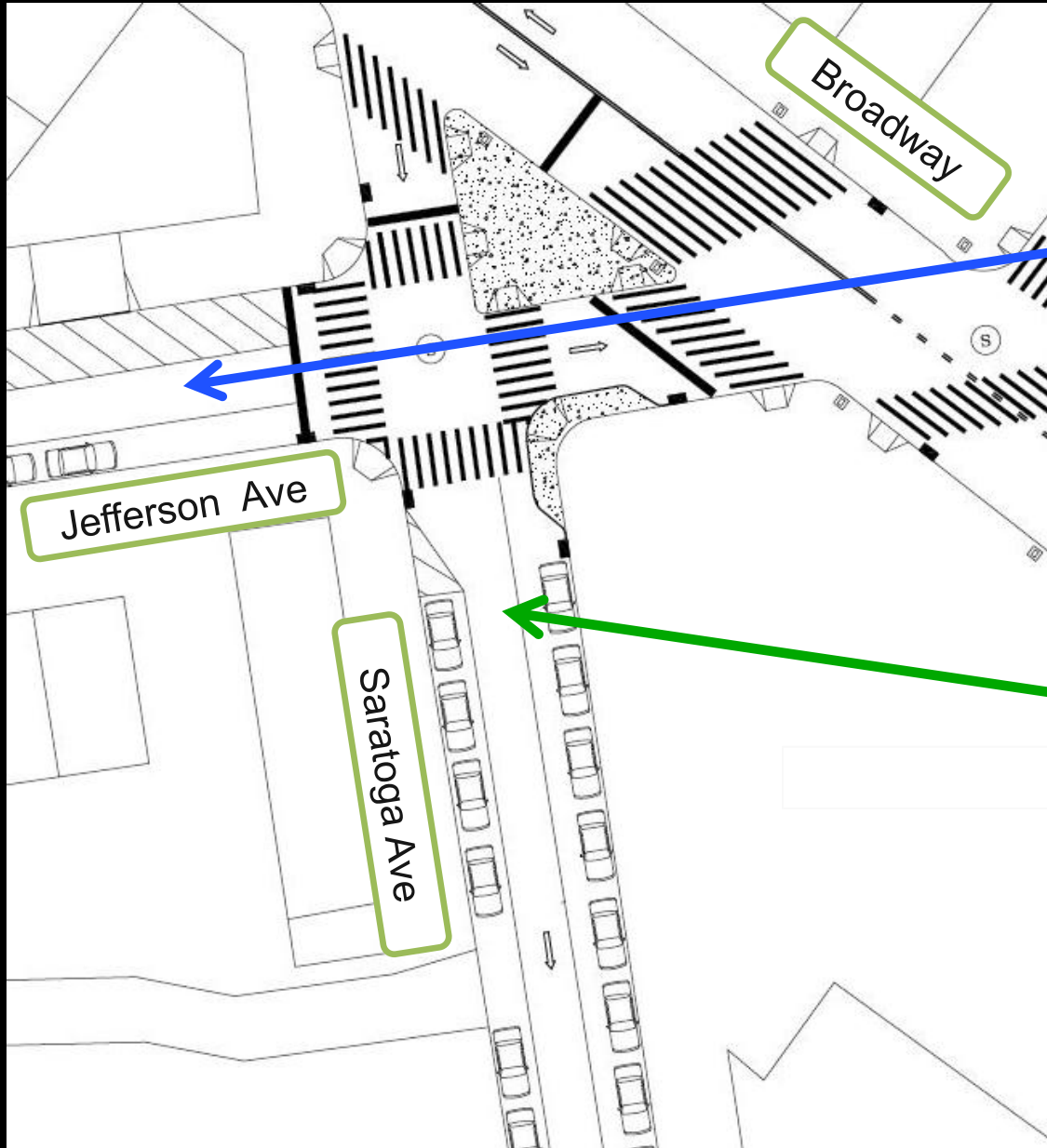

Stripe Jefferson Ave with one moving lane and two parking lanes

Convert Saratoga Ave substandard lanes to one 12' thru lane and two parking lanes

# Proposal Summary

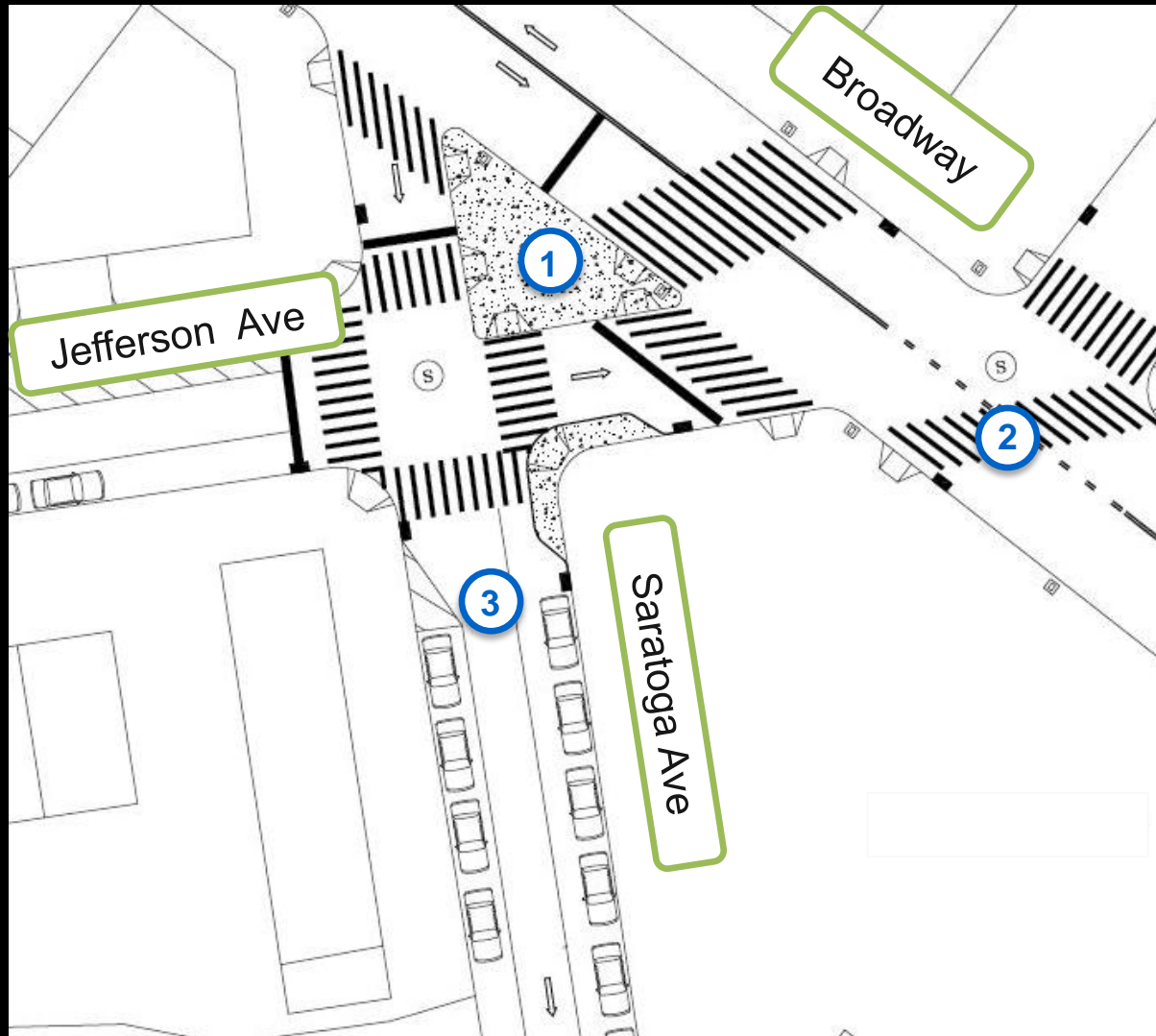

- 1. Complete pedestrian island and construct curb extension**
- 2. Install new crosswalks**
- 3. Re-stripe Saratoga Ave**





ONE WAY



ONE WAY



[www.nyc.gov/dot](http://www.nyc.gov/dot)

Thank  
You