

Gansevoort

Test Plaza & Network Redesign



Background

- Community Request
- PlaNYC Plaza
- Gehl Plaza
- Community-Led Workshops
- CB2 Resolution Passed
- Extension of 9 Ave. & 14 Street Plazas



Looking west

Location

Burgeoning night-life
& fashion district



Historic Meatpacking District

Retail and Restaurants

Builds Upon Ninth Avenue & W. 14th Street



Greater Gansevoort Community-Led Open House

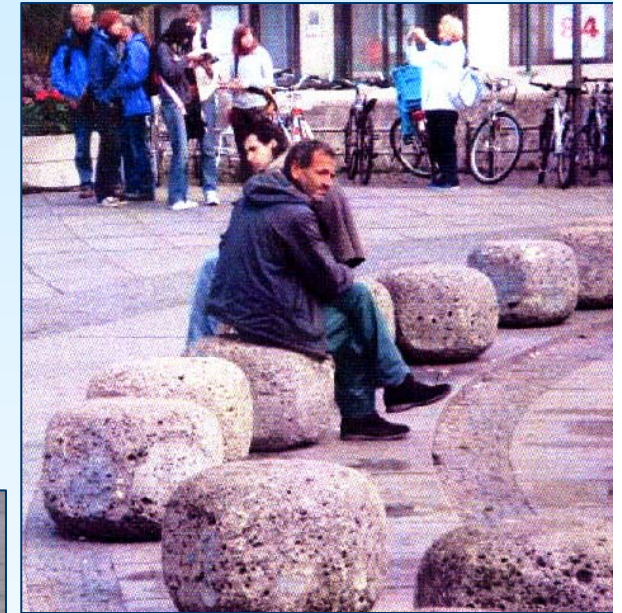

Inspiration



CB2 Resolution Requests

- ❑ Create a public space in Gansevoort Plaza, attached to northern curb
- ❑ Create auxiliary public spaces along the curbs of 9th Ave. between Gansevoort and 14th Sts.
- ❑ Use industrial-styled elements to define new public spaces
- ❑ Remove east-bound traffic on Gansevoort St. between 9th Ave and Hudson St.
- ❑ Create pedestrian priority zone reducing speed limit to 15mph on Gansevoort, Little W. 12th and 13th Sts. and on 9th and 10th Aves. and Washington St.
- ❑ Install traffic signals on Washington St. at Gansevoort and 14th Sts.
- ❑ Install all-way stop signs on Washington St. at 13th and Little West 12th Sts.
- ❑ Designate both Washington St. and 10th Ave as two-way between 14th and Gansevoort Sts.
- ❑ Reverse 13th St. between Hudson St. and 9th Ave.
- ❑ Eliminate left turns from Washington St. onto Horatio between 9pm and 7am
- ❑ Install a rumble strip across the western end of 14th St. at the entrance from the West Side Highway.
- ❑ Move M11 and M14A bus stops

Public Space Requests

- New public space attached to northern curb of Gansevoort Street: *8,115 Sq.Ft. to be provided*
- Auxiliary public spaces along 9th Avenue curb: *7,080 Sq.Ft. to be provided*
- Create pedestrian priority zone reducing speed to 15 mph: *New signage to be installed at entrances to plaza area*



Exact Signage
To Be
Determined

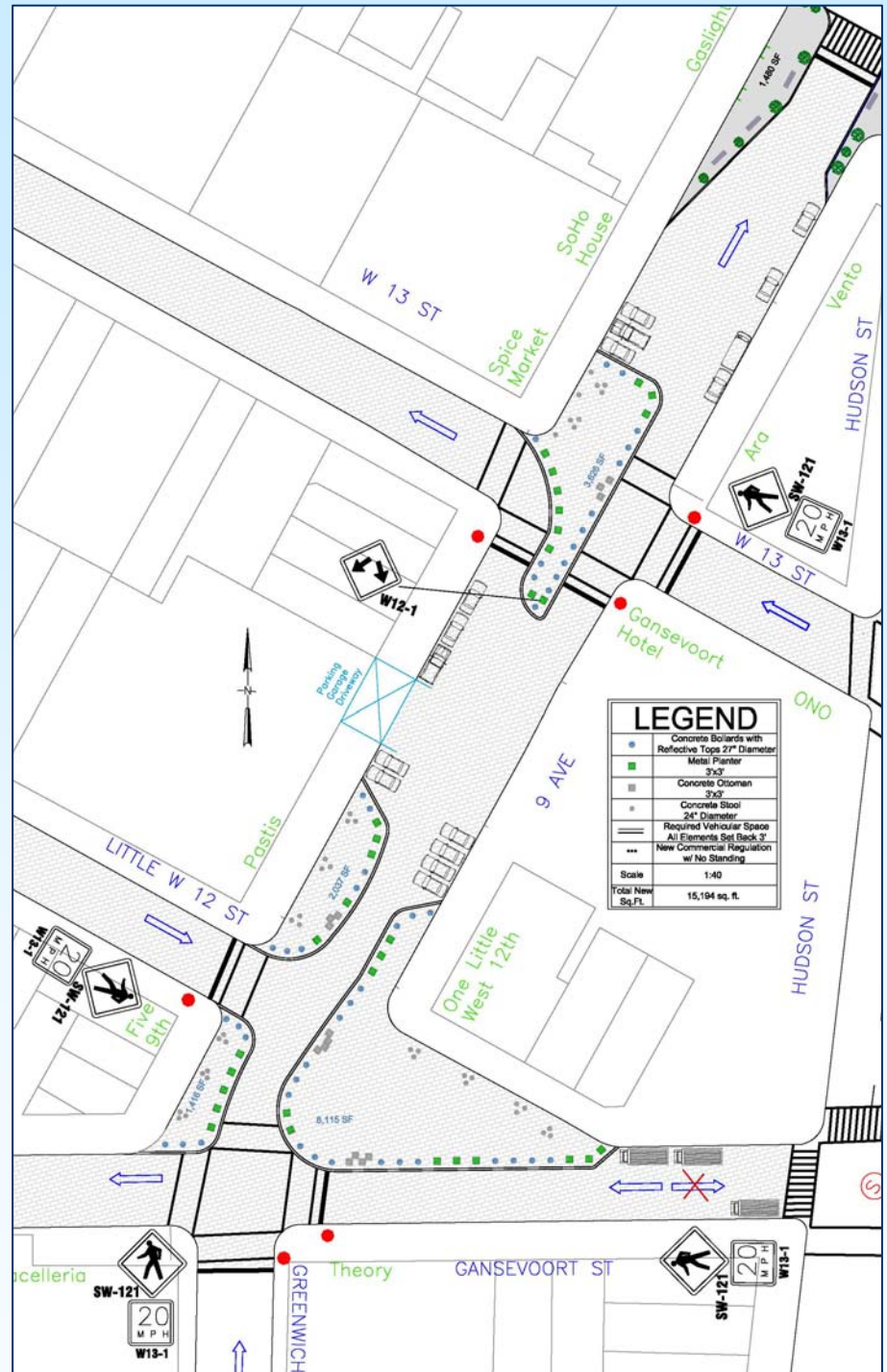

Traffic Network Requests

- Remove east-bound traffic on Gansevoort St. between Hudson and Greenwich Sts: *Approved*
- Designate both Washington St. and 10 Ave. as two-way between 14th and Gansevoort Sts.:
Approval granted for full Washington St request. Approval granted for 10th Ave two-way between Gansevoort and Little W. 12th Sts.
- Install traffic signals on Washington St. at Gansevoort and 14th Sts: *Under Study*
- Install all-way stop signs on Washington St. at 13th and Little West 12th Sts: *13th and Washington already all-way; Little W. 12th Under Study*
- Eliminate left turns from Washington St. onto Horatio St. 9pm-7am: *Will observe need after two-way Washington and 10th Avenue are implemented*
- Relocation of M11 and M14A bus stops: *Requests Denied*
- Reverse 13th St. between Hudson St. and 9th Ave.: *Request Denied*
- Install rumble strip across western end of 14th St.: *Request on Hold – Rumble strips are not a common treatment due to noise complaints; we welcome other proposals from the community toward improving safety at this intersection*

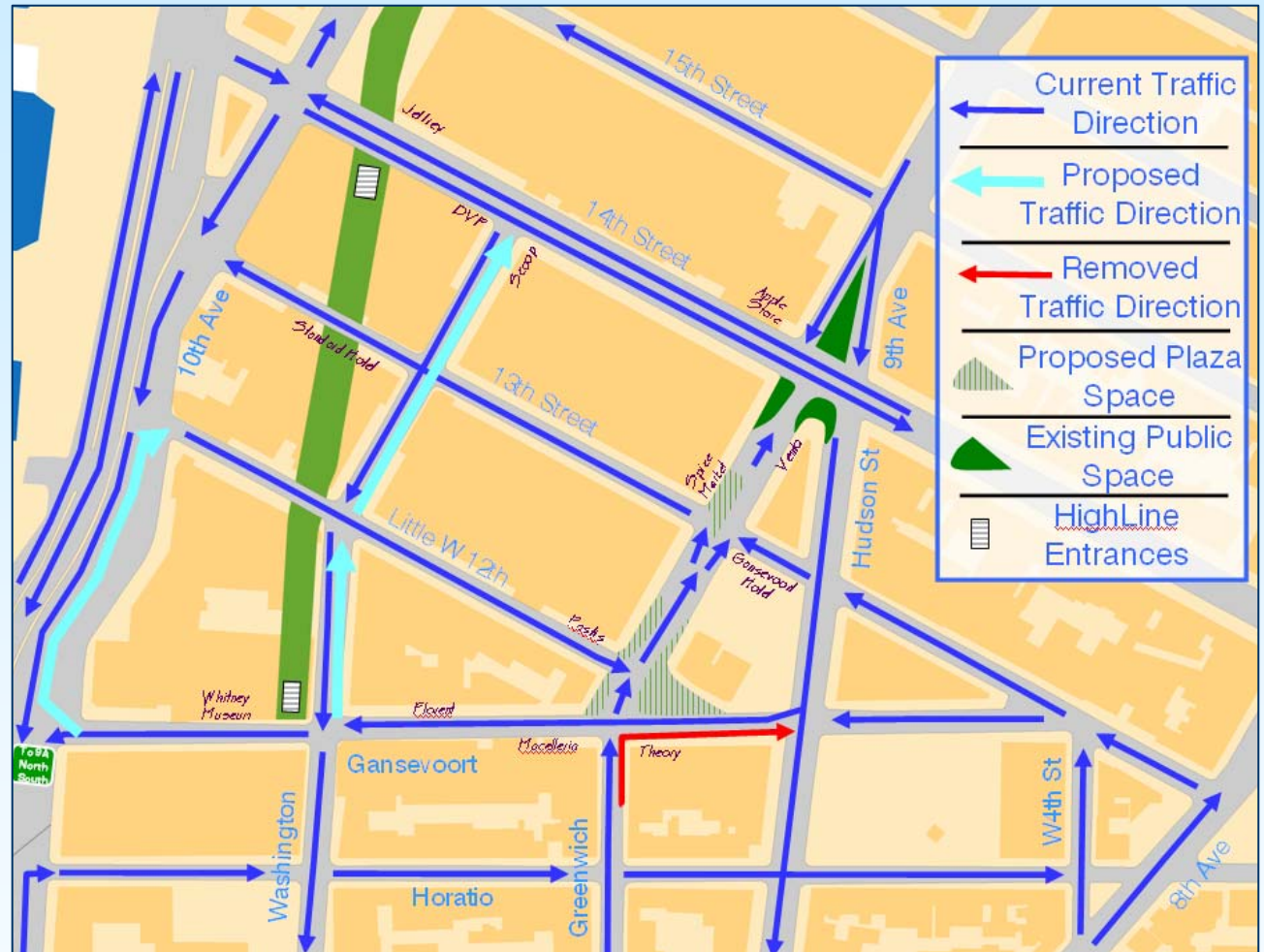

Parking Regulation Requests

-  Hotel Loading Zone
-  Taxi Stand – Under Review
-  Meat Market Regulation
-  No Standing Anytime
-  Commercial Loading/ Unloading M-F 7am-4pm; 2 Hour Parking M-F 4-11pm; 2 Hour Parking Sa-Sun 9am-11pm
-  No Standing 11pm-4am Thur Fri Sat
- Muni-Meter Request Under Review*

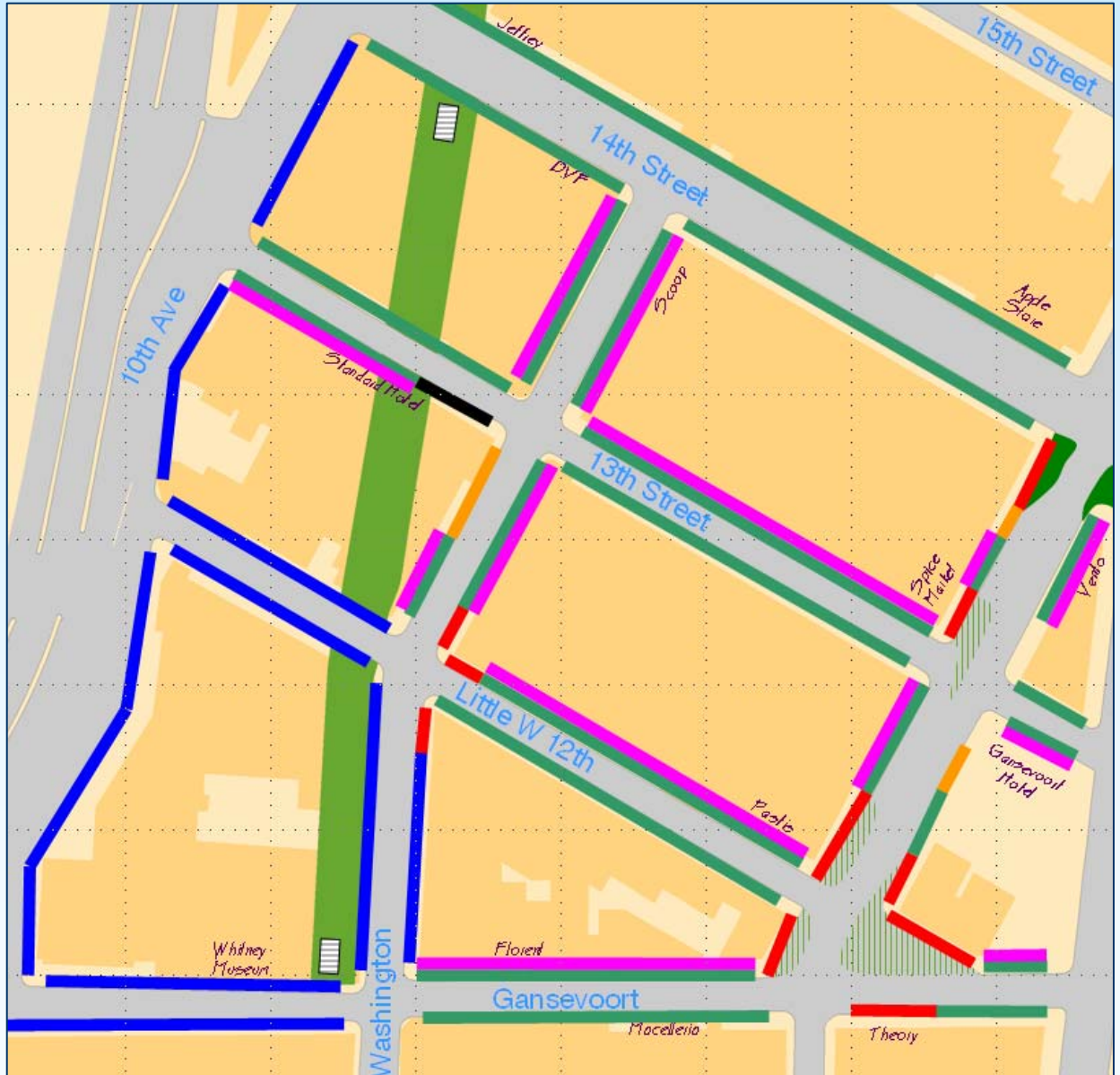

Design Element Requests

Use industrial-styled objects to define new public spaces: *Custom elements being fabricated*

Additional DOT Measures:

- *Double white 4" lines around public space*

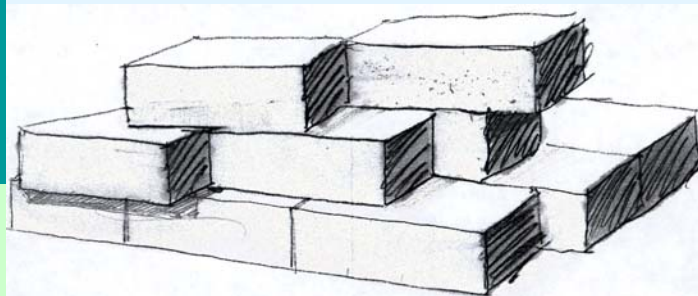

Concrete 1' x 1' x 3' stepped seating

*Metal planters
GGUIP to plant grasses*

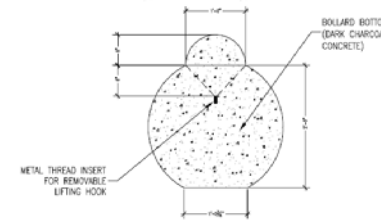
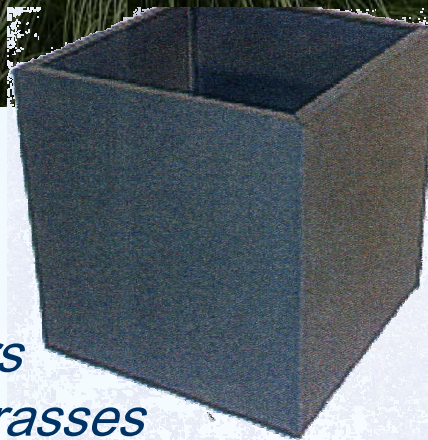

*Concrete
"Bon Bon" Bollards
with reflective tops*

Objects to Provide Casual Seating Along Sidewalks

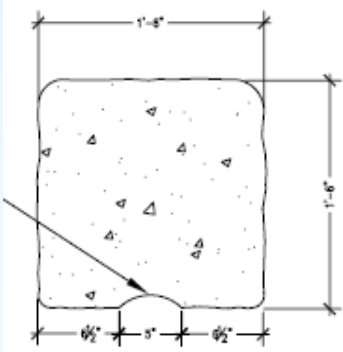
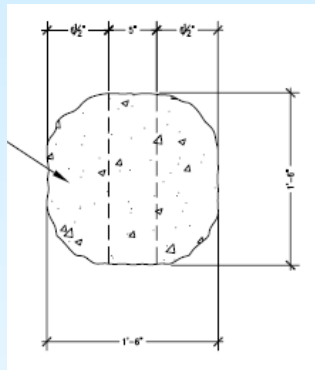

Concrete "Ottoman" stools

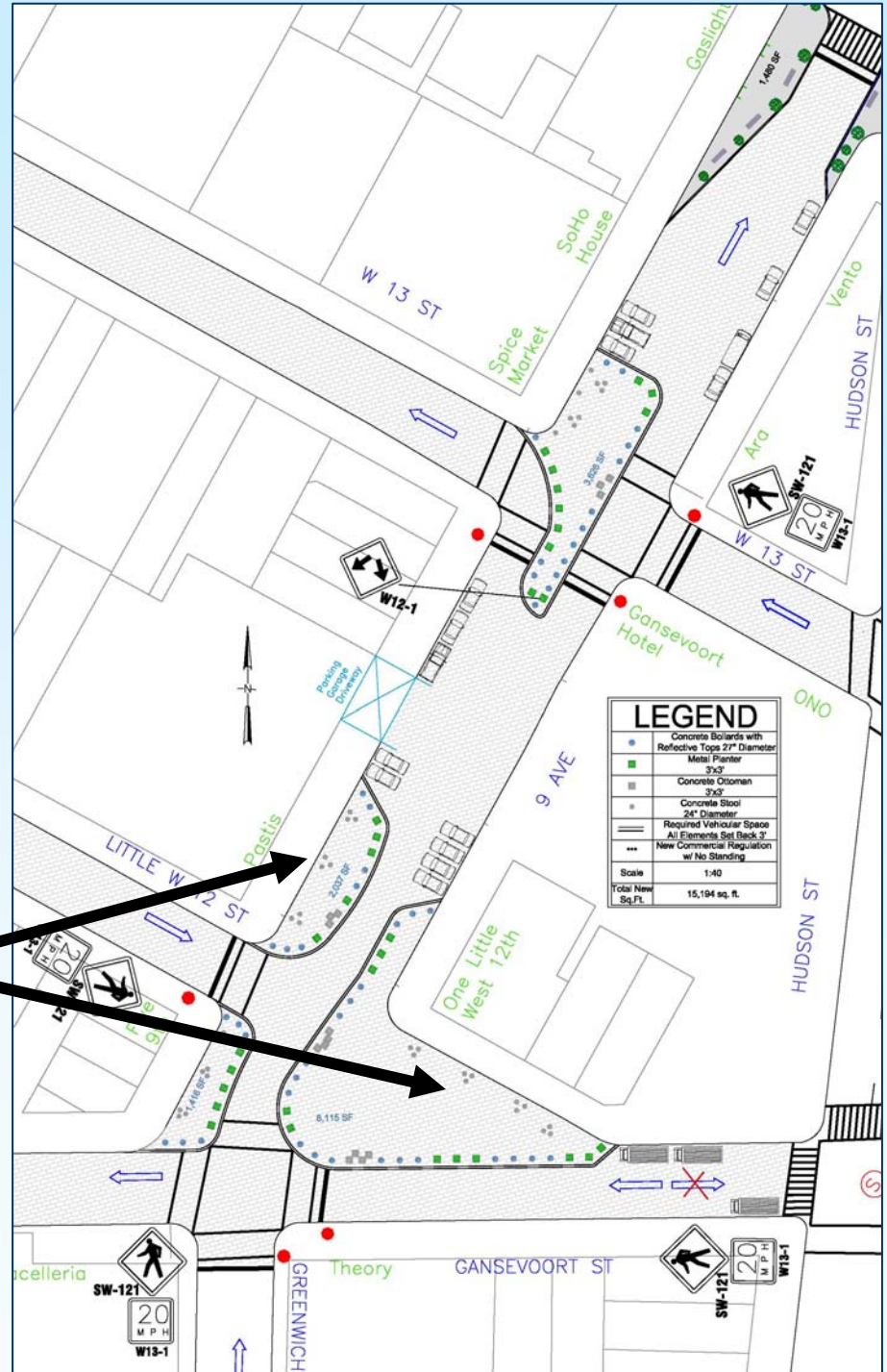

Gansevoort

Benefits

- Community Life
- Pedestrian Circulation
- New Public Spaces
- Taxi and Bus Access and Circulation

To open on...

- Earth Day-April 22

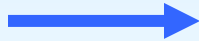

Existing