

# Bronx HUB: Multi-Modal Simplification & Enhancement

## E. 149<sup>th</sup> Street @ Willis, Third, & Melrose Avenues



Office of Alternative Modes



Janette Sadik-Khan,  
Commissioner

Central Project Area: Intersection of E.149<sup>th</sup> Street, Third & Melrose Avenues  
AND

Temporary Plaza on Willis Avenue between E.148<sup>th</sup> Street & Third Avenue  
Additional area improvements including expanded bike network & additional on-street parking

**BRONX  
HUB**



Five-legged intersection with  
high pedestrian volumes, excellent transit  
connections & diverse retail destinations

Can pedestrian safety  
& intermodal  
transfers  
be improved?



How can congested, chaotic traffic & transit patterns be simplified?



# HUB Simplification & Enhancement

Intersection clarified with new pedestrian refuge islands & right turn only from Melrose to E.149<sup>th</sup> Street

New public plaza provides much needed pedestrian space and enhanced transit passenger experience

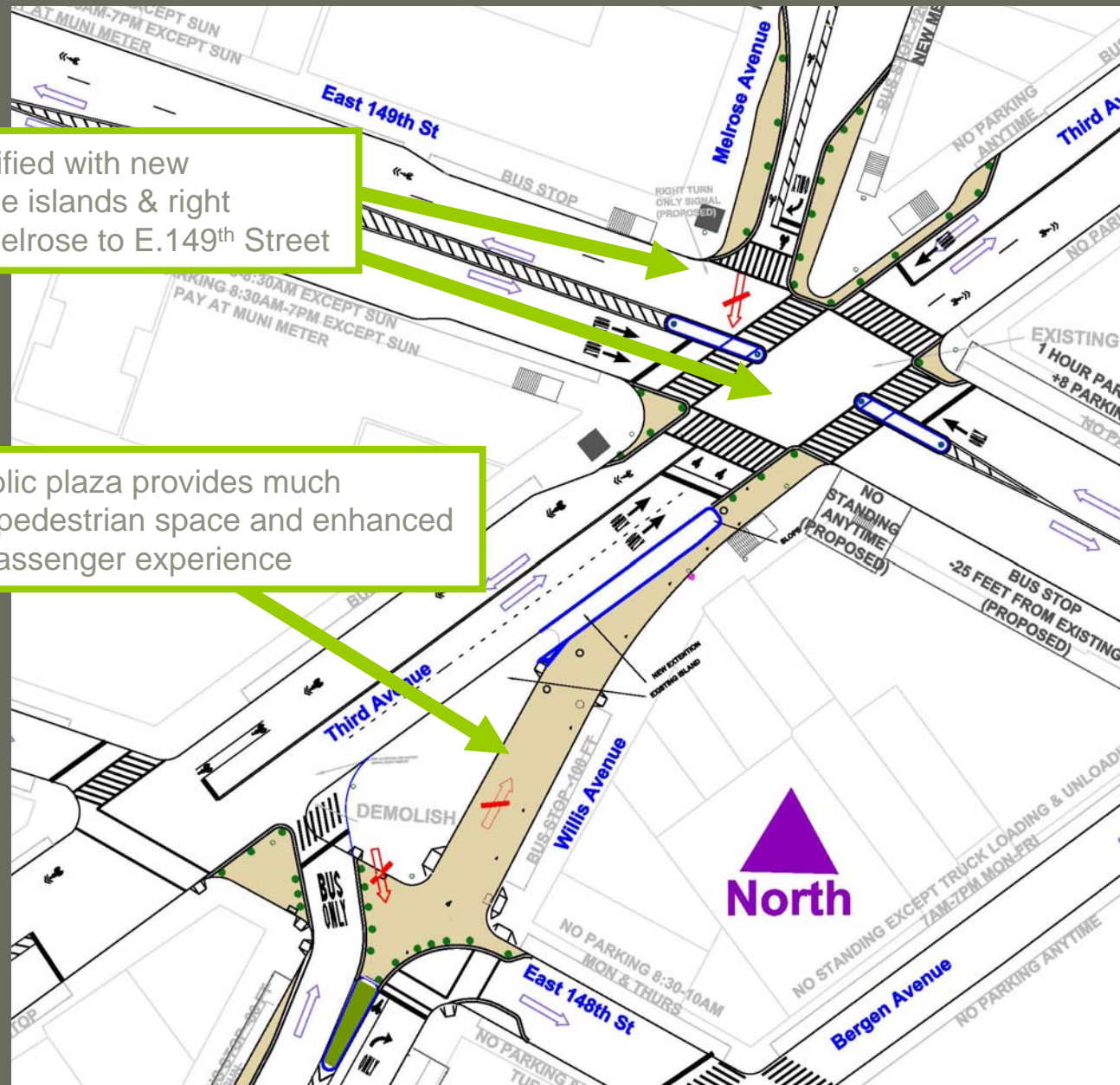

# Intersection Operation at E.149<sup>th</sup> St./Third/Willis/Melrose Aves

Existing

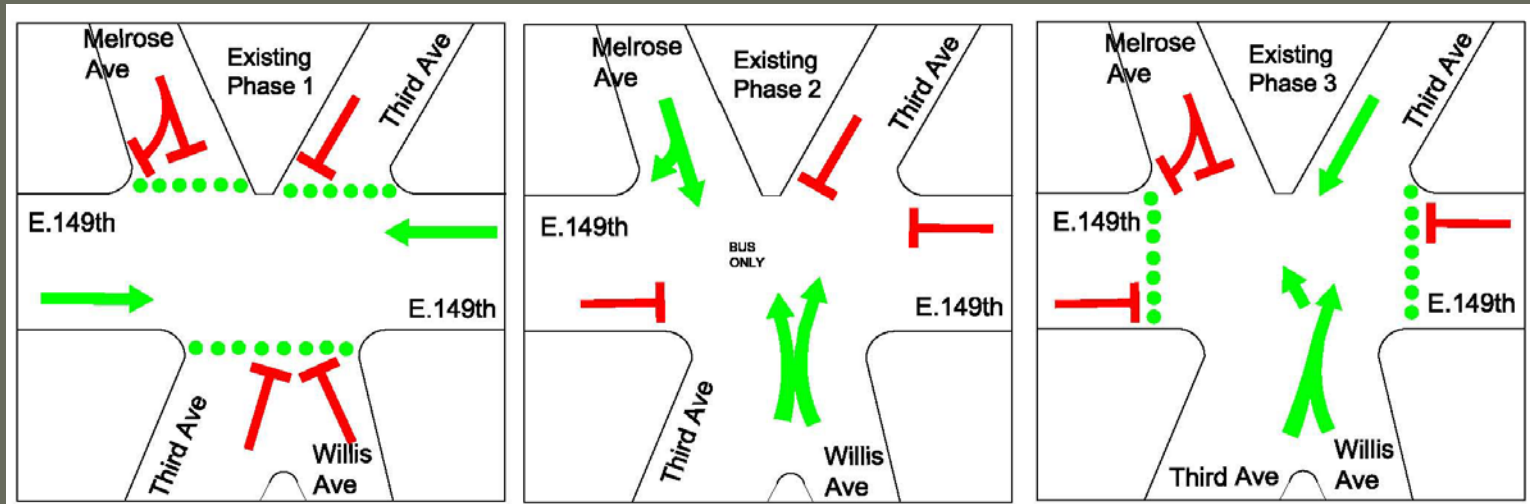

September 2008  
Implementation

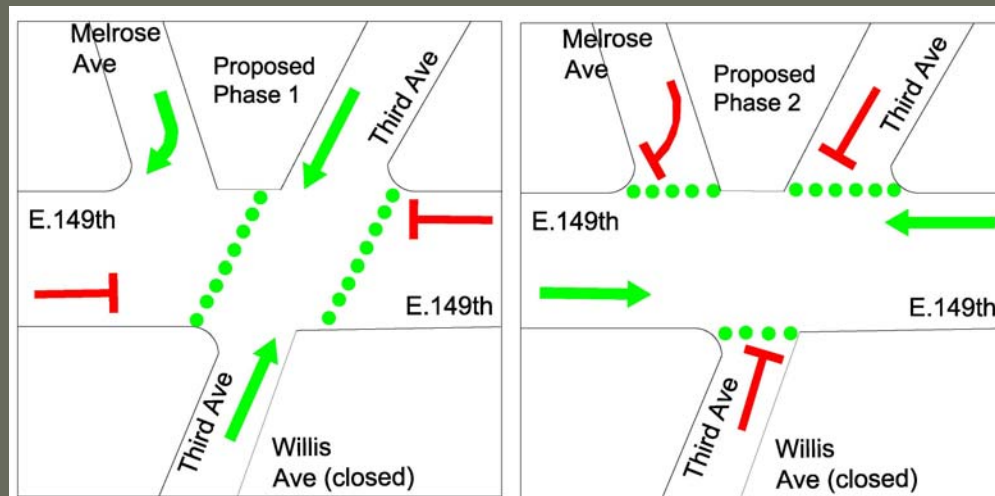

# Greater HUB Area Improvements

## Major Project Benefits

- New public plaza
- Safer intersections & reduced congestion
- Safer & more convenient pedestrian movements
- Improved bus & subway transfer access
- New bike routes & bike to transit connections

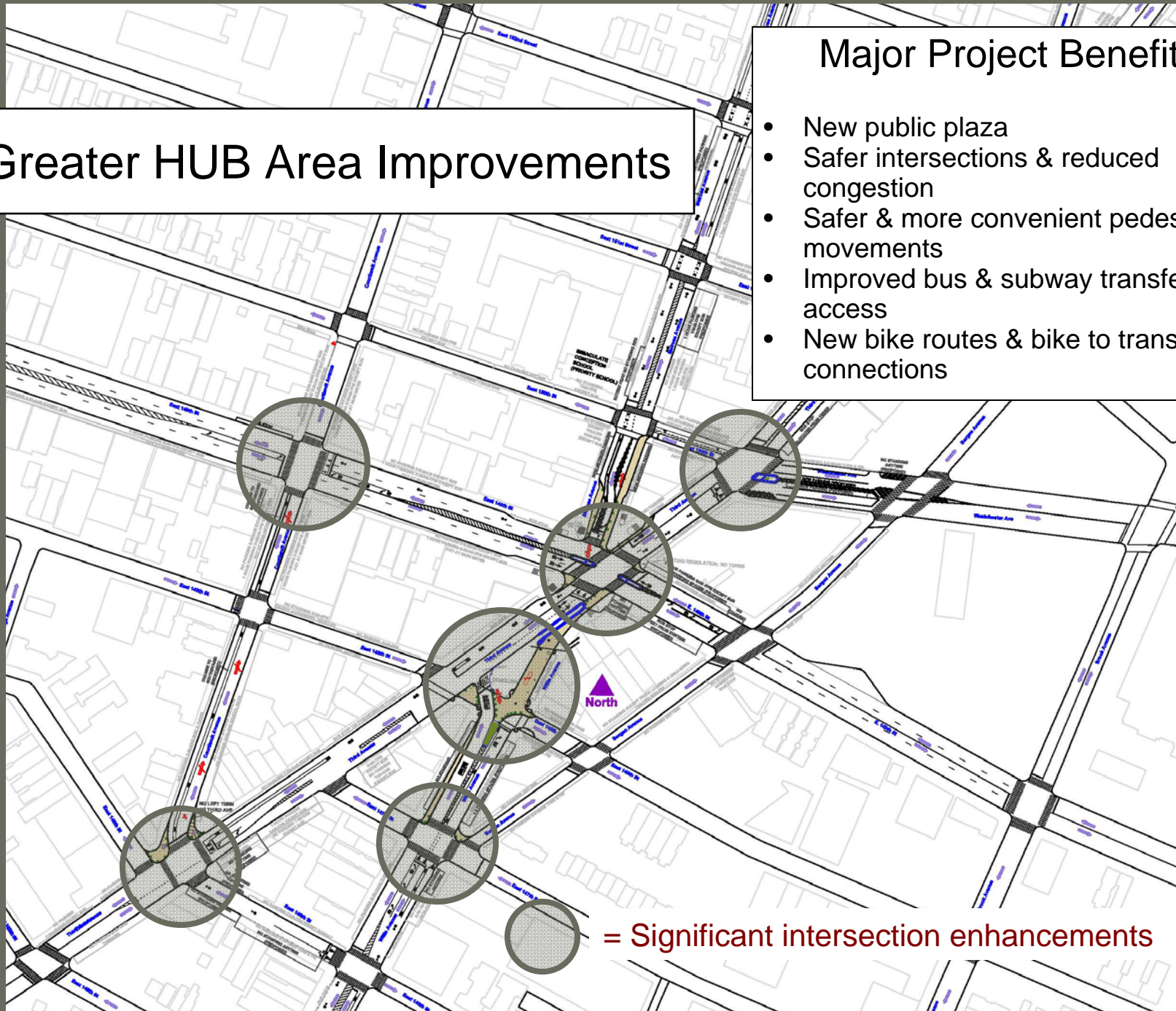

= Significant intersection enhancements

# HUB Pedestrian Plaza

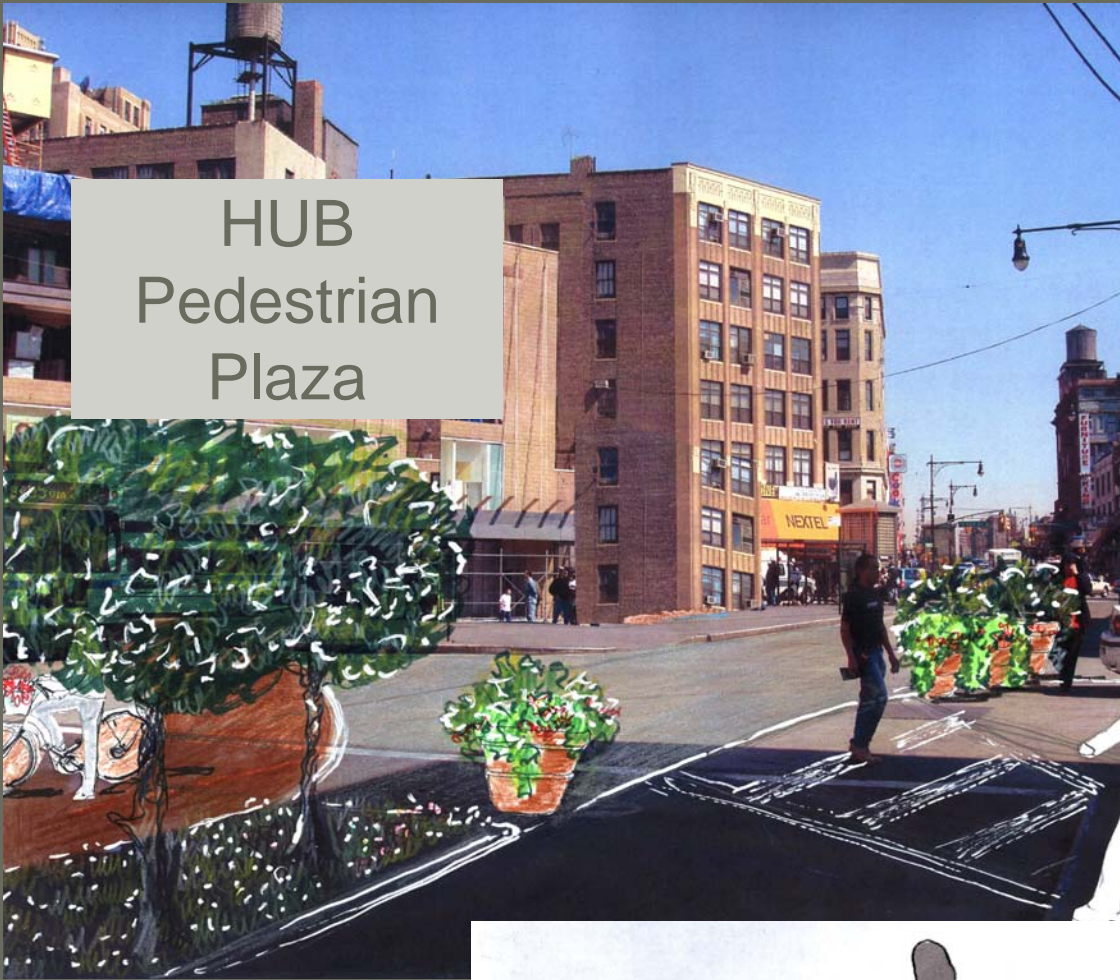

Typical Planter  
Treatment

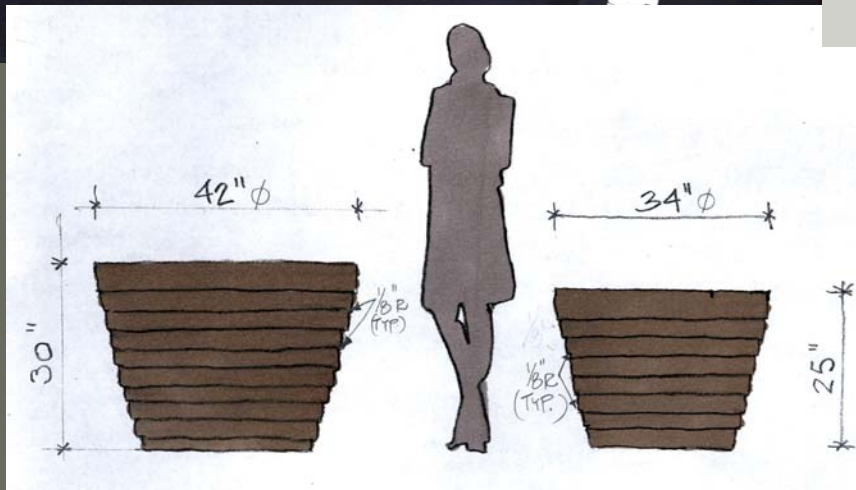



# New HUB Area Bike Routes

