



STEINWAY STREET

Community Board 1 Transportation Committee

March 12, 2018

BACKGROUND

- Commercial corridor with surrounding residential
- M and R subway station at Steinway St and 34th Ave
- Q101 bus stops along Steinway St
- 9 Pedestrian Crashes Occurred Midblock on Steinway St (2012-2016)
 - 1 crash involved a 5 year old child

Steinway St from 30th Ave to 34th Ave, QN

Injury Summary, 2012-2016 (5 years)

	Total Injuries	Severe Injuries	Fatalities	KSI
Pedestrian	35	4	0	4
Bicyclists	19	4	0	4
Motor Vehicle Occupant	58	1	0	1
Total	112	9	0	9

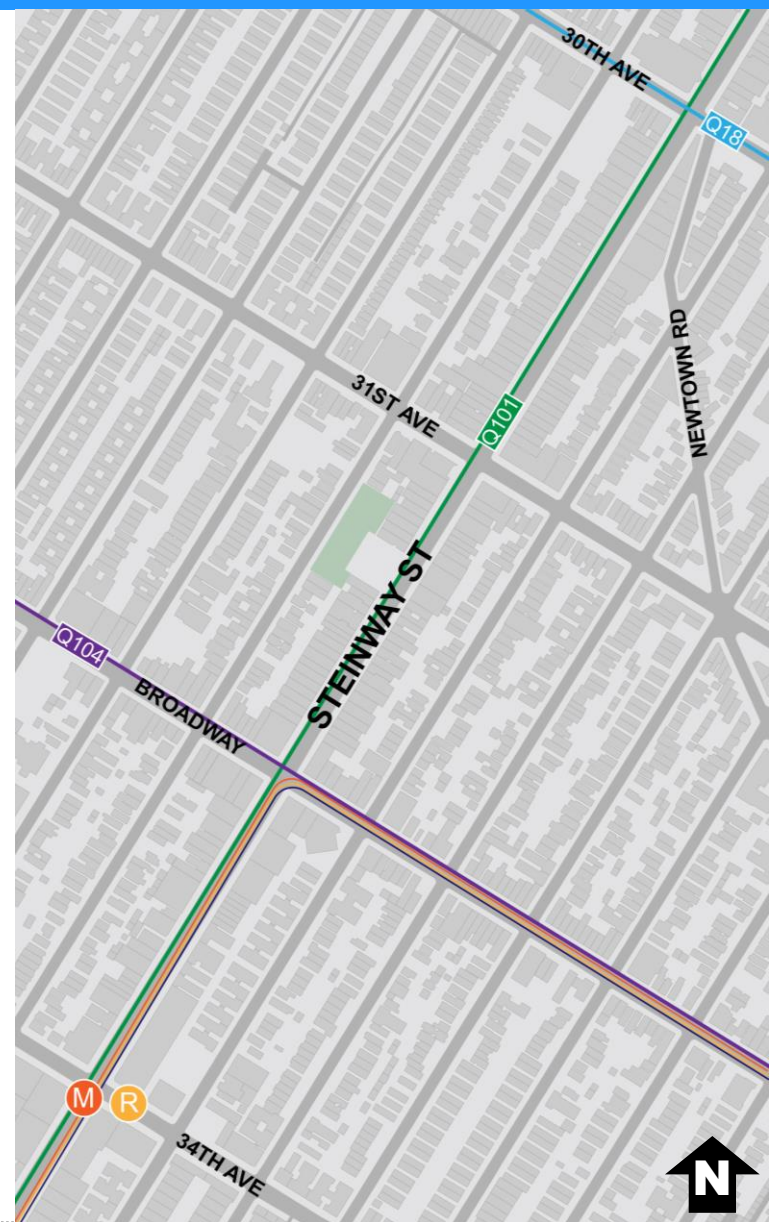

BACKGROUND

- Requests from the Steinway Astoria Partnership and Council Member Constantinides for midblock crossings and pedestrian improvements along Steinway St.
- NYC DOT previously partnered with the Steinway Street BID to add benches along the corridor and created a Steinway Streetscape Master Plan.

Steinway
ASTORIA PARTNERSHIP



STREETScape MASTER PLAN



EXISTING CONDITIONS

- Long Distances Between Traffic Signals
- Shopping Pedestrians Frequently Cross Midblock to Access Retail

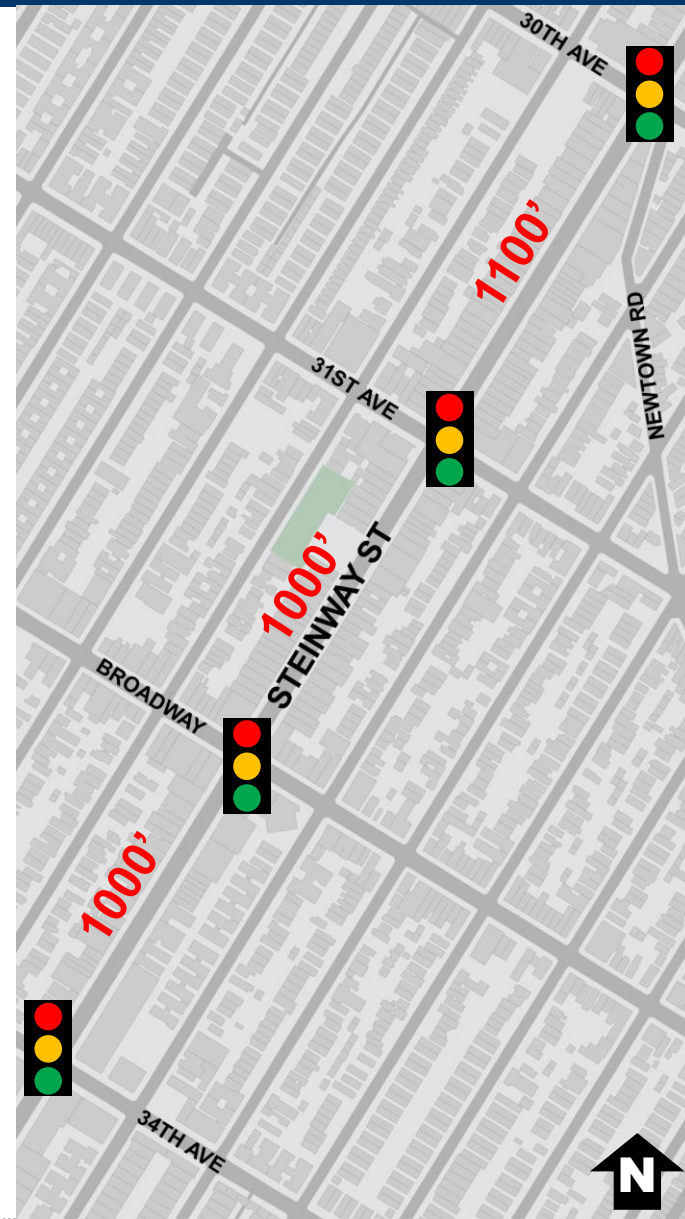

SIGNAL IMPLEMENTATION PLAN

- Adding signalized midblock crossings on Steinway St between 34th Ave and Broadway, Broadway and 31st Ave, and 31st Ave and 30th Ave
- Adding painted neckdowns with planters at new midblock crossings

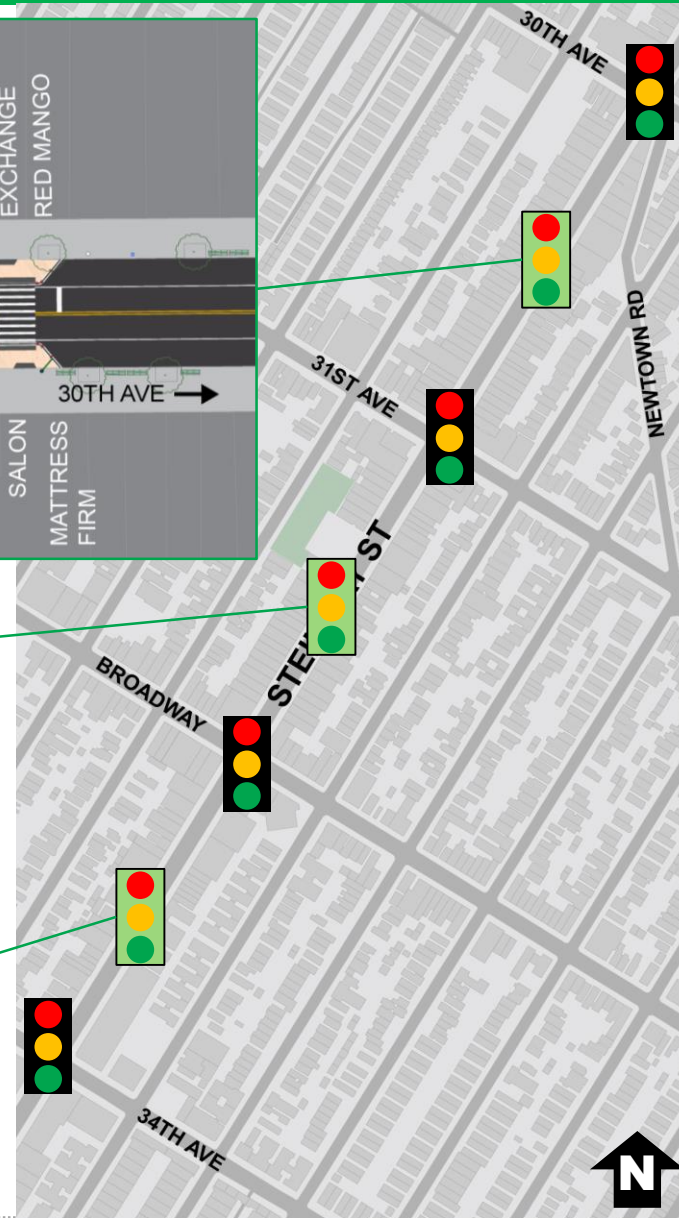
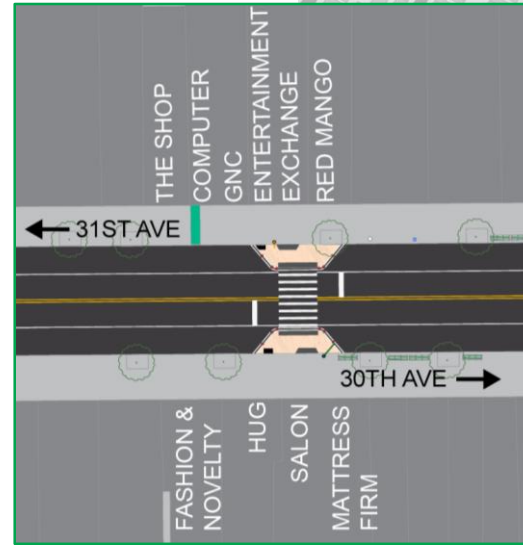
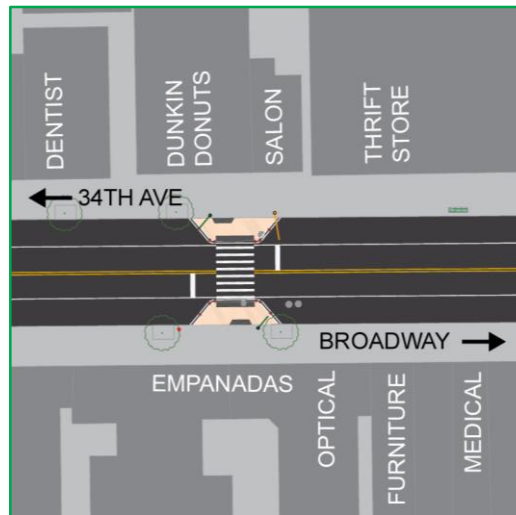
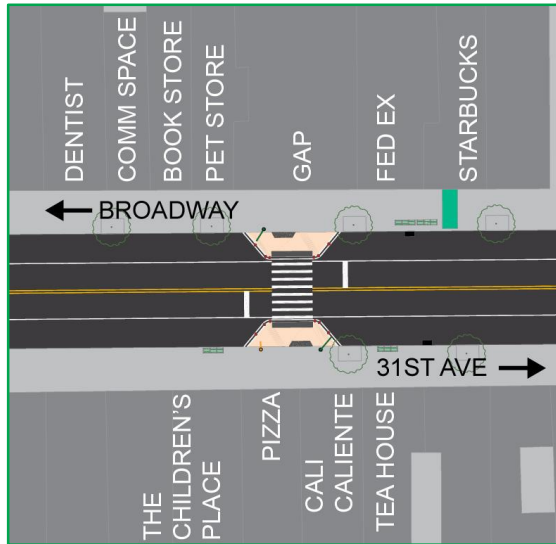

SIGNAL IMPLEMENTATION PLAN



Example Midblock Crossing, Lexington Ave, Manhattan

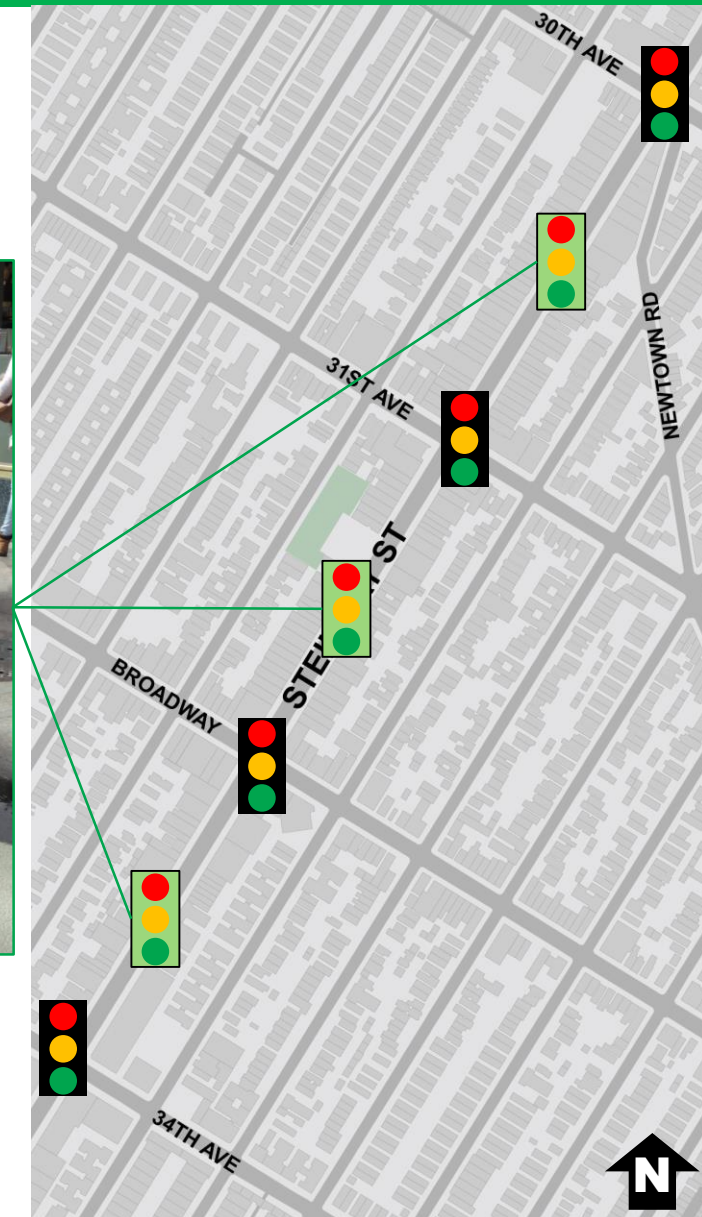

ADDITIONAL SAFETY TREATMENT

- Expanding pedestrian space at Steinway St and Newtown Rd

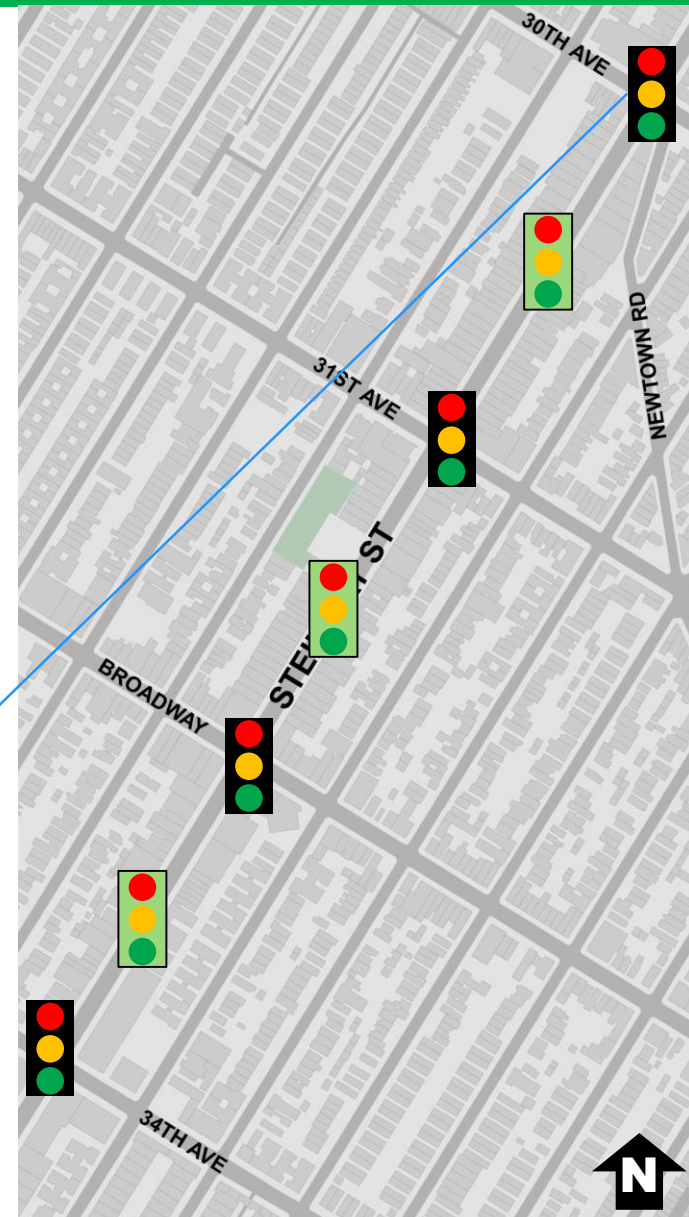
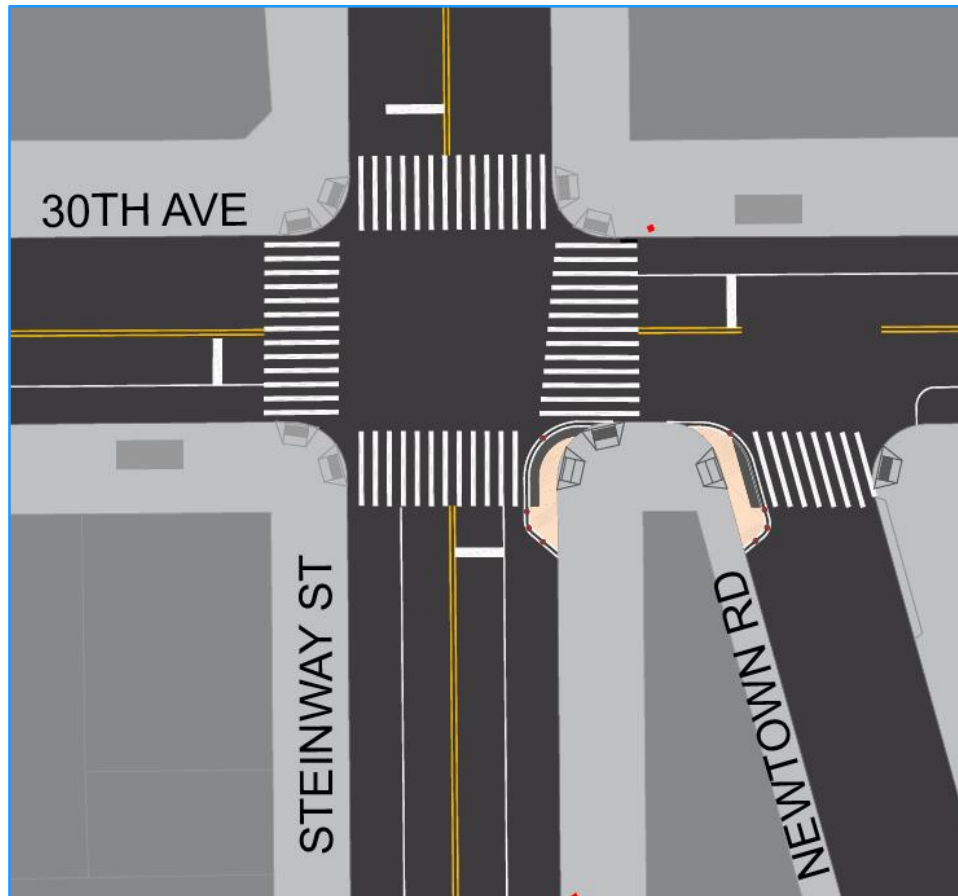

What's Happening Here?

Expand Pedestrian Space

Improve Streetscape



Calm Traffic

Shorten Pedestrian Crossings

NYC DOT will implement safety improvements along Steinway Street:

- Install three new midblock pedestrian crossings with traffic signals between:
 - 34th Avenue and Broadway
 - Broadway and 31st Avenue
 - 31st Avenue and 30th Avenue
- Install painted pedestrian space with planters at each new crossing
- Add pedestrian space at 30th Avenue and Newtown Road

Implementation starts in March



For additional information about this project, contact the DOT Queens Borough Commissioner's Office at [212.839.2510](tel:212.839.2510) or visit our website: nyc.gov/dot.
To sign up for DOT updates, visit: nyc.gov/dotnews



THANK YOU!

Questions?



NYC DOT



NYC DOT



nyc_dot



NYC DOT