



THE CITY RECORD

Official Journal of The City of New York

THE CITY RECORD
U.S.P.S. 0114-660

Printed on paper containing
40% post-consumer material

VOLUME CXXXV NUMBER 161

TUESDAY, AUGUST 19, 2008

PRICE \$4.00

TABLE OF CONTENTS

PUBLIC HEARINGS & MEETINGS

Manhattan Borough President 2769

City Planning Commission 2769

COURT NOTICE

Lower Manhattan Development Corporation 2770

See Court Notice Maps 2776-2779

PROPERTY DISPOSITION

Citywide Administrative Services 2771

Division of Municipal Supply Services 2771

Housing Preservation and Development 2772

Police 2772

PROCUREMENT

Citywide Administrative Services 2772

Division of Municipal Supply Services 2772

Vendor Lists 2772

Economic Development Corporation .. 2772

Contracts 2772

Education 2772

Division of Contracts and Purchasing 2772

Environmental Protection 2772

Bureau of Wastewater Treatment ... 2772

Health and Hospitals Corporation ... 2772

Health and Mental Hygiene 2773

Agency Chief Contracting Officer ... 2773

Homeless Services 2773

Office of Contract and Procurement . 2773

Human Resources Administration ... 2773

Bureau of Contracts and Services ... 2773

Juvenile Justice 2773

Law 2774

Parks and Recreation 2774

Revenue and Concessions 2774

SPECIAL MATERIALS

Citywide Administrative Services 2774

Comptroller 2774

Human Resources Administration 2775

Changes in Personnel 2775

READERS GUIDE 2780

THE CITY RECORD MICHAEL R. BLOOMBERG, Mayor

MARTHA K. HIRST, Commissioner, Department of Citywide Administrative Services.
ELI BLACHMAN, Editor of The City Record.

Published Monday through Friday, except legal holidays by the Department of Citywide Administrative Services of the City of New York under Authority of Section 1066 of the New York City Charter.

Subscription—\$500 a year; daily, \$4.00 a copy (\$5.00 by mail) Periodicals Postage Paid at New York, N.Y.
POSTMASTER: Send address changes to THE CITY RECORD, 1 Centre Street, Room 2208, New York, N.Y. 10007 - 1602

Editorial Office 1 Centre Street, Room 2208 New York N.Y. 10007-1602 Telephone (212) 669-8252	Subscription Changes/Information 1 Centre Street, Room 2208 New York N.Y. 10007-1602 Telephone (212) 669-8252	The City of New York Home Page provides Internet access via the WORLD WIDE WEB to solicitations and awards http://www.nyc.gov/cityrecord
--	--	--

PUBLIC HEARINGS AND MEETINGS

See Also: Procurement; Agency Rules

MANHATTAN BOROUGH PRESIDENT

MEETING

PUBLIC NOTICE IS HEREBY GIVEN THAT THE MANHATTAN BOROUGH BOARD MEETING is scheduled for August 21, 2008 from 8:30 A.M. to 10:00 A.M., at the Harlem State Office Building located at 163 West 125th Street, 2nd Floor, Art Gallery.

PLEASE NOTE: Individuals requesting sign-language interpreters or other reasonable accommodations for disabilities should contact the Office of the Manhattan Borough President, located at 1 Centre Street, 19th Floor South, New York, NY 10007 at (212) 669-8300. NO LATER THAN THREE (3) BUSINESS DAYS PRIOR TO THE PUBLIC HEARING/MEETING.

a12-20

CITY PLANNING COMMISSION

PUBLIC HEARINGS

NOTICE IS HEREBY GIVEN THAT RESOLUTIONS Have been adopted by the City Planning Commission scheduling public hearings on the following matters to be held at Spector Hall, 22 Reade Street New York, New York, on Wednesday, August 27, 2008, commencing at 10:00 a.m.

**BOROUGH OF BROOKLYN
No. 1
HOPKINSON/PARK PLACE**

- CD 16 C080447 HAK**
IN THE MATTER OF an application submitted by the Department of Housing Preservation and Development (HPD):
- pursuant to Article 16 of the General Municipal Law of New York State for:
 - the designation of property located at 1612 Park Place (Block 1468, Lot 56); and 404 A, 408, 414, and 416 Hopkinson Avenue (Block 1468, Lots 58, 60, 63, and 64), as an Urban Development Action Area; and
 - an Urban Development Action Area Project for such area; and
 - pursuant to Section 197-c of the New York City Charter for the disposition of such property to a developer selected by HPD;

to facilitate development of a residential building, tentatively known as Hopkinson/Park Place, with approximately 25 units, to be developed under the Department of Housing Preservation and Development's New Foundations Program.

**No. 2
COMMON GROUND SENIOR HOUSING**

CD 16 C 080492 HAK
IN THE MATTER OF an application submitted by the Department of Housing Preservation and Development (HPD):

- pursuant to Article 16 of the General Municipal Law of New York State for:
 - the designation of property located at St. Mark's Avenue (Block 1452, Lot 65), 1511, 1505, 1503, and 1501 St. Mark's Avenue (Block 1452, Lots 59, and 62-65), Bergen Street (Block 1452, Lot 138), and Saratoga Avenue (Block 1452, Lot 147), as an Urban Development Action Area; and
 - an Urban Development Action Area Project for such area; and
- pursuant to Section 197-c of the New York City Charter for the disposition of such property to a developer selected by HPD;

to facilitate development of a residential building, tentatively known as Common Ground Senior Housing, with approximately 71 units, to be developed under the U.S. Department of Housing and Urban Development's Section 202 Supportive Housing Program for the Elderly.

**BOROUGH OF MANHATTAN
Nos. 3, 4 & 5
DEPARTMENT OF SANITATION GARAGE**

CD 2 C 080281 ZSM
IN THE MATTER OF an application submitted by the New York City Department of Sanitation pursuant to Sections 197-c and 201 of the New York City Charter for the grant of a special permit pursuant to Section 74-743(a)(2) of the Zoning Resolution to modify the requirements of Section 43-40 (Height and Setback Regulations) and Section 43-20 (Yard Regulations) to allow a proposed garage building to be located without regard for the applicable height and setback and rear yard regulations, on property located at 500 Washington Street (Block 596, Lot 50), in an M2-4 District, within a General Large-Scale Development.

Plans for this proposal are on file with the City Planning Commission and may be seen in Room 3N, 22 Reade Street, New York, N.Y. 10007.

**No. 4
CD 2 C 080279 PSM**
IN THE MATTER OF an application submitted by the Department of Sanitation and the Department of Citywide Administrative Services, pursuant to Section 197-c of the New York City Charter for the site selection of property located at 553 Canal Street/297 West Street (Block 595, Lot 87) for use as a salt storage facility.

**No. 5
CD 2 C 080280 PCM**
IN THE MATTER OF an application submitted by the

Department of Sanitation and the Department of Citywide Administrative Services, pursuant to Section 197-c of the New York City Charter, for the site selection and acquisition of property located at 500 Washington Street (Block 596, lot 50) for use as a garage.

NOTICE

On Wednesday, August 27, 2008, at 10:00 A.M. at the Department of City Planning, 22 Reade Street, in Lower Manhattan, a public hearing is being held in Spector Hall by the New York City Department of Sanitation in conjunction with the above ULURP hearing to receive comments related to a Draft Environmental Impact Statement (DEIS) concerning the Site Selection and Acquisition of property for use as a Sanitation Garage for Manhattan Districts 1, 2, and 5 and the Site Selection of property for use as a Salt Shed; and a Special Permit pursuant to Section 74-743 (Special Provisions for Bulk Modifications) Resolution (ZR) to modify Section 43-40 (Height & Setback Regulations), Section 43-43 (Maximum Height of Front Wall and Required Front Setbacks), Section 43-20 (Yard Regulations) and Section 43-28 (Special Provisions for Through Lots); and an Authorization pursuant to Section 13-50 (Special Permits and Authorizations) and 13-553 (Curb Cuts) for Curb Cuts on a Wide Street. The actions would facilitate the construction of a new Department of Sanitation garage complex and salt shed to be located on Spring Street between Washington Street and West Street/Route 9A (Block 596, Lot 50 and Block 595, Lot 87) in Manhattan Community District 2.

This hearing is being held pursuant to the State Environmental Quality Review Act (SEQRA) and City Environmental Quality Review (CEQR), CEQR No. 07DOS003M.

**Nos. 6 & 7
HARBORVIEW
No. 6**

CD 4 C 080400 ZSM
IN THE MATTER OF an application submitted by the New York City Housing Authority and the Department of Housing Preservation and Development pursuant to Sections 197-c and 201 of the New York City Charter for the grant of a special permit pursuant Section 78-312(d) of the Zoning Resolution to allow modifications of the front height and setback regulations on the periphery of a Large-Scale Residential Development (Block 1083, Lots 1 & 15, and Block 1084, Lot 9) in connection with the development of two residential buildings on property located at 513 West 55th Street and 520 West 56th Street (Block 1084, p/o Lot 9), within the Clinton Urban Renewal Area, in an R8 District.

Plans for this proposal are on file with the City Planning Commission and may be seen in Room 3N, 22 Reade Street, New York, N.Y. 10007.

No. 7

CD 4 C 080401 ZSM
IN THE MATTER OF an application submitted by the New York City Housing Authority and the Department of Housing Preservation and Development pursuant to Sections 197-c and 201 of the New York City Charter for the grant of a special permit pursuant Section 74-681(a)(1) of the Zoning Resolution to allow that portion of the railroad or transit right-of-way which will be completely covered over by a permanent platform to be included in the lot area in connection with the development of two residential buildings on property located at 513 West 55th Street and 520 West 56th Street (Block 1084, p/o Lot 9), in a Large-Scale Residential Development (Block 1083, Lots 1 & 15, and Block 1084, Lot 9), within the Clinton Urban Renewal Area, in an R8 District.

Plans for this proposal are on file with the City Planning Commission and may be seen in Room 3N, 22 Reade Street, New York, N.Y. 100

**No. 8
BILTMORE GARAGE**

CD 5 C 030513 ZSM
IN THE MATTER OF an application submitted by Biltmore

water and sewer lines, pipes, equipment and related apparatus and further the exclusive right by the City in such space 1.35 feet below the curb level to license or grant utilities a right to install, replace and maintain such utilities therein, including, without limitation, electric, gas, telephone and communication cables, lying within the lines of any street shown on the acquisition map.

d. All equipment and other property of the City, including, but not limited to, police and fire communication lines, necessary for the maintenance of the public health and safety and having a physical manifestation within the property interests being acquired or located in any space more than 1.35 feet below any street; all recorded easements, licenses, and other agreements, if any, for such equipment and other property of the City; and reasonable rights of access to all such equipment and other property of the City necessary for the maintenance, operation, repair, replacement or use of the same whether or not embodied in recorded instruments.

e. All agreements previously entered into by and between the City and The Port Authority of New York and New Jersey (the "Port Authority") with respect to the property interests described on the acquisition map, whether or not embodied in recorded instruments.

The property interests to be acquired in this proceeding shall also be subject to: (a) the Tie-Back Easement Terms agreed to between the Port Authority and LMDC; and (b) the use restrictions and other restrictions and requirements set forth in the Declarations of Restrictive Covenant, dated December 5, 2007, between the Port Authority and the City, more particularly described and defined as the Cortlandt Street Right of Way and the Dey Street Right of Way. In addition to the exclusions listed above, the City shall have the right to retain, install, maintain, repair, operate and replace any equipment or property necessary for the maintenance of the public health and safety within the property interests being acquired in this proceeding, or located in any space more than 1.35 feet below any street.

Such restrictions and requirements shall run with the land and shall only bind LMDC for so long as LMDC holds title to the property interests affected thereby, but shall be forever binding upon LMDC's transferees or assignees (whether direct or remote), including, without limitation, the Port Authority.

No existing agreements or understandings by or between the City and the Port Authority with respect to any of the above-noted property interests including, without limitation, their use, operation, repair, restriction or maintenance, whether direct or indirect, shall be affected or modified by their condemnation, acquisition or transfer.

PLEASE TAKE FURTHER NOTICE that a diagram or representation of the acquisition map, which shows the perimeters of the property to be acquired, is set forth below:

August 11, 2008

LOWER MANHATTAN DEVELOPMENT CORPORATION
One Liberty Plaza, 20th floor New York, New York 10006
Tel. (212) 962-2300

By: Irene Chang
General Counsel and Secretary

Schedule A

PARCEL 2. Surface rights above 1.35 feet below top of curb in a parcel of land approximately 221 feet along the former southerly line of Vesey Street, as eliminated per Map Acc. No. 29910, between the westerly line of the former Washington Street, as eliminated per Map Acc. No. 29910, and the former easterly line of West Street, as eliminated per Map Acc. No. 29910, extending northerly approximately 14 feet.

PARCEL 3. Subsurface rights 1.35 feet below top of curb in a portion of the bed of Greenwich Street (creating a rectangle-like shape beginning from the corner formed by the intersection of the southerly line of Vesey Street and the easterly line of Greenwich Street, extending southerly approximately 48 feet along the easterly line of Greenwich Street, and extending westerly approximately 70 feet into the bed of Greenwich Street.)

PARCEL 6. Surface rights above 1.35 feet below top of curb in an "L"-shaped parcel of land measured from a point approximately 12 feet south of the corner formed by the intersection of the former southerly line of Vesey Street, as eliminated per Map Acc. No. 29910, and the former westerly line of Church Street, as eliminated per Map Acc. No. 29910, extending southerly approximately 149 feet along the former westerly line of Church Street, extending from the same point westerly approximately 401 feet between Church and Greenwich Streets, and extending southerly from the prior course approximately 70 feet.

PARCEL 7. Surface rights above 1.35 feet below top of curb in a portion of Fulton Street (creating a triangle-like shape beginning at a point approximately 37 feet west along the northerly line of Fulton Street from the corner formed by the intersection of the northerly line of Fulton Street and the former westerly line of Church Street, as eliminated per Map Acc. No. 29910, extending westerly approximately 24 feet along the northerly line of Fulton Street, and extending approximately 3 feet into the bed of Fulton Street).

PARCEL 8. In a sliver of Church Street (creating a triangle-like shape measured from a point approximately 5 feet north along the former westerly line of Church Street, as eliminated per Map Acc. No. 29910, from the corner formed by the intersection of the northerly line of Fulton Street with the former westerly line of Church Street, extending approximately 97 feet northerly along the former westerly

line of Church Street, and extending from the same point approximately 3 feet into the bed of Church Street).

PARCEL 9. Subsurface rights 1.35 feet below top of curb in a portion of the bed of Church Street (creating a triangle-like shape beginning at the corner formed by the intersection of the former southerly line of Fulton Street, as eliminated per Map Acc. No. 29910, and the former westerly line of Church Street, as eliminated per Map Acc. No. 29910, extending northerly approximately 91 feet, and extending westerly approximately 16 feet from the prior course).

PARCEL 11B. Surface rights above 1.35 feet below top of curb in a portion of the bed of Dey Street beginning at a point that is approximately 14.6 feet west from the intersection of the former westerly line of Church Street, as eliminated per Map Acc. No. 29910, and the northerly line of Dey Street, extending westerly approximately 101 feet along the northerly line of Dey Street, and extending between the northerly and southerly lines of Dey Street.

PARCEL 13. Surface rights above 1.35 feet below top of curb in a portion of the bed of Dey Street (creating a triangle-like shape beginning at a point approximately 15 feet west along the southerly line of Dey Street from the corner formed by the intersection of the southerly line of Dey Street and the former westerly line of Church Street, as eliminated per Map Acc. No. 29910, extending westerly approximately 40 feet along the southerly line of Dey Street, and extending from the same point approximately 5 feet northerly into the bed of Dey Street).

PARCEL 14. Subsurface rights 1.35 feet below top of curb in a portion of the bed of Church Street along the former westerly line of Church Street, as eliminated per Map Acc. No. 29910, between the northerly line of Cortlandt Street and the former southerly line of Fulton Street, as eliminated per Map Acc. No. 29910, extending approximately 10 feet easterly into the bed of Church Street).

PARCEL 16A. Surface rights above 1.35 feet below top of curb in an "L"-shaped parcel of land being in a portion of the bed of Cortlandt Street, beginning at the corner formed by the intersection of the westerly line of Church Street and the northerly line of Cortlandt Street, extending easterly approximately 111 feet along the northerly line of Cortlandt Street, and extending from the prior course approximately 45 feet south into the bed of Cortlandt Street).

PARCEL 17. Surface rights above 1.35 feet below top of curb in a portion of Cortlandt Street (creating a rectangle-like shape beginning at a point approximately 13 feet west along the southerly line of Cortlandt Street from the corner formed by the intersection of the southerly line of Cortlandt Street and the former westerly line of Church Street, as eliminated per Map Acc. No. 29910, extending approximately 53 feet westerly along the southerly line of Cortlandt Street, and extending from the same point approximately 5 feet northerly into the bed of Cortlandt Street).

PARCEL 18. In a sliver of Greenwich Street (creating a triangle-like shape beginning at a point approximately 24 feet north along the former easterly line of Greenwich Street, as eliminated by Map Acc. No. 29910, from the corner formed by the intersection of the former easterly line Greenwich Street and the former northerly line of Liberty Street, as eliminated per Map Acc. No. 29910, extending northerly approximately 47 feet along the former easterly line of Greenwich Street, and extending from the prior course approximately 3 feet into the bed of Greenwich Street).

PARCEL 19. Surface rights above 1.35 feet below top of curb in an "L"-shaped parcel of land beginning at a point approximately 47 feet south along the former easterly line of Greenwich Street, as eliminated per Map Acc. No. 29910, from the corner formed by the intersection of the northerly line of Liberty Street and the former easterly line of Greenwich Street, extending approximately 238 feet easterly, extending from the prior course approximately 203 feet northerly to a point on the southerly line of Cortlandt Street approximately 13 feet west of the corner formed by the intersection of the southerly line of Cortlandt Street and the former westerly line of Church Street, as eliminated by Map Acc. No. 29910, and extending from the prior course westerly along the southerly line of Cortlandt Street approximately 53 feet.

PARCEL 20. Subsurface rights 1.35 feet below top of curb in a portion of the beds of Greenwich and Liberty Streets (creating a rectangle-like shape beginning at a point in the bed of Liberty Street approximately 31 feet north of the corner formed by the intersection of the southerly line of Liberty Street and the westerly line of Greenwich Street, extending approximately 87 feet northerly, and extending from the prior course approximately 65 feet easterly into the bed of Greenwich Street).

PARCELS 22, 38 & 39. Surface rights above 1.35 feet below top of curb in an irregular-shaped parcel of land along the northerly line of Liberty Street as widened between the easterly line of West Street and the westerly line of Greenwich Street, extending southerly from the northerly line of Liberty Street into the bed of Liberty Street approximately 55 feet.

PARCEL 40. Surface rights above 1.35 feet below top of curb, in a parcel of land in a portion of the bed of Vesey Street (creating a rectangle-like shape beginning at the corner formed by the intersection of the southerly line of Vesey Street with the westerly line of the former Washington Street, extending easterly approximately 64 feet, and extending from the prior course northerly approximately 6 feet.)

PARCEL 41. Surface rights above 1.35 feet below top of curb in a parcel of land in a portion of the bed of Church Street (creating a rectangle-like shape beginning at the corner

formed by the intersection of the former northerly line of Dey Street, as eliminated per Map Acc. No. 29910, and the former westerly line of Church Street, as eliminated per Map Acc. No. 29910, extending westerly along the former northerly line of Dey Street approximately 114 feet to a point on the westerly line of Church Street, and extending northerly from the prior course approximately 153 feet along the westerly line of Church Street).

PARCEL 42. Surface rights above 1.35 feet below top of curb in a parcel of land in a portion of the bed of Church Street (creating a rectangle-like shape beginning at the corner formed by the intersection of the former southerly line of Dey Street, as eliminated per Map Acc. No. 29910, and the former westerly line of Church Street, as eliminated per Map Acc. No. 29910, extending southerly approximately 214 feet along the former westerly line of Church Street between the former southerly line of Dey Street and the former northerly line of Cortlandt Street, as eliminated per Map Acc. No. 29910, and extending westerly from the prior course approximately 125 feet).

PARCEL A. Subsurface easement extending vertically upward from approximate elevation 210 feet to approximate elevation 298 feet within horizontal limits of a cube — like parcel being approximately 76 feet on its sides in a portion of Vesey Street and West Broadway.

PARCEL B. Subsurface easement extending vertically upward from approximate elevation 217 feet to approximate elevation 303 feet within horizontal limits of a rectangle — like parcel being approximately 57 feet wide by 360 feet long in a portion of Vesey Street between West Broadway and Church Street.

PARCEL C. Subsurface easement extending vertically upward from approximate elevation 215 feet to approximate elevation 303 feet within horizontal limits of a portion of Church Street between southerly line of Vesey Street and the southerly line of Fulton Street approximately 70 feet wide by 210 feet long.

PARCEL D. Subsurface easement extending vertically upward from approximate elevation 210 feet to approximate elevation 299 feet within horizontal limits of a rectangle — like parcel being approximately 80 feet wide and 424 feet long in a portion of Church Street between Fulton and Cortlandt Streets.

PARCEL E. Subsurface easement extending vertically upward from approximate elevation 194 feet to approximate elevation 298 feet within horizontal limits of an irregular shape parcel in Church and Cortlandt Streets approximately 114 feet wide and 218 feet long.

PARCEL F. Subsurface easement extending vertically upward from approximate elevation 210 feet to approximate elevation 303 feet within horizontal limits of an irregular-shaped parcel within the beds of Liberty and Church Streets and the intersection of Liberty and Church Streets approximately 54 feet wide in Liberty Street and approximately 80 feet wide in Church Street.

PARCEL G. Subsurface easement extending vertically upward from approximate elevation 217 feet to approximate elevation 303 feet within horizontal limits of a rectangular-like parcel being approximately 54 feet wide and 186 feet long in a portion of Liberty Street between Greenwich Street and Trinity Place.

PARCEL K. Subsurface easement vertically upward from approximate elevation of 214 feet to approximate elevation 265 feet within horizontal limits of a parcel within Vesey Street being approximately 54 feet wide between West Street and West Broadway and a portion of Washington Street being approximately 63 feet wide.

NOTE: With respect to the foregoing permanent easements set forth in **Parcels A-G** and **Parcel K**, the project elevation 300 feet is 2.653 feet above the National Geodetic Vertical Datum of 1929.

The coordinates and bearings set forth in the above easement descriptions refer to the 10th Avenue Meridian as established by the Borough of Manhattan Topographical Bureau with Grid north being 28 degrees 59 minutes 13.5 seconds east of true north.

(SEE MAPS ON BACK PAGES)

a11-22

PROPERTY DISPOSITION

CITYWIDE ADMINISTRATIVE SERVICES

DIVISION OF MUNICIPAL SUPPLY SERVICES

■ AUCTION

PUBLIC AUCTION SALE NUMBER 09001-D

NOTICE IS HEREBY GIVEN of a bi-weekly public auction of City fleet vehicles consisting of cars, vans, light duty vehicles, trucks, heavy equipment and miscellaneous automotive equipment to be held on Wednesday, August 20, 2008 (Sale Number 09001-D). This auction is held every other Wednesday unless otherwise notified. Viewing is on auction day only from 8:30 A.M. until 9:00 A.M. The auction begins at 9:00 A.M.

COURT NOTICE MAPS FOR WORLD TRADE CENTER

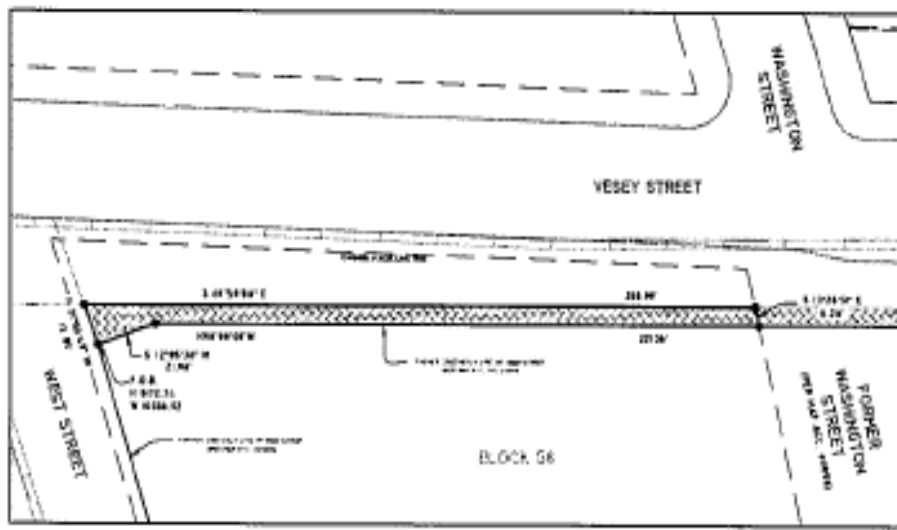

PARCEL 2

NOTE: PARCEL 2 IS LOCATED ABOVE A PLANE 1.35 FEET BELOW CURB GRADE

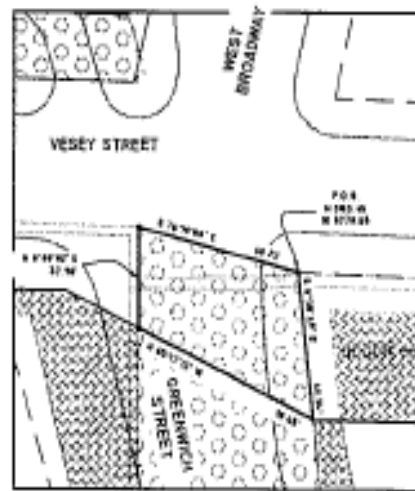

PARCEL 3

NOTE: PARCEL 3 IS LOCATED BELOW A PLANE 1.35 FEET BELOW CURB GRADE

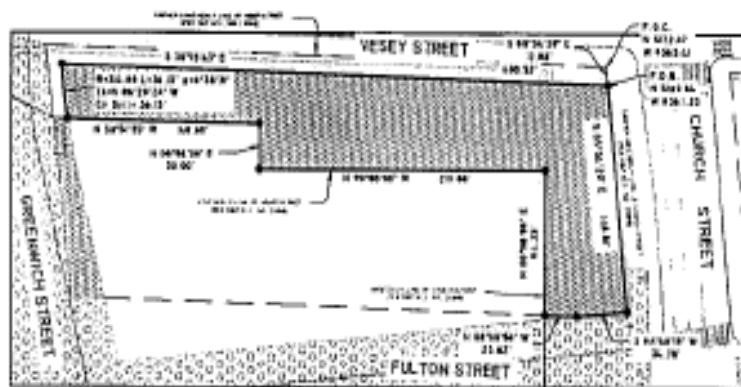

PARCEL 6

NOTE: PARCEL 6 IS LOCATED ABOVE A PLANE 1.35 FEET BELOW CURB GRADE

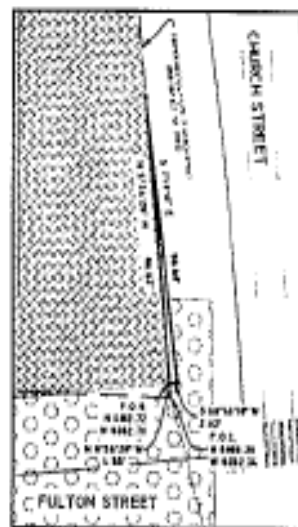

PARCEL 8

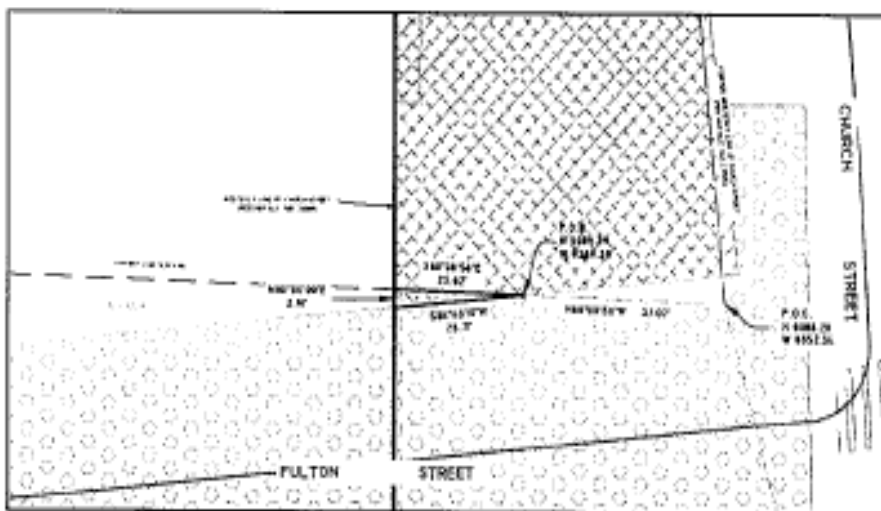

PARCEL 7

NOTE: PARCEL 7 IS LOCATED ABOVE A PLANE 1.35 FEET BELOW CURB GRADE

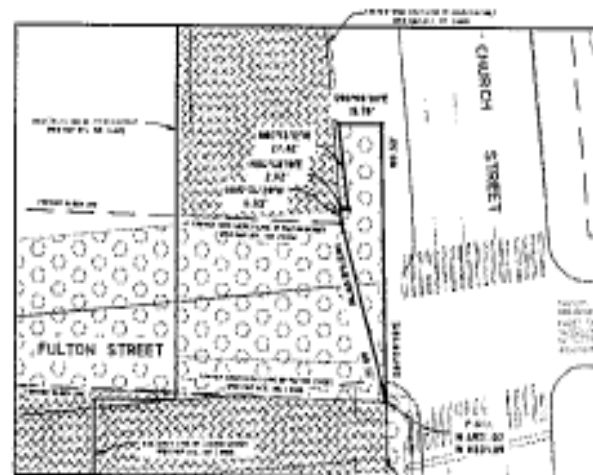

PARCEL 9

NOTE: PARCEL 9 IS LOCATED BELOW A PLANE 1.35 FEET BELOW CURB GRADE

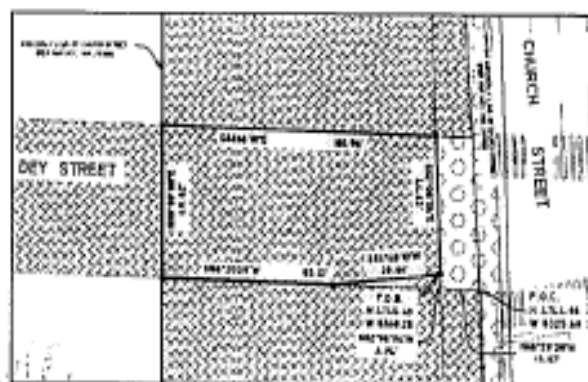

PARCEL 11-B

NOTE: PARCEL 11-B IS LOCATED ABOVE A PLANE 1.35 FEET BELOW CURB GRADE



ACQUISITION

1. THE CITY OF NEW YORK PRESENTS TO THE BOARD OF SUPERVISORS FOR APPROVAL AND ADOPTION, AND TO THE CITY OF NEW YORK PRESENTS TO THE BOARD OF SUPERVISORS FOR APPROVAL AND ADOPTION, A PLAN OF ACQUISITION OF CERTAIN REAL PROPERTY IN THE CITY OF NEW YORK, TO BE ACQUIRED BY THE CITY OF NEW YORK FOR THE PURPOSES OF THE WORLD TRADE CENTER DOWNTOWN REDEVELOPMENT PROJECT.
2. THE CITY OF NEW YORK PRESENTS TO THE BOARD OF SUPERVISORS FOR APPROVAL AND ADOPTION, A PLAN OF ACQUISITION OF CERTAIN REAL PROPERTY IN THE CITY OF NEW YORK, TO BE ACQUIRED BY THE CITY OF NEW YORK FOR THE PURPOSES OF THE WORLD TRADE CENTER DOWNTOWN REDEVELOPMENT PROJECT.
3. THE CITY OF NEW YORK PRESENTS TO THE BOARD OF SUPERVISORS FOR APPROVAL AND ADOPTION, A PLAN OF ACQUISITION OF CERTAIN REAL PROPERTY IN THE CITY OF NEW YORK, TO BE ACQUIRED BY THE CITY OF NEW YORK FOR THE PURPOSES OF THE WORLD TRADE CENTER DOWNTOWN REDEVELOPMENT PROJECT.

NOTE

1. THE CITY OF NEW YORK PRESENTS TO THE BOARD OF SUPERVISORS FOR APPROVAL AND ADOPTION, A PLAN OF ACQUISITION OF CERTAIN REAL PROPERTY IN THE CITY OF NEW YORK, TO BE ACQUIRED BY THE CITY OF NEW YORK FOR THE PURPOSES OF THE WORLD TRADE CENTER DOWNTOWN REDEVELOPMENT PROJECT.
2. THE CITY OF NEW YORK PRESENTS TO THE BOARD OF SUPERVISORS FOR APPROVAL AND ADOPTION, A PLAN OF ACQUISITION OF CERTAIN REAL PROPERTY IN THE CITY OF NEW YORK, TO BE ACQUIRED BY THE CITY OF NEW YORK FOR THE PURPOSES OF THE WORLD TRADE CENTER DOWNTOWN REDEVELOPMENT PROJECT.

THE CITY OF NEW YORK PRESENTS TO THE BOARD OF SUPERVISORS FOR APPROVAL AND ADOPTION, A PLAN OF ACQUISITION OF CERTAIN REAL PROPERTY IN THE CITY OF NEW YORK, TO BE ACQUIRED BY THE CITY OF NEW YORK FOR THE PURPOSES OF THE WORLD TRADE CENTER DOWNTOWN REDEVELOPMENT PROJECT.

THE CITY OF NEW YORK PRESENTS TO THE BOARD OF SUPERVISORS FOR APPROVAL AND ADOPTION, A PLAN OF ACQUISITION OF CERTAIN REAL PROPERTY IN THE CITY OF NEW YORK, TO BE ACQUIRED BY THE CITY OF NEW YORK FOR THE PURPOSES OF THE WORLD TRADE CENTER DOWNTOWN REDEVELOPMENT PROJECT.



Handwritten signatures of Kenneth J. Stierman and Robert Kelly, L.L.C.

ACQUISITION MAP
IN THE CITY OF NEW YORK
TO CERTAIN REAL PROPERTY REQUIRED FOR
THE WORLD TRADE CENTER
DOWNTOWN REDEVELOPMENT PROJECT

COURT NOTICE MAPS FOR WORLD TRADE CENTER

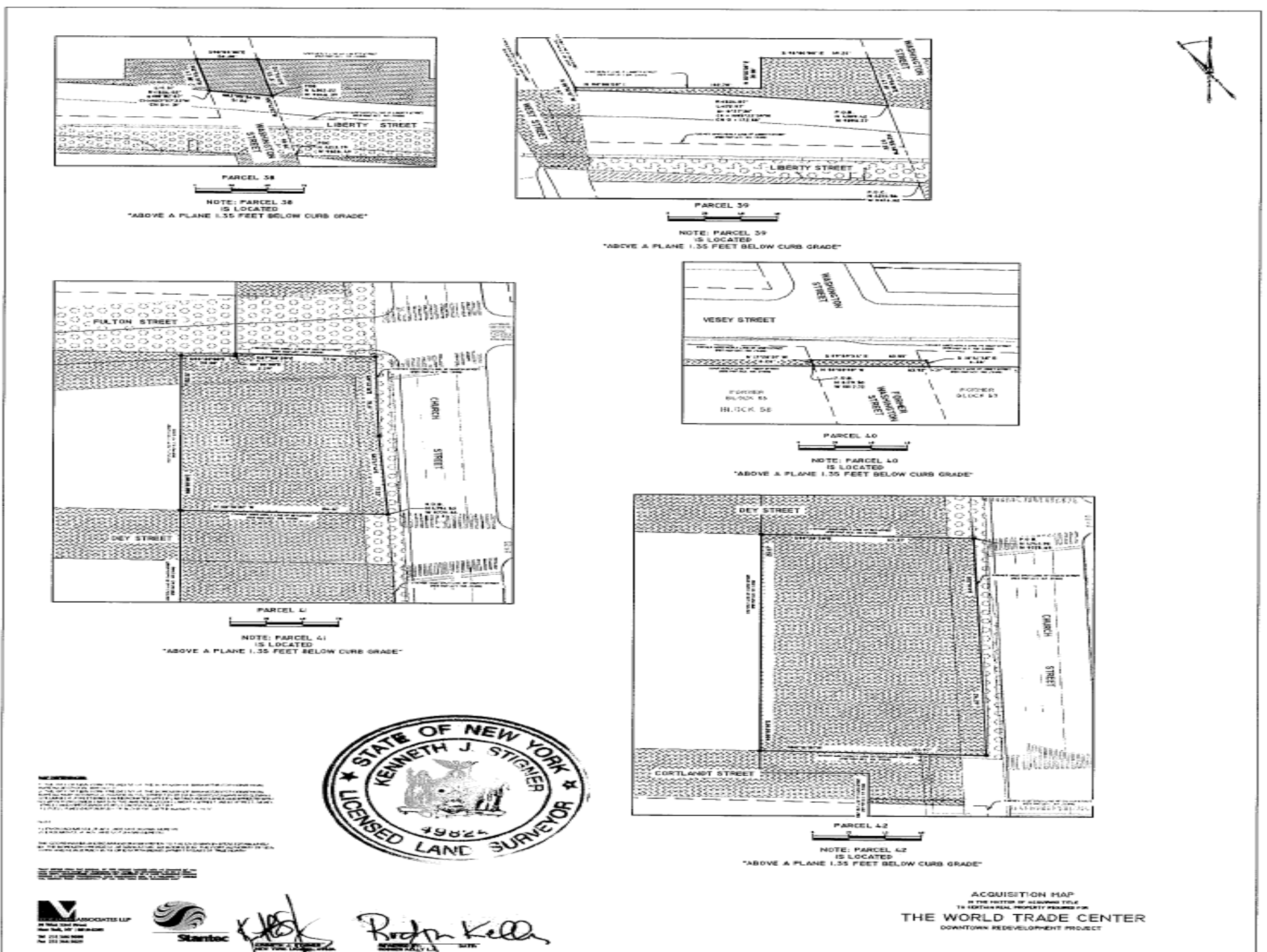
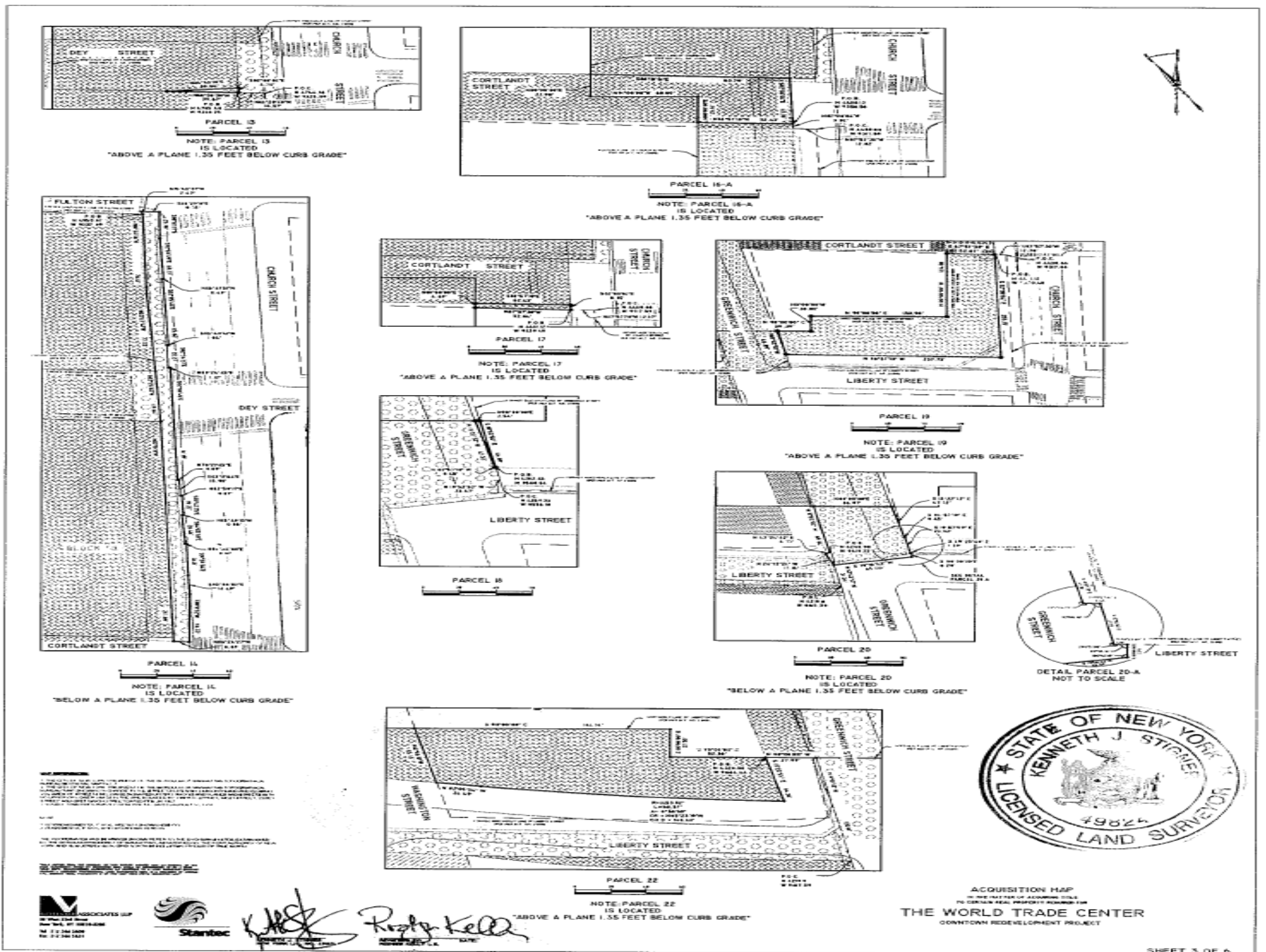

COURT NOTICE MAPS FOR WORLD TRADE CENTER

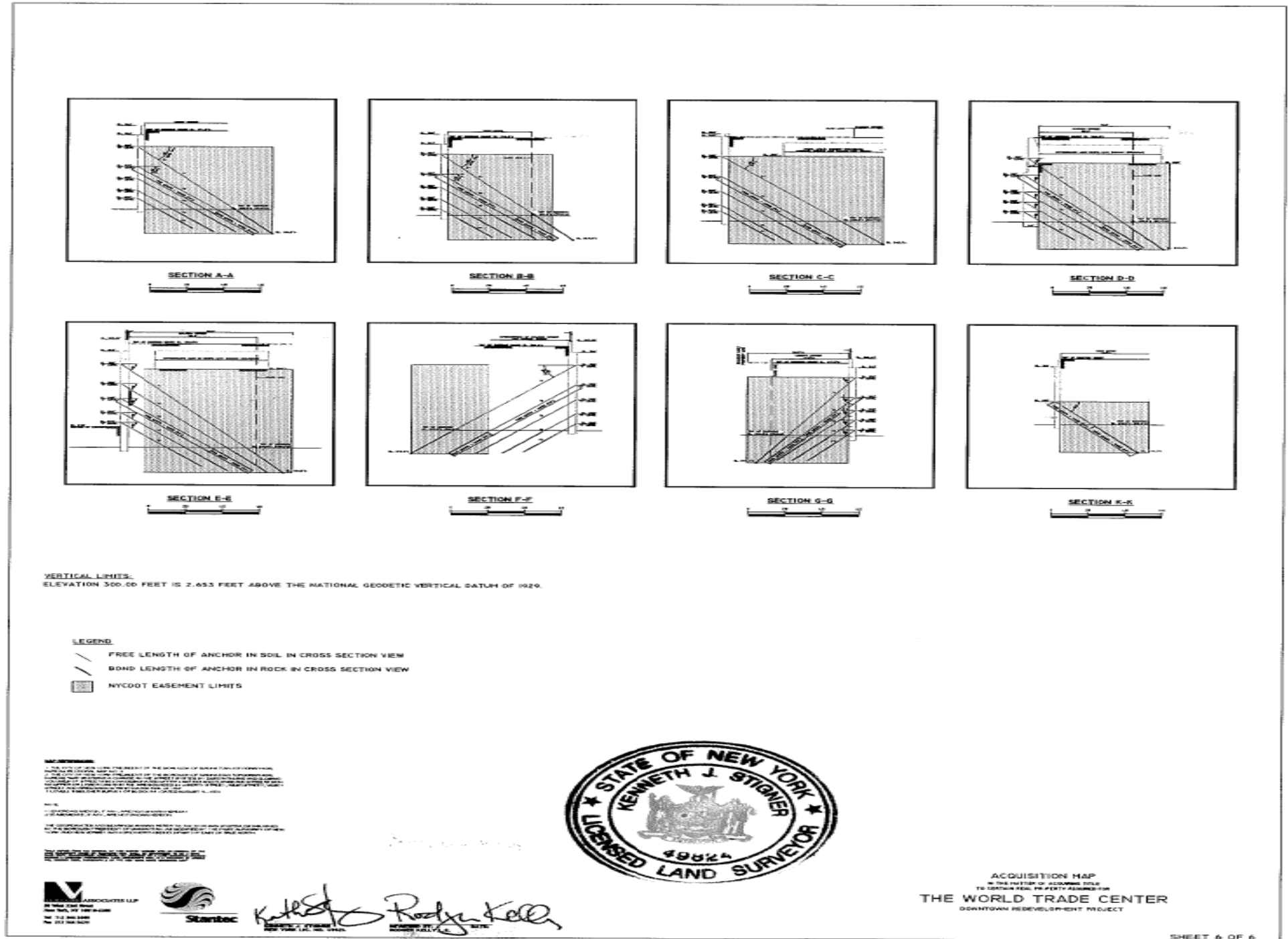
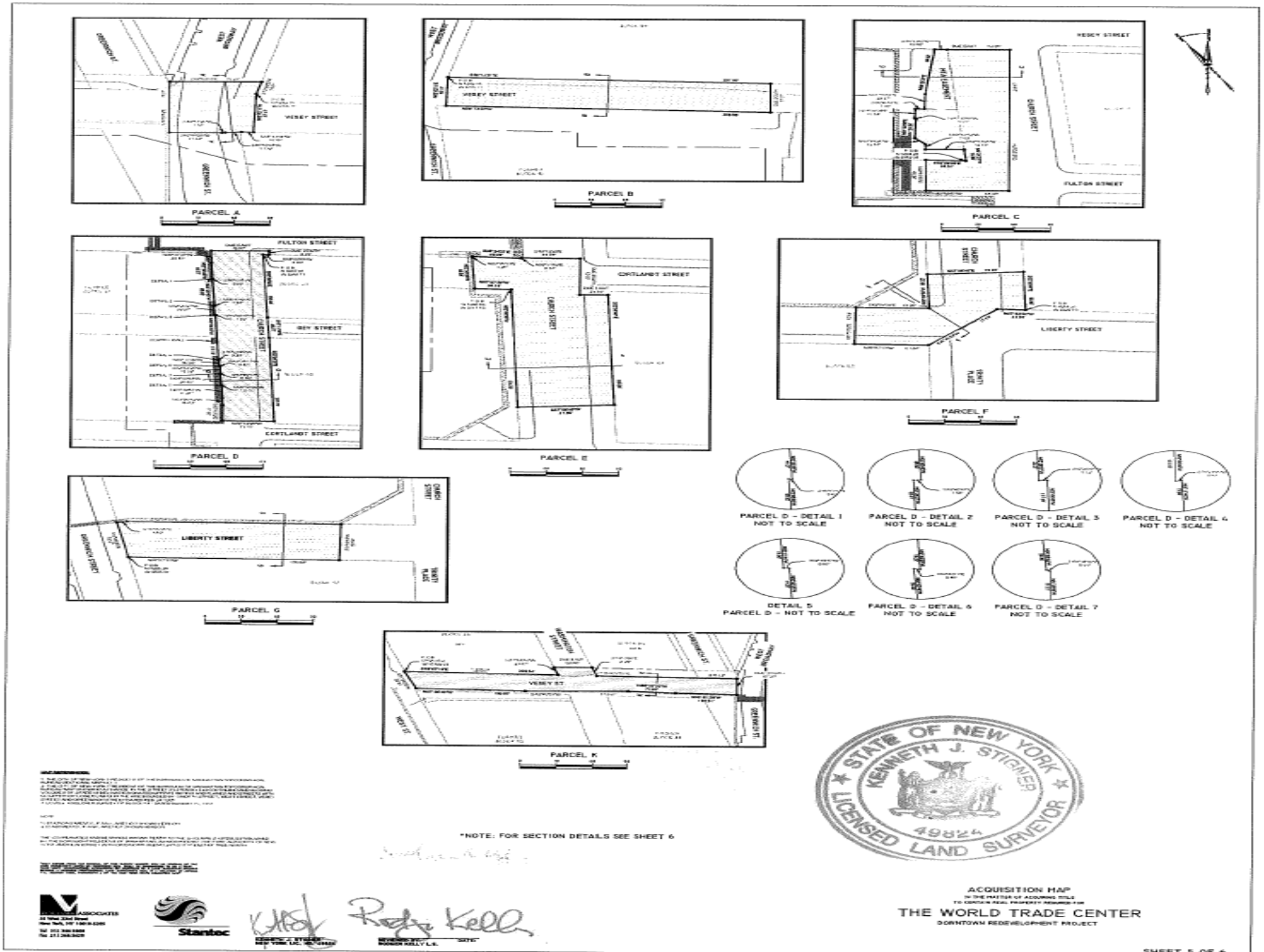

READER'S GUIDE

The City Record (CR) is, published each business day and includes notices of proposed New York City procurement actions, contract awards, and other procurement-related information. Solicitation notices for most procurements valued at or above \$100,000 for information technology and for construction and construction related services, above \$50,000 for other services, and above \$25,000 for other goods are published for at least one day. Other types of procurements, such as sole source, require notice in the City Record for five consecutive days. Unless otherwise specified, the agencies and offices listed are open for business Mondays thru Fridays from 9:00 A.M. to 5:00 P.M. except legal holidays.

NOTICE TO ALL NEW YORK CITY CONTRACTORS

The New York State Constitution ensures that all laborers, workers or mechanics employed by a contractor or subcontractor doing public work are to be paid the same wage rate that prevails in the trade where the public work is being done. Additionally, New York State Labor Law §§ 220 and 230 provide that a contractor or subcontractor doing public work in construction or building service must pay its employees no less than the prevailing wage. Section 6-109 (the Living Wage Law) of the New York City Administrative Code also provides for a "living wage", as well as prevailing wage, to be paid to workers employed by City contractors in certain occupations. The Comptroller of the City of New York is mandated to enforce prevailing wage. Contact the NYC Comptrollers Office at www.comptroller.nyc.gov, click on Labor Law Schedules to view rates.

New York City's "Burma Law" (Local Law No. 33 of 1997) No Longer to be Enforced. In light of the United States Supreme Court's decision in **Crosby v. National Foreign Trade Council**, 530 U.S. 363 (2000), the City has determined that New York City's Local Law No. 33 of 1997 (codified in Administrative Code Section 6-115 and Charter Section 1524), which restricts City business with banks and companies doing business in Burma, is unconstitutional. This is to advise, therefore, that the language relating to Burma contained in existing New York City contracts may not be enforced.

CONSTRUCTION/CONSTRUCTION SERVICES OR CONSTRUCTION RELATED SERVICES

The City of New York is committed to achieving excellence in the design and construction of its capital program, and building on the tradition of innovation in architecture and engineering that has contributed to the City's prestige as a global destination.

VENDOR ENROLLMENT APPLICATION

New York City procures approximately \$7 billion worth of goods, services, construction and construction-related services every year. The NYC Procurement Policy Board Rules require that agencies primarily solicit from established mailing lists called bidder/proposer lists. To register for these lists-free of charge-, prospective suppliers should fill out and submit the NYC-FMS Vendor Enrollment application.

- Online at NYC.gov/selltonyc
- To request a hardcopy application, call the Vendor Enrollment Center at (212) 857-1680.

Attention Existing Suppliers:

Even if you already do business with NYC agencies, be sure to fill out an application. We are switching over to citywide, centralized Bidders Lists instead of the agency-specific lists previously used to issue notices about upcoming contract opportunities. To continue receiving notices of New York City contract opportunities, you must fill out and submit a NYC-FMS Vendor Enrollment application.

If you are uncertain whether you have already submitted an application, call us at (212) 857-1680.

SELLING TO GOVERNMENT TRAINING WORKSHOP

New and experienced vendors are encouraged to register for a free training course on how to do business with New York City. "Selling to Government" workshops are conducted by the Department of Small Business Services, 110 William Street, New York, NY 10038. Morning and afternoon sessions are convened on the first Tuesday of each month. For more information, and to register, call (212) 618-8845.

PRE-QUALIFIED LIST

New York City procurement policy permits agencies to develop and solicit from pre-qualified lists of vendors, under prescribed circumstance. When it is decided by an agency to develop a pre-qualified list, criteria for pre-qualification must be clearly explained in the solicitation and notice of the opportunity to pre-qualify for that solicitation must be published in at least five issues of the CR.

Information and qualification questionnaires for inclusion on such list may be obtained directly from the Agency Chief Contracting Officer at each agency, (see Vendor Information Manual). A completed qualification Questionnaire may be submitted to the Chief Contracting Officer at any time, unless otherwise indicated and action (approval or denial) shall be taken by the agency within 90 days from the date of submission. Any denial or revocation of pre-qualified status can be appealed to the Office of Administrative Trials and Hearings, (OATH), Section 3-11 of the Procurement Policy Board Rules describes the criteria for the general use of pre-qualified lists.

NON-MAYORAL ENTITIES

The following agencies are not subject to Procurement Policy Board rules and do not follow all of the above procedures: City University, Department of Education, Metropolitan Transportation Authority, Health & Hospitals Corporation, Housing Authority. Suppliers interested in applying for inclusion on bidders list should contact these entities directly (see Vendor Information Manual) at the addresses given.

PUBLIC ACCESS CENTER

The Public Access Center is available to suppliers and the public as a central source for supplier-related information through on-line computer access. The Center is located at 253 Broadway, 9th floor, in lower Manhattan, and is open Monday through Friday from 10:00 A.M to 3:00 P.M. For information, contact the Mayor's Office of Contract Services at (212) 788-0010.

ATTENTION: NEW YORK CITY MINORITY AND WOMEN OWNED BUSINESS ENTERPRISES

Join the growing number of Minority and Women Owned Business Enterprises (M/WBEs) that are competing for New York City's business. In order to become certified for the program, your company must substantiate that it: (1) is at least fifty-one percent (51%) owned, operated and controlled by a minority or woman and (2) is either located in New York City or has a significant tie to New York City's business community. To obtain a copy of the certification application and to learn more about the program, contact the New York City Department of Small Business Services, 110 William Street, 2nd Floor, New York, New York 10038 (212) 513-6311.

PROMPT PAYMENT

It is the policy of the City of New York to pay its bills promptly. The Procurement Policy Board Rules generally require that the City pay its bills within 30 days after the receipt of a proper invoice. The City now pays interest on all late invoices. The grace period that formerly existed was eliminated on July 1, 2000. However, there are certain types of payments that are not eligible for interest. These are listed in Section 4-06 of the Procurement Policy Board Rules. The Comptroller and OMB determine the interest rate on late payments twice a year, in January and in July.

PROCUREMENT POLICY BOARD RULES

The Rules may also be accessed on the City Website, <http://NYC.GOV.Selltonyc>

COMMON ABBREVIATIONS USED IN THE CR

The CR contains many abbreviations. Listed below are simple explanations of some of the most common ones appearing in the CR:

- AB Acceptable Brands List
- AC Accelerated Procurement
- AMT Amount of Contract
- BL Bidders List
- CSB Competitive Sealed Bidding (including multi-step)
- CB/PQ CB from Pre-qualified Vendor List
- CP Competitive Sealed Proposal (including multi-step)
- CP/PQ CP from Pre-qualified Vendor List
- CR The City Record newspaper
- DA Date bid/proposal documents available
- DUE Bid/Proposal due date; bid opening date
- EM Emergency Procurement
- IG Intergovernmental Purchasing
- LBE Locally Based Business Enterprise
- M/WBE Minority/Women's Business Enterprise
- NA Negotiated Acquisition
- NOTICE....Date Intent to Negotiate Notice was published in CR
- OLB.....Award to Other Than Lowest Responsible & Responsive Bidder/Proposer
- PIN.....Procurement Identification Number
- PPB Procurement Policy Board
- PQ Pre-qualified Vendors List
- RS.....Source required by state/federal law or grant
- SCE Service Contract Short-Term Extension
- DP Demonstration Project
- SS Sole Source Procurement
- ST/FED Subject to State &/or Federal requirements

KEY TO METHODS OF SOURCE SELECTION

The Procurement Policy Board (PPB) of the City of New York has by rule defined the appropriate methods of source selection for City procurement and reasons justifying their use. The CR procurement notices of many agencies include an abbreviated reference to the source selection method utilized. The following is a list of those methods and the abbreviations used:

- CSB **Competitive Sealed Bidding** (including multi-step)
Special Case Solicitations / Summary of Circumstances:
- CP **Competitive Sealed Proposal** (including multi-step)
- CP/1 Specifications not sufficiently definite
- CP/2 Judgement required in best interest of City
- CP/3 Testing required to evaluate
- CB/PQ/4
- CP/PQ/4 **CB or CP from Pre-qualified Vendor List/** Advance qualification screening needed
- DP Demonstration Project
- SS **Sole Source Procurement/**only one source
- RS.....Procurement from a Required Source/ST/FED
- NA.....Negotiated Acquisition
For ongoing construction project only:
- NA/8 Compelling programmatic needs

- NA/9New contractor needed for changed/additional work
- NA/10Change in scope, essential to solicit one or limited number of contractors
- NA/11Immediate successor contractor required due to termination/default
For Legal services only:
- NA/12Specialized legal devices needed; CP not advantageous
- WA **Solicitation Based on Waiver/Summary of Circumstances** (Client Services/BSB or CP only)
- WA1 Prevent loss of sudden outside funding
- WA2 Existing contractor unavailable/immediate need
- WA3 Unsuccessful efforts to contract/need continues
- IG **Intergovernmental Purchasing** (award only)
- IG/F Federal
- IG/S State
- IG/O Other
- EM **Emergency Procurement** (award only) An unforeseen danger to:
- EM/A Life
- EM/B Safety
- EM/C Property
- EM/D A necessary service
- AC **Accelerated Procurement/**markets with significant short-term price fluctuations
- SCE **Service Contract Extension/**insufficient time; necessary service; fair price
Award to Other Than Lowest Responsible & Responsive Bidder or Proposer / Reason (award only)
- OLB/a anti-apartheid preference
- OLB/b local vendor preference
- OLB/c recycled preference
- OLB/d other: (specify)

HOW TO READ CR PROCUREMENT NOTICES

Procurement Notices in the CR are arranged by alphabetically listed Agencies, and within Agency, by Division if any. The notices for each Agency (or Division) are further divided into three subsections: Solicitations, Awards; and Lists & Miscellaneous notices. Each of these subsections separately lists notices pertaining to Goods, Services, or Construction.

Notices of Public Hearings on Contract Awards appear at the end of the Procurement Section. At the end of each Agency (or Division) listing is a paragraph giving the specific address to contact to secure, examine and/or to submit bid or proposal documents, forms, plans, specifications, and other information, as well as where bids will be publicly opened and read. This address should be used for the purpose specified UNLESS a different one is given in the individual notice. In that event, the directions in the individual notice should be followed. The following is a SAMPLE notice and an explanation of the notice format used by the CR.

SAMPLE NOTICE:

POLICE

DEPARTMENT OF YOUTH SERVICES

■ SOLICITATIONS

Services (Other Than Human Services)

BUS SERVICES FOR CITY YOUTH PROGRAM – Competitive Sealed Bids – PIN# 056020000293 – DUE 04-21-03 AT 11:00 A.M.

Use the following address unless otherwise specified in notice, to secure, examine or submit bid/proposal documents, vendor pre-qualification and other forms; specifications/blueprints; other information; and for opening and reading of bids at date and time specified above.

NYPD, Contract Administration Unit, 51 Chambers Street, Room 310, New York, NY 10007. Manuel Cruz (646) 610-5225.

☛ m27-30

ITEM	EXPLANATION
POLICE DEPARTMENT	Name of contracting agency
DEPARTMENT OF YOUTH SERVICES	Name of contracting division
■ SOLICITATIONS	Type of Procurement action
<i>Services (Other Than Human Services)</i>	Category of procurement
BUS SERVICES FOR CITY YOUTH PROGRAM	Short Title
CSB PIN # 056020000293 DUE 04-21-03 AT 11:00 am	Method of source selection Procurement identification number Bid submission due 4-21-03 by 11:00 am; bid opening date/time is the same.
<i>Use the following address unless otherwise specified in notice, to secure, examine-submit bid/proposal documents; etc.</i>	Paragraph at the end of Agency Division listing giving contact information, or submit bid/information or and Agency Contact address
	NYPD, Contract Administration Unit 51 Chambers Street, Room 310 New York, NY 10007. Manuel Cruz (646) 610-5225.
☛	Indicates New Ad
m27-30	Date that notice appears in City Record

NUMBERED NOTES

Numbered Notes are Footnotes. If a Numbered Note is referenced in a notice, the note so referenced must be read as part of the notice. **1.** All bid deposits must be by company certified check or money order made payable to Agency or Company.