

BBJ-XSP Preliminary Field Sampling Summary Report

NYC BOROUGH-BASED JAILS PROGRAM - COMPLETED ENVIRONMENTAL SOIL BORINGS AND TEST PITS

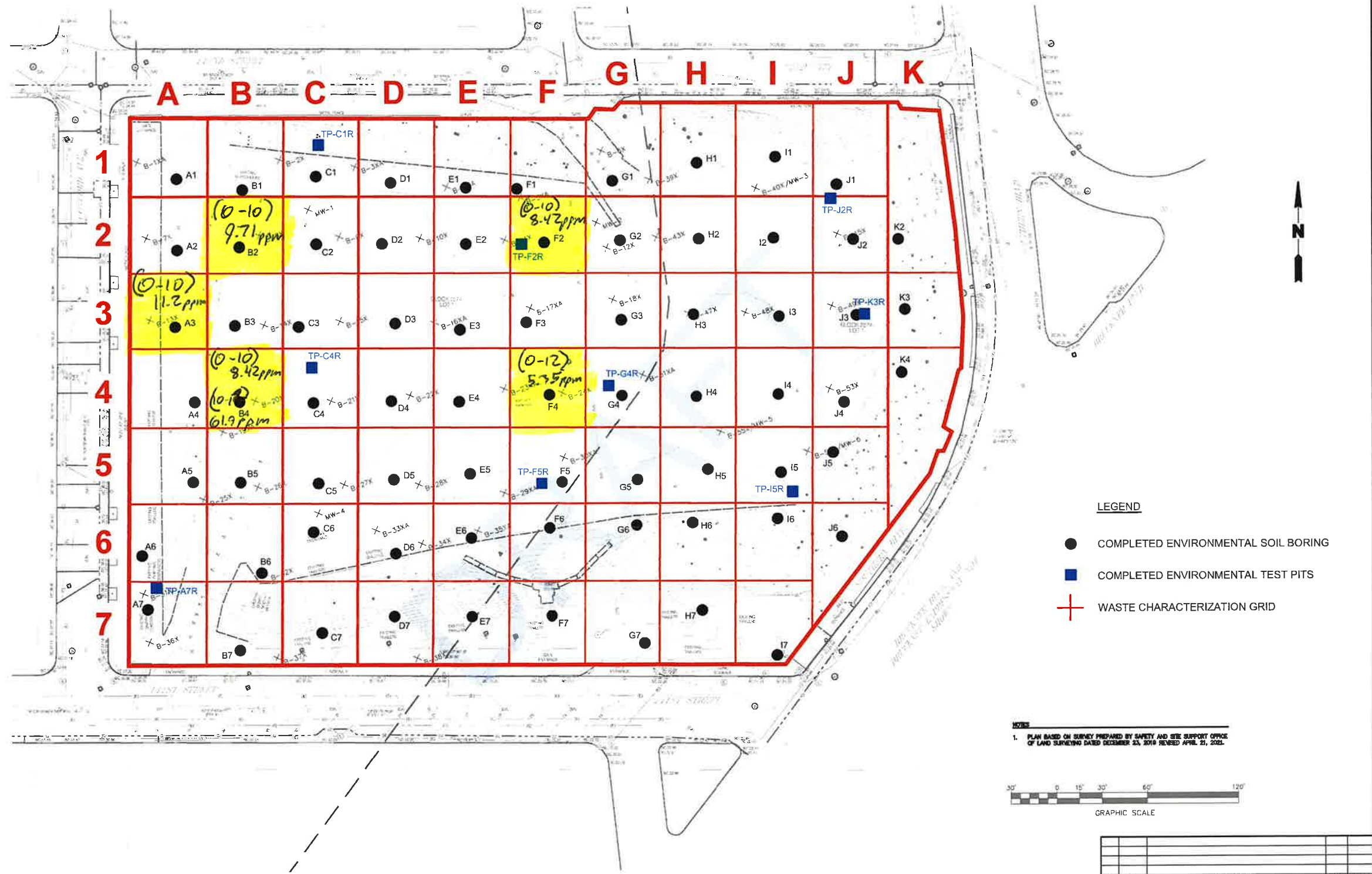

- LEGEND**
- COMPLETED ENVIRONMENTAL SOIL BORING
 - COMPLETED ENVIRONMENTAL TEST PITS
 - ✦ WASTE CHARACTERIZATION GRID

NOTES
 1. PLAN BASED ON SURVEY PREPARED BY SAFETY AND SITE SUPPORT OFFICE OF LAND SURVEYING DATED DECEMBER 23, 2010 REVISED APRIL 21, 2021.

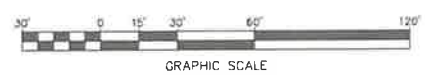

NO.	DATE	DESCRIPTIONS	BY	APPROV

SUBMITTED BY: 	PREPARED BY: ROUX ENVIRONMENTAL ENGINEERING AND GEOLOGY, D.P.C. DRAWN BY:	CONTRACTOR: 	OWNER: 	COMPLETED ENVIRONMENTAL SOIL BORINGS AND TEST PITS B.H.CICIO DRAWN BY: 2549_0011Y108.02.DWG CAD FILE	NYC BOROUGH-BASED JAILS PROGRAM THE BRONX SITE PREPARATION BRONX BOROUGH CAPITAL PROJECT NO. B502021CR000 1P-3 SHEET 2 OF 4 SV-2
-------------------	---	-----------------	------------	---	--

Grid	Interval	TCLP Lead	Date Sampled
A3	0-10	11.2	9-14-2022
B2	0-10	9.71	9-13-2022
B4	0-10	19.7	9-13-2022
B4	10-12	61.9	9-13-2022
F2	0-10	8.42	9-9-2022
F4	0-12	5.35	9-1-2022



Environmental Laboratories, Inc.
 587 East Middle Turnpike, P.O.Box 370, Manchester, CT 06045
 Tel. (860) 645-1102 Fax (860) 645-0823



Analysis Report

September 29, 2022

FOR: Attn: Li Tsang
 NY Environmental
 88-90 Harbor Rd
 Port Washington, NY 11050

Sample Information

Matrix: SOIL
 Location Code: NY-ENV
 Rush Request: Standard
 P.O.#: 2549.0011Y000

Custody Information

Collected by:
 Received by: CP
 Analyzed by: see "By" below

Date Time
 09/14/22 9:45
 09/14/22 17:11

Laboratory Data

SDG ID: GCM31869
 Phoenix ID: CM31869

Project ID: BRONX JAIL
 Client ID: A3 (0-10)

Parameter	Result	RL/ PQL	Units	Dilution	Date/Time	By	Reference
TCLP Silver	ND	0.10	mg/L	1	09/21/22	TH	SW846 1311/6010
TCLP Arsenic	ND	0.10	mg/L	1	09/21/22	TH	SW846 1311/6010
TCLP Barium	0.75	0.10	mg/L	1	09/21/22	TH	SW846 1311/6010
TCLP Cadmium	0.005	J 0.050	mg/L	1	09/21/22	TH	SW846 1311/6010
TCLP Chromium	ND	0.10	mg/L	1	09/21/22	TH	SW846 1311/6010
TCLP Copper	0.02	J 0.10	mg/L	1	09/21/22	TH	SW846 1311/6010
TCLP Mercury	ND	0.0002	mg/L	1	09/19/22	IE	SW846 1311/7470
TCLP Molybdenum	ND	0.50	mg/L	1	09/21/22	TH	SW6010D
TCLP Nickel	ND	0.10	mg/L	1	09/21/22	TH	SW846 1311/6010
TCLP Lead	11.2	0.10	mg/L	1	09/21/22	TH	SW846 1311/6010
TCLP Selenium	ND	0.10	mg/L	1	09/21/22	TH	SW846 1311/6010D
TCLP Zinc	0.12	0.10	mg/L	1	09/21/22	TH	SW846 1311/6010D
TCLP Metals Digestion	Completed				09/18/22	AB/AB	SW3010A
Total Solids @ 104C	70.3	0.1	%	1	09/15/22	PK/DK	SM2540B-15
ASTM C.O.D.	15	10	mg/L	1	09/21/22	AE	SM5220D
ASTM Ammonia Nitrogen	0.11	0.05	mg/L	1	09/20/22	KDB	SM417/E350.2
ASTM Oil/Grease	ND	1.4	mg/L	1	09/23/22	MSF	E1664A MOD
ASTM Total Solids	110	10	mg/L	1	09/21/22	DK/AE	SM209A/E160.3
Volatile Solids @ 500C	15.0	0.1	%	1	09/15/22	PK/DK	SM2540E MOD-15 1
ASTM Extraction	Completed				09/16/22	AB	D 3987 85
TCLP Digestion Mercury	Completed				09/19/22	AB/AB	SW7470A
TCLP Extraction for Metals	Completed				09/16/22	AB	SW1311
TCLP Final PH	6.36		pH Units	1	09/16/22		SW1311/SM4500H+B
Initial pH of TCLP Extraction	9.40		pH units	1	09/16/22		SM423/E150.1

Parameter	Result	RL/ PQL	Units	Dilution	Date/Time	By	Reference
-----------	--------	------------	-------	----------	-----------	----	-----------

1 = This parameter is not certified by the primary accrediting authority (NY NELAC) for this matrix. NY NELAC does not offer certification for all parameters at this time.

RL/PQL=Reporting/Practical Quantitation Level (Equivalent to NELAC LOQ, Limit of Quantitation) ND=Not Detected at RL/PQL
BRL=Below Reporting Level L=Biased Low J=Estimated Below RL

Comments:

Ammonia:

This sample was received with a pH>2 The EPA requires preservation at time of sampling to a pH of <2. A sample bias can not be ruled out.

Oil and Grease:

This sample was received with a pH>=2; pH was adjusted to <2 (EPA requires preservation at time of sampling to a pH of <2.) A sample bias can not be ruled out.

All soils, solids and sludges are reported on a dry weight basis unless otherwise noted in the sample comments.

If you are the client above and have any questions concerning this testing, please do not hesitate to contact Phoenix Client Services at ext.200. The contents of this report cannot be discussed with anyone other than the client listed above without their written consent.

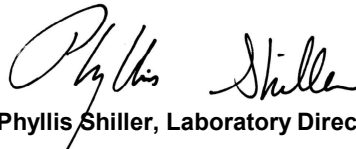

Phyllis Shiller, Laboratory Director

September 29, 2022

Reviewed and Released by: Rashmi Makol, Project Manager



Environmental Laboratories, Inc.
 587 East Middle Turnpike, P.O.Box 370, Manchester, CT 06045
 Tel. (860) 645-1102 Fax (860) 645-0823



Analysis Report

September 29, 2022

FOR: Attn: Li Tsang
 NY Environmental
 88-90 Harbor Rd
 Port Washington, NY 11050

Sample Information

Matrix: SOIL
 Location Code: NY-ENV
 Rush Request: Standard
 P.O.#: 2549.0011Y000

Custody Information

Collected by:
 Received by: CP
 Analyzed by: see "By" below

Date

09/13/22
 09/14/22

Time

13:00
 17:11

Laboratory Data

SDG ID: GCM31852
 Phoenix ID: CM31859

Project ID: BRONX JAIL
 Client ID: B2 (0-10)

Parameter	Result	RL/ PQL	Units	Dilution	Date/Time	By	Reference
TCLP Silver	ND	0.10	mg/L	1	09/21/22	TH	SW846 1311/6010
TCLP Arsenic	ND	0.10	mg/L	1	09/21/22	TH	SW846 1311/6010
TCLP Barium	0.64	0.10	mg/L	1	09/21/22	TH	SW846 1311/6010
TCLP Cadmium	0.028	J 0.050	mg/L	1	09/21/22	TH	SW846 1311/6010
TCLP Chromium	ND	0.10	mg/L	1	09/21/22	TH	SW846 1311/6010
TCLP Copper	0.03	J 0.10	mg/L	1	09/21/22	TH	SW846 1311/6010
TCLP Mercury	ND	0.0002	mg/L	1	09/19/22	IE	SW846 1311/7470
TCLP Molybdenum	ND	0.50	mg/L	1	09/21/22	TH	SW6010D
TCLP Nickel	0.03	J 0.10	mg/L	1	09/21/22	TH	SW846 1311/6010
TCLP Lead	9.71	0.10	mg/L	1	09/21/22	TH	SW846 1311/6010
TCLP Selenium	ND	0.10	mg/L	1	09/21/22	TH	SW846 1311/6010D
TCLP Zinc	5.80	0.10	mg/L	1	09/21/22	TH	SW846 1311/6010D
TCLP Metals Digestion	Completed				09/18/22	AB/AB	SW3010A
Total Solids @ 104C	66.9	0.1	%	1	09/14/22	JW/DK	SM2540B-15
ASTM C.O.D.	10	10	mg/L	1	09/21/22	AE	SM5220D
ASTM Ammonia Nitrogen	0.04	J 0.05	mg/L	1	09/20/22	KDB	SM417/E350.2
ASTM Oil/Grease	ND	1.4	mg/L	1	09/23/22	MSF	E1664A MOD
ASTM Total Solids	81	10	mg/L	1	09/20/22	DK/AE	SM209A/E160.3
Volatile Solids @ 500C	11.7	0.1	%	1	09/14/22	JW/DK	SM2540E MOD-15 1
ASTM Extraction	Completed				09/16/22	AB	D 3987 85
TCLP Digestion Mercury	Completed				09/19/22	AB/AB	SW7470A
TCLP Extraction for Metals	Completed				09/16/22	AB	SW1311
TCLP Final PH	6.26		pH Units	1	09/16/22		SW1311/SM4500H+B
Initial pH of TCLP Extraction	9.40		pH units	1	09/16/22		SM423/E150.1

Parameter	Result	RL/ PQL	Units	Dilution	Date/Time	By	Reference
-----------	--------	------------	-------	----------	-----------	----	-----------

1 = This parameter is not certified by the primary accrediting authority (NY NELAC) for this matrix. NY NELAC does not offer certification for all parameters at this time.

RL/PQL=Reporting/Practical Quantitation Level (Equivalent to NELAC LOQ, Limit of Quantitation) ND=Not Detected at RL/PQL
BRL=Below Reporting Level L=Biased Low J=Estimated Below RL

Comments:

Ammonia:

This sample was received with a pH>2 The EPA requires preservation at time of sampling to a pH of <2. A sample bias can not be ruled out.

Oil and Grease:

This sample was received with a pH>=2; pH was adjusted to <2 (EPA requires preservation at time of sampling to a pH of <2.) A sample bias can not be ruled out.

All soils, solids and sludges are reported on a dry weight basis unless otherwise noted in the sample comments.

If you are the client above and have any questions concerning this testing, please do not hesitate to contact Phoenix Client Services at ext.200. The contents of this report cannot be discussed with anyone other than the client listed above without their written consent.

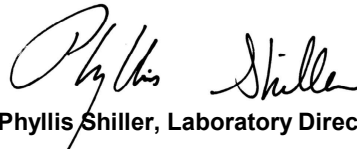

Phyllis Shiller, Laboratory Director

September 29, 2022

Reviewed and Released by: Rashmi Makol, Project Manager



Environmental Laboratories, Inc.
 587 East Middle Turnpike, P.O.Box 370, Manchester, CT 06045
 Tel. (860) 645-1102 Fax (860) 645-0823



Analysis Report

September 29, 2022

FOR: Attn: Li Tsang
 NY Environmental
 88-90 Harbor Rd
 Port Washington, NY 11050

Sample Information

Matrix: SOIL
 Location Code: NY-ENV
 Rush Request: Standard
 P.O.#: 2549.0011Y000

Custody Information

Collected by:
 Received by: CP
 Analyzed by: see "By" below

Date

09/13/22
 09/14/22

Time

11:32
 17:11

Laboratory Data

SDG ID: GCM31852
 Phoenix ID: CM31857

Project ID: BRONX JAIL
 Client ID: B4 (0-10)

Parameter	Result	RL/ PQL	Units	Dilution	Date/Time	By	Reference
TCLP Silver	ND	0.10	mg/L	1	09/21/22	TH	SW846 1311/6010
TCLP Arsenic	ND	0.10	mg/L	1	09/21/22	TH	SW846 1311/6010
TCLP Barium	0.74	0.10	mg/L	1	09/21/22	TH	SW846 1311/6010
TCLP Cadmium	0.030	J 0.050	mg/L	1	09/21/22	TH	SW846 1311/6010
TCLP Chromium	ND	0.10	mg/L	1	09/21/22	TH	SW846 1311/6010
TCLP Copper	0.04	J 0.10	mg/L	1	09/21/22	TH	SW846 1311/6010
TCLP Mercury	ND	0.0002	mg/L	1	09/19/22	IE	SW846 1311/7470
TCLP Molybdenum	ND	0.50	mg/L	1	09/21/22	TH	SW6010D
TCLP Nickel	0.02	J 0.10	mg/L	1	09/21/22	TH	SW846 1311/6010
TCLP Lead	19.7	0.10	mg/L	1	09/21/22	TH	SW846 1311/6010
TCLP Selenium	ND	0.10	mg/L	1	09/21/22	TH	SW846 1311/6010D
TCLP Zinc	3.39	0.10	mg/L	1	09/21/22	TH	SW846 1311/6010D
TCLP Metals Digestion	Completed				09/18/22	AB/AB	SW3010A
Total Solids @ 104C	84.9	0.1	%	1	09/14/22	JW/DK	SM2540B-15
ASTM C.O.D.	ND	10	mg/L	1	09/21/22	AE	SM5220D
ASTM Ammonia Nitrogen	ND	0.05	mg/L	1	09/20/22	KDB	SM417/E350.2
ASTM Oil/Grease	ND	1.4	mg/L	1	09/23/22	MSF	E1664A MOD
ASTM Total Solids	95	10	mg/L	1	09/20/22	DK/AE	SM209A/E160.3
Volatile Solids @ 500C	3.3	0.1	%	1	09/14/22	JW/DK	SM2540E MOD-15 1
ASTM Extraction	Completed				09/16/22	AB	D 3987 85
TCLP Digestion Mercury	Completed				09/19/22	AB/AB	SW7470A
TCLP Extraction for Metals	Completed				09/16/22	AB	SW1311
TCLP Final PH	6.39		pH Units	1	09/16/22		SW1311/SM4500H+B
Initial pH of TCLP Extraction	9.97		pH units	1	09/16/22		SM423/E150.1

Parameter	Result	RL/ PQL	Units	Dilution	Date/Time	By	Reference
-----------	--------	------------	-------	----------	-----------	----	-----------

1 = This parameter is not certified by the primary accrediting authority (NY NELAC) for this matrix. NY NELAC does not offer certification for all parameters at this time.

RL/PQL=Reporting/Practical Quantitation Level (Equivalent to NELAC LOQ, Limit of Quantitation) ND=Not Detected at RL/PQL
BRL=Below Reporting Level L=Biased Low J=Estimated Below RL

Comments:

Ammonia:

This sample was received with a pH>2 The EPA requires preservation at time of sampling to a pH of <2. A sample bias can not be ruled out.

Oil and Grease:

This sample was received with a pH>=2; pH was adjusted to <2 (EPA requires preservation at time of sampling to a pH of <2.) A sample bias can not be ruled out.

All soils, solids and sludges are reported on a dry weight basis unless otherwise noted in the sample comments.

If you are the client above and have any questions concerning this testing, please do not hesitate to contact Phoenix Client Services at ext.200. The contents of this report cannot be discussed with anyone other than the client listed above without their written consent.

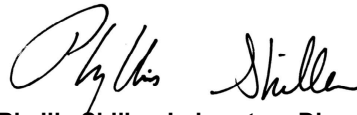

Phyllis Shiller, Laboratory Director

September 29, 2022

Reviewed and Released by: Rashmi Makol, Project Manager



Environmental Laboratories, Inc.
 587 East Middle Turnpike, P.O.Box 370, Manchester, CT 06045
 Tel. (860) 645-1102 Fax (860) 645-0823



Analysis Report

September 29, 2022

FOR: Attn: Li Tsang
 NY Environmental
 88-90 Harbor Rd
 Port Washington, NY 11050

Sample Information

Matrix: SOIL
 Location Code: NY-ENV
 Rush Request: Standard
 P.O.#: 2549.0011Y000

Custody Information

Collected by:
 Received by: CP
 Analyzed by: see "By" below

Date Time
 09/13/22 11:38
 09/14/22 17:11

Laboratory Data

SDG ID: GCM31852
 Phoenix ID: CM31858

Project ID: BRONX JAIL
 Client ID: B4 (10-12)

Parameter	Result	RL/ PQL	Units	Dilution	Date/Time	By	Reference
TCLP Silver	ND	0.10	mg/L	1	09/21/22	TH	SW846 1311/6010
TCLP Arsenic	0.05	J 0.10	mg/L	1	09/21/22	TH	SW846 1311/6010
TCLP Barium	0.78	0.10	mg/L	1	09/21/22	TH	SW846 1311/6010
TCLP Cadmium	0.080	0.050	mg/L	1	09/21/22	TH	SW846 1311/6010
TCLP Chromium	0.01	J 0.10	mg/L	1	09/21/22	TH	SW846 1311/6010
TCLP Copper	0.07	J 0.10	mg/L	1	09/21/22	TH	SW846 1311/6010
TCLP Mercury	ND	0.0002	mg/L	1	09/19/22	IE	SW846 1311/7470
TCLP Molybdenum	ND	0.50	mg/L	1	09/21/22	TH	SW6010D
TCLP Nickel	0.09	J 0.10	mg/L	1	09/21/22	TH	SW846 1311/6010
TCLP Lead	61.9	1.0	mg/L	10	09/23/22	MGH	SW846 1311/6010
TCLP Selenium	ND	0.10	mg/L	1	09/21/22	TH	SW846 1311/6010D
TCLP Zinc	23.7	1.0	mg/L	10	09/23/22	MGH	SW846 1311/6010D
TCLP Metals Digestion	Completed				09/18/22	AB/AB	SW3010A
Total Solids @ 104C	84.3	0.1	%	1	09/14/22	JW/DK	SM2540B-15
ASTM C.O.D.	12	10	mg/L	1	09/21/22	AE	SM5220D
ASTM Ammonia Nitrogen	ND	0.05	mg/L	1	09/20/22	KDB	SM417/E350.2
ASTM Oil/Grease	ND	1.4	mg/L	1	09/23/22	MSF	E1664A MOD
ASTM Total Solids	120	10	mg/L	1	09/20/22	DK/AE	SM209A/E160.3
Volatile Solids @ 500C	4.2	0.1	%	1	09/14/22	JW/DK	SM2540E MOD-15 1
ASTM Extraction	Completed				09/16/22	AB	D 3987 85
TCLP Digestion Mercury	Completed				09/19/22	AB/AB	SW7470A
TCLP Extraction for Metals	Completed				09/16/22	AB	SW1311
TCLP Final PH	4.97		pH Units	1	09/16/22		SW1311/SM4500H+B
Initial pH of TCLP Extraction	9.87		pH units	1	09/16/22		SM423/E150.1

Parameter	Result	RL/ PQL	Units	Dilution	Date/Time	By	Reference
-----------	--------	------------	-------	----------	-----------	----	-----------

1 = This parameter is not certified by the primary accrediting authority (NY NELAC) for this matrix. NY NELAC does not offer certification for all parameters at this time.

RL/PQL=Reporting/Practical Quantitation Level (Equivalent to NELAC LOQ, Limit of Quantitation) ND=Not Detected at RL/PQL
BRL=Below Reporting Level L=Biased Low J=Estimated Below RL

Comments:

Ammonia:

This sample was received with a pH>2 The EPA requires preservation at time of sampling to a pH of <2. A sample bias can not be ruled out.

Oil and Grease:

This sample was received with a pH>=2; pH was adjusted to <2 (EPA requires preservation at time of sampling to a pH of <2.) A sample bias can not be ruled out.

All soils, solids and sludges are reported on a dry weight basis unless otherwise noted in the sample comments.

If you are the client above and have any questions concerning this testing, please do not hesitate to contact Phoenix Client Services at ext.200. The contents of this report cannot be discussed with anyone other than the client listed above without their written consent.

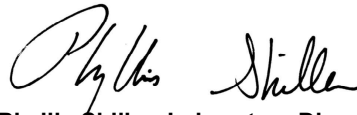

Phyllis Shiller, Laboratory Director

September 29, 2022

Reviewed and Released by: Rashmi Makol, Project Manager



Environmental Laboratories, Inc.
 587 East Middle Turnpike, P.O.Box 370, Manchester, CT 06045
 Tel. (860) 645-1102 Fax (860) 645-0823



Analysis Report

September 29, 2022

FOR: Attn: Li Tsang
 NY Environmental
 88-90 Harbor Rd
 Port Washington, NY 11050

Sample Information

Matrix: SOIL
 Location Code: NY-ENV
 Rush Request: Standard
 P.O.#:

Custody Information

Collected by:
 Received by: CP
 Analyzed by: see "By" below

Date Time
 09/09/22 10:10
 09/12/22 17:31

Laboratory Data

SDG ID: GCM28935
 Phoenix ID: CM28936

Project ID: ROUX BRONX JAIL
 Client ID: F2 (0-10)

Parameter	Result	RL/ PQL	Units	Dilution	Date/Time	By	Reference
TCLP Silver	ND	0.10	mg/L	1	09/14/22	CPP	SW846 1311/6010
TCLP Arsenic	ND	0.10	mg/L	1	09/14/22	CPP	SW846 1311/6010
TCLP Barium	1.01	0.10	mg/L	1	09/14/22	CPP	SW846 1311/6010
TCLP Cadmium	0.021	J 0.050	mg/L	1	09/14/22	CPP	SW846 1311/6010
TCLP Chromium	0.02	J 0.10	mg/L	1	09/14/22	CPP	SW846 1311/6010
TCLP Copper	0.08	J 0.10	mg/L	1	09/14/22	CPP	SW846 1311/6010 B*
TCLP Mercury	ND	0.0002	mg/L	1	09/15/22	IE	SW846 1311/7470
TCLP Molybdenum	ND	0.50	mg/L	1	09/14/22	CPP	SW6010D
TCLP Nickel	0.07	J 0.10	mg/L	1	09/14/22	CPP	SW846 1311/6010
TCLP Lead	8.42	0.10	mg/L	1	09/14/22	CPP	SW846 1311/6010
TCLP Selenium	ND	0.10	mg/L	1	09/14/22	CPP	SW846 1311/6010D
TCLP Zinc	2.01	0.10	mg/L	1	09/14/22	CPP	SW846 1311/6010D B
TCLP Metals Digestion	Completed				09/14/22	AB/KL	SW3010A
Total Solids @ 104C	75.1	0.1	%	1	09/13/22	W/AE/AM	SM2540B-15
ASTM C.O.D.	ND	10	mg/L	1	09/21/22	AE	SM5220D
ASTM Ammonia Nitrogen	ND	0.10	mg/L	2	09/16/22	KDB	SM417/E350.2
ASTM Oil/Grease	ND	1.4	mg/L	1	09/22/22	MSF	E1664A MOD
ASTM Total Solids	63	10	mg/L	1	09/16/22	DK	SM209A/E160.3
Volatile Solids @ 500C	3.0	0.1	%	1	09/13/22	W/AE/AM	SM2540E MOD-15 1
ASTM Extraction	Completed				09/13/22	AB	D 3987 85
TCLP Digestion Mercury	Completed				09/14/22	AB/AB	SW7470A
TCLP Extraction for Metals	Completed				09/13/22	AB	SW1311
TCLP Final PH	4.7		pH Units	1	09/13/22		SW1311/SM4500H+B
Initial pH of TCLP Extraction	9.53		pH units	1	09/13/22		SM423/E150.1

Parameter	Result	RL/ PQL	Units	Dilution	Date/Time	By	Reference
-----------	--------	------------	-------	----------	-----------	----	-----------

1 = This parameter is not certified by the primary accrediting authority (NY NELAC) for this matrix. NY NELAC does not offer certification for all parameters at this time.

B* = Present in blank, a bias is possible.

B = Present in blank, no bias suspected.

RL/PQL=Reporting/Practical Quantitation Level (Equivalent to NELAC LOQ, Limit of Quantitation) ND=Not Detected at RL/PQL
BRL=Below Reporting Level L=Biased Low J=Estimated Below RL

Comments:

Ammonia:

This sample was received with a pH>2 The EPA requires preservation at time of sampling to a pH of <2. A sample bias can not be ruled out.

Oil and Grease:

This sample was received with a pH>=2; pH was adjusted to <2 (EPA requires preservation at time of sampling to a pH of <2.) A sample bias can not be ruled out.

All soils, solids and sludges are reported on a dry weight basis unless otherwise noted in the sample comments.

If you are the client above and have any questions concerning this testing, please do not hesitate to contact Phoenix Client Services at ext.200. The contents of this report cannot be discussed with anyone other than the client listed above without their written consent.

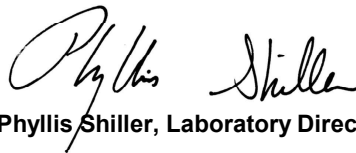

Phyllis Shiller, Laboratory Director

September 29, 2022

Reviewed and Released by: Sarah Bell, Project Manager



Environmental Laboratories, Inc.
 587 East Middle Turnpike, P.O.Box 370, Manchester, CT 06045
 Tel. (860) 645-1102 Fax (860) 645-0823



Analysis Report

September 14, 2022

FOR: Attn: Li Tsang
 NY Environmental
 88-90 Harbor Rd
 Port Washington, NY 11050

Sample Information

Matrix: SOIL
 Location Code: NY-ENV
 Rush Request: Standard
 P.O.#: 2549.0011Y000

Custody Information

Collected by:
 Received by: CP
 Analyzed by: see "By" below

Date

09/01/22
 09/01/22

Time

11:05
 18:43

Laboratory Data

SDG ID: GCM21623
 Phoenix ID: CM21629

Project ID: ROUX BRONX JAIL
 Client ID: F4 (0-12)

Parameter	Result	RL/ PQL	Units	Dilution	Date/Time	By	Reference
TCLP Silver	< 0.10	0.10	mg/L	1	09/07/22	TH	SW846 1311/6010
TCLP Arsenic	< 0.10	0.10	mg/L	1	09/07/22	TH	SW846 1311/6010
TCLP Barium	0.67	0.10	mg/L	1	09/07/22	TH	SW846 1311/6010
TCLP Cadmium	< 0.050	0.050	mg/L	1	09/07/22	TH	SW846 1311/6010
TCLP Chromium	< 0.10	0.10	mg/L	1	09/07/22	TH	SW846 1311/6010
TCLP Copper	< 0.10	0.10	mg/L	1	09/07/22	TH	SW846 1311/6010
TCLP Mercury	< 0.0002	0.0002	mg/L	1	09/07/22	IE	SW846 1311/7470
TCLP Molybdenum	< 0.50	0.50	mg/L	1	09/07/22	TH	SW6010D
TCLP Nickel	< 0.10	0.10	mg/L	1	09/07/22	TH	SW846 1311/6010
TCLP Lead	5.35	0.10	mg/L	1	09/07/22	TH	SW846 1311/6010
TCLP Selenium	< 0.10	0.10	mg/L	1	09/07/22	TH	SW846 1311/6010D
TCLP Zinc	1.28	0.10	mg/L	1	09/07/22	TH	SW846 1311/6010D
TCLP Metals Digestion	Completed				09/07/22	AB/AB	SW3010A
TCLP Digestion Mercury	Completed				09/07/22	AB/AB	SW7470A
TCLP Extraction for Metals	Completed				09/06/22	AB	SW1311
TCLP Final PH	5.27		pH Units	1	09/06/22		SW1311/SM4500H+B
Initial pH of TCLP Extraction	9.81		pH units	1	09/06/22		SM423/E150.1

Project ID: ROUX BRONX JAIL
Client ID: F4 (0-12)

Phoenix I.D.: CM21629

Parameter	Result	RL/ PQL	Units	Dilution	Date/Time	By	Reference
-----------	--------	------------	-------	----------	-----------	----	-----------

RL/PQL=Reporting/Practical Quantitation Level (Equivalent to NELAC LOQ, Limit of Quantitation) ND=Not Detected at RL/PQL
BRL=Below Reporting Level L=Biased Low

Comments:

If you are the client above and have any questions concerning this testing, please do not hesitate to contact Phoenix Client Services at ext.200.
The contents of this report cannot be discussed with anyone other than the client listed above without their written consent.



Phyllis Shiller, Laboratory Director

September 14, 2022

Reviewed and Released by: Rashmi Makol, Project Manager