

Brooklyn Bridge-Montgomery Coastal Resilience Construction Update

Virtual Presentation
September 10, 2024



Highlights

- Project Overview
- Project Status
- Timeline & Next Steps
- Construction Photos
- Ongoing Impacts
- Resources

BMCR | Project Overview

ALL WORK IS SUBJECT TO CHANGE

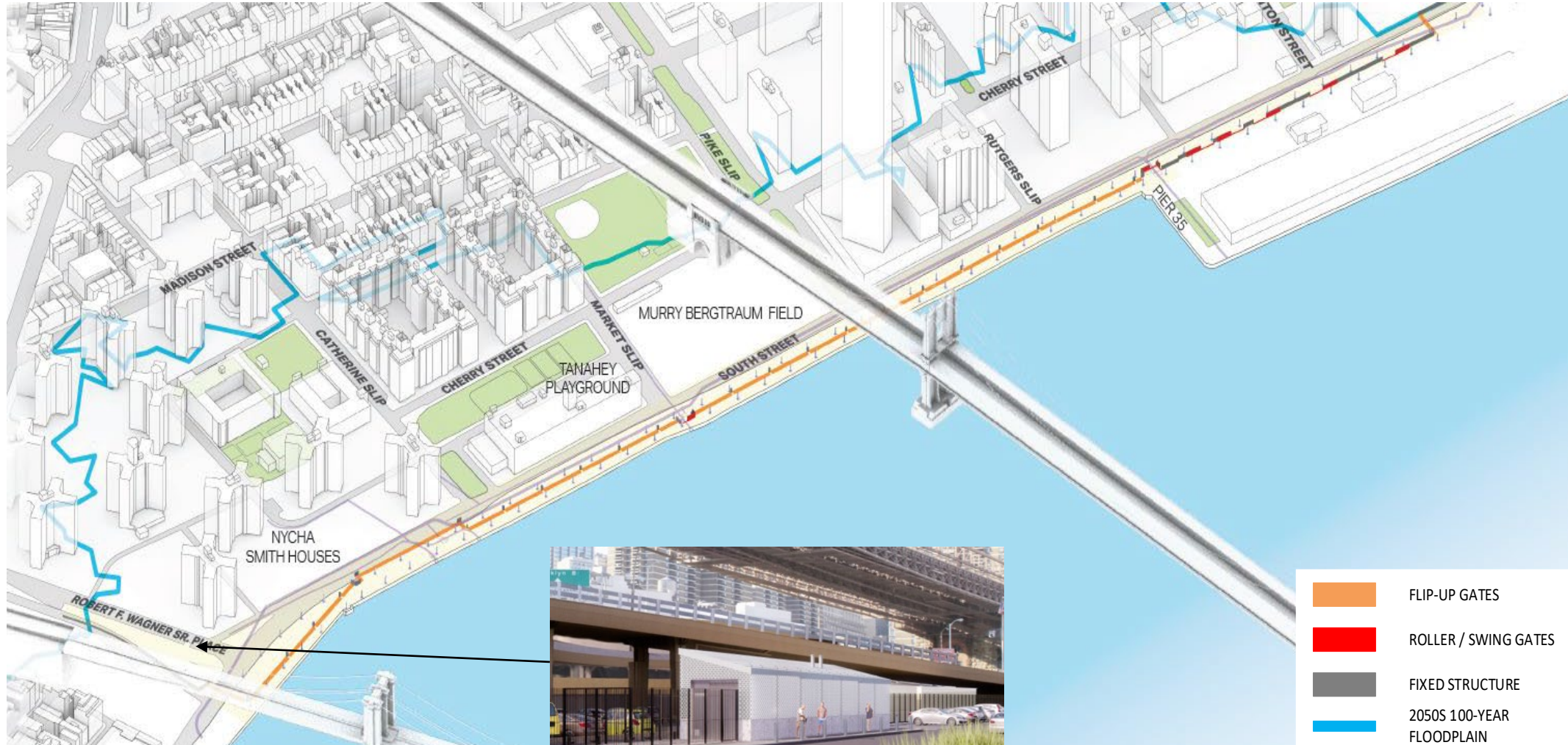

BMCR | Project Status

ALL WORK IS SUBJECT TO CHANGE

1. Floodwall construction
2. Set up for parallel conveyance
3. Utility work on South St., between Jefferson St. and Clinton St.
Utility work on Clinton St., between South St. and Cherry St.
4. Flip up gate installation, floodwall foundation construction
Micro pile installation
5. Pedestrian entrance to Pier 35 closed from South Street
Floodwall construction

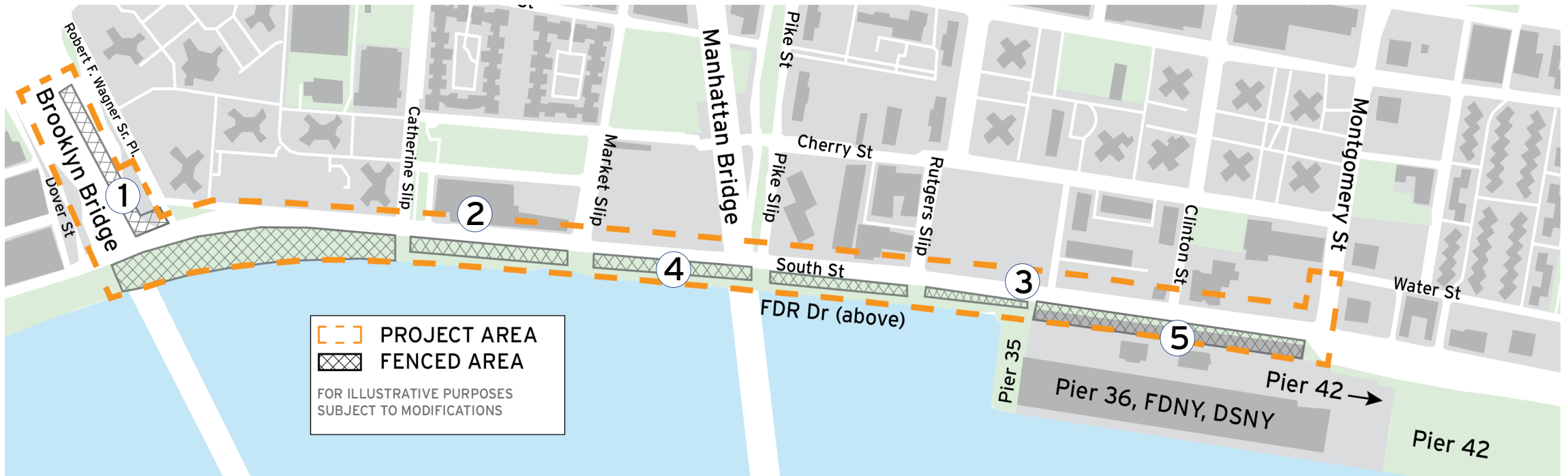

Weekly Bulletins & Advisories are issued with construction activities.
Saturday work and off-hour shifts are anticipated for some work operations.

BMCR | Project Timeline & Next Steps

ALL WORK IS SUBJECT TO CHANGE

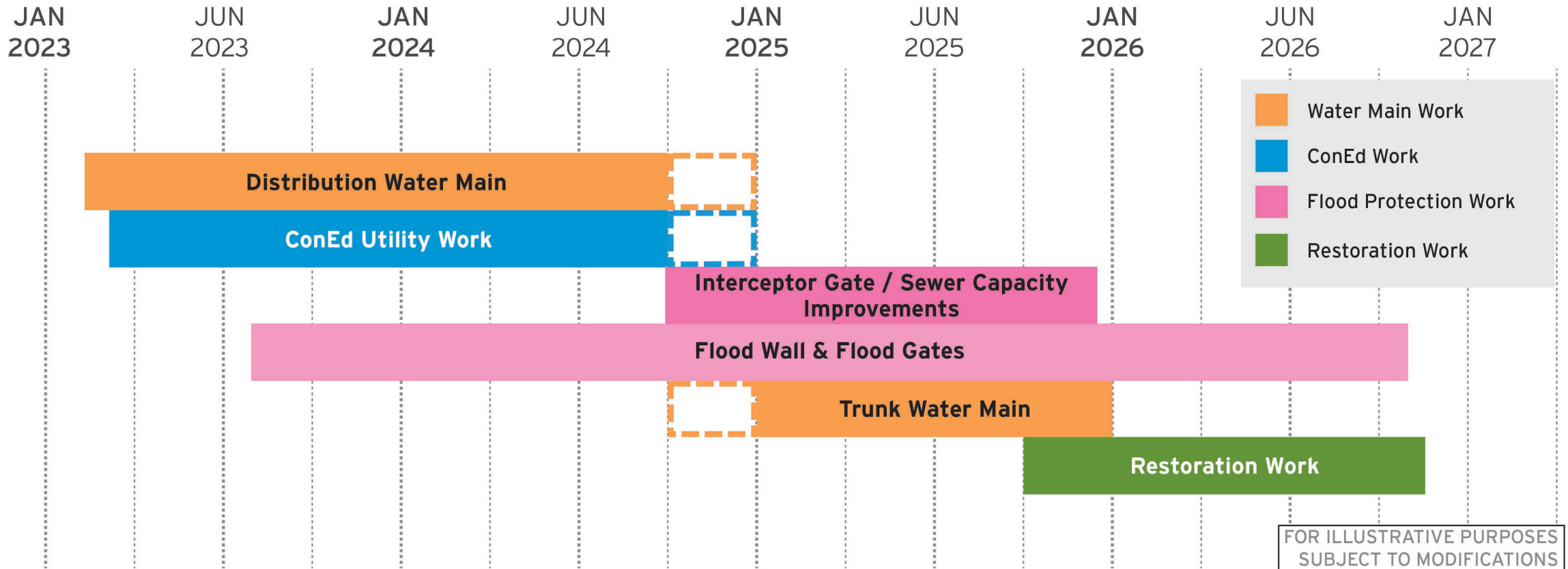

BMCR | Construction Photos

ALL WORK IS SUBJECT TO CHANGE

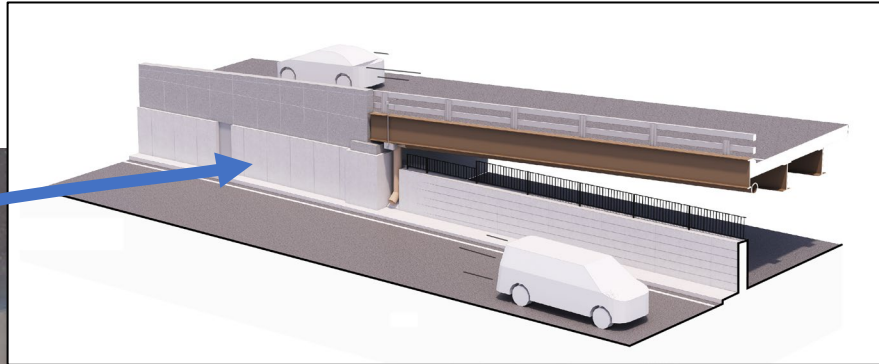

Floodwall tie-in to FDR Drive off-ramp – September 2024



Utility work in South Street – September 2024

BMCR | Construction Photos

ALL WORK IS SUBJECT TO CHANGE



Flip up gate in down position / dry condition, water side – Rendering



Deployed flip up gate during installation – June 2024

BMCR | Construction Photos

ALL WORK IS SUBJECT TO CHANGE



Deployed flip up gate, dry side – Rendering



Deployed flip up gate, dry side during installation – June 2024

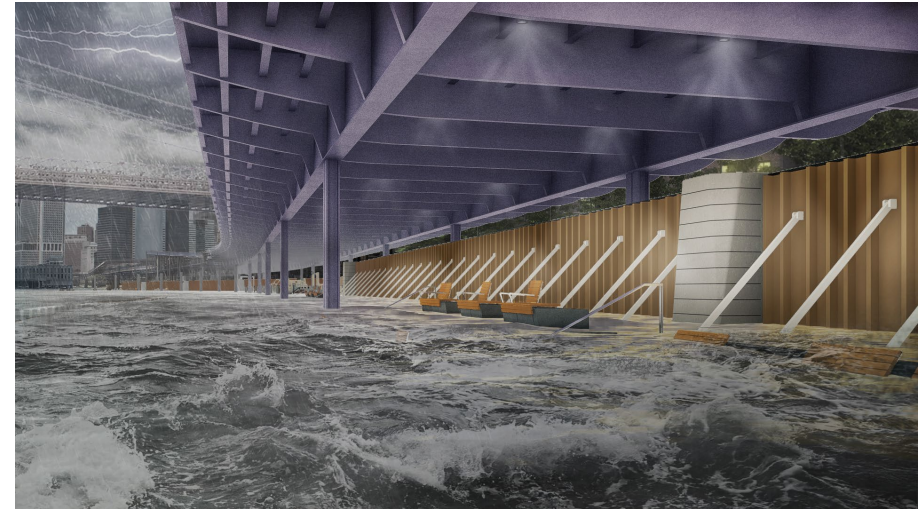

Deployed flip up gate, water side – Rendering



Flip up gate in partially deployed position – September 2024

BMCR | Ongoing Impacts

- Lane closures and detours will be required
- Cyclist and pedestrian detours are in effect
- Signage will continue to be posted in advance within affected areas
- Traffic enforcement agents and flaggers will be present when necessary to assist vehicles and pedestrians
- Emergency vehicle access and public transportation will be maintained at all times
- Water main upgrades will require some service interruptions, with advance community notice

BMCR | Resources

- Visit Us: <https://www.nyc.gov/bmcr>
- Community Construction Liaison:
 - Marsha Guido
347-538-4266
Email: bmcr.ccl@gmail.com
- Tabling in the Community
- CB 3 Parks Meetings
 - Next meeting Thursday, September 12
- On-site signage
- Inquiry tool and email updates:
<https://www.nyc.gov/bmcr/contact>



Tabling event - 2023



Advisories posted on-site

NYC Lower Manhattan Coastal Resiliency

Brooklyn Bridge-Montgomery Coastal Resilience

Brooklyn Bridge-Montgomery Coastal Resilience

The Department of Design and Construction (DDC) will install a combination of flood walls and deployable flip-up barriers to protect the neighborhood from a 100-year storm surge in the 2050s, while also maintaining access and visibility to the waterfront. New York City Economic Development Corporation (NYCEDC) led the design for the project, which will extend along the waterfront from the Brooklyn Bridge to Montgomery Street. EDC completed design in fall of 2021 and DDC is now managing the construction of BMCR.

This project will reduce flooding risk – from both sea level rise and storm surge – for thousands of residents, while continuing to preserve views and access to the waterfront. These deployable barriers will be permanent infrastructure, hidden until they are flipped up in the event of a storm. The location of the flood walls and posts has been designed to minimize conflict with subsurface infrastructure and to maximize integration of public space amenities such as open-air seating, fitness equipment, and athletic courts.

Explore the headings below for more information about BMCR and the status of construction:

Learn more about the NYCEDC design phase: [NYCEDC LMCRC](#)

The same waterfront that the community enjoys when weather is good...

...transforms into critical flood protection during major flooding events.

Learn More about BMCR

- About
- Construction Notices
- Presentations
- Newsletters
- Gallery
- Community Engagement
- Contact
- FAQs

NYC Lower Manhattan Coastal Resiliency 311 Search all NYC.gov websites

NYC Lower Manhattan Coastal Resiliency [Русский](#) Select Language | Text-Size

Background Progress Resources Get Involved Search

Brooklyn Bridge-Montgomery Coastal Resilience

[Brooklyn Bridge-Montgomery Coastal Resilience](#)

The Battery Coastal Resilience

Interim Flood Protection Measure (IFPM)

Battery Park City Resilience Projects

The Financial District and Seaport Climate Resilience Master Plan

Seaport Coastal Resilience

[f](#) [t](#) [e](#) [s](#) [Share](#)

[Print](#)



Brooklyn Bridge - Montgomery Coastal Resilience

In the Two Bridges neighborhood, the Department of Design and Construction (DDC) will install a combination of flood walls and deployable flip-up barriers to protect the neighborhood from a 100-year storm surge in the 2050s, while also maintaining access and visibility to the waterfront. New York City Economic Development Corporation (NYCEDC) led the design for the project, which will extend along the waterfront from the Brooklyn Bridge to Montgomery Street. EDC completed design in fall of 2021 and DDC is now managing the construction of BMCR.

This project will reduce flooding risk – from both sea level rise and storm surge – for thousands of residents, while continuing to preserve views and access to the waterfront. These deployable barriers will be permanent infrastructure, hidden until they are flipped up in the event of a storm. The location of the flood walls and posts has been designed to minimize conflict with subsurface infrastructure and to maximize integration of public space amenities such as open-air seating, fitness equipment, and athletic courts.

Explore the headings below for more information about BMCR and the status of construction:

Learn more about the NYCEDC design phase: [NYCEDC LMCR](#)

The same waterfront that the community enjoys when weather is good...



...transforms into critical flood protection during major flooding events.

Learn More about BMCR

- [About](#)
- [Construction Notices](#)
- [Presentations](#)
- [Newsletters](#)
- [Gallery](#)
- [Community Engagement](#)
- [Contact](#)
- [FAQs](#)

Are you looking for more information?

Visit Us at:
<https://www.nyc.gov/bmcr>

