

THE CITY OF NEW YORK MANHATTAN COMMUNITY BOARD 3

59 East 4th Street - New York, NY 10003
Phone: (212) 533-5300 - Fax: (212) 533-3659
www.cb3manhattan.org - info@cb3manhattan.org

Gigi Li, Board Chair

Susan Stetzer, District Manager

Community Board 3 Liquor License Application Questionnaire

Please bring the following items to the meeting:

NOTE: ALL ITEMS MUST BE SUBMITTED FOR APPLICATION TO BE CONSIDERED.

- Photographs of the inside and outside of the premise.
- Schematics, floor plans or architectural drawings of the inside of the premise.
- A proposed food and or drink menu.
- Petition in support of proposed business or change in business with signatures from residential tenants at location and in buildings adjacent to, across the street from and behind your proposed location. Petition must give proposed hours and method of operation. For example: restaurant, sports bar, combination restaurant/bar. (petition provided)
- Letter of notice of proposed business to block or tenant association if one exists. E-mail the CB3 office at info@cb3manhattan.org for help to find block associations.
- Photographs of proof of conspicuous posting of meeting with newspaper showing date.
- If applicant has been or is licensed anywhere in City, letter from applicable community board indicating history of complaints and other comments.

Check which you are applying for:

- | | |
|---|--|
| <input checked="" type="checkbox"/> new liquor license | <input type="checkbox"/> upgrade of an existing liquor license |
| <input type="checkbox"/> alteration of an existing liquor license | <input type="checkbox"/> sale of assets |
| <input type="checkbox"/> corporate change | |

If applying for sale of assets, you must bring letter from current owner confirming that you are buying business or have the seller come with you to the meeting.

Type of license: Beer & Wine Is location currently licensed? Yes No

If alteration, describe nature of alteration: N/A

Previous or current use of the location: VACANT

Corporation and trade name of current license: N/A

APPLICANT:

Name of applicant and all principals: IVROSE B. LLC
principals: IVROSE Bamba & KANYALY BANDA

Trade name (DBA): TBD

Premise address and cross streets: 195 AVE A, NY, NY 10009
between 12th St & AVE A.

PREMISE:

Type of building and number of floors: Mixed: Commercial/Residential

Will any outside area or sidewalk cafe be used for the sale or consumption of alcoholic beverages?
(includes roof & yard) Yes No If Yes, describe and show on diagram: _____

Does premise have a valid Certificate of Occupancy and all appropriate permits, including certificate
of occupancy for back or side yard intended for commercial use? Yes No
Indoor Certificate of Occupancy 48 Outdoor Certificate of Occupancy _____

Do you plan to apply for Public Assembly permit? Yes No

Zoning designation (check zoning using map: <http://gis.nyc.gov/doitt/nycitymap/> - please give
specific zoning designation, such as R8 or C2):

R7

Is this premise wheel chair accessible? Yes No

PROPOSED METHOD OF OPERATION:

What type of establishment will this be (i.e.: restaurant, bar, performance space, club, hotel)?

Restaurant / Wine Bar

Will any other business besides food or alcohol service be conducted at premise? Yes No

If yes, please describe what type: _____

What are the proposed days/hours of operation? (Specify days and hours each day and hours of
outdoor space) Monday - Friday: 5 PM - 2 AM

Saturday: 11 a.m. - 2 a.m., Sunday: 11 a.m. - 12 a.m.

Number of tables? 13 Number of seats at tables? 26

How many stand-up bars/ bar seats are located on the premise? 1 BAR, 12 SEATS

(A **stand up bar** is any bar or counter (whether with seating or not) over which a patron can order,
pay for and receive an alcoholic beverage)

Describe all bars (length, shape and location): L-SHAPE, FRONT RIGHT, 20'-6" x 3'-0"

Any food counters? Yes No If Yes, describe: Prep Area

Does premise have a full kitchen? Yes No?

Does it have a food preparation area? Yes No (If any, show on diagram)

Is food available for sale? Yes No If yes, describe type of food and submit a menu

SEE ATTACHED MENU.

What are the hours kitchen will be open? MON-FRI: 5PM-11PM

SAT & SUN: 11 AM - 12 AM

Will a manager or principal always be on site? Yes No If yes, which? PRINCIPAL

How many employees will there be? 8-10

Do you have or plan to install French doors accordion doors or windows?

Will you agree to close any doors and windows at 10:00 P.M. every night? Yes No

Will there be TVs/monitors? Yes No (If Yes, how many?) _____

Will premise have music? Yes No

If Yes, what type of music? Live musician DJ Juke box Tapes/CDs/iPod

If other type, please describe _____

What will be the music volume? Background (quiet) Entertainment level

Please describe your sound system: _____

Will you host promoted events, scheduled performances or any event at which a cover fee is charged? If Yes, what type of events or performances are proposed? NO

How do you plan to manage vehicular traffic and crowds on the sidewalk caused by your establishment? Please attach plans.

Will there be security personnel? Yes No (If Yes, how many and when) 1 possibly on weekends to monitor sidewalk

How do you plan to manage noise inside and outside your business so neighbors will not be affected? Please attach plans.

Do you have or plan to install sound-proofing?

APPLICANT HISTORY:

Has this corporation or any principal been licensed previously? Yes No

If yes, please indicate name of establishment: _____

Address: _____ Community Board # _____

Dates of operation: _____

If you answered "Yes" to the above question, please provide a letter from the community board indicating history of complaints or other comments.

Has any principal had work experience similar to the proposed business? Yes No If Yes, please attach explanation of experience or resume.

Does any principal have other businesses in this area? Yes No If Yes, please give trade name and describe type of business _____

Has any principal had SLA reports or action within the past 3 years? Yes No If Yes, attach list of violations and dates of violations and outcomes, if any.

Attach a separate diagram that indicates the location (**name and address**) and total number of establishments selling/serving beer, wine (B/W) or liquor (OP) for 2 blocks in each direction. Please indicate whether establishments have On-Premise (OP) licenses. Please label streets and avenues and identify your location. Use letters to indicate **Bar, Restaurant, etc.** The diagram must be submitted with the questionnaire to the Community Board before the meeting.

LOCATION:

How many licensed establishments are within 1 block? 3

How many licensed establishments are within 500 feet? 19

Is premise within a 500 foot radius of 3 or more establishments with OP licenses? Yes No

How many On-Premise (OP) liquor licenses are within 500 feet? _____

Is premise within 200 feet of any school or place of worship? Yes No

If there is a school or place of worship within 200 feet of your premise on the same block, submit a block plot diagram or area map showing its location in proximity to your premise and indicate the distance and name and address of the school or house of worship.

COMMUNITY OUTREACH:

If there are block associations or tenant associations in the immediate vicinity of your location, you must contact them. **Please attach proof (copies of letters and poster) that you have advised these groups of your application with sufficient time for them to respond to your notice.** You may contact the Community Board at info@cb3manhattan.org for any contact information.

Please use provided petitions, which clearly state the name, address, license for which you are applying, and the hours and method of operation of your establishment at the top of each page. (Attach additional sheets of paper as necessary).

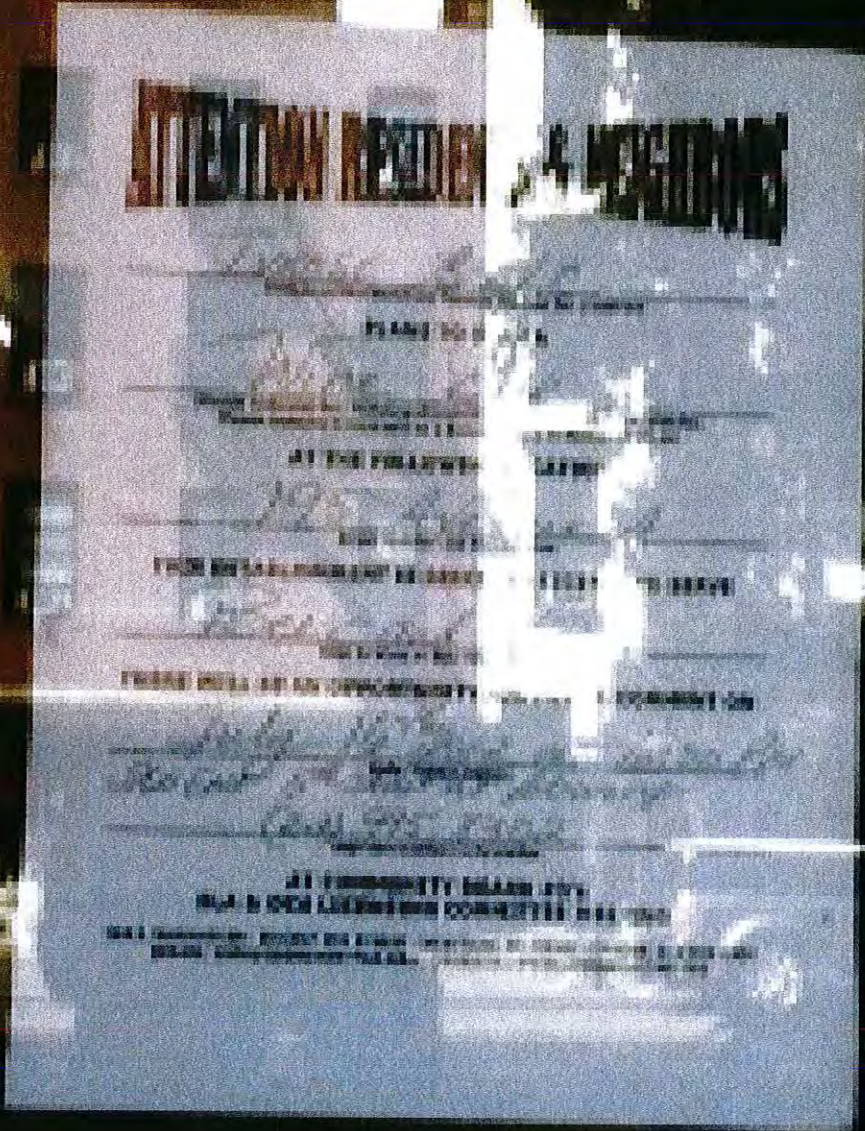

[Redacted]

PLANNING BOARD

AT THE REGULAR MEETING

HELD ON TUESDAY, APRIL 12, 1994

7:00 P.M. AT THE PLANNING BOARD ROOM

AGENDA

1. APPROVAL OF MINUTES

2. PUBLIC COMMENT

3. REPORT OF THE PLANNING BOARD

4. REPORT OF THE COMMUNITY RELATIONS COMMITTEE

5. REPORT OF THE PLANNING BOARD

6. REPORT OF THE PLANNING BOARD

7. REPORT OF THE PLANNING BOARD

8. REPORT OF THE PLANNING BOARD

9. REPORT OF THE PLANNING BOARD

10. REPORT OF THE PLANNING BOARD

11. REPORT OF THE PLANNING BOARD

12. REPORT OF THE PLANNING BOARD

13. REPORT OF THE PLANNING BOARD

14. REPORT OF THE PLANNING BOARD

15. REPORT OF THE PLANNING BOARD

16. REPORT OF THE PLANNING BOARD

17. REPORT OF THE PLANNING BOARD

18. REPORT OF THE PLANNING BOARD

19. REPORT OF THE PLANNING BOARD

20. REPORT OF THE PLANNING BOARD

21. REPORT OF THE PLANNING BOARD

22. REPORT OF THE PLANNING BOARD

23. REPORT OF THE PLANNING BOARD

24. REPORT OF THE PLANNING BOARD

25. REPORT OF THE PLANNING BOARD

26. REPORT OF THE PLANNING BOARD

27. REPORT OF THE PLANNING BOARD

28. REPORT OF THE PLANNING BOARD

29. REPORT OF THE PLANNING BOARD

30. REPORT OF THE PLANNING BOARD

31. REPORT OF THE PLANNING BOARD

32. REPORT OF THE PLANNING BOARD

33. REPORT OF THE PLANNING BOARD

34. REPORT OF THE PLANNING BOARD

35. REPORT OF THE PLANNING BOARD

36. REPORT OF THE PLANNING BOARD

37. REPORT OF THE PLANNING BOARD



STORE FOR LEASE

12,420 sq. ft.
Open Design, 10' High Ceilings & 15' Clearances

Call: 800-368-3333





















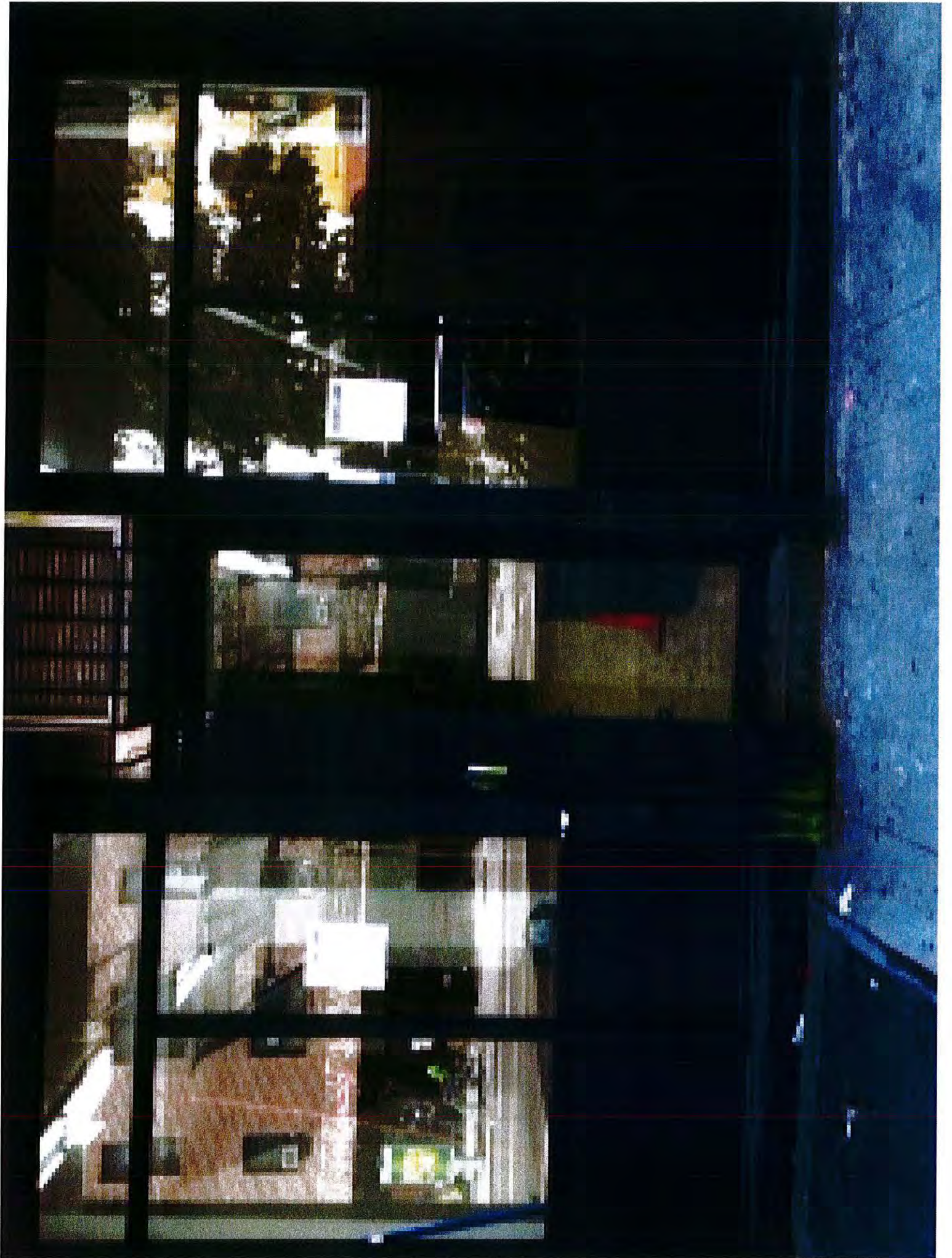

PARTIAL 1ST FLOOR PLAN
SCALE: 1/4" = 1'-0"

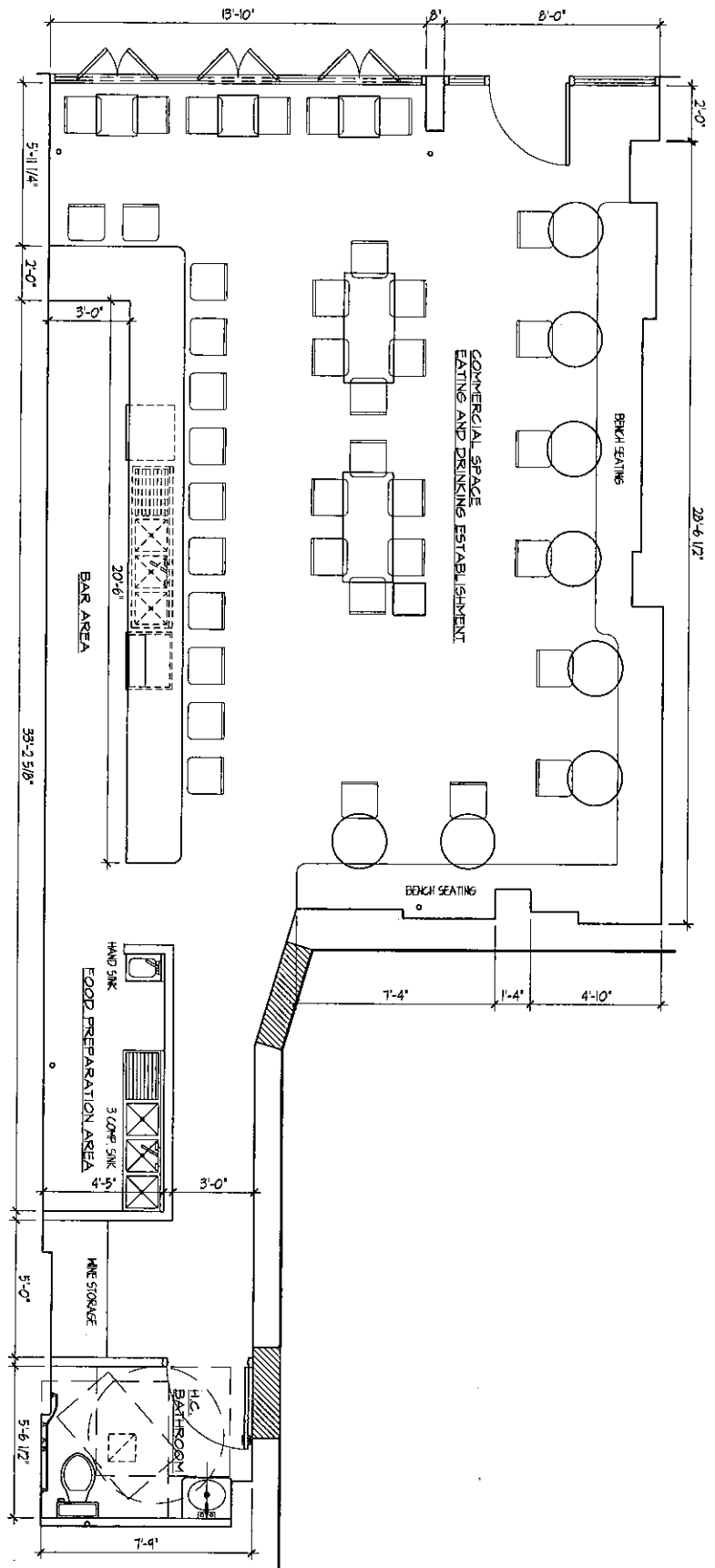

PROJECT NO. A-10000 TITLE	195 AVENUE A MANHATTAN, NY	DRAWN BY: <i>06/21/2002</i> CHECKED BY: <i>MEH</i> LANDLORD: _____ PERMIT: _____ ISSUE DATE: _____	REVISIONS: ▲ _____ ▲ _____ ▲ _____ ▲ _____	 <p> MICHAEL S.J. MAZZELLA RA ARCHITECTURAL DESIGN SERVICES 84 PETER JACOB DRIVE BANGOR, PA 17013 (917) 576-7422 / FAX (717) 228-6461 E-MAIL: mjmtr@opix.net </p>
---------------------------------	--------------------------------------	--	--	---

Cheese and Charcuterie

Les Fromages

Assorted selection of World cheeses (American, French, Spanish etc.)

La Charcuterie

Dry sausage, garlic sausage, Bayonne ham, duck breast, country pate

Le Combo Charcuterie et Fromage

Hors d'Oeuvres

Pate de Campagne

Country pate on toast with cornichons

Escargot de Bourgogne

French Burgundy snails served with garlic and parsley butter

Tartare de Saumon

Hand chopped salmon with lemon
ginger dressing

Terrine de Foie Gras

Duck terrine served with figs
and toast

Tartine de Saumon

Smoked salmon on baguette, chives and goat cheese

Salads

La Verte

Mixed greens, mustard vinaigrette

La Perigourdine

Mixed greens, duck breast,
Bayonne ham and foie gras

Earthy Mix

Endive, Frisse and Watercress with Balsamic vinaigrette

Romantic Beat

Goat cheese, Arugula, Rhubarb with lemon vinaigrette

Selections

Chili (Beef & Vegetable)

Croque Monsieur

Toasted bread, ham, béchamel sauce and gruyere

Croque de Saumon

Bread, salmon, béchamel sauce, gruyere

Steak Tartare du Chef

Hand chopped sirloin steak, capers, cornichons, onions, egg and mustard ketchup dressing

La Bayonnette

Baguette, Bayonne ham, goat cheese and Dates

Quiches

Variety (Salmon, Broccoli etc.)

La Rue A

Baguette, duck breast, brie cheese and avocado

Le Trois Fromages

Baguette, brie, goat cheese, gruyere and truffle oil

Soupe du Jour

Soup of the day

Desserts

Crème Brulée

Vanilla and Earl Grey tea custard base

Gateau au Chocolat

Warm chocolate cake, salty caramel

Tarte Tatin Flambee

Sorbet

Variety of Sorbet

Praline Ice Cream

Brunch Menu

Pate de Campagne

Country pate on toast with cornichons

Chili (Beef & Vegetable)

Croque Madame

Bread, béchamel sauce, gruyere with 2 eggs sunny side up

Gaufre aux Fruits aux deux Sirop

Waffle served w/ fresh fruit and organic maple syrup & guava sauce

Individual Frittata

Oeufs Brouillés au Saumon

Scrambled eggs, smoked salmon with dill, roasted potatoes, herbs de provence and salad

Terrine de Foie Gras

Duck terrine served with figs
and toast

Tartine de Saumon

Smoked salmon on baguette, chives and goat cheese

Mixed Salad with goat cheese aux croutons

Aperitifs

Floc de Gascogne, Chateau Laubade

Champagne

Paul de Coste
Baron de Seillac Rose (Grenache)
Thiernot
Duval, Rose
Cremant Marie Ambal
Duval Leroy
Picard Rose
Serveaux Blanc de Noir
Gardet, Blanc de Noir

White Wine

Loire Valley

Quincy, Dom. Pierre Duret
Vouvray Demi-Sec, Chateau Montancour
Pouilly Fume, Pierre Marchand
Saumur, Les Epinats
Sancerre, Dom. Gerard Millet
Provignage, Henry Marionnet

Bordeaux

Bordeaux Blanc, Douthe

Sud-Ouest

Cotes de Gascogne, Domaine d'Uby Sauvignon
Bergerac Sec, Le Bost
Saint-Mont, Les Vignes Retrouvees

Bourgogne/Beaujolais

Chablis, La Meuliere
Pernand Vergelesses, Sylvain Loichet
Chablis, Domaine Fourey
Puligny-Montrachet, Vincent Girardin
Chassagne-Montrachet, Thomas Morey
Meursault, S. Loichet

Languedoc-Rousillon

Costiere de Nimes, Cercius
Pic Poul de Pinet, Dom. Feline Jourdan
Corbieres, Las Val les Gres
Pays D'Oc, Petit-Saint-Jacques
Maris, Chateau Maris

Rose

Beaujolais Rose, Dominique Piron
Sablet Rose, Dom. Les Goubert
Minervois Rose, Chateau Maris Old School
Cotes de Provence, Provence One
Sancerre, "Cotes de Reigny"
L'argentier Rose, Aramon

Red Wines

Loire Valley

Menetou Salon, Les Thureaux

Beaujolais

Morgon, Clos les Charmes

Rhone valley

Cotes du Rhone, La Buissonne
Cotes du Ventoux, Alexandre Gauvin
Vacqueras, Dom. Le Colombier
Vacqueras, Dom. Le Colombier Cuvee G

Languedoc-Rousillon

Cotes de Thongue, Dom. De Montrose
Pic Saint Loup, Les Almades
L'Argentier, Cinsault

VIN Doux

Anjou, Coteaux du Layon Cht La Roulerie
Rasteau, Vin doux naturel
Rivesalte, Dom. Lafage
Macvin, du Jura Chateau d' Arlay

The following ~~applicant~~ license to the following applicant/establishment: IVROSE B LLC 2/5

(Please indicate type of license)

Beer + Wine only

Address of premises 195 Ave A

This business will be a bar restaurant other Upscale Wine Bar

The hours of operation will be M-F 5pm-2am, SAT 11am-2am, Sun. 11am-12am

PLEASE NOTE: signatures should be from residents of building, adjoining buildings, and within 2-block area.
Any other information:

Name	Signature	Address
24 Caise Castle		520 E 14th St, Apt 40
25 Katie McIntosh		520 E 14th St. Apt 42
26 Bryan Chan		516 E. 52nd St Apt 8
27 James Baldo		516 E 12th St Apt #20
28 Lindsey Devers		516 E 12 street apt 18
29 Ling Wice		516 east 12th #14.
30 Anne Kelly		516 E 12th #13
31 James Dale		516 E. 12th St. #8
32 Cristina Nolan		516 E 12th St #8
33 Christina Pedding		516 E 12th #4
34 Austin March		647 E 11th St #23
35 Steven Young		647 E 11th St #23
36 Sebastian Bansa		647 E 11th #23
37 Lily Kupets		647 E 11th St Apt #20
Taylor Black		647 E 11 St Apt 24
ALEJANDRO VILASO		647 E 11 St Apt 28

The following applicant/establishment: Beer + Wine license to the following applicant/establishment:

Truse B the 3/5

(Please indicate type of license)

Beer + Wine only

Address of premises 195 Ave A

This business will be a bar restaurant other Upscale Wine bar

The hours of operation will be

M-F 5pm-2am, SAT 11am-2am, Sun. 11am-12am

PLEASE NOTE: signatures should be from residents of building, adjoining buildings, and within 2-block area.

Any other information:

Name	Signature	Address
38 MADISON STEWART	<i>Madison Stewart</i>	647 E. 11th St Apt. 17
39 Yael Green	<i>Yael Green</i>	647 E. 11th St. Apt 15
40 Danielle Henderson	<i>Danielle Henderson</i>	647 E. 11th St. Apt 14
41 Erin Haggerty	<i>Erin Haggerty</i>	647 E 11th Apt 8
42 Donna Hawkins	<i>Donna Hawkins</i>	647 E 11th Apt 9
Donna Hawkins		647 E 11th Apt 9
43 Christina Guglielmo	<i>Christina Guglielmo</i>	
44 Andrea Nicole Ortiz	<i>Andrea Nicole Ortiz</i>	647 E 11th St. #17
45 Kyle Proctor	<i>Kyle Proctor</i>	647 E 11th St #2
46 Laura Roma	<i>Laura Roma</i>	647 E 11th #25
47 Shannon Hansen	<i>Shannon Hansen</i>	647 e. 11th #22
48 Ryan Rauscher	<i>Ryan Rauscher</i>	647 e. 11th #2

The following _____ license to the following applicant/establishment:

(Please indicate type of license)

Wine and Beer

Address of premises 195 Avenue A

This business will be a bar restaurant (circle one) other Wine Bar

The hours of operation will be Monday - Friday (5pm - 2AM) Saturday (11AM - 2AM) Sunday (11AM - 12AM)

PLEASE NOTE: signatures should be from residents of building, adjoining buildings, and within 2-block area.
Any other information:

Name	Signature	Address
1 Leticia MADRIDEJOS		4 Stuyvesant ave. # 5 - DNY, NY 10009
2 NORMA B. COSEA		521 E 14 ST. # 8G NEW YORK, NY 10009
3 Gary Packer		441 EAST 12 th Street Floor 15 NY 10009
4 Tarik Fallous		188 Ave A New York, NY 10009
5 Ricky Chavez		214 Ave A, NY 10009
6 Mike ATTAL		191 AVE A, NY 10009
7 Valerie N.		191 Ave A, NY 10009
8 Sarah Megel		199 Ave A
9 Ben, S Boubens.		217 Ave A
10 CRANG		444 East 12 th St Ave
11 Ricardo Barrero		174 Ave A
12 Joe Ferraro		304 E. 12 th St.
13 John Mateovich		191 Ave A, # 3

The following undersigned _____ license to the following applicant/establishment:





(Please indicate type of license)
Wine and Beer

Address of premises 195 Avenue A

This business will be a bar restaurant (circle one) other Wine Bar

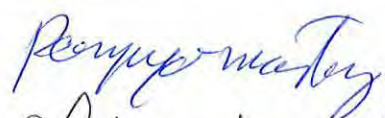
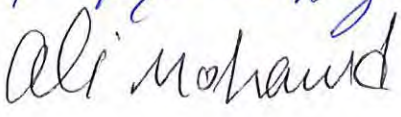
The hours of operation will be
Monday - Friday (5PM - 2AM) Saturday (11AM - 2AM) Sunday (11AM - 12 MN)

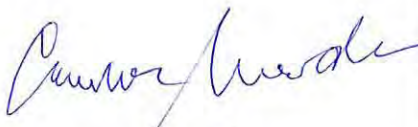
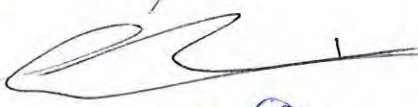
PLEASE NOTE: signatures should be from residents of building, adjoining buildings, and within 2-block area.
 Any other information:

Name	Signature	Address
14 Pompeyo MARTINEZ		215 AVE - A
15 Ali Mohand		NY 10009 217 AVE A
16 Amelia Gutierrez		NY N.Y 10009 508 A 12 th St #10 New York, NY 10009
17 CARMEN MERCADO		533 E 11ST. APT 2 N NY, NY 10009
18 Even Melson		207 Ave. A
19 Eric Rignall		209 Ave A.

The following license is being granted to the following applicant/establishment:

In Rose Bldg 1/5

(Please indicate type of license)

Beer + Wine Only

Address of premises 195 Ave A.

This business will be a bar restaurant (circle one) other Upscale wine bar

The hours of operation will be

M-F 5pm-2am, SAT 11am-2am, Sun 11am-12am

PLEASE NOTE: signatures should be from residents of building, adjoining buildings, and within 2-block area.

Any other information:

Name	Signature	Address
1 Helen Demetrious	Helen Demetrious	520 E. 14 th St, Apt B
2 Casey Warner	Casey Warner	346 E 13 th St, Apt 22
3 HOWARD JACOBSON	[Signature]	441 E 12 th Apt B
4 AMANDA CONTE	Amanda Conte	199 AVE A APT 25
5 JACQUIE DORE	[Signature]	346 E 13 th St APT 20
6 FELICIA HAMMONS	[Signature]	520 E 14 th St
7 ERIC BRATHWAITE	Eric Brathwaite	342 E 13 th St Apt 13
8 GRACE HINE	Grace Hine	346 E 13 th St #8
9 TONY BOSSMAN	Tony Bossman	346 E 13 th Apt 9
10 VICTORIA BARTLEY	[Signature]	346 E 13 Apt 15
11 MATTHEW GUTZNER	[Signature]	346 E 13 Apt 13
12 KALEY PUCKETT	Kaley Puckett	346 E 13 Apt 19
13 MICHAEL SPIRELLI	[Signature]	346 E 13 Apt 19
14 FERNANDEZ BENILLA	[Signature]	346 E 13 Apt 21
15 LISA GOLSHANI	Lisa Golshani	346 E 13 th St #21
16 CAITLIN O'DONNELL	[Signature]	346 E 13 th St #2
17 MEGAN BARROS	[Signature]	346 E 13 th St #B
18 NICK NIEVES	Nick Nieves	342 E 13 St
19 DAVE WHITAKER	[Signature]	441 E 12 th St
20 MICHAEL TURNER	[Signature]	520 E 14 th St
21 ZEPHYRUS GORNEY	Zephyrus Gorney	520 E 14 th St
22 J.D.M.	Pat Darty	520 E 14 th St #7
23 JENNIFER CUNY	Jennifer Cuny	520 E 14 th St #21 W

see you then.

On Jun 26, 2012, at 6:29 PM, IB wrote:

> Thursday 7 PM is fine.

>

> Sent from my iPhone

>

> On Jun 26, 2012, at 6:25 PM, Dale Goodson <goodpoet@verizon.net> wrote:

>

>> How's this Thursday at 7pm?

>>

>> On Jun 25, 2012, at 10:51 PM, ivmaben@aol.com wrote:

>>

>>> 7 PM is fine. We can meet at the location.

>>> -----Original Message-----

>>> From: Dale Goodson <goodpoet@verizon.net>

>>> To: [ivmaben <ivmaben@aol.com>](mailto:ivmaben@aol.com)

>>> Sent: Mon, Jun 25, 2012 10:35 pm

>>> Subject: Re: 195 Ave A

>>>

>>> We will probably be available to meet on a weeknight around 7. Can we meet

in

>>> 195 Ave A?

>>>

>>> On Jun 25, 2012, at 10:23 PM,

>>> ivmaben@aol.com

>>> wrote:

>>>

>>>> Ok!

>>>> -----Original Message-----

>>>> From: Dale Goodson <

>>>> goodpoet@verizon.net

>>>>

>>>> To: [ivmaben <](mailto:ivmaben <ivmaben@aol.com)

>>>> ivmaben@aol.com

>>>>

>>>> Cc: Coamey <

>>>> Coamey@housingworks.org>; mingum <mingum@verizon.net

>>>> >; laurasewell

>>>> <

>>>> laurasewell@earthlink.net>; jimdykenyc <jimdykenyc@aol.com

>>>> >; deejaywhit

>>>> <

>>>> deejaywhit@gmail.com>; dnewcomb <dnewcomb@nyc.rr.com

>>>>

>>>> Sent: Mon, Jun 25, 2012 10:23 pm

>>>> Subject: Re: 195 Ave A

>>>>

>>>> Thank you. We'll get back to you to set up a time.

>>>>

>>>> On Jun 25, 2012, at 10:17 PM,

>>>>

>>> ivmaben@aol.com

>>>

>>>> wrote:

>>>>
>>>>> Mr Goodson,
>>>>>
>>>>> It will be a wine bar with bite size food; basically appetizers, hors
>>>> d'oeuvres etc. I am applying for beer and wine license only.
>>>>>
>>>>> Thanks
>>>>> Ivrose
>>>>> -----Original Message-----
>>>>> From: Dale Goodson <
>>>>
>>>> goodpoet@verizon.net
>>>>
>>>>>
>>>>>> To: ivmaben <
>>>>
>>>> ivmaben@aol.com
>>>>
>>>>>
>>>>>> Cc: Andrew Coamey <
>>>>
>>>> Coamey@housingworks.org
>>>>
>>>>>> ; Jill Ackerman
>>>>> <
>>>>>
>>>> mingum@verizon.net>; Laura Sewell <laurasewell@earthlink.net
>>>>
>>>>>> ; Jim Dyke
>>>>> <
>>>>>
>>>> jimdykenyc@aol.com>; Dave Whitaker <deejaywhit@gmail.com
>>>>
>>>>>> ; David Newcomb
>>>>> <
>>>>>
>>>> dnewcomb@nyc.rr.com
>>>>
>>>>>>
>>>>>>> Sent: Mon, Jun 25, 2012 2:56 pm
>>>>>>> Subject: 195 Ave A
>>>>>>>
>>>>>>> Hello Mr. Bamba,
>>>>>>>
>>>>>>> My name is Dale Goodson and I'm a member of the North Avenue A
Neighborhood
>>>>>>> Association. Recently you contacted another member - Andrew Coamey -
about

>>>> your
>>>>>>> plans for 195 Avenue A. I live at 441 E. 12th in the building right
above
>>>> 195
>>>>>>> Ave A. Sorry about the delay in getting back to you. We've had a lot on
our
>>>>>>> agenda.
>>>>>>>

>>>> Before setting up a meeting could you first let us know briefly the
gist
of
>>>> you
>>>> proposal? What type of business are you looking to open and will it
include
>>> an
>>>>
>>>> application for a beer and wine or liquor license? We look forward to
your

>>>> response.
>>>>
>>>> Thanks,
>>>>
>>>> Dale Goodson
>>>>
>>>>
>>>>
>>>
>>>
>>

See reply below in e-mail body.

-----Original Message-----

From: Coamey, Andrew <Coamey@housingworks.org>

To: ivmaben <ivmaben@aol.com>

Sent: Mon, Jun 25, 2012 1:05 pm

Subject: RE: New Business

I am working to see if a few of my neighbors would be available this Thursday early evening. I have a few quick questions that might help speed this up:

- Have you signed a lease? I am at the last stage of this process
- Are you applying for a full liquor license or beer and wine? Beer and Wine only
- Are you intending opening a restaurant or a bar or a lounge? A Wine bar with bite size food, appetizers, small meals etc.

Any information you can provide in advance of a meeting would be helpful.

Thanks

Andrew Coamey

Senior Vice President for Housing Development & Chief Financial Officer

Housing Works, Inc.

57 Willoughby Street, 2 FL

Brooklyn, NY 11201

TEL 347-473-7405 FAX 347-473-7464

Coamey@housingworks.org

www.housingworks.org

From: ivmaben@aol.com [<mailto:ivmaben@aol.com>]

Sent: Monday, June 18, 2012 10:42 AM

To: Coamey, Andrew

Subject: Re: New Business

Good Morning Mr. Coamey,

I thought to resend this e-mail today since I have not heard back from you. I am anxious to outline my company business plan to your organization. Thank you for your attention to this matter.

Ivrose

-----Original Message-----

From: ivmaben <ivmaben@aol.com>

To: coamey <coamey@housingworks.org>

Sent: Wed, Jun 13, 2012 9:38 am

Subject: New Business

Good morning Mr. Coamey,

My name is Ivrose Bamba. I hope to open a new business at 195 Avenue A. I have contacted Mr. Edwin Chan from Community Board 3 and inquire if there was a block or tenant association for the community; he gave me your e-mail. I wish to share my plan and be familiar with the association. Please advise on the process to follow.

Thank You,

Ivrose

Premises within 5 blocks

Restaurants/Café

14th & 13th Streets

- Planet Rose 219 Avenue A
- The Horse Box 218 Avenue A
- Fat Buddha Bar 212 Avenue A
- Percy's Tavern 210 Avenue A
- Destination Bar 211 Avenue A (Corner 13th St)

13th & 12th Streets

- Common Ground 206 Avenue A
- OST Café 441 East 12th St
- El Camion 194 Avenue A (Corner 12th St)

12th & 11th Streets

- Table 12 188 Avenue A (Corner 12th St)

11th & 10th Streets

- Westville East 173 Avenue A (Corner 11th St)
- Bad Burger 171 Avenue A
- Barona 170 Avenue A (Corner 11th St)
- Hi Fi 169 Avenue A
- Diablo 167 Avenue A
- Horus Café 293 East 10th St (Corner 10th St)

Premises within 5 blocks

10th & 9th Streets

- Café Pick Me Up 115 Avenue A (Corner 9th St)

Avenue A and 1st Avenue

- Terroir 413 12th St
- Mug Lunch 446 East 13th St
- Phoenix 447 East 13th St

Churches

At 10th St between Avenue A and 1st Avenue

- *St Nicholas*

At 12th St between Avenue A and 1st Avenue

- *Mary Help of Christians (closed)*
- *Public School 60*