

THE CITY OF NEW YORK  
 MANHATTAN COMMUNITY BOARD 3  
 59 East 4th Street - New York, NY 10003  
 Phone (212) 533-5300  
 www.cb3manhattan.org - mn03@cb.nyc.gov

Andrea Gordillo, Board Chair

Susan Stetzer, District Manager

**Community Board 3 Liquor License Application Questionnaire**

**NOTE: ALL ITEMS MUST BE SUBMITTED FOR APPLICATION TO BE CONSIDERED.**

**The following items and questionnaire package are due by date listed in email invite:**

- Schematics, floor plans or architectural drawings of the inside of the premise.
- A proposed food and or drink menu.

**The following items are due by noon Wednesday before the meeting:**

- Petition in support of proposed business or change in business with signatures from residential tenants at location and in buildings adjacent to, across the street from and behind proposed location. Petition must give proposed hours and method of operation. For example: restaurant, sports bar, combination restaurant/bar. (petition provided)
- Notice of proposed business to block or tenant association if one exists. You can find community groups and contact information on the CB 3 website:  
<https://www1.nyc.gov/site/manhattancb3/resources/community-groups.page>  
 (this is not required but strongly suggested if a relevant group exists)
- Proof of conspicuous posting of notices at the site for 7 days prior to the meeting (please include newspaper with date in photo or a timestamped photo).

Check which you are applying for:

- new liquor license     alteration of an existing liquor license     corporate change

Check if either of these apply:

- sale of assets     upgrade (change of class) of an existing liquor license

**Today's Date:** \_\_\_\_\_

Is location currently licensed?  Yes  No    Type of license: Restaurant Serving Beer, Wine, and Cider (RW)

If alteration, describe nature of alteration: \_\_\_\_\_  
change in class from beer & wine license to a full on-premises liquor license

Previous or current use of the location: Restaurant

Corporation and trade name of current license: Momofuku 171 First Avenue, LLC DBA Momofuku Noodle Bar

**APPLICANT:**

Premise address: 171 1st Ave, New York, NY 10003

Cross streets: Between E 11th Street and E 10th Street

Name of applicant and all principals: Momofuku 171 First Avenue, LLC  
David Chang - Manager, Momo Holdings, LLC - Member - 95%

Trade name (DBA): Momofuku Noodle Bar

**PREMISE:**

Type of building and number of floors: Pre-War Building, 5 Floors

Does premise have a valid Certificate of Occupancy, including for any back/side yard or roof use?

Yes  No What is maximum NUMBER of people permitted 74

What is the zoning designation (check zoning using map: <http://gis.nyc.gov/doitt/nycitymap/> - please give specific zoning designation, such as R8 or C2): R7A

**PROPOSED METHOD OF OPERATION:**

What are the proposed days/hours of operation? (Specify days and hours each day and hours of outdoor space, if applicable) Monday - Friday: 11 a.m - 2 a.m., Saturday- Sunday: 10 a.m. - 2 a.m.

Outdoor Space - N/A

Will any other business besides food or alcohol service be conducted at premise, i.e., retail?  Yes  No

If yes, please describe what type: \_\_\_\_\_

Number of indoor tables? 5 Total number of indoor seats? 67

How many stand-up bars/bar seats are located on the premise (number, length, and location) 1

There is no traditional "bar", but there is high top seating at a 'ramen bar' and kitchen

*(A **stand-up bar** is any bar or counter -with seating or not- where you can order, pay for, and receive alcohol)*

Does premise have a full kitchen?  Yes  No

Does it have a food preparation area?  Yes  No (If any, show on diagram)

Is food available for sale?  Yes  No If yes, describe type of food and submit a menu \_\_\_\_\_

Ramen

What are the hours the kitchen will be open? open during all hours of operation

Will a manager or principal always be on site?  Yes  No If yes, which? Manager

How many employees will there be? 15-20

Do you have or plan to install  French doors  accordion doors or  windows? Note - Windows do not open

Will there be TVs/monitors?  Yes  No (If Yes, how many?) \_\_\_\_\_

Will premise have music?  Yes  No

If Yes, what type of music?  Live musician  DJs  Streaming services/playlists

If other type, please describe \_\_\_\_\_

What will be the music volume?  Background (conversational)  Entertainment (live music venue level) Please describe your sound system: Ceiling mounted speakers

Will you host any promoted events, scheduled performances, or any event at which a cover fee is charged? If Yes, what type of events or performances are proposed and how often? No

If promoted events, please explain the nature in which you plan to promote? Social media / online ads / outside promoters? N/A

How do you plan to manage vehicular traffic and crowds on the sidewalk caused by your establishment?

Please attach plans. (Please do not answer "we do not anticipate congestion.") We have a virtual waitlist that allows guests to receive a text when their table is ready. This significantly reduces congestion and prevents lines.

Will there be security personnel?  Yes  No (If Yes, how many and when) We do not have security personnel (it has not been necessary in our 20 years of business). If at any time security is necessary to maintain control, we will engage security

How do you plan to manage noise inside and outside your business so neighbors will not be affected?

Please attach plans. A staff person monitors the door to ensure that there is no loitering. Also, the restaurant has a vestibule that limits sound from bleeding outside and there are no operable windows.

Is sound proofing installed?  Yes  No

If not, do you plan to install sound proofing?  Yes  No

Are there current plans to use the Open Restaurants program for the sale or consumption of alcoholic beverages outdoors? (includes roof & yard)  Yes  No If Yes, describe and show on diagram:

\_\_\_\_\_  
\_\_\_\_\_

#### APPLICANT HISTORY:

Has this corporation or any principal been licensed for sale of alcohol previously?  Yes  No

If yes, please indicate name of establishment: Momofuku Noodle Bar

Address: 171 1st Ave, New York, NY 10003 Community Board # Manhattan Community Board 3

Dates of operation: August 2004 - Present

Has any principal had work experience similar to the proposed business?  Yes  No If Yes, please attach explanation of experience or resume. Note: failure to disclose previous experience or information hampers the ability to evaluate this application.

Does any principal have other businesses in this area?  Yes  No If Yes, please give trade name, address and describe the business Momofuku Noodle Bar (Uptown) - The Shops at Columbus Circle, third fl, 10 Columbus Circle, New York, NY 10019  
Kabawa - 8 Extra place, New York, NY 10003

Has any principal had SLA reports or action within the past 5 years?  Yes  No If Yes, attach list of violations and dates of violations and outcomes, if any.

Attach a separate diagram that indicates the location (**name and address**) and total number of establishments selling/serving beer, wine (B/W) or liquor (OP) for 2 blocks in each direction. Please indicate whether establishments have On-Premise (OP) licenses. Please label streets and avenues and identify your location. Use letters to indicate **Bar**, **Restaurant**, etc. The diagram must be submitted with the questionnaire to the Community Board before the meeting.

**LOCATION:**

How many licensed establishments are within 1 block? Approx 6

How many On-Premise (OP) liquor licenses are within 500 feet? Approx 20

Is the premise within 200 feet on the same street of any school or place of worship?  Yes  No

**COMMUNITY OUTREACH:**

Please see the Community Board website to find block associations or tenant associations in the immediate vicinity of your location for community outreach. Applicants are encouraged to reach out to community groups, but it is not required. Also use provided petitions, which clearly state the name, address, license for which you are applying, and the hours and method of operation of your establishment at the top of each page. (Attach additional sheets of paper as necessary)

***We are including the following questions to be able to prepare stipulations and have the meeting be faster and more efficient. Please answer per your business plan; do not plan to negotiate at the meeting.***

1. My license type is:  beer & cider  wine, beer & cider  liquor, wine, beer & cider
2.  I will operate a full-service restaurant, specifically a (type of restaurant) Ramen restaurant, or  
 I will operate a \_\_\_\_\_,  
 with a kitchen open and serving food during all hours of operation OR  with less than a full-service kitchen but serving food during all hours of operation OR  Other  
\_\_\_\_\_
3. My hours of operation will be:  
Mon 11 a.m. - 2 a.m.; Tue 11 a.m. - 2 a.m.; Wed 11 a.m. - 2 a.m.;  
Thu 11 a.m. - 2 a.m.; Fri 11 a.m. - 2 a.m.; Sat 10 a.m. - 2 a.m.;  
Sun 10 a.m. - 2 a.m.. (I understand opening is "no later than" specified opening hour, and all patrons are to be cleared from business at specified closing hour.)
4.  I will not use outdoor space for commercial use (including Open Restaurants) OR  
 I will close all outdoor dining allowed under the temporary Open Restaurants program and any other subsequent uses by 10:00 P.M. all days and not have any speakers or TV monitors outdoors
5.  I will employ a doorman/security personnel: \_\_\_\_\_
6.  I will install soundproofing, \_\_\_\_\_

7.  I will close any front or rear façade doors and windows at 10:00 P.M. every night or when amplified sound is playing, including but not limited to DJs, live music and live nonmusical performances, or during unamplified performances or televised sports.
- I will have a closed fixed façade with no open doors or windows except my entrance door, which will close by 10:00 P.M. or when amplified sound is playing, including but not limited to DJs, live music and live nonmusical performances, or during unamplified performances or televised sports.
8. I will not have  DJs,  live music,  third-party promoted events,  any event at which a cover fee is charged,  scheduled performances,  more than \_\_\_\_\_ DJs per \_\_\_\_\_,  more than \_\_\_\_\_ private parties per \_\_\_\_\_
9.  I will play ambient recorded background music only.
10.  I will not apply for an alteration to the method of operation or for any physical alterations of any nature without first coming before CB 3.
11.  I will not seek a change in class to a full on-premises liquor license without first obtaining approval from CB 3.
12.  I will not participate in pub crawls or have party buses come to my establishment.
13.  I will not have unlimited drink specials, including boozy brunches, with food.
14.  I will not have a happy hour or drink specials with or without time restrictions OR  I will have happy hour and it will end by \_\_\_\_\_.
15.  I will not have wait lines outside.  I will have a staff person responsible for ensuring no loitering, noise or crowds outside.
16.  I will conspicuously post this stipulation form beside my liquor license inside of my business.
17.  Residents may contact the manager/owner at the number below. Any complaints will be addressed immediately. I will revisit the above-stated method of operation if necessary in order to minimize my establishment's impact on my neighbors.

Name: Eugene Lee

Phone Number: 212-777-7773

David Chang is the founder of Momofuku. Since opening his first restaurant, Momofuku Noodle Bar, in 2004, he has been named one of “the most influential people of the 21st century” by Esquire, received six James Beard Awards, recognized as GQ’s Man of the Year and a Time 100 honoree. He is the host of The Dave Chang Show and Recipe Club podcasts, and three original documentary series; Breakfast Lunch and Dinner and Ugly Delicious on Netflix and The Next Thing You Eat on Hulu. His cookbooks *Momofuku*, and *Cooking At Home*, and memoir *Eat A Peach* are all New York Times bestsellers.

## **Noodle Bar – East Village**

### **Food Menu**

#### **Daily**

Crispy Spring Chicken – charred romaine, chili, garlic **45**

Black Truffle Ramen – roasted miso, egg yolk, butter **55**

#### **Hand Rolls**

Marinated Mushrooms (v) – mushroom xo, scallion **19**

Spicy Scallop – spicy mayo, tempura crunch **21**

Extra Spicy Tuna – thai bird chili, pickled ginger **21**

Yuzu Tuna – ginger, scallion **21**

#### **Buns (2 pc)**

Pork Belly – hoisin, scallion, cucumber **16**

Roasted Shiitake – hoisin, scallion, cucumber **15**

Seared Shrimp – spicy mayo, pickled red onion, iceberg **16**

#### **Small**

Kimchi **7**

Daikon & Jalapeño (v) **6**

Green Salad – carrots, salsa seca, miso vinaigrette **12**

Spicy Cucumber Salad (v) – radish, sichuan peppercorn, peanuts **13**

Florentino Cauliflower – curry, jalapeno, cotija **18**

Smoked Chicken Wings – garlic, thai chili, scallion **18**

#### **Noodles** *ramen served with momofuku barley noodles*

Smoked Pork Ramen\* – pork belly & shoulder, poached egg, bamboo **21**

Garlic Chicken Ramen\* – baby bok choy, poached egg **20**

Spicy Mushroom Ramen (v) – miso, toasted chili, yu choy **20**

Ginger Scallion Noodles (v) – pickled shiitake, cucumber, wakame **19**

Chilled Spicy Noodles – pork sausage, thai basil, peanuts **19**

add ons –

chili crunch **1.5**

poached egg\* **2**

chicken **4**

pork belly **5**

#### **Dessert**

Pineapple Yuzu Soft Serve – thai basil whipped cream, candied yuzu **10**

Caramelized White Chocolate Pie – hazelnut, puffed rice **11**

\*Consuming raw or undercooked meats, poultry, seafood, or eggs may increase your risk of food borne illness.

v=Vegan

## **Noodle Bar – East Village**

### **Beer**

**Orion**, Lager, Japan **7**

**Echigo**, Flying IPA, Japan **10**

**Threes Vliet**, Pilsner, Brooklyn, NY **13**

**Michelada**, Orion, Jalapeno, Yuzu **10**

### **Wine**

#### *Sparkling*

Crémant de Loire Brut, **Maison Foucher**, *Cuvee des Roys de Naples*, Loire, FR. NV **15/65**

#### *White*

Sauvignon Blanc, **Valery Renaudat**, *Les Lignis*, Loire, FR. '20 **15/65**

Chardonnay, **Dunites**, *Windward*, San Luis Obispo, CA. '23 **17/80**

Rosé, **Lampyres**, *Margot*, Roussillon, FR '22 **18/85**

#### *Red*

Red Blend, **Weingut Heinrich**, *Naked Red*, Burgenland, AUS '19 **15/65**

### **Soju**

Spicy Lychee Slushie **15**

Spiked Yuzu Lemonade **14**

Jinro Soju 4 oz. **8**

Takara Chu-Hi Fuji Apple **10**

### **Sake**

**Dokan Umeshu** Ume Highball **14**

**Asahiyama** Junmai, Nigata, JPN. **14 gl**

**Akitabare Momofuku** Nama Honjozo, Akita, JPN. **15/75**

**Kinoene Hanayaka** Junmai Daiginjo, Chiba, JPN. **17/85**

**Kiki- Masamune Kinushiro** Nigori, Ishikawa, JPN. **12/55**

**Noguchi Kanagaso** Junmai Ginjo, Ishikawa, JPN. **17/85**

**Flight of 3** Akitabare, Kinoene, Noguchi **25**

### **Non-Alcoholic**

**Athletic Brewing Co. Upside Dawn**, Golden, USA **10**

### **Soft Drinks**

Yuzu Lemonade **8**

Jasmine Tea **6**

Coke **4**

Diet Coke **4**

Seagram's Ginger Ale **4**

San Pellegrino Orange **4**

San Pellegrino 500ml **7**

Acqua Panna 500 ml **7**



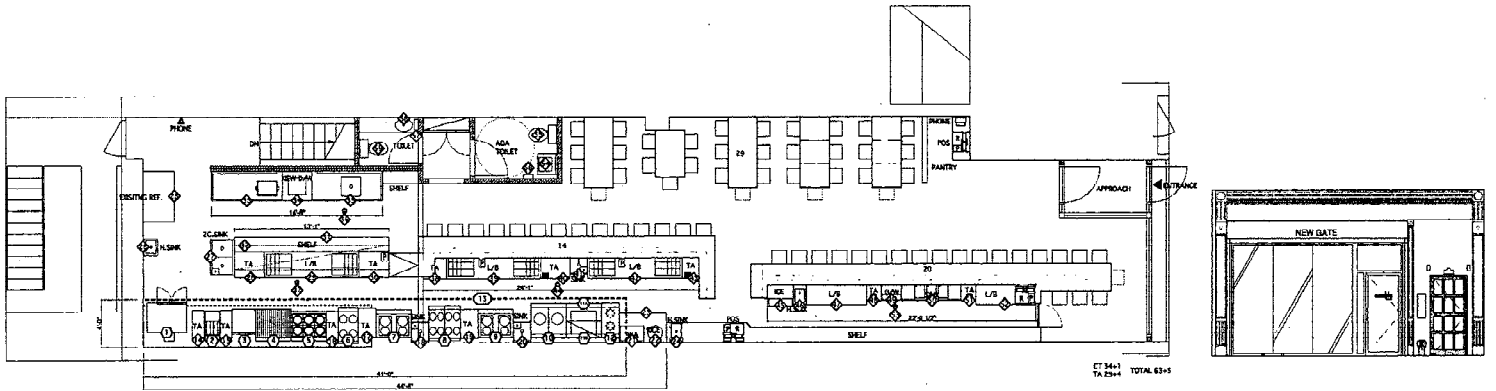

CT 34-1  
TA 25-4 TOTAL 63-5

NO.	NAME	MODEL # / COMPANY	SIZE (IN/OD)	POWER	SUPPLY	REAR	NOTE
(1)	EXISTING DEGRAS CONVECTION OVEN	HC302/ROBERT	30"X41"X37"	GAS/ 88,000 BTU (RATED/115/200)		REAR	
(2)	EXISTING DEEP FRYER	SE14/PIRELL	18"X24"X44"	GAS/10,000 BTU		REAR	
(3)	EXISTING BROILER	SE40/PIRELL	18"X24"X44"	GAS/10,000 BTU		REAR	
(4)	EXISTING CHAMBERLAIN	GR318/GARLAND	18"X24"X44"	GAS/10,000 BTU		REAR	
(5)	EXISTING 6 BURNER W/WHEN	JCS	36"X24"X36"	GAS/200,000 BTU		REAR	
(6)	CUSTOM MIDDLE COOKER	/BOWERY	20"X24"X40"	GAS/100,000 BTU	COLD/DRAIN	REAR	
(7)	EXISTING WARMER	/	30"X24"X36"	GAS/ 80,000 BTU	COLD/DRAIN	REAR	
(8)	WOODLE COOKER	TRC2/PIRELL	11"X14"X33"X11"	GAS/ 80,000 BTU	COLD/DRAIN	REAR	
(9)	CUSTOM WARMER	/BOWERY	30"X24"X36"	GAS/ 80,000 BTU	COLD/DRAIN	REAR	
(10)	HOT TOP WARMER	PHB-2/PIRELL	30"X24"X36"	GAS/ 80,000 BTU		REAR	
(11)	FLASKTOP WARMER	FRW-120/PIRELL	12"X12"X22"X24"X18"	GAS/12,500 BTU		REAR	
(12)	SALAD WARMER	SS-120/PIRELL	18"X18"X24"	GAS/1,000 BTU		REAR	
(13)	BUNNER RANGE	PRB-2/PIRELL	18"X24"X36"	GAS/ 70,000 BTU		REAR	
				TOTAL GAS/1108,500 BTU			
(14)	NEW EXHAUST HOOD W/ FAN	CUSTOM	41"X24"X40"				
(15)	EXISTING S/S TABLE	EXISTING	12"X21"X36"				
(16)	EXISTING S/S TABLE	EXISTING	12"X21"X36"				
(17)	EXISTING S/S TABLE	EXISTING	12"X21"X36"				
(18)	1 COMP SINK	441-18/ADVANCE/TABCO	18"X21"X13"3/4"		COLD/DRAIN	REAR	INSTALL DEFWELL
(19)	S/S TABLE	CUSTOM/BOWERY	18"X24"X36"		COLD/DRAIN	REAR	INSTALL DEFWELL
(20)	1 COMP SINK	441-18/ADVANCE/TABCO	18"X21"X13"3/4"	ELEC/120/60/1			NEED FAUCET
(21)	WARMER	24"X13"X10"		ELEC/120/60/1			
(22)	RICE COOKER	18"X24"X12"		ELEC/120/60/1			
(23)	S/S TABLE	CUSTOM/BOWERY	18"X24"X36"		COLD/DRAIN	REAR	INSTALL DEFWELL
(24)	WASH SINK	DR-1110/ADVANCE/TABCO	13"X13"X10"		COLD/DRAIN	REAR	NEED FAUCET
(25)	EXISTING REACH-IN REF.	EXISTING		ELEC/120/60/1			
(26)	EXISTING HAND SINK	EXISTING		ELEC/120/60/1			
(27)	2 COMP SINK	44-250/ADVANCE/TABCO	24"X24"X13"3/4"		COLD/DRAIN	REAR	INSTALL DEFWELL
(28)	S/S TABLE	CUSTOM/BOWERY	30"X24"X36"		COLD/DRAIN	REAR	INSTALL DEFWELL
(29)	CUSTOM LOW BOY REF.	CUSTOM/BOWERY	36"X24"X36"	ELEC/120/60/1			NEED DEWATO COMP.
(30)	S/S TABLE	CUSTOM/BOWERY	30"X24"X36"		COLD/DRAIN	REAR	INSTALL DEFWELL
(31)	S/S SHELF	CUSTOM/BOWERY	18"X18"X18"		COLD/DRAIN	REAR	INSTALL DEFWELL
(32)	HANDING SHELF	CUSTOM/BOWERY	15"X15"X18"		COLD/DRAIN	REAR	INSTALL DEFWELL
(33)	CLEAN TABLE		24"X24"X24"		COLD/DRAIN	REAR	NEED CHEMICAL
(34)	DISHWASH MACHINE		30"X24"X36"	ELEC/120/60/1			NEED CHEMICAL
(35)	SOUP TABLE		24"X24"X24"		COLD/DRAIN	REAR	NEED SINK FAUCET

NO.	NAME	MODEL # / COMPANY	SIZE (IN/OD)	POWER	SUPPLY	REAR	NOTE
(36)	FLOOR DRAIN	PLUMBER					DRAIN
(37)	FLOOR DRAIN	PLUMBER					DRAIN
(38)	S/S TABLE	CUSTOM/BOWERY	24"X24"X36"				
(39)	CUSTOM LOW BOY REF.	CUSTOM/BOWERY	36"X24"X36"	ELEC/120/60/1			NEED DEWATO COMP.
(40)	S/S TABLE	CUSTOM/BOWERY	18"X24"X36"				
(41)	1 COMP SINK	441-18/ADVANCE/TABCO	18"X21"X13"3/4"		COLD/DRAIN	REAR	NEED FAUCET
(42)	CUSTOM LOW BOY REF.	CUSTOM/BOWERY	36"X24"X36"	ELEC/120/60/1			NEED DEWATO COMP.
(43)	S/S TABLE	CUSTOM/BOWERY	24"X24"X36"				
(44)	FLOOR DRAIN	PLUMBER					DRAIN
(45)	UNDER COUNTER ICE MACHINE	U-11/IGAM/WHITING	24"X24"X36"3/4"	ELEC/120/60/1			COLD/DRAIN
(46)	HAND SINK	CUSTOM/BOWERY	12"X12"X10"		COLD/DRAIN	REAR	NEED FAUCET
(47)	BOTTLE COOLER	TBR-24/IGAM/WHITING	61"X24"X36"3/4"	ELEC/120/60/1			COLD/DRAIN
(48)	S/S TABLE	CUSTOM/BOWERY	18"X24"X36"				
(49)	UNDER COUNTER GLASS WASHER	U-11/IGAM/WHITING	24"X24"X36"3/4"	ELEC/208-240/50			COLD/DRAIN
(50)	2 COMP WASH SINK W/ DRAIN BOARD	DR-1110/ADVANCE/TABCO	18"X24"X36"		COLD/DRAIN	REAR	NEED FAUCET
(51)	S/S TABLE	CUSTOM/BOWERY	18"X24"X36"				
(52)	BOTTLE COOLER	TBR-24/IGAM/WHITING	61"X24"X36"3/4"	ELEC/120/60/1			COLD/DRAIN
(53)	FLOOR DRAIN	PLUMBER					DRAIN
(54)	ADA TOILET SINK						
(55)	ADA TOILET						
(56)	EXISTING HAND DRYER						
(57)	EXISTING HAND DRYER						
(58)	TOILET SINK SUCT TOP						
(59)	TOILET						

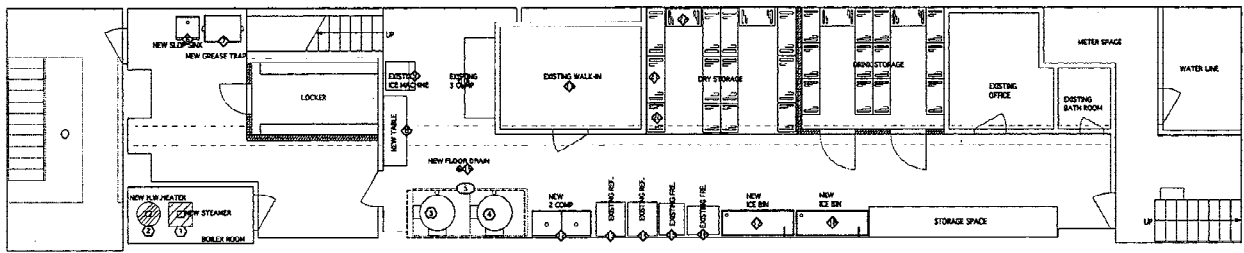

BASMENT PLAN  
1630.00 S.F.  
SCALE: 1/4"=1'-0"

NO.	NAME	MODEL # COMPANY	SIZE (width)	POWER	SUPPLY	NOTE
1	STEAM BOILER			BTU	COLD/DRAIN	NEED
2	WALK-IN COOL	A/SUMMIT		BTU	COLD/DRAIN	NEED
3	REG. STEAM KETTLE			GAS/155,000 BTU		NEED
4	REG. STEAM KETTLE			GAS/155,000 BTU		NEED
5	EXIST. REACH IN CABINETS		10'-0" x 24'-0"			
6	SLOP SINK	PLUMBER			DRAIN	
7	GREASE TRAP	PLUMBER				
8	C.E. TABLE	CUSTOM/BOWERY	72"x24"x18"			
9	EXISTING ICE MACHINE	EXISTING	30"x30"x30"	ELEC/200/40/1	COLD/DRAIN	
10	EXISTING 3 COMP SINK	EXISTING	81"x21"x18"		COLD/HOT/DRAIN	
11	EXISTING WALK-IN	EXISTING	60"x27.5"x33"	ELEC/	COLD/HOT/DRAIN	NEED FAUCET
12	EXISTING REACH IN REF.	EXISTING		ELEC/		
13	EXISTING REACH IN REF.	EXISTING		ELEC/		
14	EXISTING REACH IN FRIG.	EXISTING		ELEC/		
15	EXISTING REACH IN FRIG.	EXISTING		ELEC/		
16	CUSTOM ICE BIN	CUSTOM/BOWERY	72"x24"x18"		DRAIN	NEED FAUCET
17	CUSTOM ICE BIN	CUSTOM/BOWERY	72"x24"x18"		DRAIN	NEED FAUCET
18	FLOOR DRAIN	PLUMBER				
19	30" WIRE SHELF					
20	42" WIRE SHELF					
21	48" WIRE SHELF					

This report is for informational purposes only in aid of identifying establishments potentially subject to 500 and 200 foot rules. Distances are approximated using industry standard GIS techniques and do not reflect actual distances between points of entry. The NYS Liquor Authority makes no representation as to the accuracy of the information and disclaims any liability for errors.

Proximity Report For:	
Location	<b>171 1st Ave, New York, New York, 10003</b>
Geocode	<b>Latitude: 40.72920 longitude: -73.98438</b>
Report Generated On	<b>12/16/2024</b>

8 Closest Liquor Stores		
Name	Address	Distance
EAST VILLAGE WINES & SPIRITS INC License ID: 0100-23-123702 Legacy Serial No.: 1302369	138 1ST AVE NEW YORK, New York 10009	532 ft
SAKAYA INC License ID: 0100-22-116932 Legacy Serial No.: 1189050	324 E 9TH STREET (WEST STORE) 1ST & 2ND AVE. NEW YORK, New York 10003	644 ft
MIAT LIQUORS INC License ID: 0100-22-118312 Legacy Serial No.: 1023526	166 2ND AVE NEW YORK, New York 10003	676 ft
CARMAD INC License ID: 0100-21-114480 Legacy Serial No.: 1023546	224 226 1ST AVE NEW YORK, New York 10009	790 ft
CONVIVE PARTNERS LLC License ID: 0100-22-117111 Legacy Serial No.: 1290950	196 AVENUE A NEW YORK, New York 10009	919 ft
MRN LIQUOR INC License ID: 0100-21-115430 Legacy Serial No.: 1284586	16 ST MARKS PL NEW YORK, New York 10003	1,327 ft
BRIX NYC LLC License ID: 0100-22-117087 Legacy Serial No.: 1298290	170 AVENUE B STORE SOUTH NEW YORK, New York 10009	1,461 ft
236 WINES & LIQUORS INC License ID: 0100-22-118276 Legacy Serial No.: 1023535	279 1ST AVENUE NEW YORK, New York 10003	1,475 ft

Schools within 500 feet		
Name	Address	Distance
EAST VILLAGE COMMUNITY SCHOOL (THE)	185 1ST AVE NEW YORK, NY 10003	220 ft

Churches within 500 feet	
Name	Distance
Madina Masjid - Islamic Council Of America	159 ft
Trinity Grace Church East Village	240 ft
Tenth Street Church Of Christ	319 ft
Zahirul Kaium Parish	322 ft
Fourth Angel Free Seventh-day Adventist Church	383 ft

Pending On Premises Liquor Licenses within 750 feet		
Name	Address	Distance
Fuwa Fuwa New York Inc Application ID: NA-0340-24-133586	153 1st Ave New York, NY 10003.0	274 ft
Tramps Like Us LLC Application ID: NA-0340-24-123658	412-414 E 9th St New York, New York 10009.0	445 ft

Pending On Premises Liquor Licenses within 750 feet		
Name	Address	Distance
First Avenue Dining LLC Application ID: NA-0340-24-145441	135 1st Ave New York, NY 10003.0	571 ft
2nd Ave Pizza Palace Corp Application ID: NA-0340-24-145254	176 2nd Ave New York, NY 10003.0	657 ft
CHURCH & LOUIS INC Application ID: NA-0340-24-133439	180 2nd Ave New York, New York 10003.0	673 ft

Active On Premises Liquor Licenses within 750 feet		
Name	Address	Distance
CGJC HOLDINGS LLC License ID: 0340-22-109281 Legacy Serial No.: 1305172	168 1ST AVE NEW YORK, New York 10009	125 ft
AGN RESTAURANT LLC License ID: 0340-23-136037 Legacy Serial No.: 1295706	166 1ST AVE NEW YORK, New York 10009	138 ft
JARLENE CORP License ID: 0340-22-112176 Legacy Serial No.: 1290480	160 1ST AVE NEW YORK, New York 10009	236 ft
TKM 228 EAST 10TH ST LLC License ID: 0340-23-130850 Legacy Serial No.: 1328187	228 E 10TH ST NEW YORK, New York 10003	289 ft
SUSHI LAB LLC License ID: 0340-24-105835 Legacy Serial No.: 6013852	320 E 11TH ST NEW YORK, New York 10003	342 ft
IMMIGRANT WINE BAR LLC, THE License ID: 0370-24-137494 Legacy Serial No.: 6046352	341 E 9TH ST NEW YORK, New York 10003	376 ft
IMMIGRANT TAP ROOM INC License ID: 0370-23-163009 Legacy Serial No.: 6005383	341 E 9TH ST WEST STORE NEW YORK, NY 10003	376 ft
A VENIERO INC License ID: 0340-21-118367 Legacy Serial No.: 1122289	342 EAST 11TH STREET NEW YORK, New York 10003	387 ft
HEARTH RESTAURANT INVESTORS LLC License ID: 0340-21-116073 Legacy Serial No.: 1144865	403 E 12TH ST 1ST AVENUE & NEW YORK, New York 10009	400 ft
BIG BEN RESTAURANT CORP License ID: 0340-23-136134 Legacy Serial No.: 1347828	212 E 10TH ST NEW YORK, New York 10003	459 ft
201 EV LLC License ID: 0340-24-113841 Legacy Serial No.: 6022092	201 1st Ave New York, NY 10003	461 ft
BIG LEE AND SASHAS INC License ID: 0370-24-103287 Legacy Serial No.: 6011270	140 1ST AVE NEW YORK, New York 10009	511 ft
TAQUERIA SAINT MARKS PLACE INC License ID: 0340-23-139171 Legacy Serial No.: 1282265	79 SAINT MARKS PL NEW YORK, New York 10003	593 ft
75 ST MARKS PLACE LLC License ID: 0370-24-113407 Legacy Serial No.: 6021649	75 ST MARKS PL NEW YORK, New York 10003	600 ft
BARMAR LLC License ID: 0340-22-109758 Legacy Serial No.: 1108851	77 ST MARKS PLACE NEW YORK, New York 10003	617 ft
PJ RESTAURANT INC License ID: 0340-23-129460 Legacy Serial No.: 1299503	302 E 12TH ST NEW YORK, New York 10003	631 ft
PEPRICO INC License ID: 0340-22-103009 Legacy Serial No.: 1279139	182 2ND AVE NEW YORK, New York 10003	637 ft
RIVKA INC License ID: 0340-22-107112 Legacy Serial No.: 1155091	101 ST MARKS PLACE NEW YORK, New York 10009	638 ft
LITTLE REBEL INC License ID: 0340-23-138770 Legacy Serial No.: 1285359	134 1ST AVE NEW YORK, New York 10009	647 ft
EST RESTAURANT CORP License ID: 0340-23-134062 Legacy Serial No.: 1300345	349 E 13TH ST NEW YORK, New York 10003	678 ft

Active On Premises Liquor Licenses within 750 feet		
Name	Address	Distance
ANIMALS GROUP INC License ID: 0340-22-112472 Legacy Serial No.: 1323698	90 ST MARKS PL AKA 132 1ST AVE NEW YORK, New York 10009	680 ft
JUDEX ENTERPRISES INC License ID: 0340-23-131131 Legacy Serial No.: 1024266	178 2ND AVENUE NEW YORK, New York 10003	699 ft
NUDIBRANQUIO LLC License ID: 0340-22-108365 Legacy Serial No.: 1340390	125 127 1ST AVE NEW YORK, New York 10003	701 ft
NOREETUH RESTAURANT LLC License ID: 0340-22-108213 Legacy Serial No.: 1337700	128 1ST AVE NEW YORK, New York 10009	727 ft
31 ORCHARD ST REALTY INC License ID: 0370-24-131821 Legacy Serial No.: 6040527	301 E 12TH ST NEW YORK, New York 10003	736 ft
PATTY MC CARTHYS INC License ID: 0340-23-131650 Legacy Serial No.: 1024662	169 AVENUE A NEW YORK, New York 10009	745 ft
SADA THREE LLC License ID: 0340-22-111058 Legacy Serial No.: 1280002	132 ST MARKS PL NEW YORK, New York 10009	749 ft



# NYS Liquor Authority Mapping Project (LAMP)

version: 3.0.0

Search By Proximity

Search for an address or locate on map

171 1st Ave, New X

Show results within (Feet)

0 1500

Active Licenses	(31)
Pending Licenses	(4)
Inactive Licenses	(55)
Places of Worship	(5)

Search by Lic ID, Ser#, Name, City, Zip, ...

### Tasks

- Search Active Licenses
- Search Pending Licenses
- Search Inactive Licenses

Tasks	Results

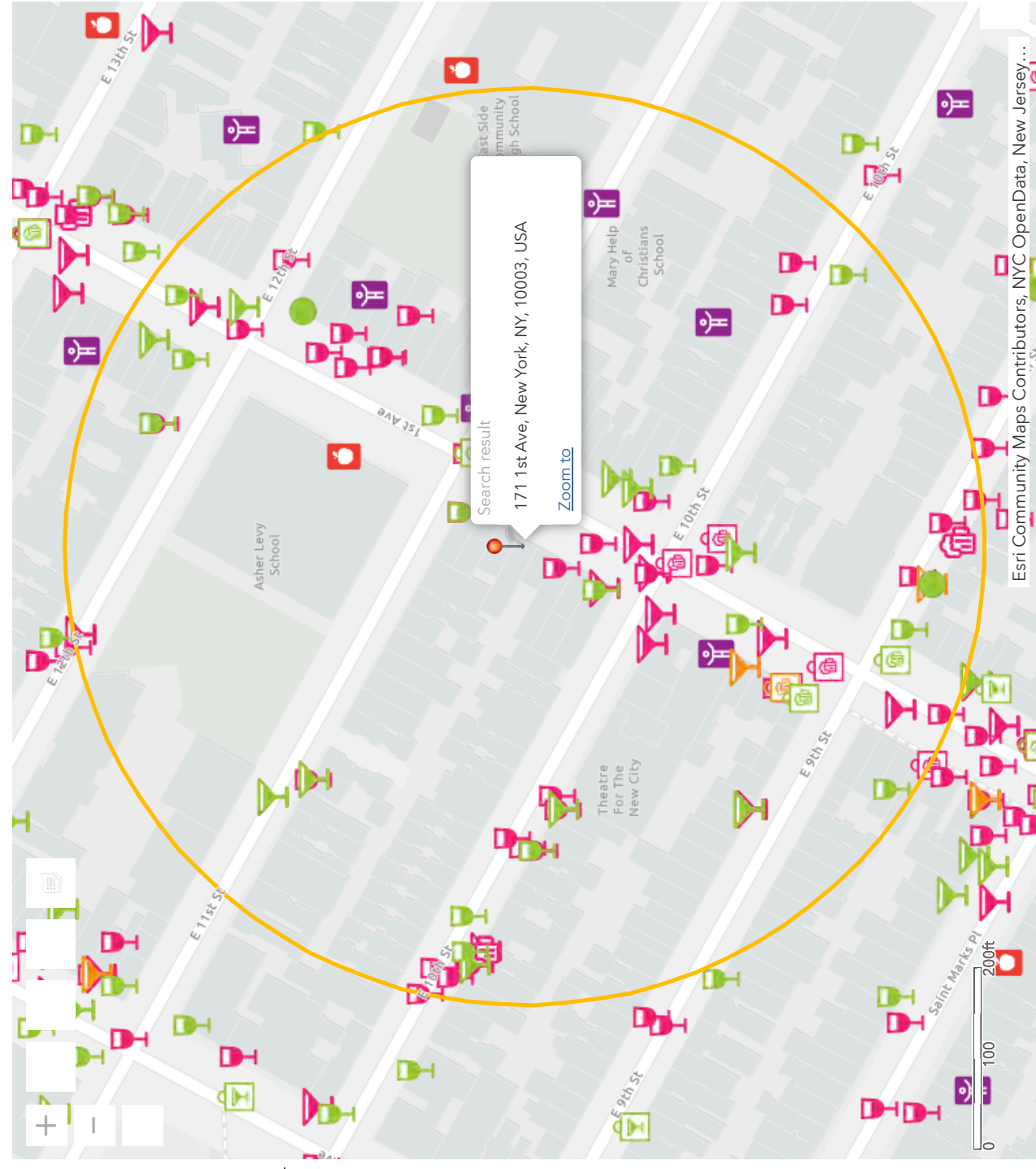

Esri Community Maps Contributors, NYC OpenData, New Jersey...