

# 36<sup>th</sup> Ave and Vernon Blvd

Pedestrian Safety Improvements

Spring  
2011



# Existing Conditions - Project Area

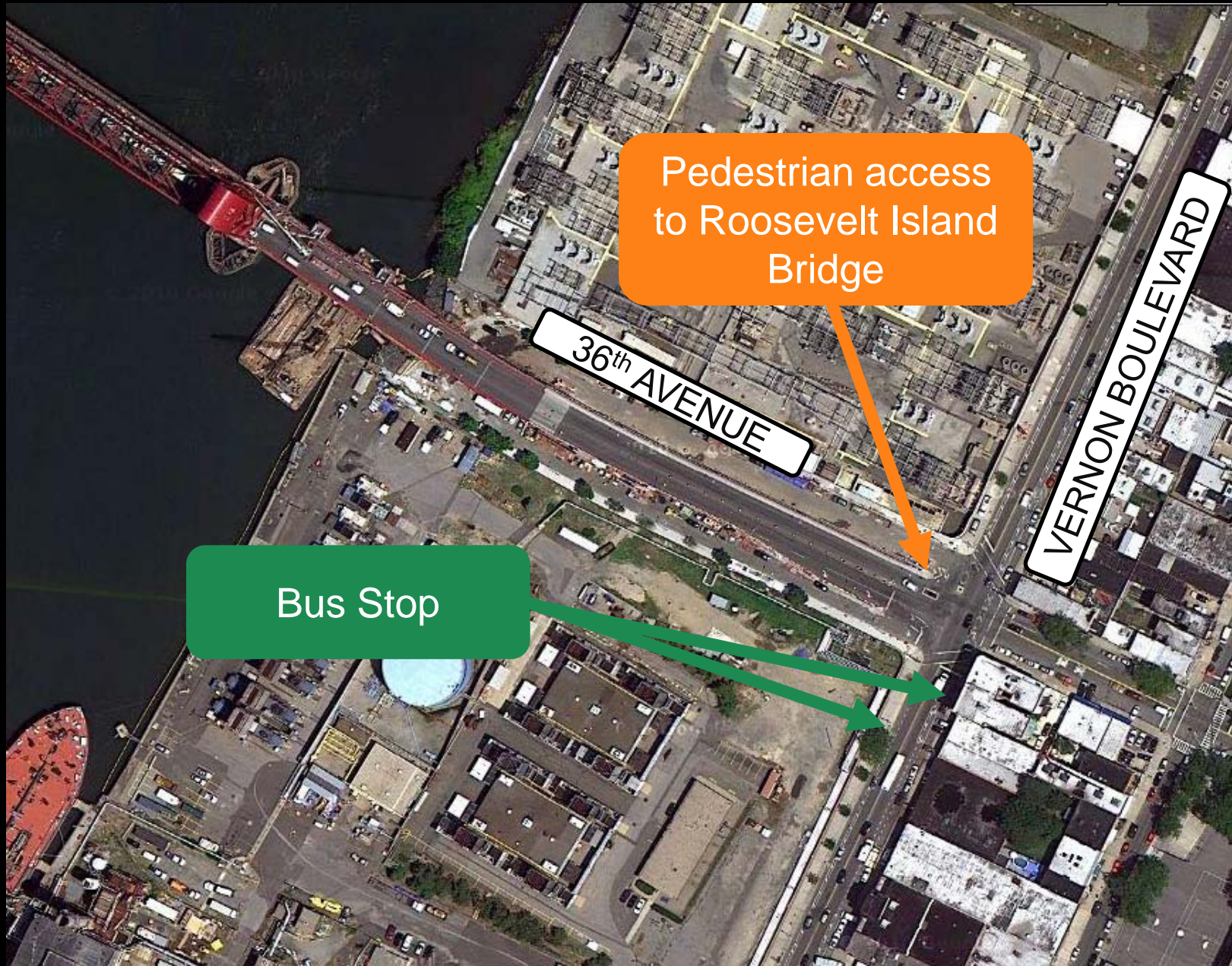

Pedestrian access  
to Roosevelt Island  
Bridge

36<sup>th</sup> AVENUE

VERNON BOULEVARD

Bus Stop

# Long crosswalks



36th AVENUE

VERNON BOULEVARD

107 feet

52 feet

# Proposal

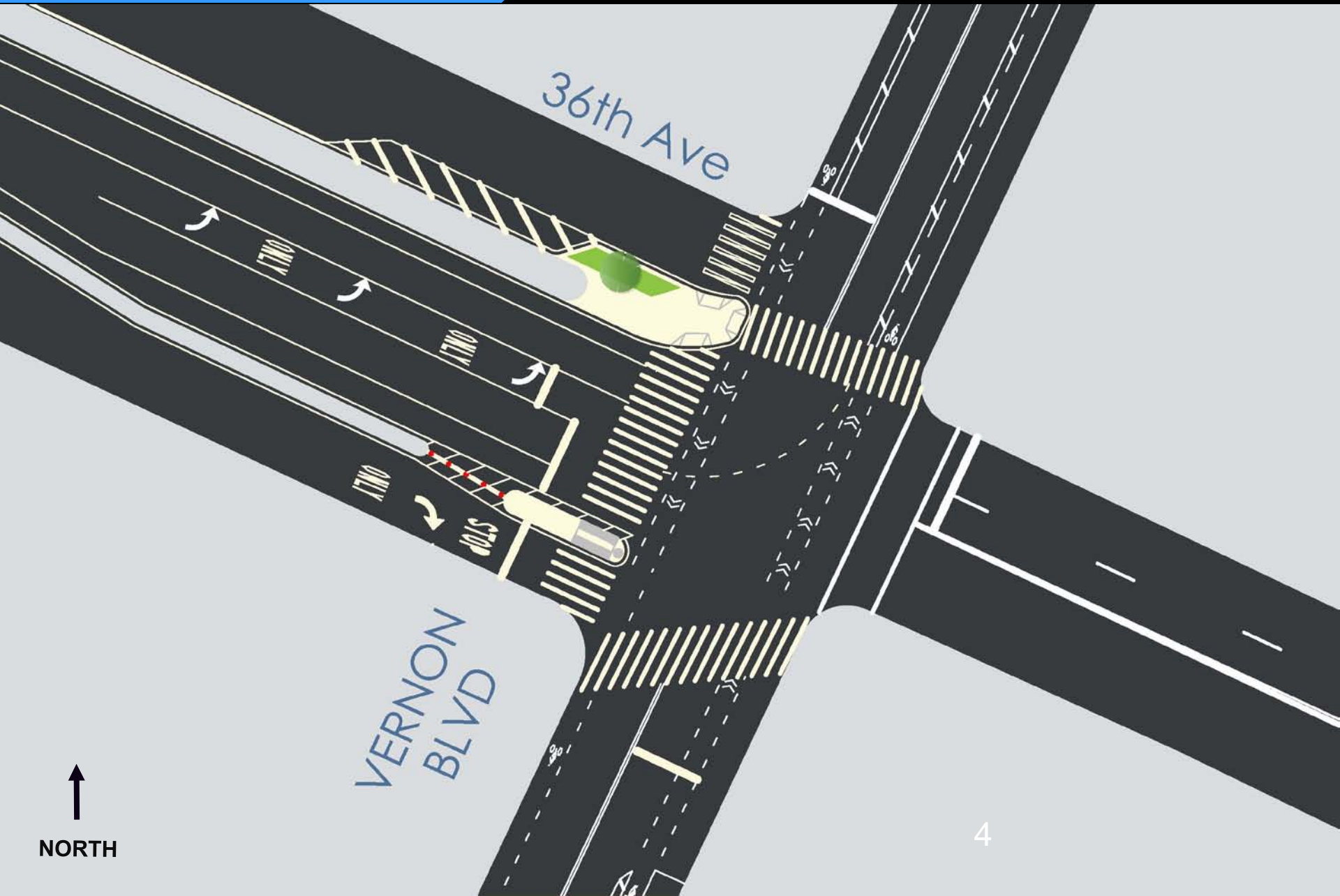

↑  
NORTH

# Improvements

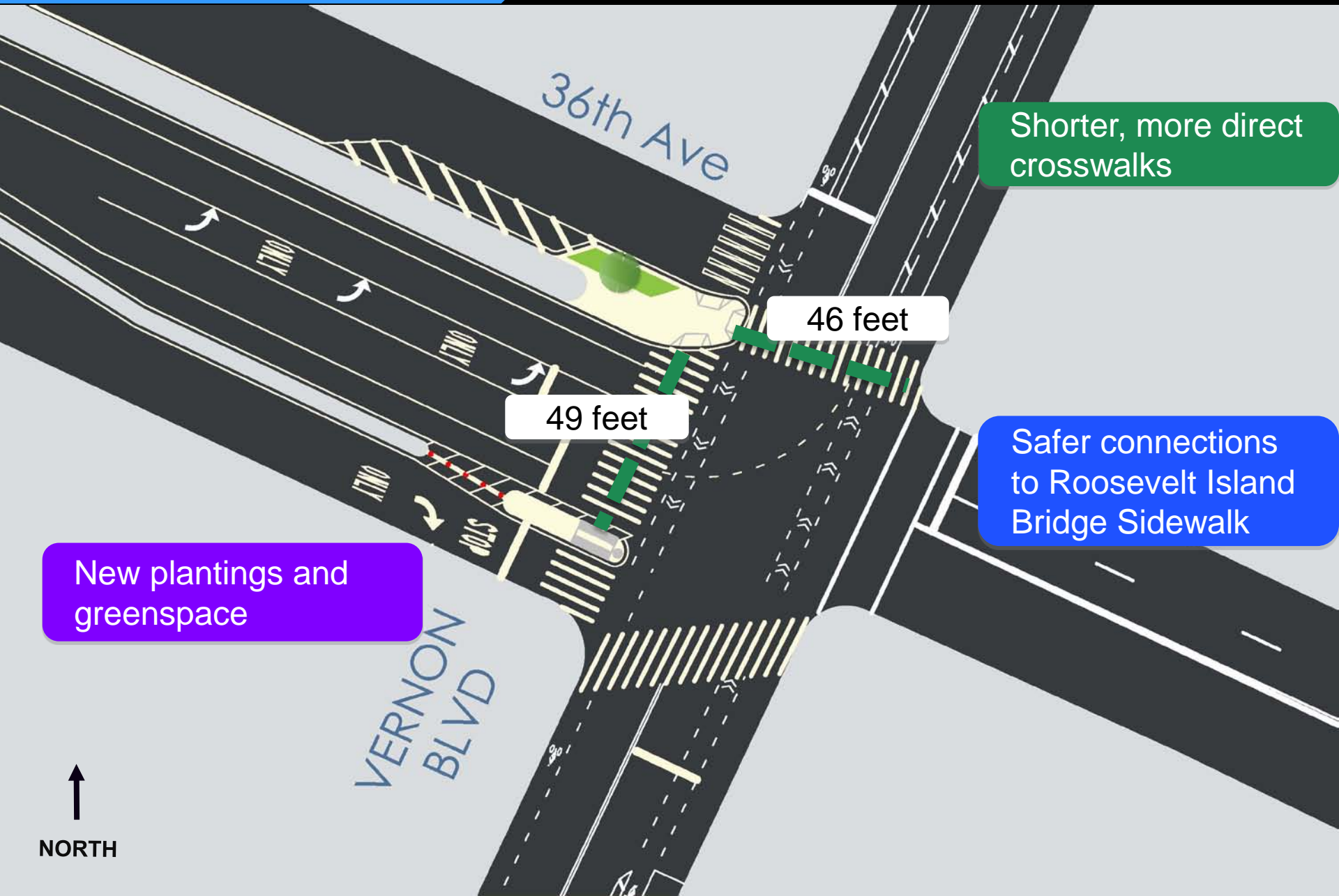

Shorter, more direct crosswalks

46 feet

49 feet

Safer connections to Roosevelt Island Bridge Sidewalk

New plantings and greenspace

↑  
NORTH

This can become...



This.



[www.nyc.gov/dot](http://www.nyc.gov/dot)

Thank  
You