

**HESTER ST**

**COMMUNITY ENGAGEMENT REPORT AND ACTION PLAN**

**FEBRUARY 2020**

# **POMONOK HOUSES**

**NYCHA CONNECTED COMMUNITIES  
PILOT PROJECT**



# ACKNOWLEDGMENTS

The engagement process would not have been possible without the support of the Pomonok Houses Resident Association, which provided space and time for the Connected Communities team to engage residents; gave valuable input and direction on the engagement approach and on residents’ priorities and concerns; and helped with outreach for events related to this project. We also appreciate the participation and passion of all the residents of Pomonok Houses.

## COMMUNITY PARTNERS

Pomonok Houses Resident Association (RA)

Pomonok Houses Resident Green Committee (RGC)

Queens Community House (QCH)

KaBOOM!

Queens Herald Church

Queens Youthbuild Program

## AGENCY PARTNERS

New York City Housing Authority (NYCHA)

The Fund For Public Housing

New York City Department of Parks and Recreation (NYC Parks)

New York Police Department (NYPD)

- Police Service Area 9 (PSA 9)

- 107<sup>th</sup> Precinct

## FUNDING

Deutsche Bank

# CONTENTS

## INTRODUCTION

- NYCHA’s Connected Communities Initiative. . . . . 4
- Pomonok Houses Pilot Project. . . . . 5
- Evaluation and Impact. . . . . 5
- Context: About Pomonok Houses. . . . . 6

## PROCESS

- Goals and Principles. . . . . 8
- Overview and Timeline . . . . . 8
- Engagement Methods. . . . . 10

## WHAT WE HEARD

- Key Themes . . . . . 12
- Key Locations . . . . . 14
- Most Popular Project Ideas . . . . . 16

## ACTION PLAN

- Immediate Implementation. . . . . 20
- Process and Design Guidelines . . . . . 29
- Recommendations for the Future . . . . . 31
- Next Steps and Action Items . . . . . 34

- APPENDIX. . . . . 36



# INTRODUCTION

The Connected Communities Initiative is NYCHA's strategy to improve physical and social connections among residents within NYCHA developments, and between the NYCHA community and surrounding neighborhoods in New York City.



## NYCHA CONNECTED COMMUNITIES INITIATIVE

Connected Communities grows out of the Authority's plan to preserve and protect public housing for current residents and future generations of New Yorkers.

NYCHA's primary goals are to provide all residents with safe, clean and connected communities. The Connected Communities Initiative supports these goals by linking NYCHA residents to resources in their neighborhoods through fostered partnerships with different organizations.

### WHY IS THE CONNECTED COMMUNITIES INITIATIVE SO IMPORTANT?

NYCHA provides housing to 1 in 15 New Yorkers. Most NYCHA developments have been planned and designed to be physically insulated from their surrounding neighborhoods. Studies show that this physical isolation contributes to the socio-economic disparities and social isolation many residents face<sup>1</sup>. Surrounding communities are likewise disconnected from the rich historical, cultural and human capital that exists in every single NYCHA campus.

Additionally, public housing has a tremendous physical asset in the existing open space on many campuses - something quite scarce in New York City. NYCHA developments collectively comprise over 2,400 acres of land in New York City or an area three times the size of Central Park. Strategic changes to the way NYCHA grounds are designed, programmed and accessed provide a tremendous opportunity to both address issues of isolation and create high-quality common spaces.

The Connected Communities Initiative commits NYCHA to holistically address these issues by working with residents to consider how the outdoor spaces in their housing developments should be enhanced, improved and designed. The goal is to create more spaces for positive interaction and collaboration and improve residents' overall quality of life.

Article References:

<sup>1</sup>Spence, Lewis "Rethinking the Social Role of Public Housing" Housing Policy Debate, Vol 4 Issue 3, 1993

To address these issues, NYCHA is collaborating with internal and external partners to:

- 1 Analyze how NYCHA overall is changing operationally and physically
- 2 Develop strategies for creating spatial connections within communal spaces and the surrounding neighborhood
- 3 Implement physical improvements to outdoor spaces
- 4 Support new or existing programs that foster relationships and connect residents to resources
- 5 Form partnerships to ensure the long-term sustainability and success of implemented projects

### POMONOK HOUSES PILOT PROJECT

As one of NYCHA's campuses that has a highly active resident organization and an engaged body of residents, Pomonok Houses was an optimal site to be one of the first pilot sites to test and implement the Connected Communities Initiative.

Through consultation with NYCHA leadership, Pomonok Houses' Resident Association, the Resident Green Committee, PSA 9 and the 107th precinct, Hester Street designed and implemented a collaborative and resident-centered engagement process that included residents at every stage, from identifying needs and priorities and selecting sites, to analyzing feasibility and creating an implementation plan.

### EVALUATION AND IMPACT

This process informed the action plan and recommendations for immediate and future implementation of the Connected Communities Initiative at Pomonok Houses in particular, and across future sites in New York City.

In preparation for this roll-out, NYCHA is concurrently created a Strategic Plan and Evaluation Framework that builds on the findings from the Pomonok Houses pilot to ensure the measurable impact of the of the Connected Communities Initiative.



# ABOUT POMONOK HOUSES

Pomonok Houses is located in Central Queens, south of Flushing, and is bordered by CUNY's Queens College to the West and the Long Island Expressway to the North. Situated in a low density auto-oriented neighborhood, Pomonok has a network of 5 bus lines that connect to train stations 30 minutes away. This two block campus has 4,292 residents, the 10th most populous out of NYCHA's 323 developments, and has a more diverse racial make up of residents than other NYCHA developments (where approximately 90% of residents are identified as Black or Latinx).

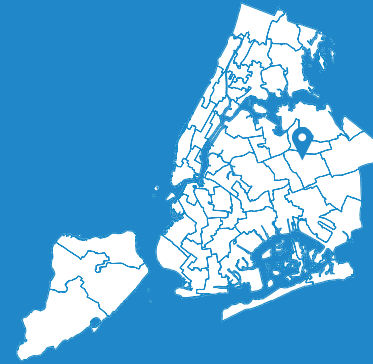

Pomonok Houses, NYCHA's second largest development by area, is unique since most of its open spaces are not gated, giving the campus a more inviting feel and providing residents the opportunity to use their open spaces more freely.

## HOUSEHOLD COMPOSITION

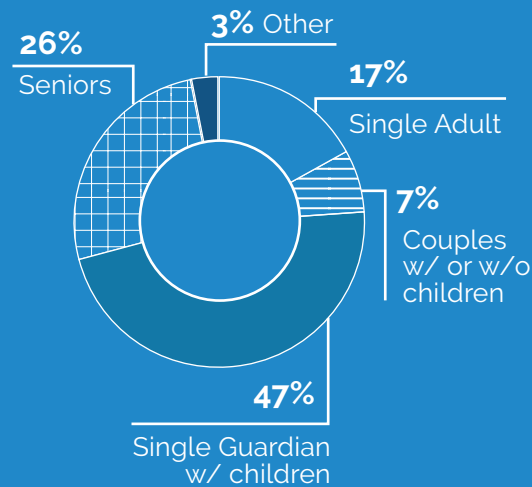

**35** Buildings  
**2,071** Apartments  
**4,292** Residents

## AGE DISTRIBUTION

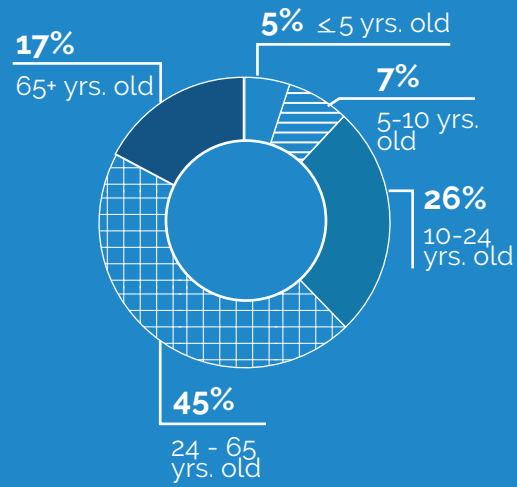

## RACE + ETHNICITY

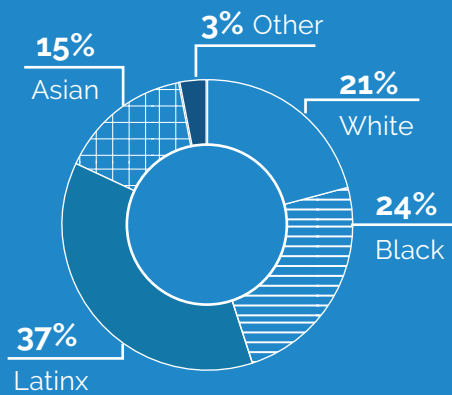

## UNEMPLOYMENT RATE

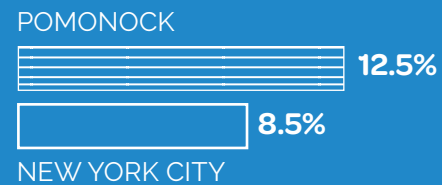

## MEDIAN HOUSEHOLD INCOME

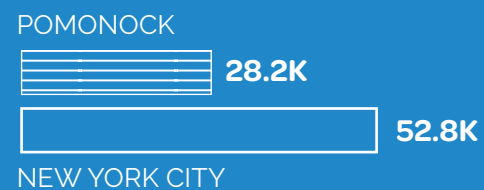

Source: NYCHA Developments Online Portal  
<https://my.nycha.info/DevPortal/Portal/DevelopmentData>





# PROCESS

To achieve the goals of creating a safer, healthier and more connected campus, the community engagement process was grounded in the knowledge and wisdom of long-term residents and community leaders.

## OVERVIEW AND TIMELINE

Hester Street structured the community engagement process in 3 phases - Engagement, Participatory Design and Implementation - to ensure that residents were meaningfully included in the identification, design and development of the potential projects to be implemented.

## ENGAGEMENT PRINCIPLES

Hester Street's community engagement strategy for engaging residents at Pomonok Houses was guided by the following principles to ensure that the process would result in clear recommendations from residents regarding project ideas and features.

### Civic Participation

Meaningfully engage the community to ensure intervention ideas address community-identified wants and needs

### Partnerships

Strengthen relationships between resident groups, community-based organizations and NYCHA leadership

### Communication

Share data, maps and plans that inform stakeholders about potential design interventions and upcoming projects

### Concrete Benefits

Ensure that resident ideas are implemented and result in actual change by grounding long-term project feasibility while also pushing for short-term changes - "quick wins" - throughout the process.

### Interactive and Innovative

Create adaptable and accessible engagement tools to share information and gather input from all residents regardless of age or background

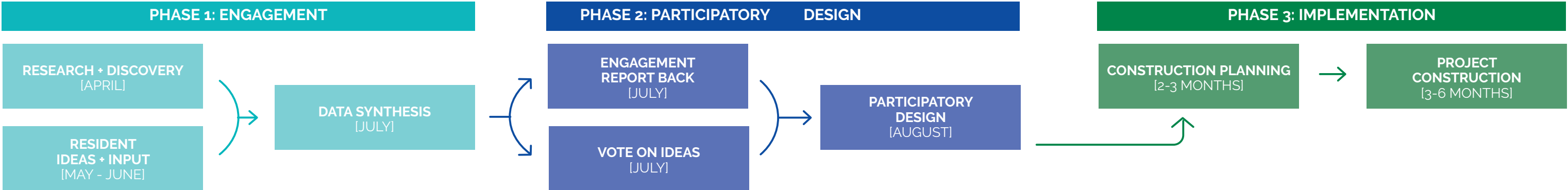

## TIMELINE

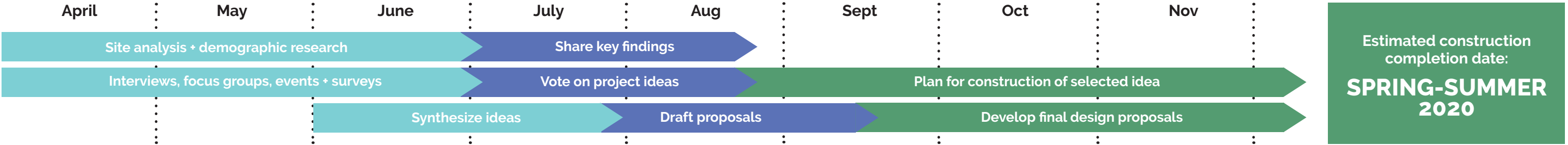



## ENGAGEMENT METHODS

From April to October, we engaged Pomonok residents and stakeholders in a variety of ways - from tabling and workshops at existing events, to interviews, surveys and the creation of a scale model of the campus. The activities were used to draw out residents' ideas, input and concerns. It began with general thoughts about Pomonok's open spaces and how they felt about their campus, what they liked, disliked and frequently encountered as residents. Based on the input, the activities began honing in on specific physical interventions, locations, and opportunities for projects. After several iterations, residents prioritized the projects they felt would address their concerns and voted to make it a reality.

**3**

### Campus Walks

Understanding the campus areas, physical conditions of its spaces and potential lighting opportunities

(3/26)

Project Team + Pomonok Resident Association

(8/13)

Campus condition walk

(9/17)

Lighting Assessment Site

**2**

### Tabling Events

Sharing project information and brief information gathering on the campus

(4/12)

Talent Show

(6/29)

Resident Green Cmte. Event

**6**

### Interviews

Understanding key players in the areas and the issues they tackle for potential partnerships

Resident Association

Community Coordinator

Queens Community House

Public School 201 Parent Teacher Association

NYPD

NYC Parks

**4**

### Resident Workshops

Hour long deep dive into Pomonok's open spaces and what residents want from their campus

(4/25)

RA General Meeting

(6/13)

Senior Focus Group

(6/19)

Resident Green Cmte Mtg.

(9/26)

RA General Meeting

**40+**

### Completed Surveys

For those who could not attend workshops, surveys were distributed to gather input

(4/30) - (7/30)

Shared online and in-person at all events

**1**

### Safety Audit Walk

Walking throughout the campus at night to identify dark and unsafe areas

(6/27)

Campus Safety Audit with Project Team, Pomonok RA, and Police Service Area 9 (PSA 9) Neighborhood Coordination Officers (NCOs)

**1**

### Restoration Day

Beautifying high foot traffic areas with a paintbrush, clippers and brooms

(8/24)

In partnership with Pomonok Resident Association

**1**

### Project Voting Day

Engaging residents in the campus's largest event to get maximum input on potential projects

(7/27)

Tabling activity at Pomonok Houses Family Day

**OVER 200 RESIDENTS ENGAGED!**



### Restoration Day

The Pomonok Resident Association organized a Restoration Day in partnership with the Connected Communities Team and Property Management to address some of the priorities that came up during engagement in this process and in previous RA meetings. RA board members, residents, the Queens Herald Church and the Resident Green Committee all helped to paint benches, remove bushes that were identified as a safety concern, and beautify playgrounds. It was a great day of hard work, sharing, and celebration!



# WHAT WE HEARD

The engagement strategy aimed to understand residents' general concerns and needs, generate ideas for projects that could address these needs, and identify key locations where these issues were most present and/or where project ideas could be implemented.

## KEY THEMES

Ideas from conversations with Pomonok residents were grouped into 10 key themes that represent their general concerns and needs regarding open space in the campus. Participants voted on which of these themes are most important to them, gave input on why they are important, and used them as a starting point to come up with project ideas that could be implemented on the campus. The 10 different themes are outlined below in the order in which they were prioritized by the community.

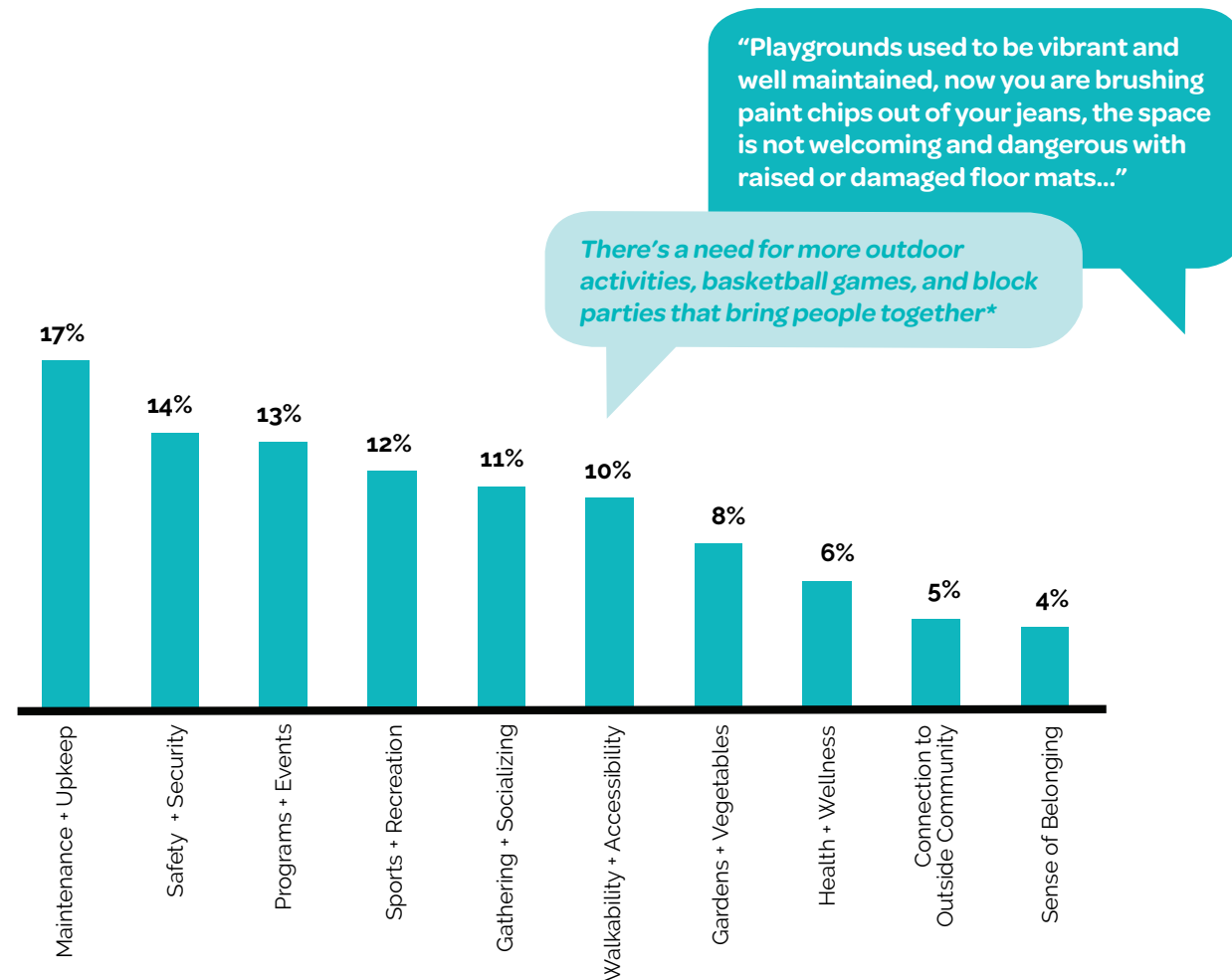

## PHYSICAL FEATURES

### Maintenance and Upkeep



The condition of benches, sidewalks, playgrounds or planted areas; the level of wear and tear of outdoor furniture and streetscapes

### Gardens and Vegetation



Planted areas within the campus - this could be community gardens, flower beds, bushes, lawns and trees

### Sports and Recreation



Areas in the neighborhood for play, sports, gathering and meeting others doing similar activities

### Walkability and Accessibility



The physical accessibility of buildings, streets and sidewalks, and public spaces in Pomonok

*“Benches are not accessible for seniors, and there is no bench that has a fresh coat of paint.”*

## PROGRAMS AND COMMUNITY

### Safety and Security



Perception of safety – including interaction with the police, local street lighting, and amount of local crime

*“Lighting! Safety! Security”*

### Health and Wellness



Environment that promotes healthy living, encouraging opportunities to play, be active, relax, and self reflect

### Programs and Events



Events that happen within the campus or community that expose residents of all ages to art, culture or other activities

### Connection to Outside Community



Connection and interactions between the NYCHA campus and the surrounding neighborhood

*Organize college tours to strengthen connection to Queens College\**

### Gathering and socializing



Areas that allow people to gather with friends and family, both formally and informally

*“We need social spaces such as, grills, lighting, and seating...”*

### Sense of Belonging



Connection to culture, history, and identity at Pomonok, and accessibility to amenities that are relevant to personal identity or culture

*\*Text in italics is paraphrased, not directly quoted.*



## KEY LOCATIONS

Throughout our engagement, residents spoke about area-specific and campus-wide challenges within Pomonok. Together they identified problems in and around the campus, along with possible solutions to address these issues.



## SAFETY AUDIT WALK

In late June, Hester Street joined NYCHA’s Resident Association, Pomonok residents and PSAg’s Neighborhood Coordination Officers in a campus walkthrough to identify areas where residents felt unsafe at night. The Circle, The Jungle and the northern portion of the campus were identified as unsafe hot spots that needed safety improvements.



The final proposed interventions built on these safety concerns to ensure that each space will be durable, low maintenance and incorporate design elements that address lighting, visibility and wayfinding.



## MOST POPULAR PROJECT IDEAS

Following the first phase of major engagement activities, participant feedback and neighborhood research was synthesized into 9 project types that addressed the key themes that emerged across the engagement process.

The final list of project types eliminated any projects that were already planned for implementation in the upcoming year(s). For example, given that the construction of an Adult Workout Area is already planned for 2020, this project was eliminated from the final list of project types.

During the Pomonok Houses Family Day, the final list of project types was shared with the community to ensure they were vetted by a diverse group of Pomonok residents.

Throughout the day, residents voted for their top 3 project ideas and shared feedback on whether the proposed projects addressed their needs. Residents also shared their thoughts on any project components they felt were missing or needed to be changed in each of the project ideas.

The voting process helped narrow the field of projects and helped prioritize the projects that were most important to the greatest number of residents engaged. The list below describes each one of the projects and specifies how they address community needs.

The top 3 ideas that are being advanced for the Action Plan are: the Splash Pad, the Basketball Upgrade and the Designated BBQ Area.

### 1. Splash Pad



100  
VOTES

#### Suggested Location: Playground near basketball court

- Convert an existing underused playground into a water splash pad area
- Restore existing equipment
- Add new sprinkler system
- Fix or add lighting around the splash pad

Promotes health and wellness	a little	●	●	●	a lot
Encourages social connections	a little	●	●	●	a lot
Improves safety	a little	●	●	○	a lot
Improves mobility and accessibility	a little	●	○	○	a lot
Ease of maintenance	hard	●	○	○	easy
Construction timeline	1 year	●	○	○	4 mths
Implementation cost		\$	\$	\$	

### 2. Creative Lighting

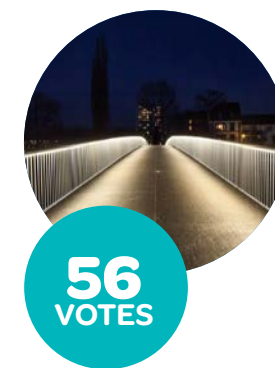

56  
VOTES

#### Suggested Locations: The Jungle, The Circle, northern boundary

- On multiple key locations, incorporate new lighting and fix existing
- Use different technologies: solar, LED light bulbs, motion sensors, etc.
- Design for a friendly ambiance: floor lighting, landscape lighting, indirect lighting, etc.

Promotes health and wellness	a little	●	●	○	a lot
Encourages social connections	a little	●	●	○	a lot
Improves safety	a little	●	●	●	a lot
Improves mobility and accessibility	a little	●	●	●	a lot
Ease of maintenance	hard	●	○	○	easy
Construction timeline	1 year	●	○	○	4 mths
Implementation cost		\$	\$	\$	

### 3. Maintenance And Upkeep Structures



55  
VOTES

#### Suggested location: Everywhere!

- Throughout the campus install elements that allow and encourage cleaning and upkeep
- Add more and larger trashcans
- Add recycling bins and doggie stations
- Improve existing compost bins
- Add signage that encourages people to clean up

Promotes health and wellness	a little	●	●	●	a lot
Encourages social connections	a little	●	○	○	a lot
Improves safety	a little	●	●	○	a lot
Improves mobility and accessibility	a little	●	○	○	a lot
Ease of maintenance	hard	●	●	●	easy
Construction timeline	1 year	●	●	●	4 mths
Implementation cost		\$	\$	\$	

### 4. Basketball Court Upgrade



53  
VOTES

#### Location: Basketball court

- Restore pavement and add/replace/restore basketball hoops
- Incorporate simple seating for spectators and other gatherings
- Fix or add surrounding lighting
- Beautify the surrounding area through painting and gardening

Promotes health and wellness	a little	●	●	●	a lot
Encourages social connections	a little	●	●	●	a lot
Improves safety	a little	●	●	○	a lot
Improves mobility and accessibility	a little	●	○	○	a lot
Ease of maintenance	hard	●	●	○	easy
Construction timeline	1 year	●	○	○	4 mths
Implementation cost		\$	\$	\$	

### 5. Designated BBQ Area



44  
VOTES

#### Suggested Location: Flagpole

- Create a designated barbecue area with new BBQ pits
- Restore or add benches and tables around the area
- Build a small shaded structure
- Fix or add lighting around the area
- Beautify the surrounding area through painting and gardening

Promotes health and wellness	a little	●	○	○	a lot
Encourages social connections	a little	●	●	●	a lot
Improves safety	a little	●	○	○	a lot
Improves mobility and accessibility	a little	●	○	○	a lot
Ease of maintenance	hard	●	●	○	easy
Construction timeline	1 year	●	●	●	4 mths
Implementation cost		\$	\$	\$	

### 6. Enhanced Seating Areas



40  
VOTES

#### Suggested Locations: TBD

- On multiple key locations throughout the campus, restore and replace benches
- Incorporate new/different type of seating
- Fix or add lighting around the seating areas
- Beautify the surrounding areas through painting and gardening

Promotes health and wellness	a little	●	●	○	a lot
Encourages social connections	a little	●	●	●	a lot
Improves safety	a little	●	●	○	a lot
Improves mobility and accessibility	a little	●	●	●	a lot
Ease of maintenance	hard	●	●	○	easy
Construction timeline	1 year	●	●	●	4 mths
Implementation cost		\$	\$	\$	



## 7. Workout Trail



40  
VOTES

### Suggested Location: The Jungle

- Build a paved ADA accessible trail specifically designated for workout
- Fix or add lighting around the trail
- Beautify the surrounding area through painting and gardening
- Improve safety through trimming/removing bushes and ensuring visibility

Promotes health and wellness	a little	●	●	●	a lot
Encourages social connections	a little	●	●	○	a lot
Improves safety	a little	●	●	●	a lot
Improves mobility and accessibility	a little	●	●	●	a lot
Ease of maintenance	hard	●	●	○	easy
Construction timeline	1 year	●	●	○	4 mths
Implementation cost		\$	\$	\$	

## 8. Upgraded Playground



36  
VOTES

### Suggested location: TBD

- Restore one existing playground
- Paint and fix existing equipment
- Restore/replace paving
- Adding swing set, sand box and/or other simple equipment

Promotes health and wellness	a little	●	●	●	a lot
Encourages social connections	a little	●	●	●	a lot
Improves safety	a little	●	●	○	a lot
Improves mobility and accessibility	a little	●	●	○	a lot
Ease of maintenance	hard	●	●	○	easy
Construction timeline	1 year	●	●	●	4 mths
Implementation cost		\$	\$	\$	

## 9. Mini Skate Park



29  
VOTES

### Suggested Location: Playground east of Community Center

- Build small skate ramps and install skate park equipment in an underused area
- Restore paving
- Fix or add lighting around the skate park
- Beautify the surrounding area through painting and gardening

Promotes health and wellness	a little	●	●	●	a lot
Encourages social connections	a little	●	●	●	a lot
Improves safety	a little	●	○	○	a lot
Improves mobility and accessibility	a little	●	○	○	a lot
Ease of maintenance	hard	●	○	○	easy
Construction timeline	1 year	●	○	○	4 mths
Implementation cost		\$	\$	\$	









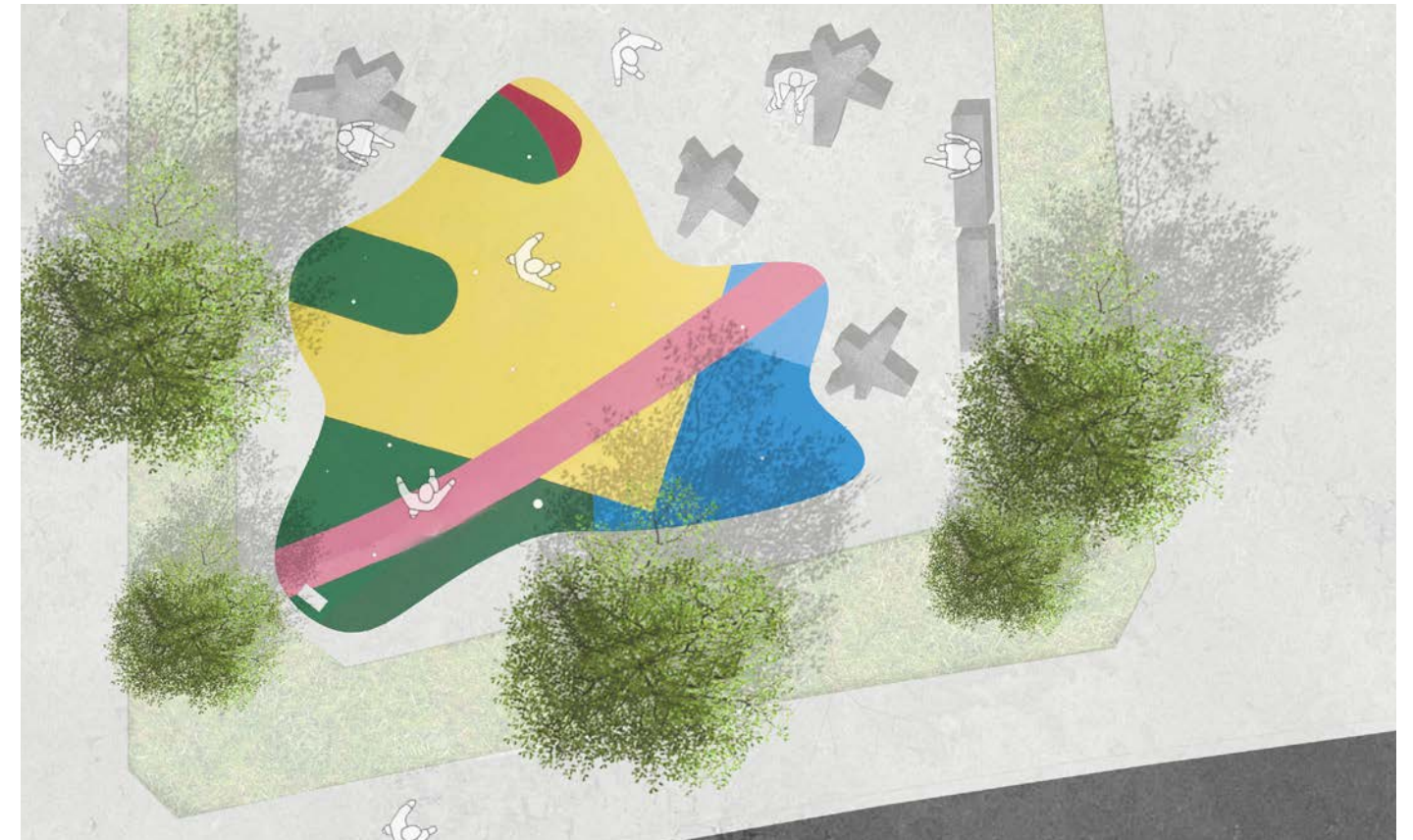
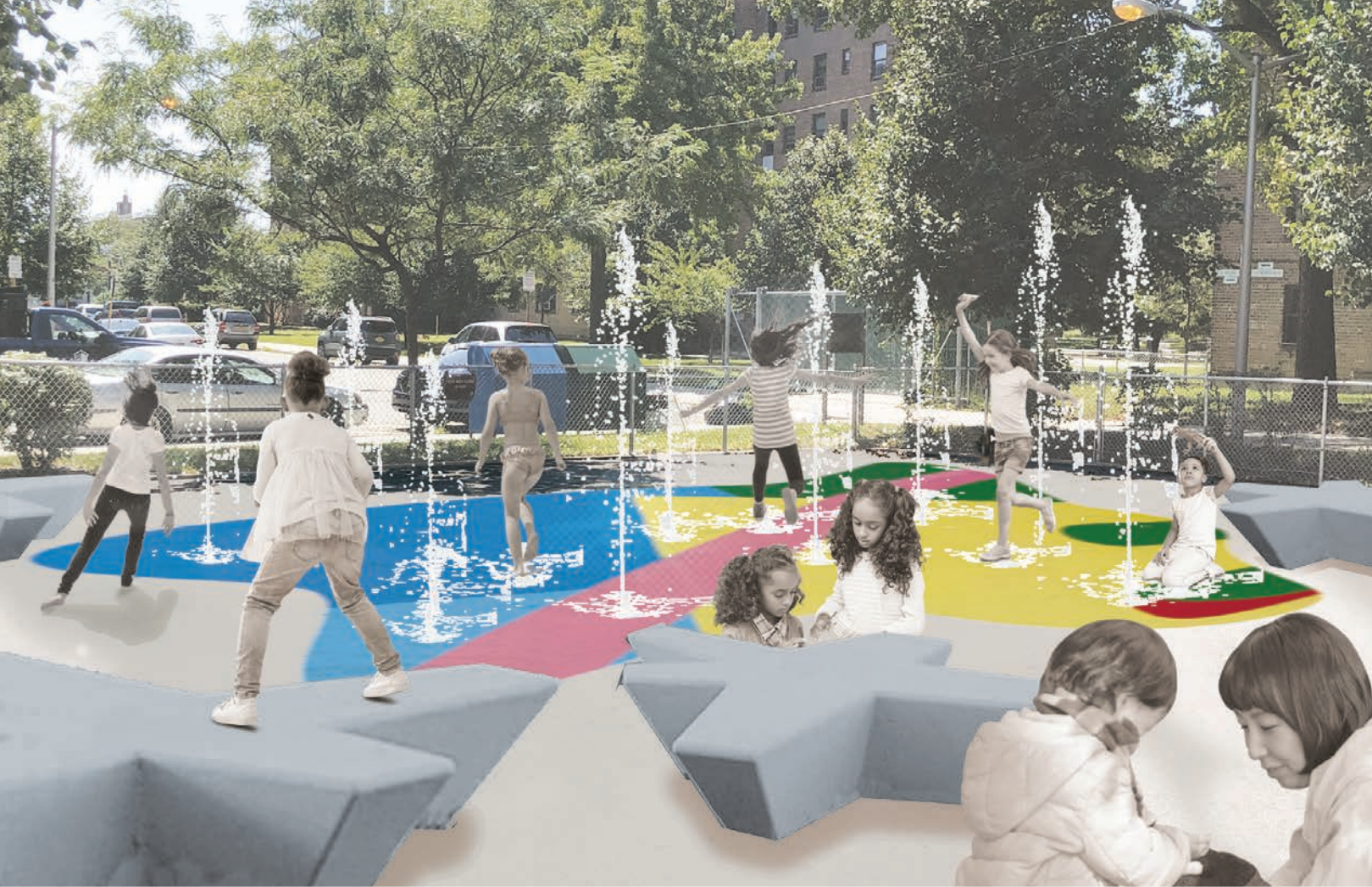

## SPLASH PAD

### Key Features:

- Interactive water sprinkler system
- Non-slip color coating
- New seating
- Creative lighting fixtures
- Signage
- Trash and recycling bins

### FURTHER RESIDENT INPUT AND ENGAGEMENT

- Seating options and placement
- Non-slip coating colors and design
- Type of sprinklers
- Lighting design
- Participation in assembling furniture

### Top Community Needs Addressed:

- **Sports and Recreation:** the project rehabilitates one of the many play areas in Pomonok that are currently in poor condition, creating a new safe space for kids to play.
- **Gathering and Socializing:** located at the heart of the campus, the newly renovated splash pad will provide accessible seating and be a main gathering area for kids to play.
- **Safety and Security:** new light fixtures will allow for this space to remain active at different times of the day and help improve the sense of safety among residents.
- **Maintenance and Upkeep:** durable and low-maintenance furniture and new trash and recycling bins will ensure longevity and encourage upkeep.

*Images represent schematic visualizations. Design will be refined in the participatory design phase to incorporate resident input and adjust to budgetary needs.*



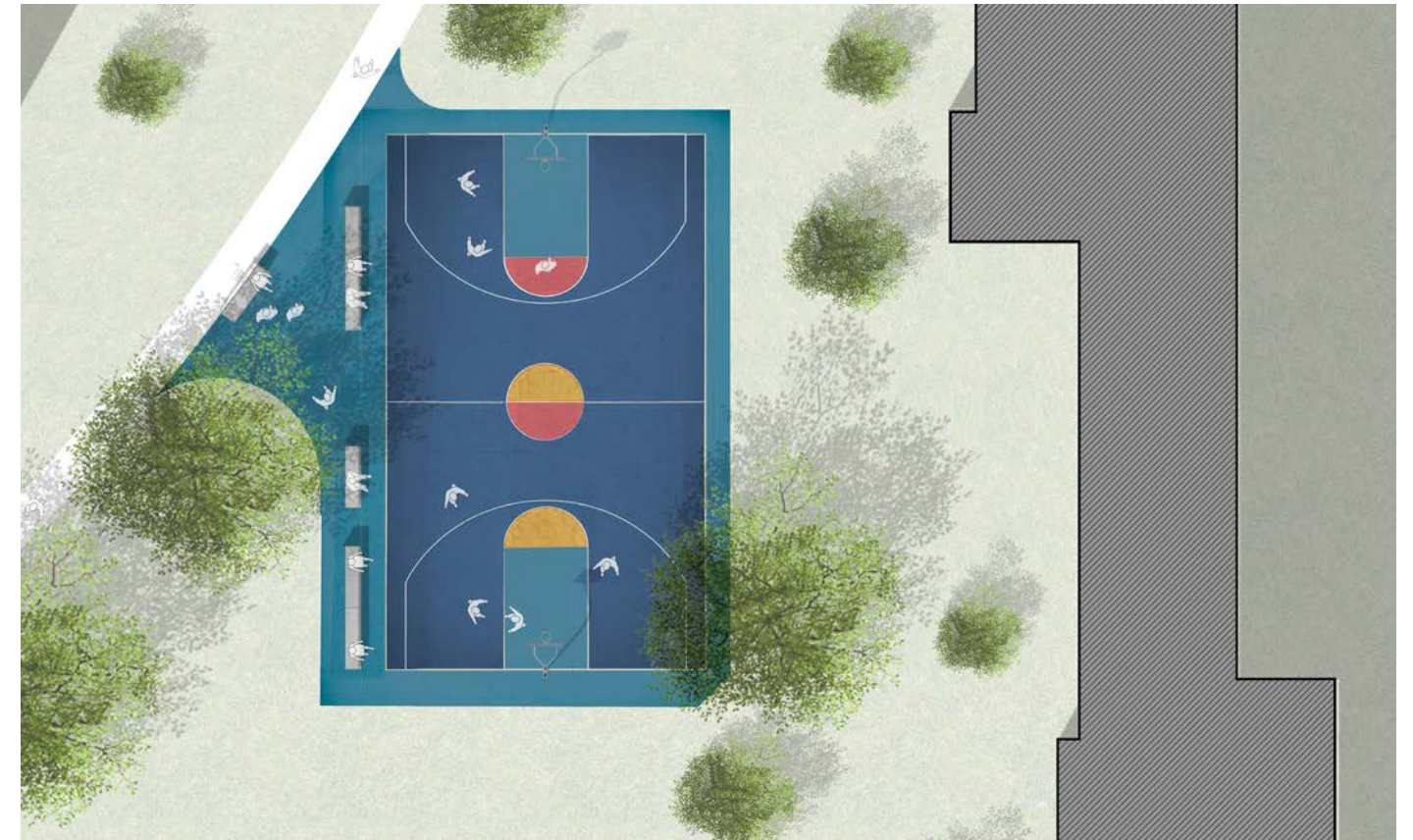

## BASKETBALL COURT

### Key Features:

- Demolition and repaving of existing court
- Colored athletic coating
- New basketball hoops
- Sports lighting
- New seating
- Signage
- Trash and recycling bins

### FURTHER RESIDENT INPUT AND ENGAGEMENT

- Seating options and placement
- Athletic surfacing colors and design
- Incorporating other sports
- Lighting design
- Participation in installing furniture and hoops

### Top Community Needs Addressed:

- **Sports and Recreation:** the project rehabilitates what was once a much used basketball court that over the years has fallen into disrepair.
- **Health and Wellness:** the newly renovated basketball court will encourage residents to come together and remain active.
- **Programs and Events:** the space will provide the opportunity for residents, management staff, the Resident Association and others to organize sports tournaments and activities.
- **Safety and Security:** safety will improve with new lighting fixtures in an area that is currently poorly lit.
- **Maintenance and Upkeep:** new furniture will be durable and low-maintenance. Additionally, signage and new trash and recycling bins will encourage upkeep.

*Images represent schematic visualizations. Design will be refined in the participatory design phase to incorporate resident input and adjust to budgetary needs.*





## BBQ AREA

### Key Features:

- Paving repairs and floor mural
- New BBQ grills
- New seating, tables and shading
- Creative lighting fixtures
- Landscape and gardening improvements
- Signage
- Trash and recycling bins

### FURTHER RESIDENT INPUT AND ENGAGEMENT

- Furniture options, placement and installation
- Floor mural design and painting
- Incorporating other sports
- Lighting design
- Landscape design and planting

### Top Community Needs Addressed:

- **Gathering and Socializing:** the designated BBQ area with various seating options will allow neighbors and families to come together for celebrations or family gatherings.
- **Programs and Events:** the space will provide the opportunity for organized events.
- **Sense of Belonging:** Resident participation in design, painting and landscaping will ensure that the space feels welcoming and responds to resident culture.
- **Safety and Security:** increased foot traffic and new lighting fixtures will allow more people to look out for each others' safety.
- **Maintenance and Upkeep:** new furniture will be durable and low-maintenance. Additionally, signage and new trash and recycling bins will encourage upkeep.

*Images represent schematic visualizations. Design will be refined in the participatory design phase to incorporate resident input and adjust to budgetary needs.*



## PROCESS AND DESIGN GUIDELINES

The following process and design guidelines were developed for the 3 selected projects, but are applicable for all future outdoor projects at the Pomonok Houses and other NYCHA developments. They synthesize feedback receive from hundreds of residents, as well as research, observations and analysis of the conditions at Pomonok Houses and other NYCHA campuses.

### COMMUNITY PARTICIPATION

Shape the process and develop the design by engaging residents, making sure to:

- Involve residents / partner with community in the design, build, implementation and upkeep
- Understand what their needs, desires, concerns and priorities are so the project can respond to them thoughtfully
- Get meaningful feedback and input on elements such as:
  - Type of project, use and programing
  - Location of the project
  - Look and appearance of furniture and finishes
  - Type of equipment and ways it will be used
- Ask for feedback on elements that are actionable and within project scope and budget
- Talk to different populations/demographics
- Go to where people are! Participate in existing events; using resident channels of communication to reach a larger pool of people and avoid engagement fatigue
- Always report findings back to residents and talk about next steps

### SITE ANALYSIS

For determining use and developing design, the process should:

- Understand how the space is currently used and build on what is already there, improving existing activities, programs and dynamics, not erasing them
- Acknowledge and honor history and collective memory associated with the space
- Survey surrounding context to fill in geographic and programmatic gaps ensuring equitable distribution of outdoor interventions, programs and amenities
- Be mindful of surrounding nature and incorporate thoughtful landscape improvements that respond sustainably to the ecosystem
- Consider each intervention as an improvement to the area, seamlessly integrating to its immediate surroundings
- Understand how the space functions at different hour of the day and during different times of the year
- Appreciate both planned/programmed and unplanned/informal activities
- Consider safety concerns/perceived safety of site

and surrounding landscape

- Identify/create visual and physical connections between site and surrounding neighborhood
- Identify public vs private areas
- Consider site access points/entryways

### USE AND PERCEPTION

Built project should:

- Be accessible for all - ages, races, physical / mental abilities, etc
- Be inclusive of different identities, groups and personalities
- Be inclusive of residents/non-residents and pets
- Foster sense of ownership and pride
- Reflect resident and neighborhood culture not NYCHA's institutional image
- Foster healthy living (mind and body) through:
  - Physical activity and exercise for all ages and abilities
  - Social interactions for small and large groups
  - Individual reflection
- Catalyze community building by enabling and encouraging:
  - Intergenerational + group specific interactions
  - People to come together in a safe space
  - Group activities, events and programing
- Be flexible so it can be used by different people, performing different activities at different times of day and different seasons
- Be welcoming, playful and colorful!

### PRACTICALITIES

Built project should:

- Be safe to use for all and incorporate safety and security design strategies to improve overall safety in the area
- Include durable, low maintenance furniture that can be easily replaced or repaired if broken
- Incorporate lighting considerations that promote safety and enable use at multiple hours
- Include maintenance and upkeep structures such as trash and recycle bins and visible instructions of how to care for the space
- Include signage and way-finding
- Use sustainability and resiliency design strategies such as features that efficiently and sustainably use water, power, etc.







# RECOMMENDATIONS FOR THE FUTURE

The following recommendations - generated through community input - are intended to inform the implementation of projects that are not currently funded. They are intended to serve as a reference and advocacy document for residents, community partners and NYCHA.



### Maintenance and Upkeep

- Add pest proof trashcans throughout campus, specifically in BBQ areas, playgrounds and sitting areas
- Add "Do not litter signs" and general rules about upkeep throughout campus
- Incorporate campus wide doggy bag stations and signage to pick up after their pets



### Safety and Security

- Focus safety and security measure in community identified "safety hot-spots": The Jungle, The Circle, North Boundary (see map on pg. 14)
- Increase lighting on main pathways, in areas where people gather (play spaces, sitting areas, spaces with limited visibility), and in community identified "unsafe hot-spots"
- Remove bushes + foliage in resident identified "unsafe hot-spots" for more visibility
- Increase police presence



### Programs and Events

- Create more programs to establish Queens Community House as a community hub (Block parties, Tai-Chi, dance lessons, farmers market, gardening)
- Increase advertising for events at the community center to get better turn-out or take them outdoors for increased visibility
- Increase curb appeal to attract residents inside the Community Center



### Sports and Recreation

- Repair + update existing play equipment and add more diverse types of equipment (Outdoor track, swing set, splash pad, tables tennis, adult exercise machines etc.)
- Include designated adult playground area for seniors and adults to exercise
- Include shaded and seating areas near playgrounds for adults to gather while kids are playing



### Gathering and Socializing

- Repair and repaint existing benches or replace for more durable, low maintenance furniture
- Prioritize areas where senior gather, ensuring benches and tables are accessible and meet proper sitting height
- Rearrange seating layouts to encourage conversation and social gatherings





### Walkability and Accessibility

- Make walkways and ramps accessible to those who can't take the stairs
- Add crosswalks on internal roads and on Jewel Av. for pedestrian safety
- Repair pathways to make accessible for seniors and wheelchairs



### Gardens and Vegetation

- Add flowers + herbs to beautify space and deter pests
- Create rules for garden upkeep
- Repair and upkeep Resident Green Committee compost bins



### Health and Wellness

- Encourage sports and workout through play and athletic equipment and community tournaments and activities
- Partner with Thrive NYC to implement Mental Health strategies in the campus
- Encourage healthy eating through, educational campaigns, farmers markets and support for community gardens and the Resident Green Committee



### Connection to Outside Community

- Allocate designated space for visitor parking
- Include maps and way-finding around campus for pedestrians and cars
- Partner with Queens College to start educational tours, programing and events
- (career workshops, dance classes, young adult programs)
- Partner with Queens Library to establish a book drop off/pick up area for residents to find new reads



### Sense of Belonging

- Brighten the space with more color and improved creative lighting strategies
- Increase campus upkeep and engage residents in volunteer brigades to build community responsibility, sense of belonging and Pomonok pride
- Host more community building events (Sports tournaments, outside performances and field trips)





## NEXT STEPS AND ACTION ITEMS

The following are recommended immediate next steps for moving the project forward towards a successful implementation.

- 1 Hire contractors, subcontractors and all other necessary consultants
- 2 Close-out engagement phase and kick-off implementation phase with residents by reporting back engagement findings, introducing them to the implementation team (design team, contractors, etc.) and sharing a preliminary construction timeline and scope
- 3 Building on the design concepts and resident priorities outlined in the engagement phase, work with contractors to develop designs that meet budgetary, technical and regulatory requirements
- 4 Identify elements in the design where residents could be engaged (see pg. 22 – 27):
  - Elements for resident input such as furniture selection, furniture location, colors, finishes, etc.
  - Elements that could be implemented by volunteers in a community build day such as gardens and landscaping, murals, painting, furniture assembly and installation, etc.
- 5 Present an update to residents to gather feedback on design elements mentioned above and gauge interest in volunteer community build days
- 6 Finalize drawings incorporating resident feedback and plan for volunteer community build days
- 7 Process permits necessary to begin construction
- 8 Present final design and construction timeline to residents
- 9 Begin construction
- 10 Program opening activities to activate the spaces, i.e. community potluck, basketball tournament, etc.
- 11 Monitor use of space and gather community feedback to evaluate project process and outcomes
- 12 Continue to advocate for built projects and programs identified by residents through this process

Pomonok residents provided tangible and meaningful input to ensure that future improvements to the Pomonok Campus are durable, usable and informed by community needs. The process, lessons learned and guidelines provide a Roadmap for Implementation at Pomonok, as well as a blueprint for furthering community driven decision making in other NYCHA developments and beyond.





# BASKETBALL COURT UPGRADE

- Restore pavement and add/replace/restore basketball hoops
- Incorporate simple seating for spectators and other gatherings
- Fix or add surrounding lighting
- Beautify the surrounding area through painting and gardening

**Location:**  
basketball court



# APPENDIX

## PROJECT SHEETS

Project ideas posters presented at Family Day for voting

## DATA SHEET

Spreadsheet containing all feedback received during engagement process

## SURVEYS

Surveys used for gathering input

## ENGAGEMENT BOARDS

Engagement boards used for gathering input and reporting back on findings

Promotes health and wellness	a little	<input checked="" type="radio"/>	<input type="radio"/>	<input type="radio"/>	a lot
Encourages social connections	a little	<input checked="" type="radio"/>	<input type="radio"/>	<input type="radio"/>	a lot
Improves safety	a little	<input checked="" type="radio"/>	<input type="radio"/>	<input type="radio"/>	a lot
Improves mobility and accessibility	a little	<input checked="" type="radio"/>	<input type="radio"/>	<input type="radio"/>	a lot
Ease of maintenance	hard	<input checked="" type="radio"/>	<input type="radio"/>	<input type="radio"/>	easy
Construction timeline	1 year	<input checked="" type="radio"/>	<input type="radio"/>	<input type="radio"/>	4 mths
Implementation cost		<input checked="" type="radio"/>	<input type="radio"/>	<input type="radio"/>	



# WORKOUT TRAIL

- Build a paved ADA accessible trail specifically designated for workout
- Improve safety through trimming/removing bushes and ensuring visibility
- Fix or add lighting around the trail
- Beautify the surrounding area through painting and gardening

**Suggested Location:**  
The Jungle



Promotes health and wellness	a little	●	●	●	a lot
Encourages social connections	a little	●	●	○	a lot
Improves safety	a little	●	●	●	a lot
Improves mobility and accessibility	a little	●	●	●	a lot
Ease of maintenance	hard	●	●	○	easy
Construction timeline	1 year	●	●	○	4 mths
Implementation cost		\$	\$	\$	

# MINI SKATE PARK

- Build small skate ramps and install skate park equipment in an underused area
- Restore paving
- Fix or add lighting around the skate park
- Beautify the surrounding area through painting and gardening

**Suggested Location:**  
Playground east of Community Center



Promotes health and wellness	a little	●	●	●	a lot
Encourages social connections	a little	●	●	●	a lot
Improves safety	a little	●	○	○	a lot
Improves mobility and accessibility	a little	●	○	○	a lot
Ease of maintenance	hard	●	○	○	easy
Construction timeline	1 year	●	○	○	4 mths
Implementation cost		\$	\$	\$	



# SPLASH PAD

- Convert an existing underused playground into a water splash pad area
- Restore existing equipment
- Add new sprinkler system
- Fix or add lighting around the splash pad

**Suggested Location:**  
Playground near basketball court



Promotes health and wellness	a little	●	●	●	a lot
Encourages social connections	a little	●	●	●	a lot
Improves safety	a little	●	●	○	a lot
Improves mobility and accessibility	a little	●	○	○	a lot
Ease of maintenance	hard	●	○	○	easy
Construction timeline	1 year	●	○	○	4 mths
Implementation cost		\$	\$	\$	

# CREATIVE LIGHTING

- On multiple key locations, incorporate new lighting and fix existing
- Use different technologies: solar, LED light bulbs, motion sensors, etc.
- Design for a friendly ambiance: floor lighting, landscape lighting, indirect lighting, etc.

**Suggested Location:**  
The Jungle, The Circle, northern boundary

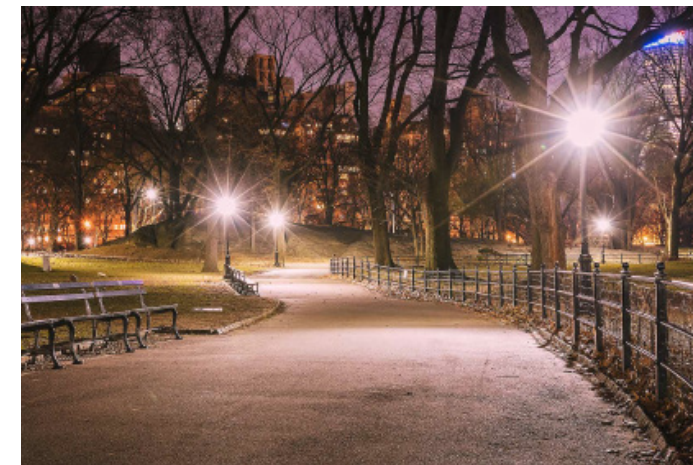

Promotes health and wellness	a little	●	●	○	a lot
Encourages social connections	a little	●	●	○	a lot
Improves safety	a little	●	●	●	a lot
Improves mobility and accessibility	a little	●	●	●	a lot
Ease of maintenance	hard	●	●	○	easy
Construction timeline	1 year	●	●	○	4 mths
Implementation cost		\$	\$	\$	



# ENHANCED SEATING AREAS

- On multiple key locations throughout the campus, restore and replace benches
- Incorporate new/different type of seating
- Fix or add lighting around the seating areas
- Beautify the surrounding areas through painting and gardening

**Suggested Location:**  
TBD



Promotes health and wellness	a little	●	●	○	a lot
Encourages social connections	a little	●	●	●	a lot
Improves safety	a little	●	●	○	a lot
Improves mobility and accessibility	a little	●	●	●	a lot
Ease of maintenance	hard	●	●	○	easy
Construction timeline	1 year	●	●	●	4 mths
Implementation cost		\$	\$	\$	

# DESIGNATED BBQ AREA

- Create a designated barbecue area with new BBQ pits
- Restore or add benches and tables around the area
- Build a small shaded structure
- Fix or add lighting around the area
- Beautify the surrounding area through painting and gardening

**Suggested Location:**  
Flagpole



Promotes health and wellness	a little	●	○	○	a lot
Encourages social connections	a little	●	●	●	a lot
Improves safety	a little	●	○	○	a lot
Improves mobility and accessibility	a little	●	○	○	a lot
Ease of maintenance	hard	●	●	○	easy
Implementation timeline	1 year	●	●	●	4 mths
Implementation cost		\$	\$	\$	



# UPGRADED PLAYGROUND

- Restore one existing playground
- Paint and fix existing equipment
- Restore/replace paving
- Adding swing set, sand box and/or other simple equipment

**Suggested Location:**  
TBD



Promotes health and wellness	a little	<input checked="" type="radio"/>	<input type="radio"/>	<input type="radio"/>	a lot
Encourages social connections	a little	<input checked="" type="radio"/>	<input type="radio"/>	<input type="radio"/>	a lot
Improves safety	a little	<input checked="" type="radio"/>	<input type="radio"/>	<input type="radio"/>	a lot
Improves mobility and accessibility	a little	<input checked="" type="radio"/>	<input type="radio"/>	<input type="radio"/>	a lot
Ease of maintenance	hard	<input checked="" type="radio"/>	<input type="radio"/>	<input type="radio"/>	easy
Construction timeline	1 year	<input checked="" type="radio"/>	<input type="radio"/>	<input type="radio"/>	4 mths
Implementation cost		\$	\$	\$	

# CLEANING + UPKEEP STRUCTURES

- Install elements that allow and encourage cleaning and upkeep
- Add more and larger trashcans
- Add recycling bins and doggie stations
- Improve existing compost bins
- Add signage that encourages people to clean up

**Location:**  
Everywhere!

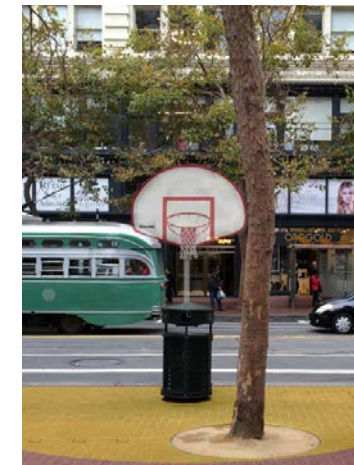

Promotes health and wellness	a little	<input type="radio"/>	<input type="radio"/>	<input checked="" type="radio"/>	a lot
Encourages social connections	a little	<input type="radio"/>	<input type="radio"/>	<input type="radio"/>	a lot
Improves safety	a little	<input type="radio"/>	<input checked="" type="radio"/>	<input type="radio"/>	a lot
Improves mobility and accessibility	a little	<input type="radio"/>	<input type="radio"/>	<input type="radio"/>	a lot
Ease of maintenance	hard	<input checked="" type="radio"/>	<input type="radio"/>	<input type="radio"/>	easy
Construction timeline	1 year	<input checked="" type="radio"/>	<input type="radio"/>	<input type="radio"/>	4 mths
Implementation cost		\$	\$	\$	











DATA SHEET

"I have to clean my building, the tiles are loose and unsafe"	General Upkeep			
We have compactors inside the buildings, near exits, yet people toss their trash outside	General upkeep			
Electchester has a real community, they are better maintained and people respect the spaces	General upkeep			
People do not care about the space, they throw trash inside, outside. I often clean the hallway when people are visiting.	General Upkeep			
"I sweep the building whenever my family comes over because I'm embarassed"	Interior			
"I dont go outside, the grounds are nasty. You need to take care of tenants"	N/A			
Fix park and playground	Park/Playground			
When the Kaboom Park open, it was very nice, howver, people pulled out the protective strips and it was never repaired.	Playgrounds			
The new park we have cost money, yet residents are now using it as dumping ground	Playgrounds/Parks + Upkeep			
Playgrounds use to be vibrant and well maintained, now you are bushing paint chips out of your jeans, the space is not welcoming and dangerous (raised or damaged floor mats), restore or upgrade	Playgrounds/Parks + Upkeep			
"We need better recycling for compactors"	Recycling			
Cracked concrete, only 2 benches have been repaired/painted since my time here ( been there for 40+yrs )	Sitting Areas, Sidewalk improvements			
Repair ground, and fencing, unsure if there is a sprinkler there but it would be good to make it into a splash pool.	Splash pad + Fencing removal + General Upkeep			
Trashcans everywhere	Trashcans			
Fix basketball court	Basketball			
Repair Basketball Court, although people use to play there until 2AM or so which disturbed some neighbors	Basketball			
	Quiet Space			
"Skate park and basketbvall go hand-in-hand"	Skate Park			
"The access to transport is convenient--you can wal outside to take the bus"	N/A		1	
Directions. Maps at every entry. People never know where to go.	Signage	1	1	
Hard to get to top of hill in a wheelchair. Very steep!	Accesible paths			
"There is no space that is welcoming, I feel sorry for seniors sitting on benches waiting for access-a-ride."	Accessible Seating for Seniors			
	BBQ			
"A lot of people BBQ there now"	BBQ			
	BBQ			
"if your having a party, people ask too many questions"	Clear Rules/Guidlines for using spaces	1		
Dog park for people with pets	Dog Park			
There is no flag here i think, consider reorienting benches once fixed	General upkeep + Seating			
Underutilized Playground	N/A			
Local Union 3, International Brotherhood of Electrical workers, mentioned they bring in money to the neighborhood? (CM)	N/A			
"I dont go into the back of other buildings"	N/A			
Issues with smoke	N/A			
I've lived here 52 years, and its the same set up, nothing has changed	N/A			

DATA SHEET

					1				04/25	TA General Meeting
					1				04/25	TA General Meeting
1					1				04/25	TA General Meeting
					1				04/25	TA General Meeting
					1				04/25	TA General Meeting
					1	1			04/25	TA General Meeting
					1	1			04/25	TA General Meeting
					1	1			04/25	TA General Meeting
					1				04/25	TA General Meeting
					1				04/25	TA General Meeting
					1	1			04/25	TA General Meeting
					1				04/25	TA General Meeting
	1					1			04/25	TA General Meeting
	1								04/25	TA General Meeting
	1					1			04/25	TA General Meeting
									04/25	TA General Meeting
					1				04/25	TA General Meeting
						1			04/25	TA General Meeting
									04/25	TA General Meeting
									04/25	TA General Meeting
									04/25	TA General Meeting
									04/25	TA General Meeting
1									04/25	TA General Meeting















# POMONOK HOUSES

A CONNECTED COMMUNITIES INITIATIVE

PILOT PROJECT

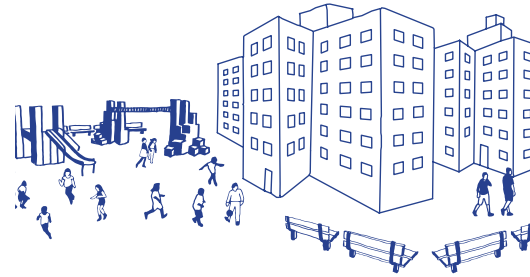

1. How often do you use the outdoor spaces at Pomonok Houses? (Select one)

- Daily
- Weekly
- Monthly
- A few times a year
- Other \_\_\_\_\_

3. Who do you often see using Pomonok's outdoor spaces? (Select all that apply)

- Children
- Teens
- Families
- Adults
- Seniors

3B. Who do you see excluded from these spaces?

\_\_\_\_\_

5. Describe what makes the existing outdoor spaces in Pomonok welcoming?

\_\_\_\_\_  
\_\_\_\_\_

7. What are your **top 3** priorities to make more inclusive outdoor spaces at Pomonok? (Select 3)

- Program + Events
- Gathering + Socializing
- Sports + Recreation
- Gardens vegetables + plantings
- Walkability + Accessibility
- Maintenance + Upkeep
- Safety + Security
- Health + Wellness
- Sense of Belonging
- Connection to outside community
- Other \_\_\_\_\_

8. What programs, uses, activity, or quality would make you use Pomonok's outdoor spaces more often?

\_\_\_\_\_  
\_\_\_\_\_

9. If you could change or improve ONE outdoor space on the Pomonok Campus what would it be? Why?

\_\_\_\_\_  
\_\_\_\_\_

**\*\* PLEASE RETURN TO YOUR TENANT ASSOCIATION \*\***

at 67-10 PARSONS BOULEVARD

Include your email or phone number for a chance to win prizes

# POMONOK HOUSES

A CONNECTED COMMUNITIES INITIATIVE

PILOT PROJECT



## TELL US MORE ABOUT YOURSELF! (OPTIONAL)

1. Do you live in Pomonok?

- Yes
- No

2. Are you, or someone else in your household, living with a disability?

- Yes
- No

1b. If so, What is your building number (Circle one)

- |    |    |    |    |    |    |    |            |                                 |    |    |    |    |    |
|----|----|----|----|----|----|----|------------|---------------------------------|----|----|----|----|----|
| 1  | 2  | 3  | 4  | 5  | 6  | 7  | 8          | 9                               | 10 | 11 | 12 | 13 | 14 |
| 15 | 16 | 17 | 18 | 19 | 20 | 21 | 22         | 23                              | 24 | 25 | 26 | 27 | 28 |
| 29 | 30 | 31 | 32 | 33 | 34 | 35 | Not Listed | I don't know my building number |    |    |    |    |    |

3. How old are you?

- 18 or younger
- 19-24
- 25-30
- 31-45
- 46-65
- 65 or older
- Prefer not to answer

4. Which category best describes how you self-identify?

- Woman
- Man
- Transgender woman
- Transgender man
- Gender Variant/ Non-conforming
- Not listed
- Prefer not to answer

5. What is your race? Select all that apply

- American Indian or Native Alaskan
- Asian or Asian American
- Black or African American
- Native Hawaiian or Pacific Islander
- White
- Other

6. Do you consider yourself to be Hispanic or Latinx?

- Yes, Hispanic/Latinx
- No, not Hispanic/Latinx

**\*\* PLEASE RETURN TO YOUR TENANT ASSOCIATION \*\***

at 67-10 PARSONS BOULEVARD

Include your email or phone number for a chance to win prizes



	Location #1: Time:	Location #2: Time:	Location #3: Time:	Location #4: Time:
Are their positive cultural or social activities occurring?	Yes No	Yes No	Yes No	Yes No
Do you feel isolated?	Yes No	Yes No	Yes No	Yes No
How many people are likely to be around? In the early morning During the day Late at night	0 5 10 15 20+ 0 5 10 15 20+ 0 5 10 15 20+	0 5 10 15 20+ 0 5 10 15 20+ 0 5 10 15 20+	0 5 10 15 20+ 0 5 10 15 20+ 0 5 10 15 20+	0 5 10 15 20+ 0 5 10 15 20+ 0 5 10 15 20+
Is it easy to predict when people will be around?	Yes No	Yes No	Yes No	Yes No
Are there organizations or groups who are concerned about this area and its people?	Yes No	Yes No	Yes No	Yes No
How do these groups make you feel more or less comfortable?				
What improvements would you like to see?				
Who do you feel should make those improvements?				
What role, skills or resources could you contribute to help make improvements?				

**SURVEYS**

	Location #1: Time:	Location #2: Time:	Location #3: Time:	Location #4: Time:
List 5 words that describe your overall feelings in this space.				
Scale of 1-5 how would you rank the following: <i>(1= very poor; 5 = very good)</i>				
<b>Lighting</b> Amount of lighting Quality of lighting Consistency of lighting	Lighting 1 2 3 4 5 1 2 3 4 5 1 2 3 4 5	Lighting 1 2 3 4 5 1 2 3 4 5 1 2 3 4 5	Lighting 1 2 3 4 5 1 2 3 4 5 1 2 3 4 5	Lighting 1 2 3 4 5 1 2 3 4 5 1 2 3 4 5
<b>Signage</b> Signage (Bldg #s, Streets) Wayfinding + maps Emergency signage Wheelchair signage Exit signage	Signage 1 2 3 4 5 1 2 3 4 5 1 2 3 4 5 1 2 3 4 5	Signage 1 2 3 4 5 1 2 3 4 5 1 2 3 4 5 1 2 3 4 5	Signage 1 2 3 4 5 1 2 3 4 5 1 2 3 4 5 1 2 3 4 5	Signage 1 2 3 4 5 1 2 3 4 5 1 2 3 4 5 1 2 3 4 5
<b>Sightlines</b> Visibility Alternative routes Lack of places to hide Ability to see people	Sightlines 1 2 3 4 5 1 2 3 4 5 1 2 3 4 5 1 2 3 4 5	Sightlines 1 2 3 4 5 1 2 3 4 5 1 2 3 4 5 1 2 3 4 5	Sightlines 1 2 3 4 5 1 2 3 4 5 1 2 3 4 5 1 2 3 4 5	Sightlines 1 2 3 4 5 1 2 3 4 5 1 2 3 4 5 1 2 3 4 5
<b>Isolation</b> Patrol access Frequency of patrol Ability to hear people	Isolation 1 2 3 4 5 1 2 3 4 5 1 2 3 4 5	Isolation 1 2 3 4 5 1 2 3 4 5 1 2 3 4 5	Isolation 1 2 3 4 5 1 2 3 4 5 1 2 3 4 5	Isolation 1 2 3 4 5 1 2 3 4 5 1 2 3 4 5
<b>Maintenance</b> Quality of maintenance Cleanliness Vandalism Infrastructure conditions Quality of repairs	Maintenance 1 2 3 4 5 1 2 3 4 5 1 2 3 4 5 1 2 3 4 5	Maintenance 1 2 3 4 5 1 2 3 4 5 1 2 3 4 5 1 2 3 4 5	Maintenance 1 2 3 4 5 1 2 3 4 5 1 2 3 4 5 1 2 3 4 5	Maintenance 1 2 3 4 5 1 2 3 4 5 1 2 3 4 5 1 2 3 4 5

**SURVEYS**

**POMONOK HOUSES**  
A CONNECTED COMMUNITIES INITIATIVE  
PILOT PROJECT

**SAFETY SURVEY**  
June 27, 2019

**HESTER ST**



ENGAGEMENT BOARDS

POMONOK HOUSES

A CONNECTED COMMUNITIES INITIATIVE  
PILOT PROJECT

IDENTIFYING CHALLENGES + OPPORTUNITIES IN POMONOKS OUTDOOR SPACES

Place 3 dots on the topics you feel most passionate about and that you would like to see addressed in this project.

PROGRAMS AND COMMUNITY

PHYSICAL

 <p>Connection to Outside Community</p> <p>Your connection to the rest of the neighborhood, does it feel different once you step out of the NYCHA campus, if so, how?</p>	 <p>Safety + Security</p> <p>How safe you feel in your neighborhood – including your interaction with police, local street lighting, and amount of local crime.</p>	 <p>Sense of Belonging</p> <p>Your connection to culture, history, and identity at Pomonok; how close you live to amenities that are relevant to your identity or culture.</p>	 <p>Walkability + Accessibility</p> <p>The physical accessibility of your home or apartment; the physical accessibility of buildings, streets and sidewalks, and public spaces in Pomonok.</p>	 <p>Outdoor Repairs &amp; Replacements</p> <p>The condition of benches, sidewalks, playgrounds or planted areas; the level of wear and tear of outdoor furniture and streetscapes.</p>	 <p>Other</p>
 <p>Health + Wellness</p> <p>Environment that promotes healthy living, where you have the opportunities to play, be active, relax, and self reflect.</p>	 <p>Programs + Events</p> <p>Events that happen within the campus or community where you are exposed to art, culture or other activities, is it for families, teens or children?</p>	 <p>Gathering + Socializing</p> <p>Areas that allow you to gather with friends and family, both formally and informally.</p>	 <p>Sports + Recreation</p> <p>The areas in the neighborhood where you and your family can play, gather and meet with others doing similar activities, is it available to all age groups?</p>	 <p>Gardens + Vegetation</p> <p>Planted areas within your campus, this could be community gardens, flower beds, bushes, lawns and trees.</p>	 <p>Other</p>

TELL US MORE!

WHAT WORKS ?

WHAT CAN BE IMPROVED?

POMONOK HOUSES

A CONNECTED COMMUNITIES INITIATIVE  
PILOT PROJECT

NOTES

ENGAGEMENT BOARDS

MAPPING IDEAS AT POMONOK

Place a dot on the map to identify specific areas/sites in Pomonok affected by the issues discussed in the previous activity. As a group, brainstorm ideas of outdoor space interventions that could address those issues. Place your idea on the map using the materials provided.

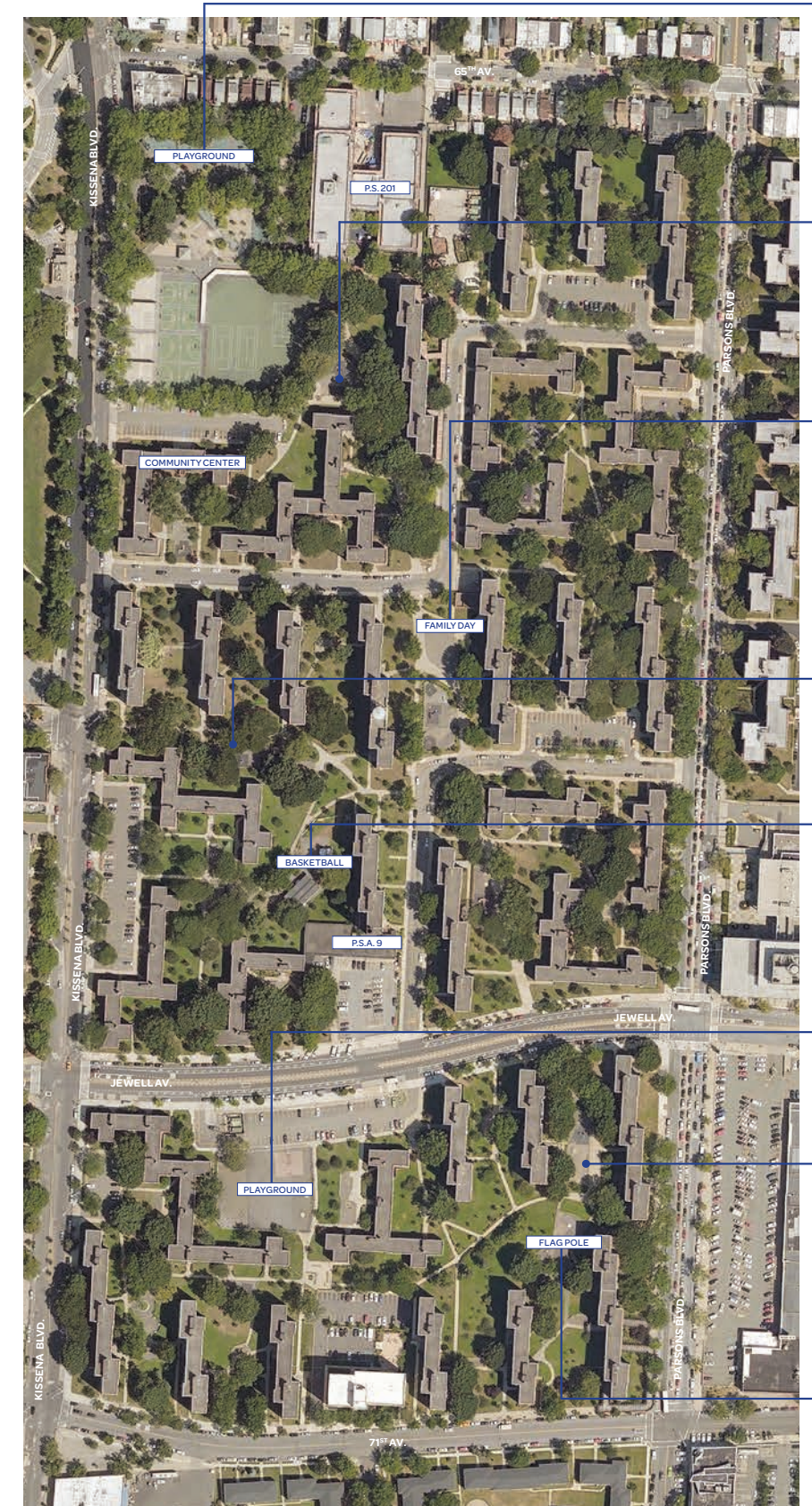



# NYCHA: CONNECTED COMMUNITIES

## 1/ What is NYCHA's Connected Communities Initiative?

### PROJECT OVERVIEW

The Connected Communities Initiative is NYCHA's urban design strategy for creating safe, clean and connected campuses by improving open outdoor spaces. The end goal of the project is to implement design ideas that respond to resident-identified needs and priorities.

### OVERALL PROCESS

The project is structured in 3 phases to make sure the process is led by Pomonok residents. Your feedback will directly impact the which idea is selected and the look and feel of the final proposal!

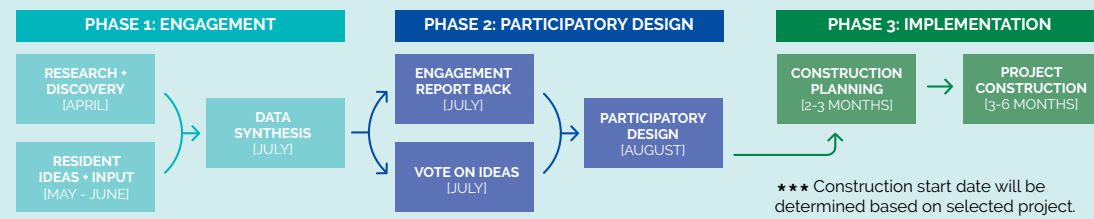

### TIMELINE

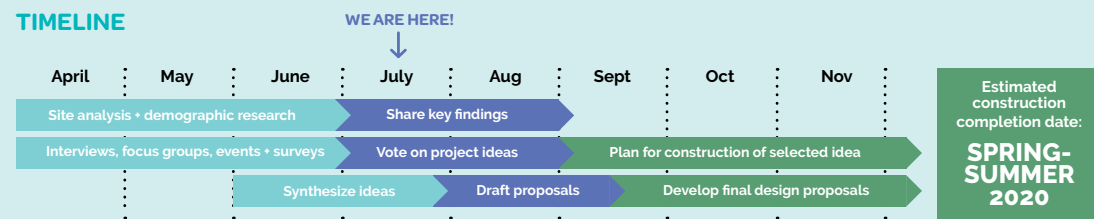

### TYPES OF ENGAGEMENT

Over the past 4 months Pomonok residents and community members have been engaged through campus walks, tabling events, interviews, surveys and interactive activities. Through this process residents and community members shared over 200+ ideas to improve the outdoor spaces at Pomonok Houses!

**1** Campus Walkthrough

Campus walkthrough with Project Team and Pomonok Tenant Association (3/26)

**4** Tabling Events

Talent Show (4/12)  
Health Fair (5/4)  
Resident Green Cmte. Event (5/29)  
Family Day (7/27)

**6** Stakeholder Interviews

Tenant Association Community Coord.  
Queens Community House  
PS 201 PTA  
NYPD 107th/PSA 9  
NYC Parks

**3** Resident Workshops

Resident Meeting (4/25)  
Senior Focus Group (6/19)  
Resident Green Cmte Mtg. (6/19)

**40+** Completed Surveys

Shared online and in-person at all events

**1** Safety Audit Walk

Campus Safety Audit with Project Team, Pomonok Tenant Association, and PSA 9 NCOs (6/27)

**1** Volunteer Day

Upcoming Volunteer Day in partnership with Pomonok Tenant Association and Resident Green Committee!

**"I enjoy walking around the campus!"**

**"Pomonok is very safe compared to other campuses."**

HESTER ST

# NYCHA: CONNECTED COMMUNITIES

## 2/ How do you feel about the outdoor spaces at Pomonok Houses?

### KEY THEMES

Ideas from conversations with Pomonok residents were grouped into 10 key themes: Connection to outside community, safety and security, sense of belonging, health and wellness, programs and events, gathering and socializing, walkability and accessibility, maintenance and upkeep, sports and recreation, and gardens and vegetables. Residents voted on which of these themes are most important to them, gave input on why they are important, and shared their ideas to improve the existing outdoor spaces.

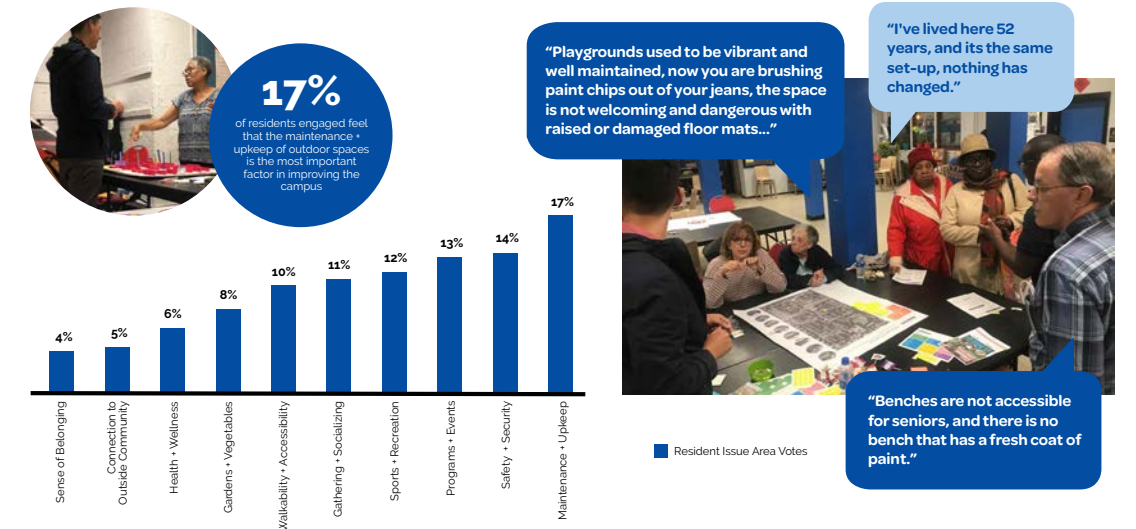

### KEY LOCATIONS

Using various mapping activities, Pomonok residents identified 9 locations around the campus that are most important to them, and shared design ideas to improve them.

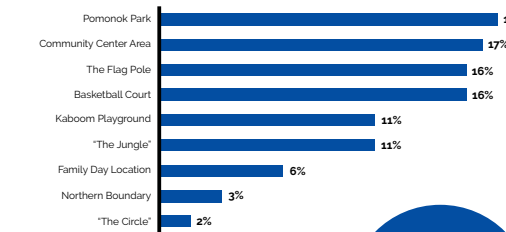

**18%** of suggested locations for design improvements were around Pomonok Park, followed by the Community Center, the Flag Pole, and Basketball Court.

**"Have dedicated areas in playgrounds for adults, children, and seniors."**

**"At the Community Center, some of the teen programs run up to 11 pm, there is concern for their safety heading home."**

### KEY IDEAS

The key ideas residents came up with fit into the categories listed below. General upkeep and repairs came up most frequently, followed by sports/recreation and playgrounds/splash pads.

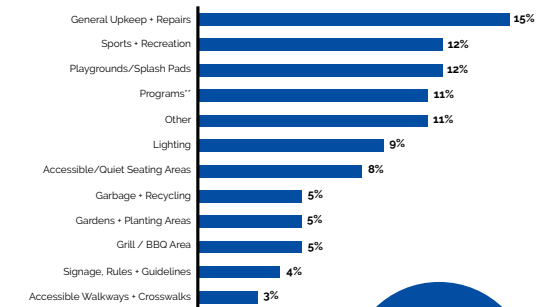

**15%** of intervention ideas are focused on general upkeep + repairs, followed by sports + recreation and new or improved playgrounds.

**"We need social spaces such as, grills, lighting, and seating..."**

**"...The Flag Pole could be a designated BBQ area."**

\*Project funding is only for physical designs, program ideas are not reflected in the voting.

HESTER ST



# NYCHA : CONNECTED COMMUNITIES

## 3/ Site specific ideas and recommendations

### WHAT WE HEARD!

Throughout our engagement, residents spoke about area specific and campus wide challenges within Pomonok. Together they identified problems in and around the campus with possible solutions to address these issues.

We categorized these engagement findings into overall campus themes and site specific recommendations.

### CAMPUS-WIDE THEMES

- GATHERING + SITTING AREAS**
  - Repair and repaint existing benches
  - Prioritize areas where senior gather, ensuring they meet proper sitting height
  - Arrange seating layouts for more conversations
- LIGHTING + SAFETY**
  - Increase lighting on main pathways and in areas where people gather for increased accessibility + safety (play spaces, sitting areas, spaces with limited visibility)
- UPKEEP + MAINTENANCE**
  - Add pest proof trashcans throughout campus, specifically in BBQ areas, playgrounds and sitting areas
  - Add "Do not litter signs" and general rules about upkeep throughout campus
  - Incorporate campus wide doggy bag stations and signage to pick up after their pets
  - Increase campus upkeep and incorporate residents to build community responsibility
- SPORTS + PLAY AREAS**
  - Repair + update existing play equipment
  - Include designated adult playground area for seniors and adults to exercise
  - Add more diverse types of equipment (Outdoor track, swing set, splash pad, tables tennis, adult exercise machines etc.)
  - Host more community building events (Sports tournaments, outside performances, and field trips)
- CONNECTIVITY TO OUTSIDE**
  - Allocate designated space for visitor parking
  - Include maps and wayfinding around campus for pedestrians and cars
  - Partner with Queens College to start educational tours, programming and events (career workshops, dance classes, young adult programs)
  - Establish a book drop off/pick up area for residents to find new reads

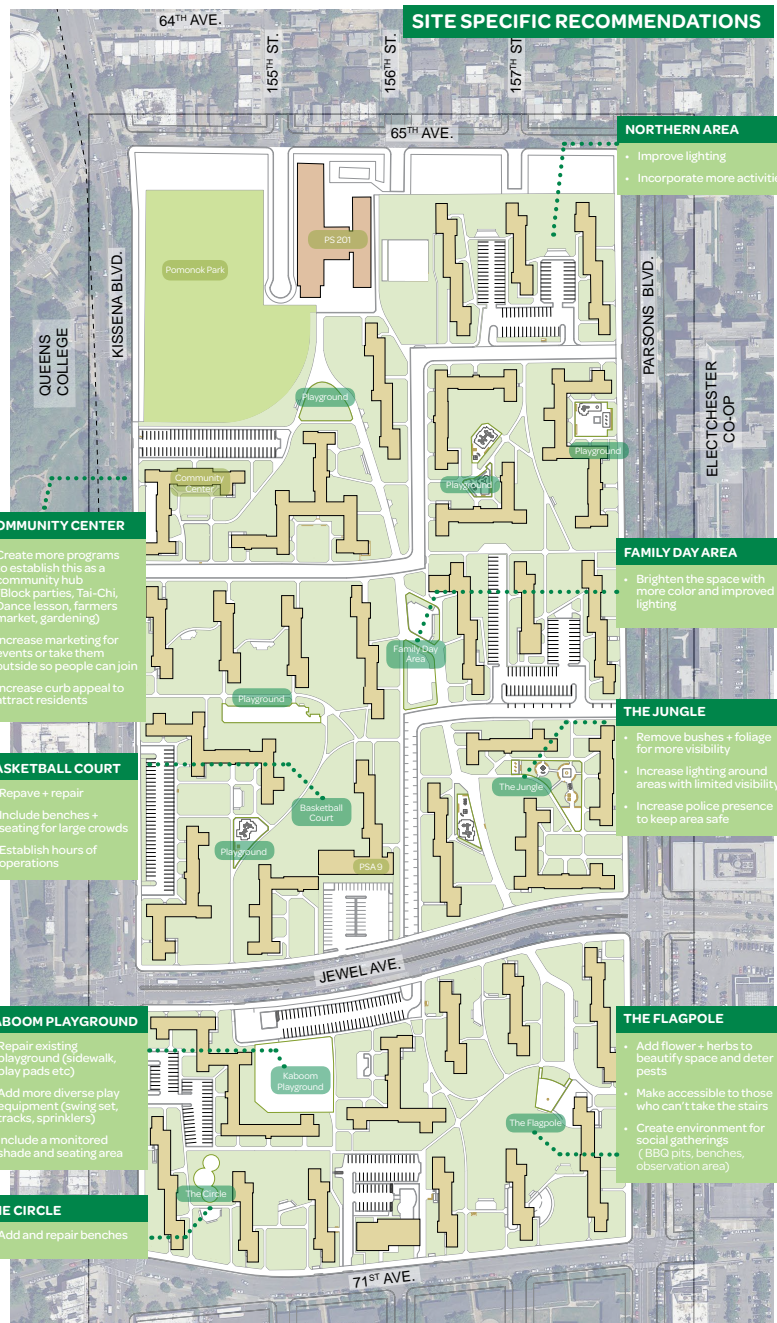

# NYCHA: CONNECTED COMMUNITIES

## 4/ Vote for one of the following ideas to be implemented at Pomonok Houses!

Each person gets 3 votes! you can comment on all the ideas!

All project ideas came from conversations and activities with residents of Pomonok Houses and the surrounding community. Through voting, one idea will be selected, further developed and finally built in the Pomonok campus. The project descriptions below are preliminary and the selected project will be shaped in an upcoming phase by budget and feasibility, and through a participatory design process with residents.

### 1. BASKETBALL COURT UPGRADE

- Location: Basketball court**
- Restore pavement and add/replace/restore basketball hoops
  - Incorporate simple seating for spectators and other gatherings
  - Fix or add surrounding lighting
  - Beautify the surrounding area through painting and gardening

Promotes health and wellness	a little	●	●	●	○	a lot
Encourages social connections	a little	●	●	●	○	a lot
Improves safety	a little	●	●	●	○	a lot
Improves mobility and accessibility	a little	●	○	○	○	a lot
Ease of maintenance	hard	●	○	○	○	easy
Construction timeline	1 year	●	●	○	○	4 mths
Implementation cost	\$	\$	\$			

### 2. WORKOUT TRAIL

- Suggested Location: the jungle**
- Build a paved ADA accessible trail specifically designated for workout
  - Fix or add lighting around the trail
  - Beautify the surrounding area through painting and gardening
  - Improve safety through trimming/removing bushes and ensuring visibility

Promotes health and wellness	a little	●	●	●	○	a lot
Encourages social connections	a little	●	●	●	○	a lot
Improves safety	a little	●	●	●	○	a lot
Improves mobility and accessibility	a little	●	●	●	○	a lot
Ease of maintenance	hard	●	○	○	○	easy
Construction timeline	1 year	●	●	○	○	4 mths
Implementation cost	\$	\$	\$	⊘		

### 3. MINI SKATE PARK

- Suggested Location: Playground east of Community Center**
- Build small skate ramps and install skate park equipment in an underused area
  - Restore paving
  - Fix or add lighting around the skate park
  - Beautify the surrounding area through painting and gardening

Promotes health and wellness	a little	●	●	●	○	a lot
Encourages social connections	a little	●	●	●	○	a lot
Improves safety	a little	●	●	●	○	a lot
Improves mobility and accessibility	a little	●	○	○	○	a lot
Ease of maintenance	hard	●	○	○	○	easy
Construction timeline	1 year	●	●	○	○	4 mths
Implementation cost	\$	\$	\$			

### 4. SPLASH PAD

- Suggested Location: Playground near basketball court**
- Convert an existing underused playground into a water splash pad area
  - Restore existing equipment
  - Add new sprinkler system
  - Fix or add lighting around the splash pad

Promotes health and wellness	a little	●	●	●	○	a lot
Encourages social connections	a little	●	●	●	○	a lot
Improves safety	a little	●	●	●	○	a lot
Improves mobility and accessibility	a little	●	○	○	○	a lot
Ease of maintenance	hard	●	○	○	○	easy
Construction timeline	1 year	●	●	○	○	4 mths
Implementation cost	\$	\$	\$			

### 5. CREATIVE LIGHTING

- Suggested Locations: The Jungle, The Circle, northern boundary**
- On multiple key locations, incorporate new lighting and fix existing
  - Use different technologies: solar, LED lightbulbs, motion sensors, etc.
  - Design for a friendly ambience: floor lighting, landscape lighting, indirect lighting, etc.

Promotes health and wellness	a little	●	●	●	○	a lot
Encourages social connections	a little	●	●	●	○	a lot
Improves safety	a little	●	●	●	○	a lot
Improves mobility and accessibility	a little	●	●	●	○	a lot
Ease of maintenance	hard	●	○	○	○	easy
Construction timeline	1 year	●	○	○	○	4 mths
Implementation cost	\$	\$	\$			

### 6. ENHANCED SEATING AREAS

- Suggested Locations: TBD**
- On multiple key locations throughout the campus, restore and replace benches
  - Incorporate new/different type of seating
  - Fix or add lighting around the seating areas
  - Beautify the surrounding areas through painting and gardening

Promotes health and wellness	a little	●	●	●	○	a lot
Encourages social connections	a little	●	●	●	○	a lot
Improves safety	a little	●	●	●	○	a lot
Improves mobility and accessibility	a little	●	●	●	○	a lot
Ease of maintenance	hard	●	○	○	○	easy
Construction timeline	1 year	●	●	○	○	4 mths
Implementation cost	\$	\$	\$	⊘		

### 7. DESIGNATED BBQ AREA

- Suggested Location: Flagpole**
- Create a designated barbecue area with new BBQ pits
  - Restore or add benches and tables around the area
  - Build a small shaded structure
  - Fix or add lighting around the area
  - Beautify the surrounding area through painting and gardening

Promotes health and wellness	a little	●	○	○	○	a lot
Encourages social connections	a little	●	●	●	○	a lot
Improves safety	a little	●	○	○	○	a lot
Improves mobility and accessibility	a little	●	○	○	○	a lot
Ease of maintenance	hard	●	○	○	○	easy
Construction timeline	1 year	●	●	○	○	4 mths
Implementation cost	\$	\$	\$			

### 8. UPGRADED PLAYGROUND

- Suggested location: TBD**
- Restore one existing playground
  - Paint and fix existing equipment
  - Restore/replace paving
  - Adding swing set, sand box and/or other simple equipment

Promotes health and wellness	a little	●	●	●	○	a lot
Encourages social connections	a little	●	●	●	○	a lot
Improves safety	a little	●	●	●	○	a lot
Improves mobility and accessibility	a little	●	●	●	○	a lot
Ease of maintenance	hard	●	○	○	○	easy
Construction timeline	1 year	●	●	○	○	4 mths
Implementation cost	\$	\$	\$	⊘		

### 9. CLEANING AND UPKEEP STRUCTURES

- Suggested location: Everywhere!**
- Throughout the campus install elements that allow and encourage cleaning and upkeep
  - Add more and larger trashcans
  - Add recycling bins and doggie stations
  - Improve existing compost bins
  - Add signage that encourages people to clean up

Promotes health and wellness	a little	●	●	●	○	a lot
Encourages social connections	a little	●	○	○	○	a lot
Improves safety	a little	●	○	○	○	a lot
Improves mobility and accessibility	a little	●	○	○	○	a lot
Ease of maintenance	hard	●	○	○	○	easy
Construction timeline	1 year	●	●	○	○	4 mths
Implementation cost	\$	⊘	⊘			

10. ADULT WORKOUT AREA: Popular idea that is not included in this project because the construction of a new adult workout area in the Pomonok campus is planned for 2020!



# NYCHA: CONNECTED COMMUNITIES

## Potential Projects for Implementation



### WHAT WE HEARD

More than 150 Residents provided input on what they most wanted to see at the Pomonok Houses. Feedback was collected at Family Day on July 27th, 2019 and through an online platform through August 3, 2019. The most popular ideas were: Splash Pad, Creative Lighting, Maintenance and Upkeep Structures, Basketball Court and BBQ Area. Since creative lighting and maintenance can be incorporated into all ideas, the top 3 project areas for implementation are splash pad, basketball court and BBQ area.

### TOTAL VOTES

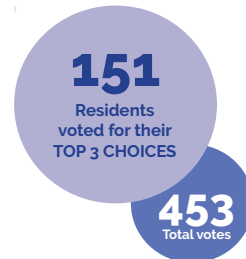

### PROJECTS WITH MOST VOTES

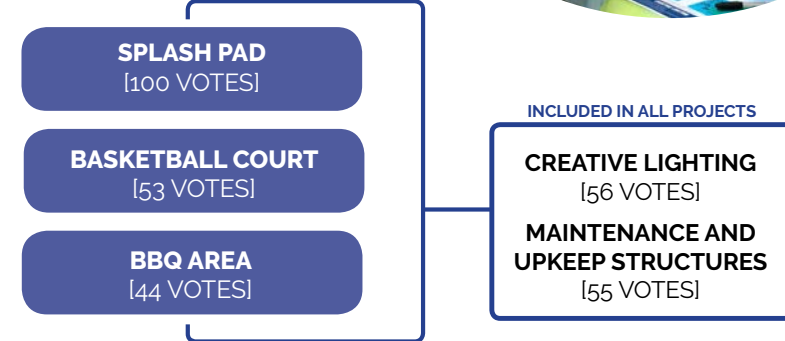

### PROJECT IMPLEMENTATION TIMELINE



### SPLASH PAD AREA



### KEY FEATURES

1. Install interactive sprinkler system
2. Repave with non-slip coating
3. Install new seating
4. Install new creative lighting

HESTER ST

# NYCHA: CONNECTED COMMUNITIES

## Potential Projects for Implementation

### BASKETBALL COURT AREA

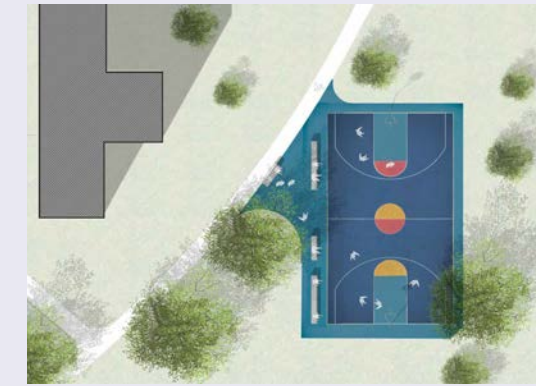

### KEY FEATURES

1. Demolish and repave existing court
2. Resurface with colored athletic coating
3. Install new basketball hoops
4. Install sports lighting
5. Install new seating

### BBQ AREA

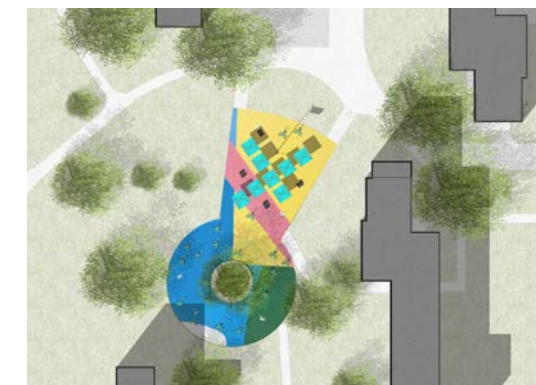

### KEY FEATURES

1. Repair and resurface existing paving
2. Install BBQ grills
3. Install new seating and tables
4. Install creative lighting
5. Improve landscaping/gardening

HESTER ST





Connected Communities



**HESTER ST**

