

**APPENDIX D**  
**CONSTRUCTION NOISE**



550 Washington Street FEIS  
 Construction Noise Analysis  
 North Building and Outdoor Space  
 Assumes Simultaneous Construction of Center and South Buildings

| Building | Height<br>(m) | Façade | Floor | Year 1 Results                      |                      |                        |                      |                      | Year 2 Results       |                                     |                      |                        |                      | Year 3 Results       |                      |                                     |                      |                        | Year 4 Results       |                      |                      |                                     |                      |                        |                      |                      |                      |
|----------|---------------|--------|-------|-------------------------------------|----------------------|------------------------|----------------------|----------------------|----------------------|-------------------------------------|----------------------|------------------------|----------------------|----------------------|----------------------|-------------------------------------|----------------------|------------------------|----------------------|----------------------|----------------------|-------------------------------------|----------------------|------------------------|----------------------|----------------------|----------------------|
|          |               |        |       | Calculated construction Noise level |                      | Non Construction Noise |                      | Total Level          | Total L10            | Calculated construction Noise level |                      | Non Construction Noise |                      | Total Level          | Total L10            | Calculated construction Noise level |                      | Non Construction Noise |                      | Total Level          | Total L10            | Calculated construction Noise level |                      | Non Construction Noise |                      | Total Level          | Total L10            |
|          |               |        |       | L <sub>eq</sub> (dB)                | L <sub>10</sub> (dB) | L <sub>eq</sub> (dB)   | L <sub>10</sub> (dB) | L <sub>eq</sub> (dB) | L <sub>10</sub> (dB) | L <sub>eq</sub> (dB)                | L <sub>10</sub> (dB) | L <sub>eq</sub> (dB)   | L <sub>10</sub> (dB) | L <sub>eq</sub> (dB) | L <sub>10</sub> (dB) | L <sub>eq</sub> (dB)                | L <sub>10</sub> (dB) | L <sub>eq</sub> (dB)   | L <sub>10</sub> (dB) | L <sub>eq</sub> (dB) | L <sub>10</sub> (dB) | L <sub>eq</sub> (dB)                | L <sub>10</sub> (dB) | L <sub>eq</sub> (dB)   | L <sub>10</sub> (dB) | L <sub>eq</sub> (dB) | L <sub>10</sub> (dB) |
| North    | 1.89          | East   | 1     | 63.9                                | 72.4                 | 72.9                   | 73.3                 | 64.4                 | 72.4                 | 73.0                                | 73.3                 | 64.2                   | 72.4                 | 73.0                 | 73.3                 | 63.7                                | 72.4                 | 72.9                   | 73.3                 | 63.7                 | 72.4                 | 72.9                                | 73.3                 |                        |                      |                      |                      |
| North    | 3.67          | East   | 2     | 63.7                                | 72.4                 | 72.9                   | 73.3                 | 64.2                 | 72.4                 | 73.0                                | 73.3                 | 64.2                   | 72.4                 | 73.0                 | 73.3                 | 63.7                                | 72.4                 | 72.9                   | 73.3                 | 63.7                 | 72.4                 | 72.9                                | 73.3                 |                        |                      |                      |                      |
| North    | 9.45          | East   | 3     | 69.0                                | 72.4                 | 72.9                   | 73.3                 | 67.9                 | 72.4                 | 73.0                                | 73.3                 | 67.9                   | 72.4                 | 73.0                 | 73.3                 | 67.3                                | 72.4                 | 72.9                   | 73.3                 | 67.3                 | 72.4                 | 72.9                                | 73.3                 |                        |                      |                      |                      |
| North    | 13.23         | East   | 4     | 69.7                                | 72.4                 | 72.9                   | 73.3                 | 68.4                 | 72.4                 | 73.0                                | 73.3                 | 68.4                   | 72.4                 | 73.0                 | 73.3                 | 67.8                                | 72.4                 | 72.9                   | 73.3                 | 67.8                 | 72.4                 | 72.9                                | 73.3                 |                        |                      |                      |                      |
| North    | 17.01         | East   | 5     | 70.0                                | 72.4                 | 72.9                   | 73.3                 | 68.6                 | 72.4                 | 73.0                                | 73.3                 | 68.6                   | 72.4                 | 73.0                 | 73.3                 | 68.3                                | 72.4                 | 72.9                   | 73.3                 | 68.3                 | 72.4                 | 72.9                                | 73.3                 |                        |                      |                      |                      |
| North    | 20.79         | East   | 6     | 70.4                                | 72.4                 | 72.9                   | 73.3                 | 69.0                 | 72.4                 | 73.0                                | 73.3                 | 69.0                   | 72.4                 | 73.0                 | 73.3                 | 68.9                                | 72.4                 | 72.9                   | 73.3                 | 68.9                 | 72.4                 | 72.9                                | 73.3                 |                        |                      |                      |                      |
| North    | 24.57         | East   | 7     | 71.2                                | 72.4                 | 72.9                   | 73.3                 | 69.4                 | 72.4                 | 73.0                                | 73.3                 | 69.4                   | 72.4                 | 73.0                 | 73.3                 | 69.3                                | 72.4                 | 72.9                   | 73.3                 | 69.3                 | 72.4                 | 72.9                                | 73.3                 |                        |                      |                      |                      |
| North    | 28.35         | East   | 8     | 71.4                                | 72.4                 | 72.9                   | 73.3                 | 69.8                 | 72.4                 | 73.0                                | 73.3                 | 69.8                   | 72.4                 | 73.0                 | 73.3                 | 69.7                                | 72.4                 | 72.9                   | 73.3                 | 69.7                 | 72.4                 | 72.9                                | 73.3                 |                        |                      |                      |                      |
| North    | 32.13         | East   | 9     | 70.6                                | 72.4                 | 72.9                   | 73.3                 | 69.4                 | 72.4                 | 73.0                                | 73.3                 | 69.4                   | 72.4                 | 73.0                 | 73.3                 | 69.3                                | 72.4                 | 72.9                   | 73.3                 | 69.3                 | 72.4                 | 72.9                                | 73.3                 |                        |                      |                      |                      |
| North    | 35.91         | East   | 10    | 70.4                                | 72.4                 | 72.9                   | 73.3                 | 69.2                 | 72.4                 | 73.0                                | 73.3                 | 69.2                   | 72.4                 | 73.0                 | 73.3                 | 69.1                                | 72.4                 | 72.9                   | 73.3                 | 69.1                 | 72.4                 | 72.9                                | 73.3                 |                        |                      |                      |                      |
| North    | 39.69         | East   | 11    | 70.3                                | 72.4                 | 72.9                   | 73.3                 | 69.0                 | 72.4                 | 73.0                                | 73.3                 | 69.0                   | 72.4                 | 73.0                 | 73.3                 | 68.9                                | 72.4                 | 72.9                   | 73.3                 | 68.9                 | 72.4                 | 72.9                                | 73.3                 |                        |                      |                      |                      |
| North    | 43.47         | East   | 12    | 58.1                                | 72.4                 | 72.5                   | 73.3                 | 54.7                 | 72.4                 | 72.4                                | 73.3                 | 53.8                   | 72.4                 | 72.4                 | 73.3                 | 52.6                                | 72.4                 | 72.4                   | 73.3                 | 52.6                 | 72.4                 | 72.4                                | 73.3                 |                        |                      |                      |                      |
| North    | 44.47         | East   | 12    | 64.4                                | 75.0                 | 75.4                   | 76.6                 | 60.1                 | 75.0                 | 75.1                                | 76.6                 | 59.2                   | 75.0                 | 75.1                 | 76.6                 | 58.0                                | 75.0                 | 75.1                   | 76.6                 | 58.0                 | 75.0                 | 75.1                                | 76.6                 |                        |                      |                      |                      |
| North    | 47.25         | East   | 13    | 61.2                                | 72.4                 | 72.7                   | 73.3                 | 60.1                 | 72.4                 | 72.6                                | 73.3                 | 58.4                   | 72.4                 | 72.5                 | 73.3                 | 56.9                                | 72.4                 | 72.5                   | 73.3                 | 56.9                 | 72.4                 | 72.5                                | 73.3                 |                        |                      |                      |                      |
| North    | 48.25         | East   | 13    | 71.9                                | 75.0                 | 75.7                   | 76.6                 | 67.6                 | 75.0                 | 75.7                                | 76.6                 | 66.8                   | 75.0                 | 75.6                 | 76.6                 | 65.4                                | 75.0                 | 75.4                   | 76.6                 | 65.4                 | 75.0                 | 75.4                                | 76.6                 |                        |                      |                      |                      |
| North    | 51.03         | East   | 14    | 67.2                                | 72.4                 | 72.5                   | 73.3                 | 64.1                 | 72.4                 | 72.4                                | 73.3                 | 63.4                   | 72.4                 | 72.4                 | 73.3                 | 61.6                                | 72.4                 | 72.4                   | 73.3                 | 61.6                 | 72.4                 | 72.4                                | 73.3                 |                        |                      |                      |                      |
| North    | 52.03         | East   | 14    | 75.9                                | 75.0                 | 78.5                   | 81.5                 | 70.7                 | 75.0                 | 76.4                                | 76.6                 | 69.9                   | 75.0                 | 76.2                 | 76.6                 | 68.8                                | 75.0                 | 75.9                   | 76.6                 | 68.8                 | 75.0                 | 75.9                                | 76.6                 |                        |                      |                      |                      |
| North    | 54.81         | East   | 15    | 69.9                                | 72.4                 | 74.3                   | 73.3                 | 65.6                 | 72.4                 | 73.2                                | 73.3                 | 65.3                   | 72.4                 | 73.1                 | 73.3                 | 63.5                                | 72.4                 | 72.9                   | 73.3                 | 63.5                 | 72.4                 | 72.9                                | 73.3                 |                        |                      |                      |                      |
| North    | 55.81         | East   | 15    | 76.9                                | 75.0                 | 79.1                   | 82.1                 | 71.0                 | 75.0                 | 76.5                                | 76.6                 | 70.4                   | 75.0                 | 76.3                 | 76.6                 | 69.2                                | 75.0                 | 76.0                   | 76.6                 | 69.2                 | 75.0                 | 76.0                                | 76.6                 |                        |                      |                      |                      |
| North    | 58.59         | East   | 16    | 70.7                                | 72.4                 | 74.6                   | 73.3                 | 66.9                 | 72.4                 | 73.5                                | 73.3                 | 66.6                   | 72.4                 | 73.4                 | 73.3                 | 65.4                                | 72.4                 | 73.2                   | 73.3                 | 65.4                 | 72.4                 | 73.2                                | 73.3                 |                        |                      |                      |                      |
| North    | 59.59         | East   | 16    | 77.1                                | 75.0                 | 80.2                   | 82.2                 | 71.2                 | 75.0                 | 76.5                                | 76.6                 | 70.6                   | 75.0                 | 76.3                 | 76.6                 | 69.5                                | 75.0                 | 75.9                   | 76.6                 | 69.5                 | 75.0                 | 75.9                                | 76.6                 |                        |                      |                      |                      |
| North    | 62.37         | East   | 17    | 71.4                                | 72.4                 | 74.9                   | 73.3                 | 67.4                 | 72.4                 | 73.6                                | 73.3                 | 66.6                   | 72.4                 | 73.4                 | 73.3                 | 65.3                                | 72.4                 | 73.1                   | 73.3                 | 65.3                 | 72.4                 | 73.1                                | 73.3                 |                        |                      |                      |                      |
| North    | 63.37         | East   | 17    | 77.6                                | 75.0                 | 79.5                   | 82.5                 | 71.1                 | 75.0                 | 76.5                                | 76.6                 | 70.7                   | 75.0                 | 76.4                 | 76.6                 | 69.5                                | 75.0                 | 75.9                   | 76.6                 | 69.5                 | 75.0                 | 75.9                                | 76.6                 |                        |                      |                      |                      |
| North    | 66.15         | East   | 18    | 71.6                                | 72.4                 | 75.0                   | 73.3                 | 67.6                 | 72.4                 | 73.6                                | 73.3                 | 66.6                   | 72.4                 | 73.4                 | 73.3                 | 65.3                                | 72.4                 | 73.1                   | 73.3                 | 65.3                 | 72.4                 | 73.1                                | 73.3                 |                        |                      |                      |                      |
| North    | 67.15         | East   | 18    | 77.5                                | 75.0                 | 79.5                   | 82.5                 | 71.5                 | 75.0                 | 76.5                                | 76.6                 | 70.8                   | 75.0                 | 76.3                 | 76.6                 | 69.6                                | 75.0                 | 75.9                   | 76.6                 | 69.6                 | 75.0                 | 75.9                                | 76.6                 |                        |                      |                      |                      |
| North    | 69.93         | East   | 19    | 72.3                                | 72.4                 | 75.3                   | 73.3                 | 68.1                 | 72.4                 | 73.7                                | 73.3                 | 67.2                   | 72.4                 | 73.5                 | 73.3                 | 65.3                                | 72.4                 | 73.1                   | 73.3                 | 65.3                 | 72.4                 | 73.1                                | 73.3                 |                        |                      |                      |                      |
| North    | 70.93         | East   | 19    | 77.5                                | 75.0                 | 79.4                   | 82.4                 | 70.9                 | 75.0                 | 76.4                                | 76.6                 | 70.4                   | 75.0                 | 76.3                 | 76.6                 | 69.4                                | 75.0                 | 75.9                   | 76.6                 | 69.4                 | 75.0                 | 75.9                                | 76.6                 |                        |                      |                      |                      |
| North    | 73.71         | East   | 20    | 72.4                                | 72.4                 | 75.3                   | 73.3                 | 68.2                 | 72.4                 | 73.8                                | 73.3                 | 67.3                   | 72.4                 | 73.5                 | 73.3                 | 65.5                                | 72.4                 | 73.2                   | 73.3                 | 65.5                 | 72.4                 | 73.2                                | 73.3                 |                        |                      |                      |                      |
| North    | 74.71         | East   | 20    | 77.4                                | 75.0                 | 79.4                   | 82.4                 | 70.8                 | 75.0                 | 76.4                                | 76.6                 | 70.3                   | 75.0                 | 76.3                 | 76.6                 | 69.3                                | 75.0                 | 75.9                   | 76.6                 | 69.3                 | 75.0                 | 75.9                                | 76.6                 |                        |                      |                      |                      |
| North    | 77.49         | East   | 21    | 72.2                                | 72.4                 | 75.3                   | 73.3                 | 68.4                 | 72.4                 | 73.8                                | 73.3                 | 67.5                   | 72.4                 | 73.9                 | 73.3                 | 65.7                                | 72.4                 | 73.4                   | 73.3                 | 65.7                 | 72.4                 | 73.4                                | 73.3                 |                        |                      |                      |                      |
| North    | 78.49         | East   | 21    | 77.3                                | 75.0                 | 79.3                   | 82.3                 | 70.8                 | 75.0                 | 76.4                                | 76.6                 | 70.8                   | 75.0                 | 76.3                 | 76.6                 | 69.2                                | 75.0                 | 75.9                   | 76.6                 | 69.2                 | 75.0                 | 75.9                                | 76.6                 |                        |                      |                      |                      |
| North    | 81.27         | East   | 22    | 72.3                                | 72.4                 | 75.3                   | 73.3                 | 68.2                 | 72.4                 | 73.8                                | 73.3                 | 67.3                   | 72.4                 | 73.5                 | 73.3                 | 65.6                                | 72.4                 | 73.2                   | 73.3                 | 65.6                 | 72.4                 | 73.2                                | 73.3                 |                        |                      |                      |                      |
| North    | 82.27         | East   | 22    | 77.0                                | 75.0                 | 79.1                   | 82.1                 | 70.4                 | 75.0                 | 76.3                                | 76.6                 | 69.9                   | 75.0                 | 76.2                 | 76.6                 | 68.8                                | 75.0                 | 75.9                   | 76.6                 | 68.8                 | 75.0                 | 75.9                                | 76.6                 |                        |                      |                      |                      |
| North    | 85.05         | East   | 23    | 72.3                                | 72.4                 | 75.3                   | 73.3                 | 68.4                 | 72.4                 | 73.8                                | 73.3                 | 67.5                   | 72.4                 | 73.9                 | 73.3                 | 65.8                                | 72.4                 | 73.4                   | 73.3                 | 65.8                 | 72.4                 | 73.4                                | 73.3                 |                        |                      |                      |                      |
| North    | 86.05         | East   | 23    | 77.2                                | 75.0                 | 79.2                   | 82.2                 | 70.3                 | 75.0                 | 76.3                                | 76.6                 | 69.8                   | 75.0                 | 76.1                 | 76.6                 | 68.7                                | 75.0                 | 75.9                   | 76.6                 | 68.7                 | 75.0                 | 75.9                                | 76.6                 |                        |                      |                      |                      |
| North    | 88.83         | East   | 24    | 72.4                                | 72.4                 | 75.3                   | 73.3                 | 68.4                 | 72.4                 | 73.8                                | 73.3                 | 67.5                   | 72.4                 | 73.9                 | 73.3                 | 65.8                                | 72.4                 | 73.4                   | 73.3                 | 65.8                 | 72.4                 | 73.4                                | 73.3                 |                        |                      |                      |                      |
| North    | 89.83         | East   | 24    | 77.2                                | 75.0                 | 79.2                   | 82.2                 | 70.2                 | 75.0                 | 76.2                                | 76.6                 | 69.7                   | 75.0                 | 76.1                 | 76.6                 | 68.6                                | 75.0                 | 75.9                   | 76.6                 | 68.6                 | 75.0                 | 75.9                                | 76.6                 |                        |                      |                      |                      |
| North    | 92.61         | East   | 25    | 62.3                                | 72.4                 | 72.8                   | 73.3                 | 59.2                 | 72.4                 | 72.6                                | 73.3                 | 58.6                   | 72.4                 | 72.5                 | 73.3                 | 57.5                                | 72.4                 | 72.5                   | 73.3                 | 57.5                 | 72.4                 | 72.5                                | 73.3                 |                        |                      |                      |                      |
| North    | 93.61         | East   | 25    | 77.1                                | 75.0                 | 79.2                   | 82.2                 | 70.2                 | 75.0                 | 76.1                                | 76.6                 | 69.7                   | 75.0                 | 76.1                 | 76.6                 | 68.6                                | 75.0                 | 75.9                   | 76.6                 | 68.6                 | 75.0                 | 75.9                                | 76.6                 |                        |                      |                      |                      |
| North    | 96.39         | East   | 26    | 67.0                                | 72.4                 | 73.5                   | 73.3                 | 63.7                 | 72.4                 | 72.9                                | 73.3                 | 62.9                   | 72.4                 | 72.8                 | 73.3                 | 61.6                                | 72.4                 | 72.7                   | 73.3                 | 61.6                 | 72.4                 | 72.7                                | 73.3                 |                        |                      |                      |                      |
| North    | 97.39         | East   | 26    | 76.9                                | 75.0                 | 79.1                   | 82.1                 | 70.0                 | 75.0                 | 76.2                                | 76.6                 | 69.6                   | 75.0                 | 76.1                 | 76.6                 | 68.4                                | 75.0                 | 75.9                   | 76.6                 | 68.4                 | 75.0                 | 75.9                                | 76.6                 |                        |                      |                      |                      |
| North    | 100.17        | East   | 27    | 69.9                                | 72.4                 | 74.3                   | 73.3                 | 66.1                 | 72.4                 | 73.3                                | 73.3                 | 65.4                   | 72.4                 | 73.2                 | 73.3                 | 63.8                                | 72.4                 | 73.1                   | 73.3                 | 63.8                 | 72.4                 | 73.1                                | 73.3                 |                        |                      |                      |                      |
| North    | 101.17        | East   | 27    | 76.8                                | 75.0                 | 79.0                   | 82.0                 | 70.9                 | 75.0                 | 76.2                                | 76.6                 | 69.5                   | 75.0                 | 76.1                 | 76.6                 | 68.3                                | 75.0                 | 75.8                   | 76.6                 | 68.3                 | 75.0                 | 75.8                                | 76.6                 |                        |                      |                      |                      |
| North    | 103.95        | East   | 28    | 70.7                                | 72.4                 | 74.6                   | 73.3                 | 66.9                 | 72.4                 | 73.5                                | 73.3                 | 66.6                   | 72.4                 | 73.4                 | 73.3                 | 65.4                                | 72.4                 | 73.2                   | 73.3                 | 65.4                 | 72.4                 | 73.2                                | 73.3                 |                        |                      |                      |                      |
| North    | 104.95        | East   | 28    | 76.4                                | 75.0                 | 78.8                   | 81.8                 | 69.8                 | 75.0                 | 76.1                                | 76.6                 | 69.5                   | 75.0                 | 76.1                 | 76.6                 | 68.2                                | 75.0                 | 75.8                   | 76.6                 | 68.2                 | 75.0                 | 75.8                                | 76.6                 |                        |                      |                      |                      |
| North    | 108.73        | East   | 29    | 76.3                                | 75.0                 | 78.7                   | 81.7                 | 69.7                 | 75.0                 | 76.1                                | 76.6                 | 69.4                   | 75.0                 | 76.1                 | 76.6                 | 68.0                                | 75.0                 | 75.8                   | 76.6                 | 68.0                 | 75.0                 | 75.8                                | 76.6                 |                        |                      |                      |                      |
| North    | 112.51        | East   | 30    | 76.2                                | 75.0                 | 78.7                   | 81.7                 | 69.5                 | 75.0                 | 76.1                                | 76.6                 | 69.1                   | 75.0                 | 76.0                 | 76.6                 | 67.9                                | 75.0                 | 75.8                   | 76.6                 | 67.9                 | 75.0                 | 75.8                                | 76.6                 |                        |                      |                      |                      |
| North    | 116.29        | East   | 31    | 76.0                                | 75.0                 | 78.5                   | 81.5                 | 69.4                 | 75.0                 | 76.1                                | 76.6                 | 69.1                   | 75.0                 | 76.0                 | 76.6                 | 67.8                                | 75.0                 | 75.8                   | 76.6                 | 67.8                 | 75.0                 | 75.8                                | 76.6                 |                        |                      |                      |                      |
| North    | 120.07        | East   | 32    | 75.9                                | 75.0                 | 78.5                   | 81.5                 | 69.4                 | 75.0                 | 76.1                                | 76.6                 | 69.1                   | 75.0                 | 76.0                 | 76.6                 | 67.8                                | 75.0                 | 75.8                   | 76.6                 | 67.8                 | 75.0                 | 75.8                                | 76.6                 |                        |                      |                      |                      |
| North    | 123.85        | East   | 33    | 75.8                                | 75.0                 | 78.4                   | 81.4                 | 69.4                 | 75.0                 | 76.1                                | 76.6                 | 68.9                   | 75.0                 | 76.0                 | 76.6                 | 67.7                                | 75.0                 | 75.7                   | 76.6                 | 67.7                 | 75.0                 | 75.7                                | 76.6                 |                        |                      |                      |                      |
| North    | 127.63        | East   | 34    | 75.7                                | 75.0                 | 78.4                   | 81.4                 | 69.2                 | 75.0                 | 76.0                                | 76.6                 | 68.8                   | 75.0                 | 75.9                 | 76.6                 | 67.6                                | 75.0                 | 75.7                   | 76.6                 | 67.6                 | 75.0                 | 75.7                                | 76.6                 |                        |                      |                      |                      |
| North    | 127.63        | East   | 34    | 75.7                                | 75.0                 | 78.4                   | 81.4                 | 69.2                 | 75.0                 | 76.0                                | 76.6                 | 68.8                   | 75.0                 | 75.9                 | 76.6                 | 67.6                                | 75.0                 | 75.7                   | 76.6                 | 67.6                 | 75.0                 | 75.7                                | 76.6                 |                        |                      |                      |                      |
| North    | 1.89          | North  | 1     | 60.7                                | 75.0                 | 75.2                   | 76.6                 | 58.2                 | 75.0                 | 75.1                                | 76.6                 | 57.5                   | 75.0                 | 75.1                 | 76.6                 | 56.0                                | 75.0                 | 75.1                   | 76.6                 | 56.0                 | 75.0                 | 75.1                                | 76.6                 |                        |                      |                      |                      |
| North    | 5.67          | North  | 2     | 59.9                                | 75.0                 | 75.1                   | 76.6                 | 59.0                 | 75.0                 | 75.1                                | 76.6                 | 59.0                   | 75.0                 | 75.1                 | 76.6                 | 59.0                                | 75.0                 | 75.1                   | 76.6                 | 59.0                 | 75.0                 | 75.1                                | 76.6                 |                        |                      |                      |                      |
| North    | 5.67          | North  | 2     | 61.3                                | 75.0                 | 75.2                   | 76.6                 | 59.6                 | 75.                  |                                     |                      |                        |                      |                      |                      |                                     |                      |                        |                      |                      |                      |                                     |                      |                        |                      |                      |                      |

550 Washington Street FEIS  
Construction Noise Analysis  
North Building and Outdoor Space  
Assumes Simultaneous Construction of Center and South Buildings

| Building | Height<br>(m) | Façade | Floor | Year 1 Results   |   |  |                              |   | Year 2 Results   |   |  |                              |                       | Year 3 Results   |   |  |                              |                       | Year 4 Results   |   |  |                              |                       |
|----------|---------------|--------|-------|--|---|--|------------------------------|---|--|---|--|------------------------------|-----------------------|--|---|--|------------------------------|-----------------------|--|---|--|------------------------------|-----------------------|
|          |               |        |       | Calculated construction Noise level<br>L <sub>eq</sub> (dB(A)) | Non Construction Noise<br>L <sub>eq</sub> (dB(A)) | Total Level<br>L <sub>eq</sub> (dB(A)) | Total L10<br>L <sub>10</sub> | Dominant Noise Source                     | Calculated construction Noise level<br>L <sub>eq</sub> (dB(A)) | Non Construction Noise<br>L <sub>eq</sub> (dB(A)) | Total Level<br>L <sub>eq</sub> (dB(A)) | Total L10<br>L <sub>10</sub> | Dominant Noise Source | Calculated construction Noise level<br>L <sub>eq</sub> (dB(A)) | Non Construction Noise<br>L <sub>eq</sub> (dB(A)) | Total Level<br>L <sub>eq</sub> (dB(A)) | Total L10<br>L <sub>10</sub> | Dominant Noise Source | Calculated construction Noise level<br>L <sub>eq</sub> (dB(A)) | Non Construction Noise<br>L <sub>eq</sub> (dB(A)) | Total Level<br>L <sub>eq</sub> (dB(A)) | Total L10<br>L <sub>10</sub> | Dominant Noise Source |
| North    | 39.69         | South  | 11    | 82.0   | 72.4  | 82.4                                   | 85.4                         | Impact Pile Driver, Concrete Saw, Hoe Ram | 76.2   | 72.4  | 77.7                                   | 80.7                         | Dump Truck            | 75.7   | 72.4  | 77.4                                   | 80.4                         | Dump Truck            | 74.8   | 72.4  | 76.8                                   | 79.8                         | Dump Truck            |
| North    | 39.69         | South  | 11    | 81.5   | 75.0  | 82.4                                   | 85.4                         | Impact Pile Driver, Concrete Saw, Hoe Ram | 74.8   | 75.0  | 77.9                                   | 76.6                         | Dump Truck            | 74.5   | 75.0  | 77.8                                   | 76.6                         | Dump Truck            | 73.7   | 75.0  | 77.4                                   | 76.6                         | Dump Truck            |
| North    | 43.47         | South  | 12    | 81.8   | 72.4  | 82.3                                   | 85.3                         | Impact Pile Driver, Concrete Saw, Hoe Ram | 76.0   | 72.4  | 77.6                                   | 80.6                         | Dump Truck            | 75.5   | 72.4  | 77.2                                   | 80.2                         | Dump Truck            | 74.6   | 72.4  | 76.6                                   | 79.6                         | Dump Truck            |
| North    | 44.47         | South  | 12    | 82.2   | 75.0  | 75.2                                   | 76.6                         |   | 58.0   | 75.0  | 75.1                                   | 76.6                         |                       | 56.9   | 75.0  | 75.1                                   | 76.6                         |                       | 54.6   | 75.0  | 75.0                                   | 76.6                         |                       |
| North    | 43.47         | South  | 12    | 81.3   | 75.0  | 82.2                                   | 85.2                         |   | 74.7   | 75.0  | 77.9                                   | 76.6                         |                       | 74.3   | 75.0  | 77.7                                   | 76.6                         |                       | 73.5   | 75.0  | 77.3                                   | 76.6                         |                       |
| North    | 47.25         | South  | 13    | 81.6   | 72.4  | 82.1                                   | 85.1                         | Impact Pile Driver, Concrete Saw, Hoe Ram | 75.7   | 72.4  | 77.4                                   | 80.4                         | Dump Truck            | 75.2   | 72.4  | 77.0                                   | 80.0                         | Dump Truck            | 74.3   | 72.4  | 76.5                                   | 79.5                         | Dump Truck            |
| North    | 48.25         | South  | 13    | 82.0   | 75.0  | 76.0                                   | 76.6                         |   | 66.1   | 75.0  | 75.5                                   | 76.6                         |                       | 66.1   | 75.0  | 75.5                                   | 76.6                         |                       | 63.3   | 75.0  | 75.3                                   | 76.6                         |                       |
| North    | 51.03         | South  | 14    | 81.4   | 72.4  | 81.9                                   | 84.9                         | Impact Pile Driver, Concrete Saw, Hoe Ram | 75.4   | 72.4  | 77.2                                   | 80.2                         | Dump Truck            | 74.9   | 72.4  | 76.8                                   | 79.8                         | Dump Truck            | 74.0   | 72.4  | 76.3                                   | 79.3                         | Dump Truck            |
| North    | 52.03         | South  | 14    | 75.0   | 75.0  | 76.4                                   | 76.6                         |   | 69.4   | 75.0  | 76.1                                   | 76.6                         |                       | 68.7   | 75.0  | 75.9                                   | 76.6                         |                       | 66.8   | 75.0  | 75.6                                   | 76.6                         |                       |
| North    | 54.81         | South  | 15    | 68.3   | 72.4  | 73.8                                   | 73.3                         |   | 63.0   | 72.4  | 72.8                                   | 73.3                         |                       | 61.9   | 72.4  | 72.7                                   | 73.3                         |                       | 60.0   | 72.4  | 72.6                                   | 73.3                         |                       |
| North    | 55.81         | South  | 15    | 76.1   | 75.0  | 78.6                                   | 81.6                         |   | 70.6   | 75.0  | 76.3                                   | 76.6                         |                       | 70.0   | 75.0  | 76.2                                   | 76.6                         |                       | 68.9   | 75.0  | 76.0                                   | 76.6                         |                       |
| North    | 58.59         | South  | 16    | 79.3   | 72.4  | 80.1                                   | 83.1                         | Impact Pile Driver, Concrete Saw, Hoe Ram | 73.2   | 72.4  | 75.8                                   | 78.8                         | Tower Crane           | 72.6   | 72.4  | 75.5                                   | 78.5                         | Dump Truck            | 71.9   | 72.4  | 75.1                                   | 78.1                         | Dump Truck            |
| North    | 59.59         | South  | 16    | 77.0   | 75.0  | 79.1                                   | 82.1                         |   | 71.4   | 75.0  | 76.6                                   | 76.6                         |                       | 70.7   | 75.0  | 76.4                                   | 76.6                         |                       | 69.8   | 75.0  | 76.1                                   | 76.6                         |                       |
| North    | 62.37         | South  | 17    | 80.3   | 72.4  | 80.9                                   | 83.9                         | Impact Pile Driver, Concrete Saw, Hoe Ram | 74.2   | 72.4  | 76.4                                   | 79.4                         | Tower Crane           | 73.4   | 72.4  | 75.9                                   | 78.9                         | Dump Truck            | 72.4   | 72.4  | 75.4                                   | 78.4                         | Dump Truck            |
| North    | 63.37         | South  | 17    | 77.4   | 75.0  | 79.4                                   | 82.4                         |   | 71.6   | 75.0  | 76.6                                   | 76.6                         |                       | 70.9   | 75.0  | 76.4                                   | 76.6                         |                       | 70.4   | 75.0  | 76.3                                   | 76.6                         |                       |
| North    | 66.15         | South  | 18    | 80.3   | 72.4  | 80.9                                   | 83.9                         | Impact Pile Driver, Concrete Saw, Hoe Ram | 74.1   | 72.4  | 76.3                                   | 79.3                         | Tower Crane           | 73.5   | 72.4  | 76.0                                   | 79.0                         | Dump Truck            | 72.4   | 72.4  | 75.5                                   | 78.5                         | Dump Truck            |
| North    | 67.15         | South  | 18    | 77.7   | 75.0  | 79.6                                   | 82.6                         |   | 71.7   | 75.0  | 76.7                                   | 76.6                         |                       | 71.1   | 75.0  | 76.5                                   | 76.6                         |                       | 70.5   | 75.0  | 76.3                                   | 76.6                         |                       |
| North    | 69.93         | South  | 19    | 78.8   | 72.4  | 79.7                                   | 82.7                         | Impact Pile Driver, Concrete Saw, Hoe Ram | 72.8   | 72.4  | 75.6                                   | 78.6                         | Dump Truck            | 72.2   | 72.4  | 75.3                                   | 78.3                         |                       | 71.2   | 72.4  | 74.8                                   | 77.8                         |                       |
| North    | 70.93         | South  | 19    | 77.7   | 75.0  | 79.6                                   | 82.6                         |   | 71.9   | 75.0  | 76.7                                   | 76.6                         |                       | 71.1   | 75.0  | 76.5                                   | 76.6                         |                       | 70.4   | 75.0  | 76.3                                   | 76.6                         |                       |
| North    | 73.71         | South  | 20    | 79.7   | 72.4  | 80.4                                   | 83.4                         | Impact Pile Driver, Concrete Saw, Hoe Ram | 73.2   | 72.4  | 75.8                                   | 78.8                         | Dump Truck            | 72.8   | 72.4  | 75.6                                   | 78.6                         | Dump Truck            | 71.9   | 72.4  | 75.1                                   | 78.1                         | Dump Truck            |
| North    | 74.71         | South  | 20    | 77.9   | 75.0  | 79.7                                   | 82.7                         |   | 71.4   | 75.0  | 76.6                                   | 76.6                         |                       | 70.8   | 75.0  | 76.4                                   | 76.6                         |                       | 70.0   | 75.0  | 76.2                                   | 76.6                         |                       |
| North    | 77.49         | South  | 21    | 79.7   | 72.4  | 80.4                                   | 83.4                         | Impact Pile Driver, Concrete Saw, Hoe Ram | 73.4   | 72.4  | 75.9                                   | 78.9                         | Dump Truck            | 72.9   | 72.4  | 75.7                                   | 78.7                         | Dump Truck            | 71.9   | 72.4  | 75.1                                   | 78.1                         | Dump Truck            |
| North    | 78.49         | South  | 21    | 77.8   | 75.0  | 79.6                                   | 82.6                         |   | 71.3   | 75.0  | 76.5                                   | 76.6                         |                       | 70.6   | 75.0  | 76.3                                   | 76.6                         |                       | 69.8   | 75.0  | 76.1                                   | 76.6                         |                       |
| North    | 81.27         | South  | 22    | 79.5   | 72.4  | 80.3                                   | 83.3                         | Impact Pile Driver, Concrete Saw, Hoe Ram | 73.2   | 72.4  | 75.8                                   | 78.8                         | Dump Truck            | 72.7   | 72.4  | 75.5                                   | 78.5                         | Dump Truck            | 71.8   | 72.4  | 75.1                                   | 78.1                         | Dump Truck            |
| North    | 82.27         | South  | 22    | 77.9   | 75.0  | 79.7                                   | 82.7                         |   | 71.2   | 75.0  | 76.5                                   | 76.6                         |                       | 70.5   | 75.0  | 76.3                                   | 76.6                         |                       | 69.7   | 75.0  | 76.1                                   | 76.6                         |                       |
| North    | 85.05         | South  | 23    | 79.3   | 72.4  | 80.1                                   | 83.1                         | Impact Pile Driver, Concrete Saw, Hoe Ram | 73.0   | 72.4  | 75.7                                   | 78.7                         | Dump Truck            | 72.5   | 72.4  | 75.4                                   | 78.4                         | Dump Truck            | 71.5   | 72.4  | 74.9                                   | 77.9                         | Dump Truck            |
| North    | 86.05         | South  | 23    | 77.8   | 75.0  | 79.6                                   | 82.6                         |   | 71.1   | 75.0  | 76.5                                   | 76.6                         |                       | 70.4   | 75.0  | 76.3                                   | 76.6                         |                       | 69.5   | 75.0  | 76.1                                   | 76.6                         |                       |
| North    | 88.83         | South  | 24    | 62.6   | 72.4  | 72.8                                   | 73.3                         |   | 56.7   | 72.4  | 72.5                                   | 73.3                         |                       | 55.8   | 72.4  | 72.5                                   | 73.3                         |                       | 53.7   | 72.4  | 72.4                                   | 73.3                         |                       |
| North    | 89.83         | South  | 24    | 77.9   | 75.0  | 79.7                                   | 82.7                         |   | 71.0   | 75.0  | 76.5                                   | 76.6                         |                       | 70.3   | 75.0  | 76.3                                   | 76.6                         |                       | 69.4   | 75.0  | 76.1                                   | 76.6                         |                       |
| North    | 92.61         | South  | 25    | 74.1   | 72.4  | 76.3                                   | 79.3                         | Impact Pile Driver, Concrete Saw, Hoe Ram | 66.8   | 72.4  | 73.7                                   | 73.3                         |                       | 66.8   | 72.4  | 73.4                                   | 73.3                         |                       | 63.9   | 72.4  | 72.9                                   | 73.3                         |                       |
| North    | 93.61         | South  | 25    | 77.8   | 75.0  | 82.6                                   | 85.6                         |   | 70.9   | 75.0  | 76.4                                   | 76.6                         |                       | 70.2   | 75.0  | 76.2                                   | 76.6                         |                       | 69.3   | 75.0  | 76.0                                   | 76.6                         |                       |
| North    | 96.39         | South  | 26    | 76.6   | 72.4  | 78.0                                   | 81.0                         | Impact Pile Driver, Concrete Saw, Hoe Ram | 70.3   | 72.4  | 74.5                                   | 73.3                         |                       | 69.6   | 72.4  | 74.2                                   | 73.3                         |                       | 68.6   | 72.4  | 73.9                                   | 73.3                         |                       |
| North    | 97.39         | South  | 26    | 77.7   | 75.0  | 79.6                                   | 82.6                         |   | 70.8   | 75.0  | 76.4                                   | 76.6                         |                       | 70.2   | 75.0  | 76.2                                   | 76.6                         |                       | 69.2   | 75.0  | 76.0                                   | 76.6                         |                       |
| North    | 100.17        | South  | 27    | 77.4   | 72.4  | 78.6                                   | 81.6                         | Impact Pile Driver, Concrete Saw, Hoe Ram | 71.2   | 72.4  | 74.8                                   | 73.3                         |                       | 70.5   | 72.4  | 74.5                                   | 73.3                         |                       | 69.4   | 72.4  | 74.1                                   | 73.3                         |                       |
| North    | 101.17        | South  | 27    | 77.5   | 75.0  | 79.4                                   | 82.4                         |   | 70.7   | 75.0  | 76.4                                   | 76.6                         |                       | 70.1   | 75.0  | 76.2                                   | 76.6                         |                       | 69.1   | 75.0  | 76.0                                   | 76.6                         |                       |
| North    | 103.95        | South  | 28    | 78.1   | 72.4  | 79.1                                   | 82.1                         | Impact Pile Driver, Concrete Saw, Hoe Ram | 71.4   | 72.4  | 74.9                                   | 73.3                         |                       | 70.8   | 72.4  | 74.7                                   | 73.3                         |                       | 69.8   | 72.4  | 74.3                                   | 73.3                         |                       |
| North    | 104.95        | South  | 28    | 77.5   | 75.0  | 79.4                                   | 82.4                         |   | 70.6   | 75.0  | 76.3                                   | 76.6                         |                       | 70.0   | 75.0  | 76.2                                   | 76.6                         |                       | 69.0   | 75.0  | 76.0                                   | 76.6                         |                       |
| North    | 108.73        | South  | 29    | 77.3   | 75.0  | 79.3                                   | 82.3                         |   | 70.5   | 75.0  | 76.3                                   | 76.6                         |                       | 69.9   | 75.0  | 76.2                                   | 76.6                         |                       | 68.9   | 75.0  | 76.0                                   | 76.6                         |                       |
| North    | 112.51        | South  | 30    | 77.2   | 75.0  | 79.2                                   | 82.2                         |   | 70.4   | 75.0  | 76.2                                   | 76.6                         |                       | 69.8   | 75.0  | 76.1                                   | 76.6                         |                       | 68.8   | 75.0  | 75.9                                   | 76.6                         |                       |
| North    | 116.29        | South  | 31    | 77.1   | 75.0  | 79.2                                   | 82.2                         |   | 70.3   | 75.0  | 76.3                                   | 76.6                         |                       | 69.8   | 75.0  | 76.1                                   | 76.6                         |                       | 68.7   | 75.0  | 75.9                                   | 76.6                         |                       |
| North    | 120.07        | South  | 32    | 77.0   | 75.0  | 79.1                                   | 82.1                         |   | 70.2   | 75.0  | 76.2                                   | 76.6                         |                       | 69.7   | 75.0  | 76.1                                   | 76.6                         |                       | 68.7   | 75.0  | 75.9                                   | 76.6                         |                       |
| North    | 123.85        | South  | 33    | 76.8   | 75.0  | 79.0                                   | 82.0                         |   | 70.1   | 75.0  | 76.2                                   | 76.6                         |                       | 69.4   | 75.0  | 76.1                                   | 76.6                         |                       | 68.3   | 75.0  | 75.8                                   | 76.6                         |                       |
| North    | 127.63        | South  | 34    | 76.6   | 75.0  | 78.9                                   | 81.9                         |   | 70.0   | 75.0  | 76.2                                   | 76.6                         |                       | 69.4   | 75.0  | 76.1                                   | 76.6                         |                       | 68.3   | 75.0  | 75.8                                   | 76.6                         |                       |
| North    | 128.63        | South  | 34    | 76.6   | 75.0  | 78.9                                   | 81.9                         |   | 70.0   | 75.0  | 76.2                                   | 76.6                         |                       | 69.4   | 75.0  | 76.1                                   | 76.6                         |                       | 68.3   | 75.0  | 75.8                                   | 76.6                         |                       |
| North    | 129.63        | South  | 34    | 76.6   | 75.0  | 78.9                                   | 81.9                         |   | 70.0   | 75.0  | 76.2                                   | 76.6                         |                       | 69.4   | 75.0  | 76.1                                   | 76.6                         |                       | 68.3   | 75.0  | 75.8                                   | 76.6                         |                       |
| North    | 130.63        | South  | 34    | 76.6   | 75.0  | 78.9                                   | 81.9                         |   | 70.0   | 75.0  | 76.2                                   | 76.6                         |                       | 69.4   | 75.0  | 76.1                                   | 76.6                         |                       | 68.3   | 75.0  | 75.8                                   | 76.6                         |                       |
| North    | 131.63        | South  | 34    | 76.6   | 75.0  | 78.9                                   | 81.9                         |   | 70.0   | 75.0  | 76.2                                   | 76.6                         |                       | 69.4   | 75.0  | 76.1                                   | 76.6                         |                       | 68.3   | 75.0  | 75.8                                   | 76.6                         |                       |
| North    | 132.63        | South  | 34    | 76.6   | 75.0  | 78.9                                   | 81.9                         |   | 70.0   | 75.0  | 76.2                                   | 76.6                         |                       | 69.4   | 75.0  | 76.1                                   | 76.6                         |                       | 68.3   | 75.0  | 75.8                                   | 76.6                         |                       |
| North    | 133.63        | South  | 34    | 76.6   | 75.0  | 78.9                                   | 81.9                         |   | 70.0   | 75.0  | 76.2                                   | 76.6                         |                       | 69.4   | 75.0  | 76.1                                   | 76.6                         |                       | 68.3   | 75.0  | 75.8                                   | 76.6                         |                       |
| North    | 134.63        | South  | 34    | 76.6   | 75.0  | 78.9                                   | 81.9                         |   | 70.0   | 75.0  | 76.2                                   | 76.6                         |                       | 69.4   | 75.0  | 76.1                                   | 76.6                         |                       | 68.3   | 75.0  | 75.8                                   | 76.6                         |                       |
| North    | 135.63        | South  | 34    | 76.6   | 75.0  | 78.9                                   | 81.9                         |   | 70.0   | 75.0  | 76.2                                   | 76.6                         |                       | 69.4   | 75.0  | 76.1                                   | 76.6                         |                       | 68.3   | 75.0  | 75.8                                   | 76.6                         |                       |
| North    | 136.63        | South  | 34    | 76.6   | 75.0  | 78.9                                   | 81.9                         |   | 70.0   | 75.0  | 76.2                                   | 76.6                         |                       | 69.4   | 75.0  | 76.1                                   | 76.6                         |                       | 68.3   | 75.0  | 75.8                                   | 76.6                         |                       |
| North    | 137.63        |        |       |  |   |  |                              |   |  |   |  |                              |                       |  |   |  |                              |                       |  |   |  |                              |                       |

550 Washington Street FEIS  
 Construction Noise Analysis  
 Center Building  
 Assumes Simultaneous Construction of North and South Buildings

| Building | Height | Façade    | Floor | Year 1 Results   |   |                                 |                              |   | Year 2 Results   |   |                                 |                              |                       | Year 3 Results   |   |                                 |                              |                       | Year 4 Results   |   |                                 |                              |                       |
|----------|--------|-----------|-------|--|---|---------------------------------|------------------------------|---|--|---|---------------------------------|------------------------------|-----------------------|--|---|---------------------------------|------------------------------|-----------------------|--|---|---------------------------------|------------------------------|-----------------------|
|          |        |           |       | Calculated construction Noise level<br>L <sub>eq</sub> (dB(A)) | Non Construction Noise<br>L <sub>eq</sub> (dB(A)) | Total Level<br>L <sub>tot</sub> | Total L10<br>L <sub>10</sub> | Dominant Noise Source                     | Calculated construction Noise level<br>L <sub>eq</sub> (dB(A)) | Non Construction Noise<br>L <sub>eq</sub> (dB(A)) | Total Level<br>L <sub>tot</sub> | Total L10<br>L <sub>10</sub> | Dominant Noise Source | Calculated construction Noise level<br>L <sub>eq</sub> (dB(A)) | Non Construction Noise<br>L <sub>eq</sub> (dB(A)) | Total Level<br>L <sub>tot</sub> | Total L10<br>L <sub>10</sub> | Dominant Noise Source | Calculated construction Noise level<br>L <sub>eq</sub> (dB(A)) | Non Construction Noise<br>L <sub>eq</sub> (dB(A)) | Total Level<br>L <sub>tot</sub> | Total L10<br>L <sub>10</sub> | Dominant Noise Source |
| Center   | 1.74   | East      | 1     | 66.9   | 71.2  | 72.6                            | 74.0                         |   | 66.0   | 71.2  | 72.3                            | 74.0                         |                       | 64.1   | 71.2  | 72.0                            | 74.0                         |                       | 63.0   | 71.2  | 71.8                            | 74.0                         |                       |
| Center   | 5.22   | East      | 2     | 69.5   | 71.2  | 73.4                            | 74.0                         |   | 67.4   | 71.2  | 72.7                            | 74.0                         |                       | 65.9   | 71.2  | 72.3                            | 74.0                         |                       | 65.0   | 71.2  | 72.1                            | 74.0                         |                       |
| Center   | 8.7    | East      | 3     | 70.5   | 71.2  | 73.9                            | 74.0                         |   | 68.1   | 71.2  | 72.9                            | 74.0                         |                       | 66.8   | 71.2  | 72.5                            | 74.0                         |                       | 66.0   | 71.2  | 72.3                            | 74.0                         |                       |
| Center   | 12.18  | East      | 4     | 71.1   | 71.2  | 74.2                            | 74.0                         | Impact Pile Driver, Dump Truck, Hoe Ram   | 69.6   | 71.2  | 73.5                            | 74.0                         |                       | 68.4   | 71.2  | 73.0                            | 74.0                         |                       | 66.5   | 71.2  | 72.5                            | 74.0                         |                       |
| Center   | 15.66  | East      | 5     | 72.0   | 71.2  | 74.6                            | 77.6                         | Impact Pile Driver, Dump Truck, Hoe Ram   | 70.0   | 71.2  | 73.7                            | 74.0                         |                       | 68.9   | 71.2  | 73.2                            | 74.0                         |                       | 66.6   | 71.2  | 72.5                            | 74.0                         |                       |
| Center   | 19.14  | East      | 6     | 72.9   | 71.2  | 75.1                            | 78.1                         | Impact Pile Driver, Dump Truck, Hoe Ram   | 69.9   | 71.2  | 73.6                            | 74.0                         |                       | 68.9   | 71.2  | 73.2                            | 74.0                         |                       | 66.7   | 71.2  | 72.5                            | 74.0                         |                       |
| Center   | 22.62  | East      | 7     | 73.7   | 71.2  | 75.6                            | 78.6                         | Impact Pile Driver, Dump Truck, Hoe Ram   | 69.6   | 71.2  | 73.5                            | 74.0                         |                       | 69.1   | 71.2  | 73.3                            | 74.0                         |                       | 66.9   | 71.2  | 72.6                            | 74.0                         |                       |
| Center   | 26.1   | East      | 8     | 73.8   | 71.2  | 75.7                            | 78.7                         | Impact Pile Driver, Dump Truck, Hoe Ram   | 69.4   | 71.2  | 73.4                            | 74.0                         |                       | 68.8   | 71.2  | 73.2                            | 74.0                         |                       | 67.8   | 71.2  | 72.8                            | 74.0                         |                       |
| Center   | 29.58  | East      | 9     | 71.8   | 71.2  | 74.5                            | 74.0                         | Impact Pile Driver, Dump Truck, Hoe Ram   | 68.8   | 71.2  | 73.2                            | 74.0                         |                       | 67.8   | 71.2  | 72.8                            | 74.0                         |                       | 67.3   | 71.2  | 72.5                            | 74.0                         |                       |
| Center   | 38.13  | East      | 10    | 64.5   | 71.2  | 72.0                            | 74.0                         |   | 62.0   | 71.2  | 71.7                            | 74.0                         |                       | 61.4   | 71.2  | 71.6                            | 74.0                         |                       | 59.7   | 71.2  | 71.5                            | 74.0                         |                       |
| Center   | 41.61  | East      | 11    | 72.2   | 71.2  | 74.7                            | 77.7                         | Dump Truck, Concrete Saw, Pile Driver     | 68.8   | 71.2  | 73.2                            | 74.0                         |                       | 68.6   | 71.2  | 73.1                            | 74.0                         |                       | 67.2   | 71.2  | 72.7                            | 74.0                         |                       |
| Center   | 45.09  | East      | 12    | 73.6   | 71.2  | 75.6                            | 78.6                         | Dump Truck, Concrete Saw, Pile Driver     | 70.8   | 71.2  | 74.0                            | 74.0                         | Dump Truck            | 70.2   | 71.2  | 73.7                            | 74.0                         |                       | 68.5   | 71.2  | 73.1                            | 74.0                         |                       |
| Center   | 38.13  | East      | 13    | 59.7   | 71.2  | 71.5                            | 74.0                         |   | 55.1   | 71.2  | 71.3                            | 74.0                         |                       | 54.9   | 71.2  | 71.3                            | 74.0                         |                       | 52.6   | 71.2  | 71.3                            | 74.0                         |                       |
| Center   | 38.13  | East      | 13    | 67.8   | 71.2  | 72.8                            | 74.0                         |   | 63.7   | 71.2  | 71.9                            | 74.0                         |                       | 62.4   | 71.2  | 71.7                            | 74.0                         |                       | 57.5   | 71.2  | 71.4                            | 74.0                         |                       |
| Center   | 48.57  | East      | 13    | 73.5   | 71.2  | 75.5                            | 78.5                         | Dump Truck, Concrete Saw, Pile Driver     | 70.8   | 71.2  | 74.0                            | 74.0                         | Dump Truck            | 70.3   | 71.2  | 73.8                            | 74.0                         |                       | 68.3   | 71.2  | 73.0                            | 74.0                         |                       |
| Center   | 38.13  | East      | 13    | 74.3   | 71.2  | 76.0                            | 79.0                         | Impact Pile Driver, Concrete Saw, Hoe Ram | 68.1   | 71.2  | 72.9                            | 74.0                         |                       | 66.5   | 71.2  | 72.5                            | 74.0                         |                       | 63.4   | 71.2  | 71.9                            | 74.0                         |                       |
| Center   | 41.61  | East      | 14    | 60.8   | 71.2  | 71.6                            | 74.0                         |   | 57.1   | 71.2  | 71.4                            | 74.0                         |                       | 56.4   | 71.2  | 71.3                            | 74.0                         |                       | 55.3   | 71.2  | 71.3                            | 74.0                         |                       |
| Center   | 41.61  | East      | 14    | 73.7   | 71.2  | 75.6                            | 78.6                         | Impact Pile Driver, Hoe Ram, Excavator    | 68.3   | 71.2  | 73.0                            | 74.0                         |                       | 67.2   | 71.2  | 72.5                            | 74.0                         |                       | 61.6   | 71.2  | 71.7                            | 74.0                         |                       |
| Center   | 52.05  | East      | 14    | 73.4   | 71.2  | 75.4                            | 78.4                         | Dump Truck, Concrete Saw, Pile Driver     | 70.6   | 71.2  | 73.9                            | 74.0                         | Dump Truck            | 70.0   | 71.2  | 73.7                            | 74.0                         |                       | 68.1   | 71.2  | 72.9                            | 74.0                         |                       |
| Center   | 41.61  | East      | 14    | 79.1   | 71.2  | 79.8                            | 82.8                         | Impact Pile Driver, Concrete Saw, Hoe Ram | 73.0   | 71.2  | 75.2                            | 78.2                         |                       | 71.6   | 71.2  | 74.4                            | 77.4                         | Excavator             | 68.7   | 71.2  | 73.1                            | 74.0                         |                       |
| Center   | 45.09  | East      | 15    | 61.8   | 71.2  | 71.7                            | 74.0                         |   | 58.9   | 71.2  | 71.4                            | 74.0                         |                       | 57.6   | 71.2  | 71.4                            | 74.0                         |                       | 57.3   | 71.2  | 71.4                            | 74.0                         |                       |
| Center   | 45.09  | East      | 15    | 76.2   | 71.2  | 77.4                            | 80.4                         | Impact Pile Driver, Hoe Ram, Excavator    | 70.1   | 71.2  | 73.7                            | 74.0                         |                       | 69.6   | 71.2  | 73.5                            | 74.0                         |                       | 64.3   | 71.2  | 72.0                            | 74.0                         |                       |
| Center   | 55.53  | East      | 15    | 73.4   | 71.2  | 75.4                            | 78.4                         | Dump Truck, Concrete Saw, Pile Driver     | 70.5   | 71.2  | 73.9                            | 74.0                         | Dump Truck            | 69.8   | 71.2  | 73.6                            | 74.0                         |                       | 67.9   | 71.2  | 72.9                            | 74.0                         |                       |
| Center   | 45.09  | East      | 15    | 80.3   | 71.2  | 80.8                            | 83.8                         | Impact Pile Driver, Concrete Saw, Hoe Ram | 73.9   | 71.2  | 75.8                            | 78.8                         | Excavator             | 72.6   | 71.2  | 75.0                            | 78.0                         | Excavator             | 69.2   | 71.2  | 73.3                            | 74.0                         |                       |
| Center   | 48.57  | East      | 16    | 62.4   | 71.2  | 71.7                            | 74.0                         |   | 60.0   | 71.2  | 71.5                            | 74.0                         |                       | 60.0   | 71.2  | 71.5                            | 74.0                         |                       | 59.7   | 71.2  | 71.5                            | 74.0                         |                       |
| Center   | 48.57  | East      | 16    | 77.3   | 71.2  | 78.3                            | 81.3                         | Impact Pile Driver, Hoe Ram, Excavator    | 71.3   | 71.2  | 74.3                            | 77.3                         | Excavator             | 70.9   | 71.2  | 74.1                            | 74.0                         |                       | 65.5   | 71.2  | 72.2                            | 74.0                         |                       |
| Center   | 59.01  | East      | 16    | 73.2   | 71.2  | 75.3                            | 78.3                         | Dump Truck, Concrete Saw, Pile Driver     | 70.3   | 71.2  | 73.8                            | 74.0                         | Dump Truck            | 69.6   | 71.2  | 73.5                            | 74.0                         |                       | 67.7   | 71.2  | 72.8                            | 74.0                         |                       |
| Center   | 48.57  | East      | 16    | 80.9   | 71.2  | 81.3                            | 84.3                         | Impact Pile Driver, Concrete Saw, Hoe Ram | 74.2   | 71.2  | 76.0                            | 79.0                         | Excavator             | 73.1   | 71.2  | 75.3                            | 78.3                         | Excavator             | 68.6   | 71.2  | 73.1                            | 74.0                         |                       |
| Center   | 52.05  | East      | 17    | 63.5   | 71.2  | 71.9                            | 74.0                         |   | 61.6   | 71.2  | 71.7                            | 74.0                         |                       | 61.7   | 71.2  | 71.7                            | 74.0                         |                       | 59.5   | 71.2  | 71.5                            | 74.0                         |                       |
| Center   | 52.05  | East      | 17    | 78.6   | 71.2  | 79.3                            | 82.3                         | Impact Pile Driver, Hoe Ram, Excavator    | 72.2   | 71.2  | 74.7                            | 77.7                         | Excavator             | 72.0   | 71.2  | 74.6                            | 77.6                         | Excavator             | 66.5   | 71.2  | 72.5                            | 74.0                         |                       |
| Center   | 62.49  | East      | 17    | 73.0   | 71.2  | 75.2                            | 78.2                         | Dump Truck, Concrete Saw, Pile Driver     | 70.1   | 71.2  | 73.7                            | 74.0                         | Dump Truck            | 69.4   | 71.2  | 73.4                            | 74.0                         |                       | 67.5   | 71.2  | 72.7                            | 74.0                         |                       |
| Center   | 52.05  | East      | 17    | 81.1   | 71.2  | 81.5                            | 84.5                         | Impact Pile Driver, Concrete Saw, Hoe Ram | 74.4   | 71.2  | 76.1                            | 79.1                         | Excavator             | 73.2   | 71.2  | 75.3                            | 78.3                         | Excavator             | 69.1   | 71.2  | 73.3                            | 74.0                         |                       |
| Center   | 55.53  | East      | 18    | 65.9   | 71.2  | 72.3                            | 74.0                         |   | 64.0   | 71.2  | 72.0                            | 74.0                         |                       | 63.6   | 71.2  | 71.9                            | 74.0                         |                       | 62.3   | 71.2  | 71.7                            | 74.0                         |                       |
| Center   | 55.53  | East      | 18    | 79.2   | 71.2  | 79.8                            | 82.8                         | Impact Pile Driver, Hoe Ram, Excavator    | 73.1   | 71.2  | 75.3                            | 78.3                         | Excavator             | 73.0   | 71.2  | 75.2                            | 78.2                         | Excavator             | 67.4   | 71.2  | 72.7                            | 74.0                         |                       |
| Center   | 65.97  | East      | 18    | 72.9   | 71.2  | 75.1                            | 78.1                         | Dump Truck, Concrete Saw, Pile Driver     | 69.9   | 71.2  | 73.6                            | 74.0                         | Dump Truck            | 69.2   | 71.2  | 73.3                            | 74.0                         |                       | 67.3   | 71.2  | 72.7                            | 74.0                         |                       |
| Center   | 55.53  | East      | 18    | 80.8   | 71.2  | 81.3                            | 84.3                         | Impact Pile Driver, Concrete Saw, Hoe Ram | 74.2   | 71.2  | 76.0                            | 79.0                         | Excavator             | 73.0   | 71.2  | 75.2                            | 78.2                         | Excavator             | 68.9   | 71.2  | 73.2                            | 74.0                         |                       |
| Center   | 59.01  | East      | 19    | 68.1   | 71.2  | 74.0                            | 74.0                         |   | 68.1   | 71.2  | 72.2                            | 74.0                         |                       | 68.1   | 71.2  | 72.2                            | 74.0                         |                       | 67.9   | 71.2  | 71.9                            | 74.0                         |                       |
| Center   | 69.45  | East      | 19    | 72.8   | 71.2  | 75.1                            | 78.1                         | Dump Truck, Concrete Saw, Pile Driver     | 69.7   | 71.2  | 73.5                            | 74.0                         | Dump Truck            | 69.0   | 71.2  | 73.2                            | 74.0                         |                       | 67.1   | 71.2  | 72.5                            | 74.0                         |                       |
| Center   | 59.01  | East      | 19    | 80.5   | 71.2  | 81.0                            | 84.0                         | Impact Pile Driver, Concrete Saw, Hoe Ram | 74.0   | 71.2  | 75.8                            | 78.8                         | Excavator             | 72.7   | 71.2  | 75.0                            | 78.0                         | Excavator             | 68.6   | 71.2  | 73.1                            | 74.0                         |                       |
| Center   | 62.49  | East      | 20    | 68.5   | 71.2  | 73.1                            | 74.0                         |   | 65.8   | 71.2  | 72.3                            | 74.0                         |                       | 65.4   | 71.2  | 72.2                            | 74.0                         |                       | 64.7   | 71.2  | 72.1                            | 74.0                         |                       |
| Center   | 62.49  | East      | 20    | 80.3   | 71.2  | 80.8                            | 83.8                         | Impact Pile Driver, Concrete Saw, Hoe Ram | 73.8   | 71.2  | 75.7                            | 78.7                         | Excavator             | 72.6   | 71.2  | 75.0                            | 78.0                         | Excavator             | 68.5   | 71.2  | 73.1                            | 74.0                         |                       |
| Center   | 65.97  | East      | 21    | 69.4   | 71.2  | 73.4                            | 74.0                         |   | 66.4   | 71.2  | 72.4                            | 74.0                         |                       | 65.6   | 71.2  | 72.3                            | 74.0                         |                       | 64.7   | 71.2  | 72.1                            | 74.0                         |                       |
| Center   | 65.97  | East      | 21    | 80.2   | 71.2  | 80.7                            | 83.7                         | Impact Pile Driver, Concrete Saw, Hoe Ram | 73.7   | 71.2  | 75.6                            | 78.6                         | Excavator             | 72.5   | 71.2  | 74.9                            | 77.9                         | Excavator             | 68.3   | 71.2  | 73.0                            | 74.0                         |                       |
| Center   | 69.45  | East      | 22    | 80.0   | 71.2  | 80.5                            | 83.5                         | Impact Pile Driver, Concrete Saw, Hoe Ram | 73.6   | 71.2  | 75.6                            | 78.6                         | Excavator             | 72.4   | 71.2  | 74.9                            | 77.9                         | Excavator             | 68.2   | 71.2  | 73.0                            | 74.0                         |                       |
| Center   | 72.93  | East      | 23    | 79.8   | 71.2  | 80.4                            | 83.4                         | Impact Pile Driver, Concrete Saw, Hoe Ram | 73.4   | 71.2  | 75.4                            | 78.4                         | Excavator             | 72.4   | 71.2  | 74.9                            | 77.9                         | Excavator             | 68.1   | 71.2  | 72.9                            | 74.0                         |                       |
| Center   | 76.41  | East      | 24    | 79.7   | 71.2  | 80.3                            | 83.3                         | Impact Pile Driver, Concrete Saw, Hoe Ram | 73.3   | 71.2  | 75.4                            | 78.4                         | Excavator             | 72.3   | 71.2  | 74.8                            | 77.8                         | Excavator             | 68.0   | 71.2  | 72.9                            | 74.0                         |                       |
| Center   | 79.89  | East      | 25    | 79.6   | 71.2  | 80.2                            | 83.2                         | Impact Pile Driver, Concrete Saw, Hoe Ram | 73.2   | 71.2  | 75.3                            | 78.3                         | Excavator             | 72.2   | 71.2  | 74.7                            | 77.7                         | Excavator             | 67.9   | 71.2  | 72.9                            | 74.0                         |                       |
| Center   | 83.37  | East      | 26    | 79.5   | 71.2  | 80.1                            | 83.1                         | Impact Pile Driver, Concrete Saw, Hoe Ram | 73.2   | 71.2  | 75.3                            | 78.3                         | Excavator             | 72.2   | 71.2  | 74.7                            | 77.7                         | Excavator             | 67.8   | 71.2  | 72.8                            | 74.0                         |                       |
| Center   | 86.85  | East      | 27    | 79.4   | 71.2  | 80.0                            | 83.0                         | Impact Pile Driver, Concrete Saw, Hoe Ram | 73.0   | 71.2  | 75.2                            | 78.2                         | Excavator             | 72.1   | 71.2  | 74.7                            | 77.7                         | Excavator             | 67.5   | 71.2  | 72.7                            | 74.0                         |                       |
| Center   | 90.33  | East      | 28    | 79.4   | 71.2  | 80.0                            | 83.0                         | Impact Pile Driver, Concrete Saw, Hoe Ram | 72.9   | 71.2  | 75.1                            | 78.1                         | Excavator             | 72.0   | 71.2  | 74.6                            | 77.6                         | Excavator             | 67.3   | 71.2  | 72.7                            | 74.0                         |                       |
| Center   | 93.81  | East      | 29    | 79.3   | 71.2  | 79.9                            | 82.9                         | Impact Pile Driver, Concrete Saw, Hoe Ram | 72.8   | 71.2  | 75.1                            | 78.1                         | Excavator             | 71.9   | 71.2  | 74.6                            | 77.6                         | Excavator             | 67.2   | 71.2  | 72.7                            | 74.0                         |                       |
| Center   | 1.74   | Courtyard | 1     | 71.6   | 71.2  | 74.4                            | 77.4                         | Impact Pile Driver, Hoe Ram, Concrete Saw | 70.4   | 71.2  | 73.8                            | 74.0                         |                       | 66.0   | 71.2  | 72.3                            | 74.0                         |                       | 62.9   | 71.2  | 71.8                            | 74.0                         |                       |
| Center   | 1.74   | Courtyard | 1     | 68.8   | 71.2  | 73.2                            | 74.0                         |   | 68.5   | 71.2  | 73.1                            | 74.0                         |                       | 63.5   | 71.2  | 71.9                            | 74.0                         |                       | 60.0   | 71.2  | 71.5                            | 74.0                         |                       |
| Center   | 1.74   | Courtyard | 1     | 70.7   | 71.2  | 74.0                            | 74.0                         |   | 69.4   | 71.2  | 73.4                            | 74.0                         |                       | 64.6   | 71.2  | 72.1                            | 74.0                         |                       | 60.1   | 71.2  | 71.5                            | 74.0                         |                       |
| Center   | 5.22   | Courtyard | 2     | 73.4   | 71.2  | 75.4                            | 78.4                         | Impact Pile Driver, Hoe Ram, Concrete Saw | 71.1   | 71.2  | 74.2                            | 74.0                         |                       | 67.8   | 71.2  | 72.8                            | 74.0                         |                       | 64.2   | 71.2  | 72.0                            | 74.0                         |                       |
| Center   | 5.22   | Courtyard | 2     | 71.5   | 71.2  | 74.4                            | 77.4                         |   | 69.1   | 71.2  | 73.3                            | 74.0                         |                       | 64.8   | 71.2  | 72.1                            | 74.0                         |                       | 61.0   | 71.2  | 71.6                            | 74.0                         |                       |
| Center   | 5.22   | Courtyard | 2     | 72.8   | 71.2  | 75.1                            | 78.1                         |   | 69.9   | 71.2  | 73.6                            | 74.0                         |                       | 65.2   | 71.2  | 72.4                            | 74.0                         |                       | 61.3   | 71.2  | 71.6                            | 74.0                         |                       |
| Center   | 8.7    | Courtyard | 3     | 74.8   | 71.2  | 76.4                            | 79.4                         | Impact Pile Driver, Hoe Ram, Concrete Saw | 71.8   | 71.2  | 74.5                            | 77.5                         | Dump Truck            | 69.0   | 71.2  | 73.2                            | 74.0                         |                       |  |   |                                 |                              |                       |

550 Washington Street FEIS  
 Construction Noise Analysis  
 Center Building  
 Assumes Simultaneous Construction of North and South Buildings

| Building | Height<br>(m) | Façade | Floor | Year 1 Results  |  |                          |                       |   | Year 2 Results  |  |                          |                       |                       | Year 3 Results  |  |                          |                       |                       | Year 4 Results  |  |                          |                       |                       |
|----------|---------------|--------|-------|---|--|--------------------------|-----------------------|---|---|--|--------------------------|-----------------------|-----------------------|---|--|--------------------------|-----------------------|-----------------------|---|--|--------------------------|-----------------------|-----------------------|
|          |               |        |       | Calculated construction Noise level<br>$L_{eq}(10hr)$ | Non Construction Noise<br>$L_{eq}(10hr)$ | Total Level<br>$L_{tot}$ | Total L10<br>$L_{10}$ | Dominant Noise Source                     | Calculated construction Noise level<br>$L_{eq}(10hr)$ | Non Construction Noise<br>$L_{eq}(10hr)$ | Total Level<br>$L_{tot}$ | Total L10<br>$L_{10}$ | Dominant Noise Source | Calculated construction Noise level<br>$L_{eq}(10hr)$ | Non Construction Noise<br>$L_{eq}(10hr)$ | Total Level<br>$L_{tot}$ | Total L10<br>$L_{10}$ | Dominant Noise Source | Calculated construction Noise level<br>$L_{eq}(10hr)$ | Non Construction Noise<br>$L_{eq}(10hr)$ | Total Level<br>$L_{tot}$ | Total L10<br>$L_{10}$ | Dominant Noise Source |
| Center   | 65.97         | North  | 18    | 70.4  | 71.2                                     | 73.8                     | 74.0                  |   | 65.9  | 71.2                                     | 72.3                     | 74.0                  |                       | 64.7  | 71.2                                     | 72.1                     | 74.0                  |                       | 60.9  | 71.2                                     | 71.6                     | 74.0                  |                       |
| Center   | 55.53         | North  | 18    | 64.5  | 71.2                                     | 72.0                     | 74.0                  |   | 59.9  | 71.2                                     | 71.5                     | 74.0                  |                       | 58.8  | 71.2                                     | 71.4                     | 74.0                  |                       | 56.1  | 71.2                                     | 71.3                     | 74.0                  |                       |
| Center   | 59.01         | North  | 19    | 80.4  | 75.0                                     | 81.5                     | 84.5                  | Impact Pile Driver, Concrete Saw, Hoe Ram | 73.8  | 75.0                                     | 77.5                     | 76.6                  |                       | 73.8  | 75.0                                     | 77.5                     | 76.6                  |                       | 68.7  | 75.0                                     | 75.9                     | 76.6                  |                       |
| Center   | 69.45         | North  | 19    | 70.7  | 71.2                                     | 74.0                     | 74.0                  |   | 66.1  | 71.2                                     | 72.4                     | 74.0                  |                       | 64.8  | 71.2                                     | 72.1                     | 74.0                  |                       | 61.1  | 71.2                                     | 71.6                     | 74.0                  |                       |
| Center   | 59.01         | North  | 19    | 65.6  | 71.2                                     | 72.3                     | 74.0                  |   | 61.4  | 71.2                                     | 71.6                     | 74.0                  |                       | 60.4  | 71.2                                     | 71.5                     | 74.0                  |                       | 57.4  | 71.2                                     | 71.4                     | 74.0                  |                       |
| Center   | 62.49         | North  | 20    | 80.3  | 75.0                                     | 81.4                     | 84.4                  | Impact Pile Driver, Concrete Saw, Hoe Ram | 73.7  | 75.0                                     | 77.4                     | 76.6                  |                       | 73.8  | 75.0                                     | 77.5                     | 76.6                  |                       | 68.5  | 75.0                                     | 75.9                     | 76.6                  |                       |
| Center   | 62.49         | North  | 20    | 67.3  | 71.2                                     | 72.7                     | 74.0                  |   | 62.3  | 71.2                                     | 71.7                     | 74.0                  |                       | 61.7  | 71.2                                     | 71.7                     | 74.0                  |                       | 57.8  | 71.2                                     | 71.4                     | 74.0                  |                       |
| Center   | 65.97         | North  | 21    | 80.0  | 75.0                                     | 81.2                     | 84.2                  | Impact Pile Driver, Concrete Saw, Hoe Ram | 73.5  | 75.0                                     | 77.3                     | 76.6                  |                       | 73.6  | 75.0                                     | 77.4                     | 76.6                  |                       | 68.2  | 75.0                                     | 75.8                     | 76.6                  |                       |
| Center   | 65.97         | North  | 21    | 68.0  | 71.2                                     | 72.9                     | 74.0                  |   | 63.2  | 71.2                                     | 71.8                     | 74.0                  |                       | 62.6  | 71.2                                     | 71.8                     | 74.0                  |                       | 58.2  | 71.2                                     | 71.4                     | 74.0                  |                       |
| Center   | 69.45         | North  | 22    | 68.8  | 71.2                                     | 73.2                     | 74.0                  |   | 63.8  | 71.2                                     | 71.9                     | 74.0                  |                       | 63.4  | 71.2                                     | 71.9                     | 74.0                  |                       | 57.9  | 71.2                                     | 71.4                     | 74.0                  |                       |
| Center   | 72.93         | North  | 23    | 69.3  | 71.2                                     | 73.4                     | 74.0                  |   | 64.5  | 71.2                                     | 72.0                     | 74.0                  |                       | 63.8  | 71.2                                     | 71.9                     | 74.0                  |                       | 59.2  | 71.2                                     | 71.5                     | 74.0                  |                       |
| Center   | 76.41         | North  | 24    | 70.2  | 71.2                                     | 73.7                     | 74.0                  |   | 65.2  | 71.2                                     | 72.2                     | 74.0                  |                       | 64.6  | 71.2                                     | 72.1                     | 74.0                  |                       | 59.1  | 71.2                                     | 71.5                     | 74.0                  |                       |
| Center   | 79.89         | North  | 25    | 70.4  | 71.2                                     | 73.8                     | 74.0                  |   | 66.6  | 71.2                                     | 72.5                     | 74.0                  |                       | 65.7  | 71.2                                     | 72.3                     | 74.0                  |                       | 59.6  | 71.2                                     | 71.5                     | 74.0                  |                       |
| Center   | 83.37         | North  | 26    | 70.9  | 71.2                                     | 74.1                     | 74.0                  |   | 66.8  | 71.2                                     | 72.5                     | 74.0                  |                       | 66.0  | 71.2                                     | 72.3                     | 74.0                  |                       | 60.1  | 71.2                                     | 71.5                     | 74.0                  |                       |
| Center   | 86.85         | North  | 27    | 71.6  | 71.2                                     | 74.4                     | 74.4                  |   | 66.8  | 71.2                                     | 72.5                     | 74.0                  |                       | 66.4  | 71.2                                     | 72.4                     | 74.0                  |                       | 59.7  | 71.2                                     | 71.5                     | 74.0                  |                       |
| Center   | 90.33         | North  | 28    | 72.8  | 71.2                                     | 75.1                     | 78.1                  |   | 67.2  | 71.2                                     | 72.7                     | 74.0                  |                       | 67.1  | 71.2                                     | 72.6                     | 74.0                  |                       | 60.1  | 71.2                                     | 71.5                     | 74.0                  |                       |
| Center   | 93.81         | North  | 29    | 72.8  | 71.2                                     | 75.1                     | 78.1                  |   | 67.6  | 71.2                                     | 72.8                     | 74.0                  |                       | 66.9  | 71.2                                     | 72.6                     | 74.0                  |                       | 60.6  | 71.2                                     | 71.6                     | 74.0                  |                       |
| Center   | 1.74          | South  | 1     | 77.0  | 71.2                                     | 78.0                     | 74.0                  | Impact Pile Driver, Concrete Saw, Hoe Ram | 81.0  | 74.0                                     | 76.1                     | 79.1                  |                       | 76.9  | 71.2                                     | 77.9                     | 80.9                  |                       | 73.4  | 71.2                                     | 75.4                     | 74.0                  |                       |
| Center   | 1.74          | South  | 1     | 76.4  | 82.9                                     | 83.8                     | 83.3                  |   | 73.9  | 82.9                                     | 83.4                     | 83.3                  |                       | 69.3  | 82.9                                     | 83.1                     | 83.3                  |                       | 65.4  | 82.9                                     | 83.0                     | 83.3                  |                       |
| Center   | 5.22          | South  | 2     | 74.9  | 71.2                                     | 79.6                     | 82.6                  | Impact Pile Driver, Concrete Saw, Hoe Ram | 75.6  | 71.2                                     | 76.9                     | 79.9                  | Dump Truck            | 72.7  | 71.2                                     | 75.0                     | 78.0                  | Dump Truck            | 69.5  | 71.2                                     | 73.4                     | 74.0                  |                       |
| Center   | 5.22          | South  | 2     | 77.4  | 82.9                                     | 84.0                     | 83.3                  |   | 74.5  | 82.9                                     | 83.5                     | 83.3                  |                       | 70.9  | 82.9                                     | 83.2                     | 83.3                  |                       | 66.7  | 82.9                                     | 83.0                     | 83.3                  |                       |
| Center   | 8.7           | South  | 3     | 81.0  | 71.2                                     | 81.4                     | 84.4                  | Impact Pile Driver, Concrete Saw, Hoe Ram | 76.8  | 71.2                                     | 77.9                     | 80.9                  | Dump Truck            | 74.4  | 71.2                                     | 76.1                     | 79.1                  | Dump Truck            | 71.0  | 71.2                                     | 74.1                     | 74.0                  | Dump Truck            |
| Center   | 8.7           | South  | 3     | 79.0  | 82.9                                     | 84.4                     | 83.3                  |   | 75.9  | 82.9                                     | 83.7                     | 83.3                  |                       | 73.0  | 82.9                                     | 83.4                     | 83.3                  |                       | 68.7  | 82.9                                     | 83.1                     | 83.3                  |                       |
| Center   | 12.18         | South  | 4     | 83.3  | 71.2                                     | 83.6                     | 86.6                  | Impact Pile Driver, Concrete Saw, Hoe Ram | 78.0  | 71.2                                     | 78.8                     | 81.8                  | Dump Truck            | 75.8  | 71.2                                     | 77.1                     | 80.1                  | Dump Truck            | 72.1  | 71.2                                     | 74.7                     | 77.7                  | Dump Truck            |
| Center   | 12.18         | South  | 4     | 82.1  | 82.9                                     | 85.5                     | 83.3                  |   | 76.8  | 82.9                                     | 83.9                     | 83.3                  |                       | 74.4  | 82.9                                     | 83.5                     | 83.3                  |                       | 70.0  | 82.9                                     | 83.1                     | 83.3                  |                       |
| Center   | 15.66         | South  | 5     | 84.3  | 71.2                                     | 84.5                     | 87.5                  | Impact Pile Driver, Concrete Saw, Hoe Ram | 78.4  | 71.2                                     | 79.2                     | 82.2                  | Dump Truck            | 76.8  | 71.2                                     | 77.9                     | 80.9                  | Dump Truck            | 72.9  | 71.2                                     | 75.1                     | 78.1                  | Dump Truck            |
| Center   | 15.66         | South  | 5     | 83.0  | 82.9                                     | 86.0                     | 89.0                  | Impact Pile Driver, Concrete Saw, Hoe Ram | 77.3  | 82.9                                     | 84.0                     | 83.3                  |                       | 75.0  | 82.9                                     | 83.6                     | 83.3                  |                       | 70.2  | 82.9                                     | 83.2                     | 83.3                  |                       |
| Center   | 19.14         | South  | 6     | 84.5  | 71.2                                     | 84.7                     | 87.7                  | Impact Pile Driver, Concrete Saw, Hoe Ram | 84.5  | 71.2                                     | 79.3                     | 82.3                  | Dump Truck            | 78.6  | 71.2                                     | 77.9                     | 80.9                  | Dump Truck            | 73.4  | 71.2                                     | 75.4                     | 78.4                  | Dump Truck            |
| Center   | 19.14         | South  | 6     | 83.7  | 82.9                                     | 86.3                     | 89.3                  | Impact Pile Driver, Concrete Saw, Hoe Ram | 77.5  | 82.9                                     | 84.0                     | 83.3                  |                       | 75.5  | 82.9                                     | 83.7                     | 83.3                  |                       | 70.8  | 82.9                                     | 83.2                     | 83.3                  | Dump Truck            |
| Center   | 22.62         | South  | 7     | 84.6  | 71.2                                     | 84.8                     | 87.8                  | Impact Pile Driver, Concrete Saw, Hoe Ram | 78.4  | 71.2                                     | 79.2                     | 82.2                  | Dump Truck            | 76.8  | 71.2                                     | 77.9                     | 80.9                  | Dump Truck            | 73.1  | 71.2                                     | 75.3                     | 78.3                  | Dump Truck            |
| Center   | 22.62         | South  | 7     | 83.7  | 82.9                                     | 86.3                     | 89.3                  | Impact Pile Driver, Concrete Saw, Hoe Ram | 77.5  | 82.9                                     | 84.0                     | 83.3                  |                       | 75.6  | 82.9                                     | 83.7                     | 83.3                  |                       | 70.8  | 82.9                                     | 83.2                     | 83.3                  | Dump Truck            |
| Center   | 26.1          | South  | 8     | 84.7  | 71.2                                     | 84.9                     | 87.9                  | Impact Pile Driver, Concrete Saw, Hoe Ram | 78.1  | 71.2                                     | 78.9                     | 81.9                  | Dump Truck            | 76.6  | 71.2                                     | 77.7                     | 80.7                  | Dump Truck            | 72.8  | 71.2                                     | 75.1                     | 78.1                  | Dump Truck            |
| Center   | 26.1          | South  | 8     | 83.8  | 82.9                                     | 86.4                     | 89.4                  | Impact Pile Driver, Concrete Saw, Hoe Ram | 77.5  | 82.9                                     | 84.0                     | 83.3                  |                       | 75.6  | 82.9                                     | 83.7                     | 83.3                  |                       | 70.7  | 82.9                                     | 83.2                     | 83.3                  | Dump Truck            |
| Center   | 29.58         | South  | 9     | 83.8  | 82.9                                     | 86.4                     | 89.4                  | Impact Pile Driver, Concrete Saw, Hoe Ram | 77.3  | 82.9                                     | 84.0                     | 83.3                  |                       | 75.4  | 82.9                                     | 83.6                     | 83.3                  |                       | 70.5  | 82.9                                     | 83.2                     | 83.3                  | Dump Truck            |
| Center   | 31.17         | South  | 10    | 76.0  | 71.2                                     | 77.2                     | 80.2                  | Impact Pile Driver, Concrete Saw, Hoe Ram | 71.6  | 71.2                                     | 74.4                     | 77.4                  |                       | 68.9  | 71.2                                     | 73.2                     | 74.0                  |                       | 65.6  | 71.2                                     | 72.3                     | 74.0                  |                       |
| Center   | 33.07         | South  | 10    | 83.7  | 82.9                                     | 86.3                     | 89.3                  | Impact Pile Driver, Concrete Saw, Hoe Ram | 77.2  | 82.9                                     | 84.0                     | 83.3                  |                       | 75.4  | 82.9                                     | 83.6                     | 83.3                  |                       | 70.5  | 82.9                                     | 83.2                     | 83.3                  | Dump Truck            |
| Center   | 34.65         | South  | 11    | 82.6  | 82.9                                     | 85.9                     | 88.9                  | Impact Pile Driver, Concrete Saw, Hoe Ram | 76.2  | 82.9                                     | 77.4                     | 80.4                  | Dump Truck            | 74.3  | 71.2                                     | 76.0                     | 79.0                  | Dump Truck            | 71.4  | 71.2                                     | 74.3                     | 77.3                  | Dump Truck            |
| Center   | 38.13         | South  | 12    | 82.9  | 71.2                                     | 82.2                     | 86.2                  | Impact Pile Driver, Concrete Saw, Hoe Ram | 75.0  | 71.2                                     | 77.6                     | 80.6                  | Dump Truck            | 73.3  | 71.2                                     | 76.5                     | 79.5                  | Dump Truck            | 71.3  | 71.2                                     | 74.3                     | 77.3                  | Dump Truck            |
| Center   | 38.13         | South  | 13    | 64.5  | 71.2                                     | 72.0                     | 74.0                  |   | 60.0  | 71.2                                     | 71.5                     | 74.0                  |                       | 57.6  | 71.2                                     | 71.4                     | 74.0                  |                       | 51.0  | 71.2                                     | 71.2                     | 74.0                  |                       |
| Center   | 38.13         | South  | 13    | 62.9  | 71.2                                     | 71.8                     | 74.0                  | Impact Pile Driver, Concrete Saw, Hoe Ram | 59.0  | 71.2                                     | 71.5                     | 74.0                  |                       | 56.6  | 71.2                                     | 71.3                     | 74.0                  |                       | 52.1  | 71.2                                     | 71.3                     | 74.0                  |                       |
| Center   | 38.13         | South  | 13    | 74.0  | 82.9                                     | 83.5                     | 83.3                  |   | 69.3  | 82.9                                     | 83.1                     | 83.3                  |                       | 66.8  | 82.9                                     | 83.0                     | 83.3                  |                       | 62.8  | 82.9                                     | 83.0                     | 83.3                  |                       |
| Center   | 41.61         | South  | 13    | 82.4  | 71.2                                     | 82.7                     | 85.7                  | Impact Pile Driver, Concrete Saw, Hoe Ram | 76.4  | 71.2                                     | 77.5                     | 80.5                  | Dump Truck            | 74.8  | 71.2                                     | 76.4                     | 79.4                  | Dump Truck            | 71.1  | 71.2                                     | 74.2                     | 74.0                  |                       |
| Center   | 41.61         | South  | 14    | 71.5  | 71.2                                     | 74.4                     | 77.4                  |   | 66.0  | 71.2                                     | 72.3                     | 74.0                  |                       | 63.3  | 71.2                                     | 71.9                     | 74.0                  |                       | 56.4  | 71.2                                     | 71.3                     | 74.0                  |                       |
| Center   | 41.61         | South  | 14    | 68.0  | 71.2                                     | 72.9                     | 74.0                  |   | 64.3  | 71.2                                     | 72.0                     | 74.0                  |                       | 61.6  | 71.2                                     | 71.7                     | 74.0                  |                       | 58.5  | 71.2                                     | 71.4                     | 74.0                  |                       |
| Center   | 41.61         | South  | 14    | 81.7  | 82.9                                     | 85.4                     | 83.3                  |   | 75.6  | 82.9                                     | 83.7                     | 83.3                  |                       | 73.8  | 82.9                                     | 83.4                     | 83.3                  |                       | 68.9  | 82.9                                     | 83.1                     | 83.3                  |                       |
| Center   | 45.09         | South  | 14    | 82.3  | 71.2                                     | 82.6                     | 85.6                  | Impact Pile Driver, Concrete Saw, Hoe Ram | 76.2  | 71.2                                     | 77.4                     | 80.4                  | Dump Truck            | 74.7  | 71.2                                     | 76.3                     | 79.3                  | Dump Truck            | 70.8  | 71.2                                     | 74.0                     | 74.0                  |                       |
| Center   | 45.09         | South  | 15    | 74.5  | 71.2                                     | 76.2                     | 79.2                  | Impact Pile Driver, Hoe Ram, Concrete Saw | 74.5  | 71.2                                     | 72.7                     | 74.0                  |                       | 64.9  | 71.2                                     | 72.1                     | 74.0                  |                       | 57.8  | 71.2                                     | 71.4                     | 74.0                  |                       |
| Center   | 45.09         | South  | 15    | 73.2  | 71.2                                     | 75.3                     | 78.3                  | Impact Pile Driver, Concrete Saw, Hoe Ram | 67.4  | 71.2                                     | 72.7                     | 74.0                  |                       | 65.4  | 71.2                                     | 72.2                     | 74.0                  |                       | 61.7  | 71.2                                     | 71.7                     | 74.0                  |                       |
| Center   | 45.09         | South  | 15    | 82.7  | 82.9                                     | 85.8                     | 83.3                  |   | 76.0  | 82.9                                     | 83.7                     | 83.3                  |                       | 74.3  | 82.9                                     | 83.5                     | 83.3                  |                       | 69.6  | 82.9                                     | 83.1                     | 83.3                  |                       |
| Center   | 48.57         | South  | 15    | 82.1  | 71.2                                     | 82.4                     | 85.4                  | Impact Pile Driver, Concrete Saw, Hoe Ram | 76.0  | 71.2                                     | 77.2                     | 80.2                  | Dump Truck            | 74.5  | 71.2                                     | 76.2                     | 79.2                  | Dump Truck            | 70.6  | 71.2                                     | 73.9                     | 74.0                  |                       |
| Center   | 48.57         | South  | 16    | 74.4  | 71.2                                     | 76.1                     | 79.1                  | Impact Pile Driver, Hoe Ram, Concrete Saw | 67.7  | 71.2                                     | 72.8                     | 74.0                  |                       | 65.8  | 71.2                                     | 72.3                     | 74.0                  |                       | 60.0  | 71.2                                     | 71.5                     | 74.0                  |                       |
| Center   | 48.57         | South  | 16    | 74.6  | 71.2                                     | 76.2                     | 79.2                  | Impact Pile Driver, Concrete Saw, Hoe Ram | 67.8  | 71.2                                     | 72.8                     | 74.0                  |                       | 65.9  | 71.2                                     | 72.3                     | 74.0                  |                       | 62.6  | 71.2                                     | 71.                      |                       |                       |

550 Washington Street FEIS  
 Construction Noise Analysis  
 Center Building  
 Assumes Simultaneous Construction of North and South Buildings



| Building | Height<br>(m) | Façade | Floor | Year 1 Results   |   |                                |                       |                       | Year 2 Results   |   |                                |                       |                       | Year 3 Results   |   |                                |                       |                       | Year 4 Results   |   |                                |                       |                       |
|----------|---------------|--------|-------|--|---|--------------------------------|-----------------------|-----------------------|--|---|--------------------------------|-----------------------|-----------------------|--|---|--------------------------------|-----------------------|-----------------------|--|---|--------------------------------|-----------------------|-----------------------|
|          |               |        |       | Calculated construction Noise level<br>$L_{eq}(100\%)$ | Non Construction Noise<br>$L_{eq}(100\%)$ | Total Level<br>$L_{eq}(100\%)$ | Total L10<br>$L_{10}$ | Dominant Noise Source | Calculated construction Noise level<br>$L_{eq}(100\%)$ | Non Construction Noise<br>$L_{eq}(100\%)$ | Total Level<br>$L_{eq}(100\%)$ | Total L10<br>$L_{10}$ | Dominant Noise Source | Calculated construction Noise level<br>$L_{eq}(100\%)$ | Non Construction Noise<br>$L_{eq}(100\%)$ | Total Level<br>$L_{eq}(100\%)$ | Total L10<br>$L_{10}$ | Dominant Noise Source | Calculated construction Noise level<br>$L_{eq}(100\%)$ | Non Construction Noise<br>$L_{eq}(100\%)$ | Total Level<br>$L_{eq}(100\%)$ | Total L10<br>$L_{10}$ | Dominant Noise Source |
| Center   | 55.53         | West   | 18    | 68.1   | 82.9                                      | 83.1                           | 83.3                  |                       | 63.9   | 82.9                                      | 83.0                           | 83.3                  |                       | 61.9   | 82.9                                      | 83.0                           | 83.3                  |                       | 50.8   | 82.9                                      | 82.9                           | 83.3                  |                       |
| Center   | 59.01         | West   | 18    | 80.5   | 71.2                                      | 81.0                           | 84.0                  |                       | 73.1   | 81.0                                      | 75.3                           | 78.3                  |                       | 71.3   | 71.2                                      | 74.3                           | 77.3                  |                       | 64.9   | 71.2                                      | 72.1                           | 74.0                  |                       |
| Center   | 55.53         | West   | 18    | 74.1   | 82.9                                      | 83.5                           | 83.3                  |                       | 67.9   | 82.9                                      | 83.1                           | 83.3                  |                       | 65.1   | 82.9                                      | 83.0                           | 83.3                  |                       | 56.6   | 82.9                                      | 82.9                           | 83.3                  |                       |
| Center   | 65.97         | West   | 19    | 79.0   | 71.2                                      | 79.7                           | 82.7                  |                       | 72.5   | 79.7                                      | 74.9                           | 77.9                  |                       | 71.5   | 71.2                                      | 74.4                           | 77.4                  |                       | 64.1   | 71.2                                      | 72.0                           | 74.0                  |                       |
| Center   | 62.49         | West   | 19    | 80.4   | 71.2                                      | 80.9                           | 83.9                  |                       | 73.0   | 71.2                                      | 75.2                           | 78.2                  |                       | 71.2   | 71.2                                      | 74.2                           | 74.0                  |                       | 64.9   | 71.2                                      | 72.1                           | 74.0                  |                       |
| Center   | 59.01         | West   | 19    | 74.0   | 82.9                                      | 83.5                           | 83.3                  |                       | 67.8   | 83.5                                      | 83.1                           | 83.3                  |                       | 65.0   | 82.9                                      | 83.0                           | 83.3                  |                       | 56.5   | 82.9                                      | 82.9                           | 83.3                  |                       |
| Center   | 69.45         | West   | 20    | 79.3   | 71.2                                      | 79.9                           | 82.9                  |                       | 72.6   | 71.2                                      | 75.0                           | 78.0                  |                       | 71.7   | 71.2                                      | 74.5                           | 77.5                  |                       | 65.0   | 71.2                                      | 72.1                           | 74.0                  |                       |
| Center   | 65.97         | West   | 20    | 80.2   | 71.2                                      | 80.7                           | 83.7                  |                       | 73.0   | 71.2                                      | 75.2                           | 78.2                  |                       | 71.3   | 71.2                                      | 74.3                           | 77.3                  |                       | 64.9   | 71.2                                      | 72.1                           | 74.0                  |                       |
| Center   | 62.49         | West   | 20    | 73.8   | 82.9                                      | 83.4                           | 83.3                  |                       | 67.7   | 83.4                                      | 82.9                           | 83.3                  |                       | 64.9   | 83.0                                      | 83.0                           | 83.3                  |                       | 56.3   | 82.9                                      | 82.9                           | 83.3                  |                       |
| Center   | 69.45         | West   | 21    | 80.0   | 71.2                                      | 80.5                           | 83.5                  |                       | 72.9   | 71.2                                      | 75.1                           | 78.1                  |                       | 71.2   | 71.2                                      | 74.2                           | 74.0                  |                       | 64.8   | 71.2                                      | 72.1                           | 74.0                  |                       |
| Center   | 65.97         | West   | 21    | 73.7   | 82.9                                      | 83.4                           | 83.3                  |                       | 67.6   | 83.4                                      | 83.1                           | 83.3                  |                       | 64.7   | 82.9                                      | 83.0                           | 83.3                  |                       | 56.2   | 82.9                                      | 82.9                           | 83.3                  |                       |
| Center   | 69.45         | West   | 22    | 73.5   | 82.9                                      | 83.4                           | 83.3                  |                       | 67.5   | 82.9                                      | 83.1                           | 83.3                  |                       | 64.6   | 82.9                                      | 83.0                           | 83.3                  |                       | 56.1   | 82.9                                      | 82.9                           | 83.3                  |                       |
| Center   | 72.93         | West   | 23    | 73.4   | 82.9                                      | 83.4                           | 83.3                  |                       | 67.3   | 83.4                                      | 83.1                           | 83.3                  |                       | 64.4   | 82.9                                      | 83.0                           | 83.3                  |                       | 55.9   | 82.9                                      | 82.9                           | 83.3                  |                       |
| Center   | 76.41         | West   | 24    | 73.3   | 82.9                                      | 83.4                           | 83.3                  |                       | 67.2   | 82.9                                      | 83.0                           | 83.3                  |                       | 64.3   | 82.9                                      | 83.0                           | 83.3                  |                       | 55.8   | 82.9                                      | 82.9                           | 83.3                  |                       |
| Center   | 79.89         | West   | 25    | 73.1   | 82.9                                      | 83.4                           | 83.3                  |                       | 67.1   | 83.4                                      | 83.0                           | 83.3                  |                       | 64.2   | 82.9                                      | 83.0                           | 83.3                  |                       | 55.8   | 82.9                                      | 82.9                           | 83.3                  |                       |
| Center   | 83.37         | West   | 26    | 73.0   | 82.9                                      | 83.4                           | 83.3                  |                       | 67.1   | 82.9                                      | 83.0                           | 83.3                  |                       | 64.2   | 82.9                                      | 83.0                           | 83.3                  |                       | 55.6   | 82.9                                      | 82.9                           | 83.3                  |                       |
| Center   | 86.85         | West   | 27    | 72.9   | 82.9                                      | 83.3                           | 83.3                  |                       | 67.0   | 83.3                                      | 83.0                           | 83.3                  |                       | 64.2   | 82.9                                      | 83.0                           | 83.3                  |                       | 55.5   | 82.9                                      | 82.9                           | 83.3                  |                       |
| Center   | 90.33         | West   | 28    | 72.8   | 82.9                                      | 83.3                           | 83.3                  |                       | 66.8   | 83.3                                      | 83.0                           | 83.3                  |                       | 64.1   | 82.9                                      | 83.0                           | 83.3                  |                       | 55.4   | 82.9                                      | 82.9                           | 83.3                  |                       |
| Center   | 93.81         | West   | 29    | 72.8   | 82.9                                      | 83.3                           | 83.3                  |                       | 66.6   | 82.9                                      | 83.0                           | 83.3                  |                       | 64.0   | 82.9                                      | 83.0                           | 83.3                  |                       | 55.3   | 82.9                                      | 82.9                           | 83.3                  |                       |



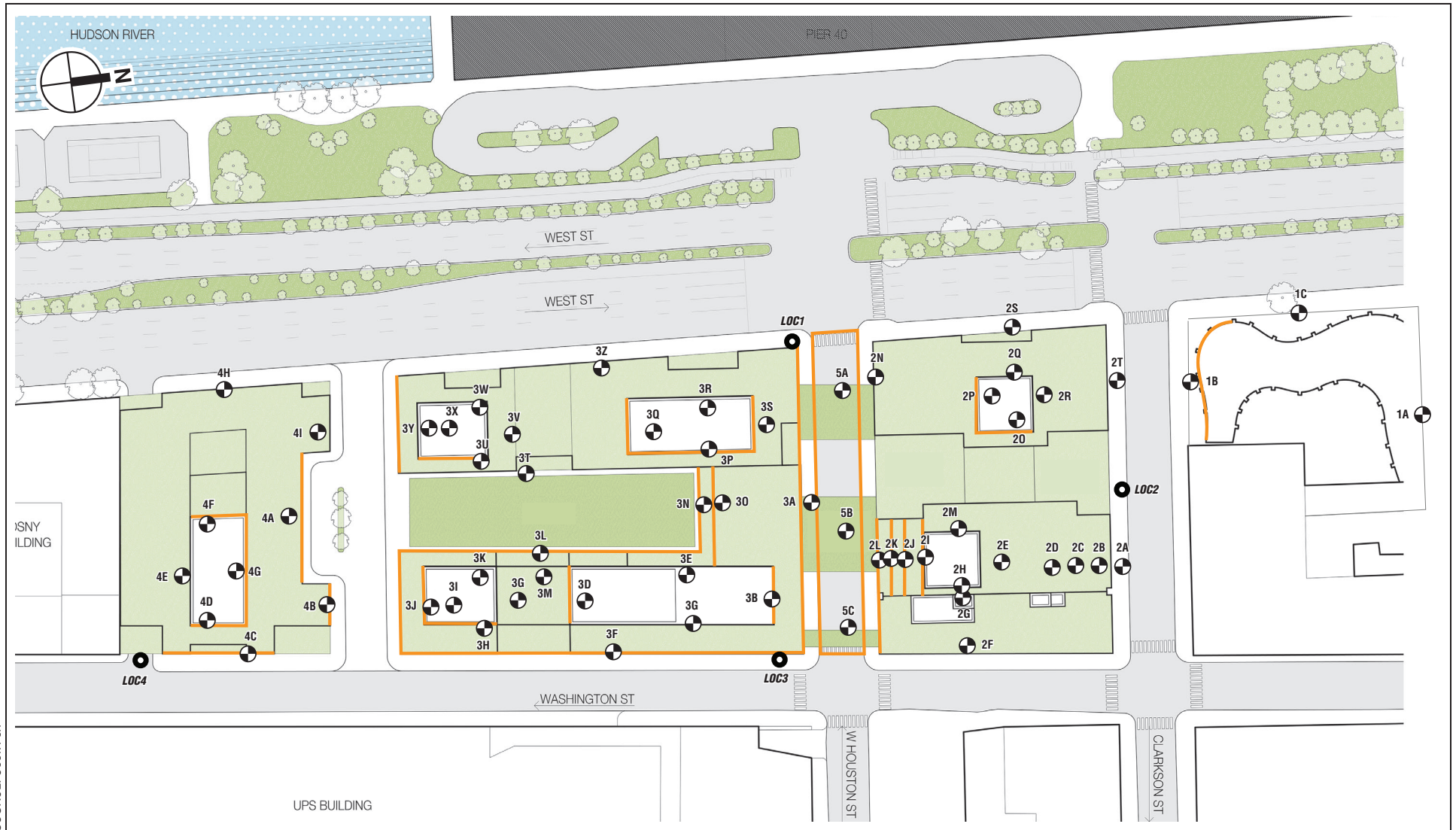



SOURCE: Cook Fox

-  Calculated Noise Receptor
-  Measured Noise Receptor
-  Significant Impact